

Turntable play

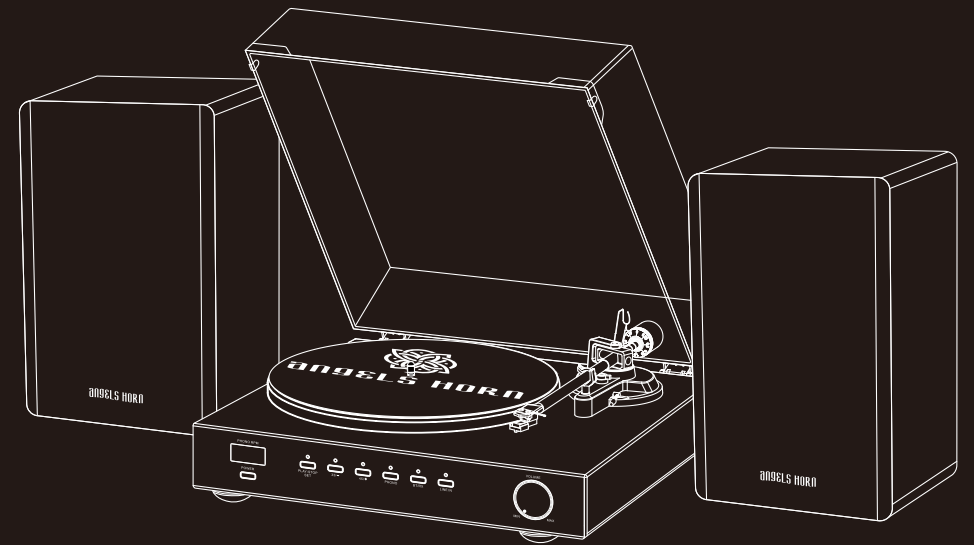

Introduction

Thank you for purchasing Angels Horn Turntable Hi-Fi System with Speakers. This instruction manual contains important information about safety, usage and disposal. Use the product as described and keep this manual for future reference. If you sell this turntable or pass it on, also give this manual to the new owner.

Safety Instructions

Read and understand this entire manual before using this product. Keep these instructions for future reference.

1. Do not set and use the product in locations that are considerably hot or humid, dirty, or subject to extreme vibrations.
2. The product should be positioned on a flat, level surface.
3. Attach the provided protector to the cartridge when the product is not in use.
4. Do not touch the stylus of the cartridge with your finger.
5. Do not allow the stylus to bump against the platter, felt mat, or edge of the record.
6. Only connect the turntable to a power outlet type as indicated on the marking label or in the "Specifications" section of this instruction manual.
7. The turntable has a polarized plug (one pin is wider than the other). To reduce the risk of electric shock, this plug is intended to fit into a polarized outlet in only one orientation. If the plug does not fit fully into the outlet, reverse the plug. If it still does not fit, contact a qualified electrician. Do not attempt to modify the plug in any way.
8. Protect the power cord from being walked on or pinched, particularly at the power plug, at the point of connection between the plug and outlet and at the point of connection between the power cable and speaker.
9. Do not overload wall outlets or extension cords as this will be a fire hazard and may cause electric shock.
10. Never push objects of any kind into the turntable through openings as they may touch dangerous voltage points or short out parts that could result in a fire or electric shock. Never spill liquid of any kind on the product.
11. Do not attempt to service the turntable yourself as opening or removing body panels may expose you to dangerous voltage or other hazards. Refer all servicing to qualified service personnel.

12. Changes or modifications to the turntable not expressly approved by the party responsible for compliance could void the user's authority to operate the product.
13. Do not use attachments not recommended by the manufacturer as they may cause hazards.
14. Only place on a flat, sturdy table or use with the cart, stand, tripod or bracket as specified by the manufacturer or sold with the turntable. When a cart is used, use caution when moving the cart/turntable combination to avoid injury from tip-over. 
15. Slots and openings in the cabinet are provided for ventilation and to ensure reliable operation of the product and to protect it from overheating. Do not block or cover these openings.
16. Unplug the product during lightning storms or when unused for long periods of time.

COMPLIANCE WITH FCC REGULATIONS

This device complies with Part 15 of FCC rules. Operation is subject to the following two conditions:

- (1) This device may not cause harmful interference, and
- (2) This device must accept any interference received, including interference that may cause undesired operation.

Note: This equipment has been tested and found to comply with the limits for a Class B digital device, pursuant to Part 15 of the FCC rules. These limits are designed to provide reasonable protection against harmful interference in a residential installation. This equipment generates, uses and can radiate radio frequency energy and, if not installed and used in accordance with the instructions, may cause harmful interference to radio communications. However, there is no guarantee that interference will not occur in a particular installation.

If this equipment does cause harmful interference to radio or television reception, which can be determined by turning the equipment off and on, the user is encouraged to try to correct the interference by one or more of the following measures:

- Reorient or relocate the receiving antenna.
- Increase the separation between the equipment and receiver.
- Connect the equipment into an outlet on a circuit different from that to which the receiver is connected.
- Consult the dealer or an experienced radio/TV technician for help.

WARNING: Changes or modifications to this unit not expressly approved by the party responsible for compliance could void the user's authority to operate the equipment.

Radiation Exposure Statement

This device complies with FCC RF radiation exposure limits set forth for an uncontrolled environment.

The FCC certification of this device refers to RF exposure testing performed in typical operating conditions, where a person is no closer than 20 centimeters from the device surface at all times, except for non-repetitive patterns with transient time intervals in the order of a second. Only in the stated conditions, the device is shown to fully comply with the FCC RF Exposure requirements of KDB 447498.

WARNING: Cancer and Reproductive Harm - HYPERLINK "<http://www.P65Warnings.ca.gov>."

Part Names and Functions

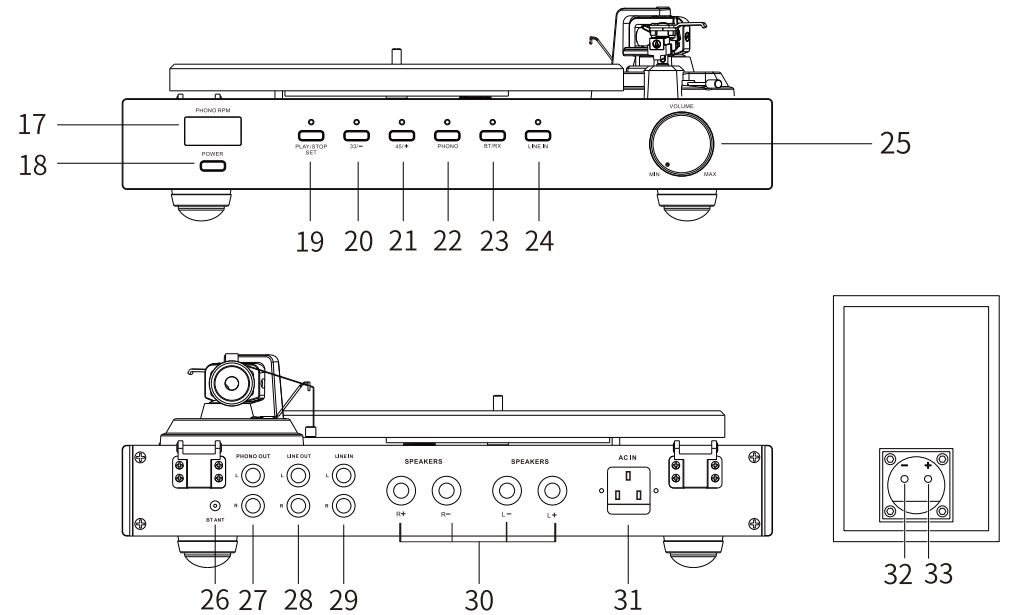
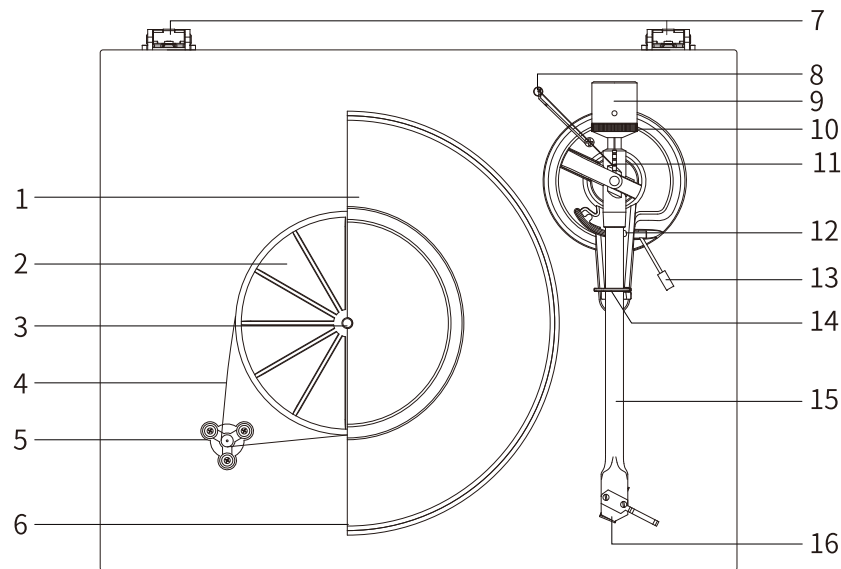

- | | | |
|--------------------------|---|--|
| 1.Cast Iron Platter | 12.Tonearm Rest | 23.BT/RX Button:Bluetooth Receiving Mode |
| 2.Sub-platter | 13.Tonearm Lift Lever | 24.Line In Button:Line In Mode |
| 3.Spindle | 14.Tonearm Clip | 25.Volume Knob:Volume Adjustment |
| 4. Drive Belt | 15.Tonearm | 26.BT ANT:Bluetooth Antenna |
| 5.Motor Pulley | 16.Cartridge with Stylus | 27.PHONO Out Jacks |
| 6.Felt Mat | 17.LED Display:Speed Display | 28.Line Out Jacks |
| 7.Lid Hinge | 18.Power Button:Power Switch | 29.Line In Jacks |
| 8.Anti-skating Weight | 19.Play/ Stop/ SET Button:Play/Stop Switch | 30.External Speaker Jacks |
| 9.Tonearm Counterweight | 20.33-/Button:33 1/3RPM Selection & Slow Down | 31.Power Cord Jack |
| 10.Down-force Scale Dial | 21.45+/Button:45RPM Selection & Accelerate | 32.Speaker Jack - |
| 11.Anti-skating Stick | 22.PHONO Button:PHONO Mode | 33.Speaker Jack + |

Included Items

Before installing the turntable, check the package contents to ensure all parts below are included and free of visible damage. Please retain the original packaging materials for exchange or return purposes.

1 x Turntable Unit	1 x Tonearm Counterweight
2 x Speakers	1 x Drive Belt
1 x Turntable Lid	1 x Belt Hook
1 x Turntable Felt Mat	1 x Bluetooth Antenna
1 x Turntable Platter	1 x Cartridge Alignment Protractor
1 x Sub-platter	1 x AC Power Cable
1 x 45 RPM Adapter	2 x Audio Cables for Speakers
1 x Anti-skating Weight	1 x User Manual

Installing the Lid

Insert the hinge pockets of the lid onto the hinges of the turntable.

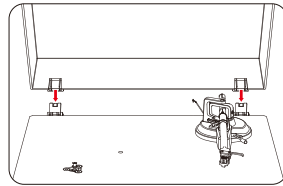

Turntable Platter and Belt Setup

1. Remove the protective packaging and ensure the turntable is placed on a sturdy and level surface.
2. Insert the sub-platter into the turntable spindle located in the middle of the turntable.
3. Loop the drive belt around the sub-platter and motor pulley.
4. Using your hands, slowly rotate the sub-platter ten times in the direction of the arrow (Figure 1).

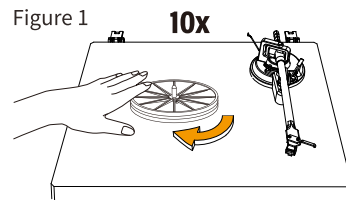

5. This step is for resetting the auto mechanism, getting rid of any twists in the belt and making sure the belt rides smoothly along the drive rim on the underside of the platter.
6. Carefully place the main platter onto the sub-platter (Figure 2).
7. Place the slip mat on top of the platter (Figure 3).

Figure 2

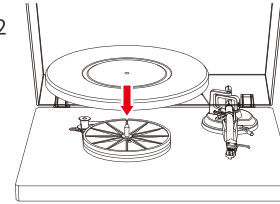
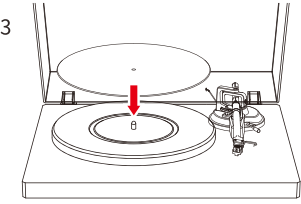
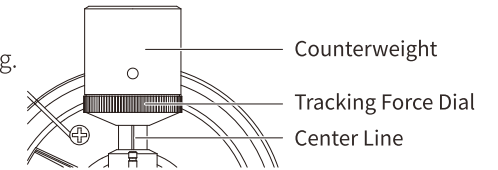

Figure 3



Cartridge Tracking Force Adjustment

The Counterweight supplied is suitable for cartridges weighing between 3.0-6.0g.



1. Gently push and turn the Counterweight onto the rear of the tonearm (with the dial facing toward the front of the turntable).

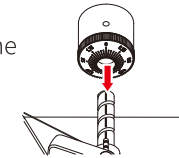

2. Pull the cartridge protection cap straight forward to remove it.

Note: Applying a downward force may cause the stylus to come off the body. Only low volume is output if the stylus has come off, or is about to come off, so refer to "Replacing the stylus" to reattach the stylus correctly.

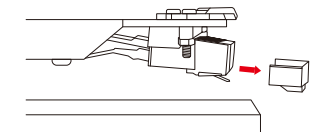

3. Remove the tie-wrap and unlock the tone arm.
4. Lower the tonearm lift lever and position the cartridge in the space between tonearm rest and platter.

5. Carefully rotate the Counterweight until the tonearm achieves a neutral balance (The tonearm will rock up and down during the adjustment process, and eventually it should reach this balanced position). This adjustment must be done carefully.

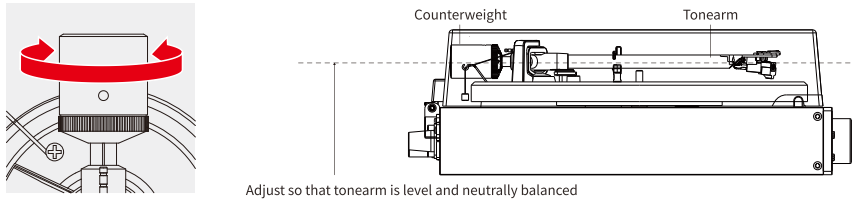

6. Once the tonearm is correctly balanced, return the tonearm to its rest. Hold the Counterweight without moving it, and gently rotate the tracking force dial until the zero is in line with the center line on the rear of the tonearm. Check to make sure the tonearm is still neutrally balanced.

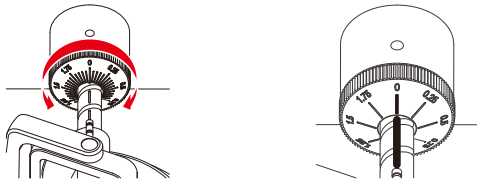

7. Rotate the counterweight counterclockwise (seen from the front) to adjust the tracking force according to the cartridge manufacturer's recommendations.

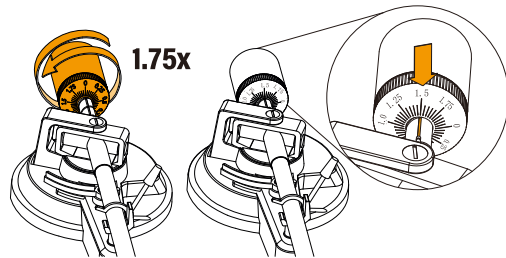

Note: Each mark on the scale represents 0.05g. The recommended tracking force for the factory-installed cartridge is 3.5g+0.5g. The cartridge only goes up to 2.0g for one rotation of the tracking force dial. You will need to make more than one (1.75X) rotation to reach 3.5g.

Anti-skating Force Adjustment

The anti-skating force must be adjusted corresponding to the tracking force as follows:

Tracking Force	Groove in the stick
5-10 mN	1st from the bearing ring
10-15 mN	2nd from the bearing ring
15-20 mN	3rd from the bearing ring
20 mN and bigger	4th from the bearing ring

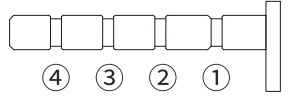

- Slip the loop of the anti-skating weight's thread over the **3rd** groove of the stick to set the correct anti-skating force for the factory-fitted cartridge.

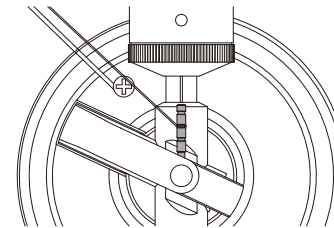

- Feed the thread through the loop of the wire hanger.

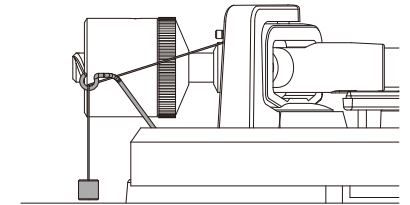

Stereo System Connection

1. Connection to the Included Speakers

This turntable includes a built-in preamp and supplied with Hi-Fi speakers. Connect the speakers using the included audio cable (gold cable to red cable clamp and silver cable to black cable clamp).

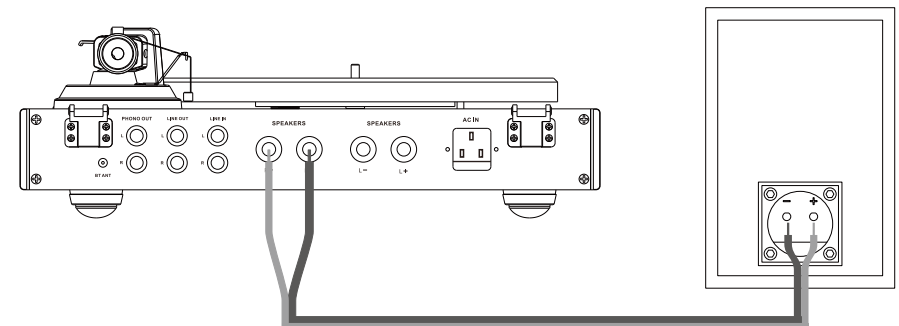

2. Connection to External Speaker with the RCA Audio Cable

As the turntable has a built-in phono pre-amplifier. The RCA Line Out Jacks output analog line-level signals and could be connected directly with a pair of active/powerd speakers.

The bottom plug connects with the Right channel and the top plug connects with the Left channel.

Note: The RCA Jacks are not designed to be connected directly to the passive/unpowered speakers on LINE mode. If connected to the passive speakers, there is no sound.

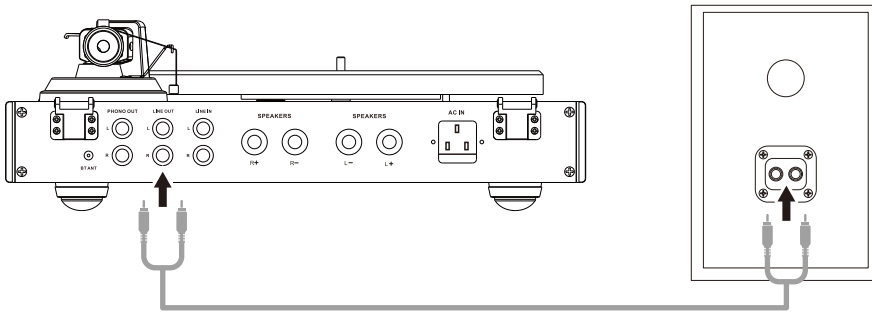

3. Connection to an Amplifier

This turntable uses a moving magnetic cartridge. Connect the phono out jacks with the phono input on your amplifier or pre-amplifier (phono stage) by RCA audio cable. Line inputs on your amplifier such as CD, Tuner, Tape, or Video jacks are not suitable for phono inputs. Make sure the amplification of the selected input matches the type of cartridge being used.

The factory installed cartridge is 47k ohms/MM-input.

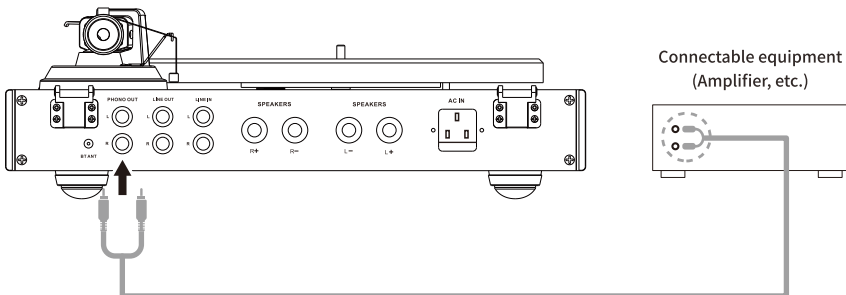

4. LINE-IN Operation

This turntable includes an auxiliary audio signal input jack for connecting external audio devices like MP3 players, CD players and DVD player, Turntable etc., So you can listen to your external source through the turntable's speakers.

1. Use an audio cable (not included) with one RCA stereo connection on one end of the cable and another end with 3.5mm stereo connection.
2. Plug the RCA cable end into the LINE IN jack at the back of the turntable and the other end to the Line Out Jack of the audio device.
3. Power on the turntable and external audio device. It will be on Bluetooth Mode by default when power on this turntable. Press the LINE IN button, it will enter into the LINE IN mode.
4. The volume level can be controlled through the turntable. Operate all the functions on the auxiliary device as usual.

Main Power Connection

1. Insert the plug of the power cable into the AC INPUT Jack at the back of the turntable.
2. Plug the power cable into a normal power outlet.

Note: Do not plug the AC power cable into a power outlet before all turntable assembly is completed. Before turning on turntable power, recheck all connections to make sure they are correct and secure. Always turn off the turntable before connecting or disconnecting from power.

Playing a Record

1. Before playing a record

- 1.1 Pull the stylus protector straight forward to remove it.

Note: Applying a downward force may cause the stylus to come off the body. Only low volume is output if the stylus has come off, or is about to come off, so refer to "Replacing the stylus" to reattach the stylus correctly.

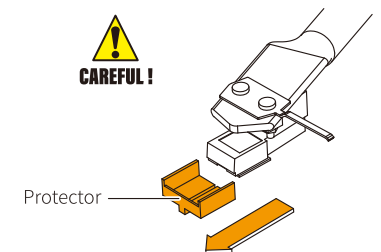

- 1.2 Place the record on the felt mat so that the center hole aligns with the spindle.
If playing a 45 RPM record with a large center hole, attach the 45 RPM adapter.

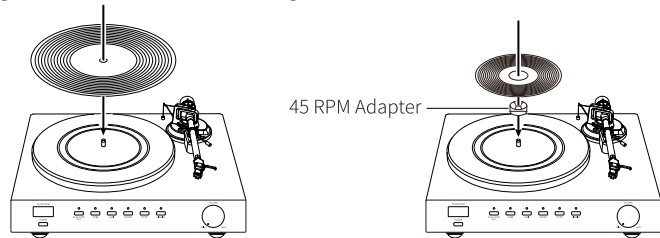

2. Turntable Operation

- 2.1 Connect the included power cable to the turntable and press the Power Button to power on this unit.
- 2.2 Press the PHONO button once to enter into the PHONO Mode.
- 2.3 Place the record on the slip mat. If using 45RPM records, put the 45RPM adapter on the center spindle before placing the record on the platter.
- 2.4 Press the 33 or 45 RPM speed button according to the type of record.
- 2.5 Press the Play/Stop button, the platter will start turning.
- 2.6 Remove the stylus protector from the stylus.
- 2.7 Unlock the tonearm clip and set the tonearm lift lever to the up position.
- 2.8 Position the tonearm over the desired location (groove) on the record.
- 2.9 Move the tonearm lift lever to the down position to move the tonearm toward the record. Alternatively, place the stylus over the desired location on the record.
- 2.10 Carefully lower the tonearm on the record.
- 2.11 When you are finished playing the record, raise the tonearm, return it to rest on the arm clip and press the Play/Stop button to stop.
- 2.12 The platter will stop turning if there is no sound output from the speakers in 3minutes.



45RPM Adapter

Note: Do not plug the AC power adapter into a power outlet before all turntable assembly is completed. Before turning on turntable power, recheck all connections to make sure they are correct and secure. Always turn off the turntable before connecting or disconnecting from power. When you are done, make sure the tonearm is securely locked to avoid any damage. Don't forget to turn off the power on the turntable and your external device.

3. Speed Adjusting

1. Press and hold the SET button for 3 seconds, the speed on LED display will blink. That means it entered into the speed adjusting mode.
2. Press + or - button to adjust the speed to the preferred speed. Pressing the + or - button 3 times in a row will increase or decrease the RPM by 0.1.
3. Wait for 3-5 turns to remember the speed you set by the system.
4. Press SET button to finalize. The speed on LED display will be solid.
5. The remembered speed will show after 3-5 turns when you turn on this unit.

Note: This turntable player is equipped with a brush-less motor and Hall effect sensor, it will monitor and correct the speed automatically.

Bluetooth Operation

1. Assemble the Bluetooth Antenna on the back of the turntable player.
2. Connect the included power cable to the turntable and press the Power Button to power on.
3. Press the BT/RX button once to enter into the Bluetooth Mode.
4. Turn on the Bluetooth feature of your media device and search for and select "Angels Horn Phantom" to pair the media device and turntable.
5. Once your media device is successfully paired with the turntable, the turntable will play a short confirmation sound.
6. Play and stream music from your media device to the turntable.

Note: Bluetooth version: 5.3

Maintenance and Cleaning

Note: Disconnect the power cable plug from the outlet as a precaution before maintenance.

Turntable Body

Your turntable requires little of no regular maintenance. Remove dust with a slightly damp anti-static cloth. Never use a dry cloth, this will create static electricity and attract more dust! Anti-static cleaning agents are available at specialist stores, but must be applied sparingly to avoid damage to rubber parts. It is recommended to install the needle cover before cleaning or maintenance is carried out to avoid damage.

- Do not use benzenes, thinners, etc.
- When storing the turntable for a long time, the drive belt should be removed to prevent unequal stretching.

Useful Tips

The turntable should be positioned on a low-resonance surface such as wood or multiple layer ply board to avoid structural vibrations disturbing playback.

Stylus tip

- Do not touch the stylus tip with your fingers. Avoid bumping the stylus on the turntable felt mat or a record's edge.
- If dirt and grime are stuck to the stylus tip, clean it with a commercially sold brush.
- We recommend using a stylus cleaner(not included) if the stylus tip is considerably dirty. Clean the stylus tip by moving the brush from the rear to the front of the stylus tip.

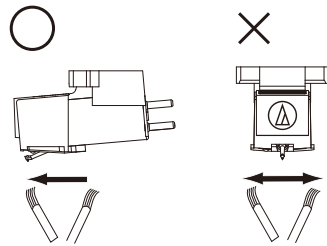

Replacing the Stylus

Removing the Stylus

- In addition to the deterioration of sound quality, records may also be damaged as the cartridge's stylus tip wears down.
- As a rule of thumb, replace the stylus after 300 to 500 hours of use.
- Be sure to disconnect the product's power cable plug from the outlet.

1. Remove the protector from the cartridge.
2. Remove the stylus by pulling in the direction of the arrow.

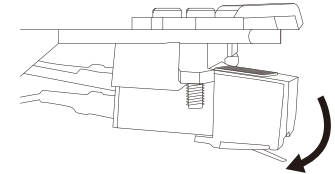

Installing a new replacement stylus

1. Grasp both sides of the stylus holder and insert the stylus grip into the cartridge rear tab of the cartridge.

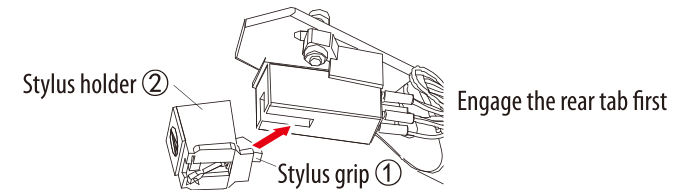

2. Push up the stylus holder until it clicks and locks completely in place.

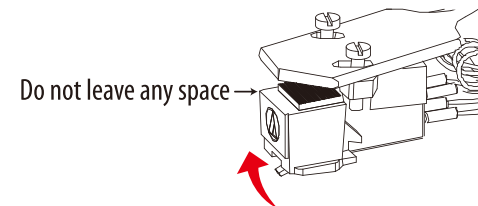

When the Turntable is Moved

Using the product's original packing materials, wrap the turntable in the reverse order from when you unwrapped it. If you do not have the packaging materials, take the following measures:

- After disconnecting the AC adapter from the outlet, remove the felt mat and platter, and then wrap them so that they do not get damaged.
- Attach the stylus protector to the cartridge.
- Use a string or something similar to tie the tonearm to the rest so that it does not move.
- Wrap the turntable body with paper or a soft cloth so that it does not get damaged.

Troubleshooting

Potential Incorrect Use and Fault Conditions:

These turntables are manufactured to the highest standards and undergo strict quality controls before leaving the factory. Faults that may possibly occur are not necessarily due to material or production faults but can sometimes be caused by incorrect use or unfortunate circumstances. Therefore the following list of common fault symptoms is included.

Problem	Solution
The platter does not spin.	<ul style="list-style-type: none"> • The turntable is not connected to the power supply. • No power at the outlet. • The belt slipped from the sub-platter. • Is the belt placed on the motor pulley? <ul style="list-style-type: none"> - Check that the belt is placed on the motor pulley (brass-colored) correctly. • Is the Play/stop set set correctly? <ul style="list-style-type: none"> - Switch to Play mode. • Has the belt been damaged? <ul style="list-style-type: none"> - Replace it with a new belt. • Turntable is not on turntable mode. <ul style="list-style-type: none"> - Press the PHONO button to turn on turntable mode.

The platter spins, but there is no sound or the volume is not loud enough.	<ul style="list-style-type: none"> • Tone arm is lifted up by the lift lever. • Ensure the PHONO/LINE OUT jacks are connected correctly. <ul style="list-style-type: none"> - If using the internal Preamp, the RCA audio cable should connect with LINE OUT Jacks - When connecting an external amplifier, please connect the external amplifier through the Phono Out port of the turntable. - When connecting external speakers, please connect the external speakers through the Line Out port of the turntable. • Is Phono mode turned on? <ul style="list-style-type: none"> - Turn on Phono mode. • The speaker needs to be connected to the turntable. • Stylus protector is still on. • Is the stylus damaged? <ul style="list-style-type: none"> - Check the stylus and replace it, if necessary. • Is the stylus placed correctly on the body of the cartridge? <ul style="list-style-type: none"> - Check the cartridge and reinstall it, if necessary. • The stylus thread is loose. <ul style="list-style-type: none"> - Firmly insert the needle thread into the cartridge.
The stylus skips.	<ul style="list-style-type: none"> • Is the record warped or scratched? <ul style="list-style-type: none"> - Check the record. Try new records if necessary. • Is the tracking force set too light? <ul style="list-style-type: none"> - Adjust the tracking force correctly. Try a slightly heavier weight (3.5g-3.8g). • It may be that the stylus is not installed correctly. <ul style="list-style-type: none"> - Reinstall the stylus. • Is the stylus damaged? <ul style="list-style-type: none"> - Check the stylus and replace it, if necessary. • The tonearm top screw is loose. <ul style="list-style-type: none"> - Turn the screw on the top of the tonearm one turn counterclockwise, and then readjust the counterweight and set the anti-skid block correctly. • It may be that the anti-slip block is not installed correctly. <ul style="list-style-type: none"> - Reinstall the anti-slip block. • The stylus is not oriented correctly. <ul style="list-style-type: none"> - Use the cartridge alignment protractor included in the turntable package to correct the stylus position.

There is howling.	<ul style="list-style-type: none"> • Is the product picking up excessive vibrations from the floor, surfaces of the walls, or nearby speakers? <ul style="list-style-type: none"> - Decrease the vibrations or mount the product on a surface that is not subject to the effects of vibrations. Move the turntable away from the speakers.
There is noise when the record is playing	<ul style="list-style-type: none"> • Is there dust on the stylus' tip? <ul style="list-style-type: none"> - If dust is stuck to the stylus tip, clean it with a commercially sold brush.
Playback speed slows down or there is irregular rotation.	<ul style="list-style-type: none"> • Is the belt stretched out? <ul style="list-style-type: none"> - Replace with a new belt. - Press + or - button to adjust the speed to the preferred speed. • The belt is not level. <ul style="list-style-type: none"> - Use the belt hook to adjust the belt to the correct horizontal position. - Clean the turntable hub shaft, clean the turntable spindle hole, and add lubricating oil into the turntable spindle hole.
Needle is not touching the record.	The screw on the tonearm rest may have loosened during transport. Gently turn this screw clockwise to move the needle stylus closer to the record.
Needle is scratching the record's surface.	Gently turn the tonearm rest screw anticlockwise to move the needle stylus away from the turntable.
Distorted or inconsistent sound from one or both channels.	<ul style="list-style-type: none"> • Turntable is connected to wrong input of amplifier. • Needle damaged. • Drive belt overstretched or dirty. • Platter bearing without oil, dirty or damaged. • Dust on stylus. • MM/MC switch on pre-amplifier set incorrectly.

Specifications

Turntable

Cabinet Material	Aluminum Alloy
Power	AC Power
Power Cord Length	1.5m
Power Consumption	385 W
Turntable Speed	33 1/3, 45 RPM
Wow and Flutter	<0.1%
Signal to Noise	80dB
Tracking Force Range	0-6.0g
Effective Tonearm Length	8.6" (218.5mm)
Dimensions(LxWxH)	430x350x156mm(lid closed)
Weight	9.5kg

Stylus

Model	Audio-Technica AT3600L
Frequency Response	20Hz-20kHz
Channel Balance	<2.5dB
Channel Separation	>18dBW
Output Voltage	2.5mV
Recommended Load Resistance	47kΩ
Amplifier Connection	MM(Moving Magnet)-input
Recommended Tracking Force	3.5±0.5g
Weight	0.18oz(5.1g)

Speaker

Output Power(RMS)	PHONO:45W x 2, Bluetooth:100W x 2
Speaker Units	Woofers:6",4Ω,100W, Tweeters:3",8Ω,15W
Frequency Response	PHONO:100Hz+10dB,10k-13dB, Bluetooth:100Hz-0dB,10kHz-1dB
Dimensions	192 x 275 x 319mm
Weight	5.10KGS for each speaker

Note: Design and specifications are subject to change without notice.

Dimensions

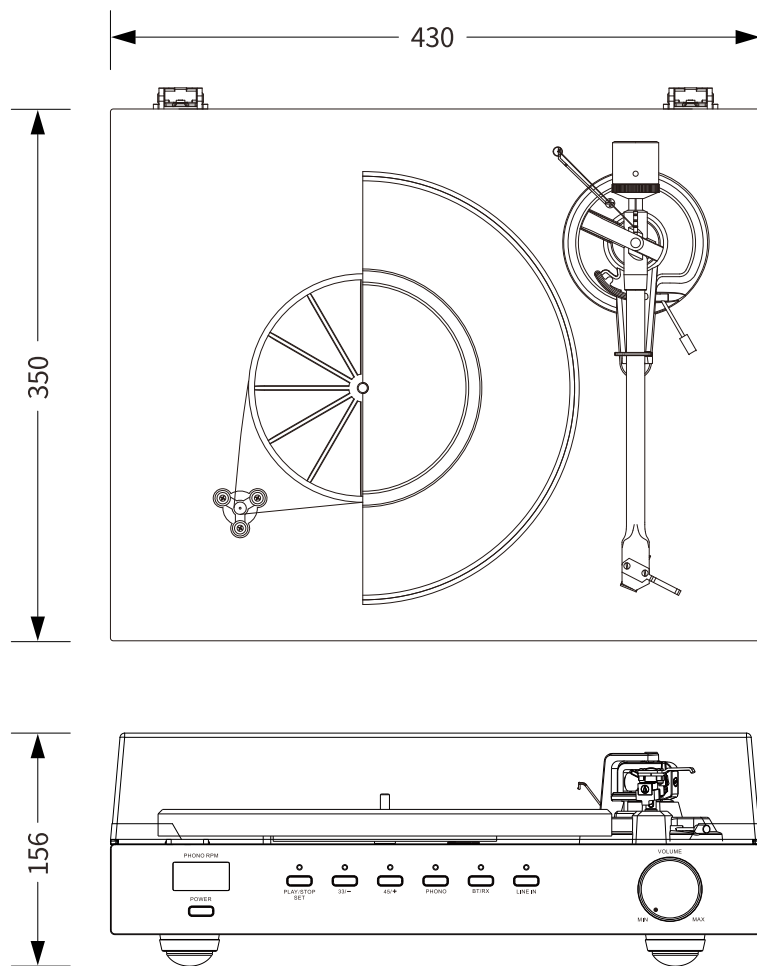

(Unit: mm)

Customer Service

Please contact Angels Horn official customer service if there is any accessory missing from the package. Please retain the original packaging materials for exchange or return purposes.

US Email :

support@angelshorn.com

UK,EU,CA Email:

services@angelshorn.com

Facebook:facebook.com/AngelsHornPage

Disposal

Disposal of the Product



Under no circumstances should you dispose of the product in normal domestic waste.

■ This product is subject to the provisions of European Directive 2012/19/EU. Dispose of the product via an approved disposal company or your municipal waste facility. Please observe currently applicable regulations.

Please contact your waste disposal center if you need any further information.



This product's packaging is made from environmentally friendly material and can be disposed of at your local recycling plant.