



## Turntable Hi-Fi System

Turntable Player

Model: HP-H005PITC



### EUROPEAN REPRESENTATIVE

EC	REP
----	-----

SHUNSHUN GmbH  
Römeracker 9 Z2021,76351  
Linkenheim-Hochstetten, Germany

### BRITISH REPRESENTATIVE

UK	AR
----	----

UK CROSSBORDER LIMITED  
7 Bell Yard London WC2A 2JR, UK  
United Kingdom

Email 1: US: support@angels-horn.com  
Email 2: UK,EU: services@angels-horn.com



## Introduction

Thank you for purchasing this Angels Horn Turntable with bluetooth HI-fi System.

Read through this user manual before using the product to ensure its correct use. This instruction manual contains important information about safety, usage, and disposal. Use the product as described and keep this manual for future reference.

This product can be used only in countries where the product is sold. Make sure that the operating voltage and the plug of AC adapter of the product are correct for the country you live in.

## Package contents

Make sure that you have all the included items listed below before using this product. If some items are missing or damaged, please contact our official customer service  
Email 1 : US: [support@angelshorn.com](mailto:support@angelshorn.com)  
Email 2 : UK,EU: [services@angelshorn.com](mailto:services@angelshorn.com)

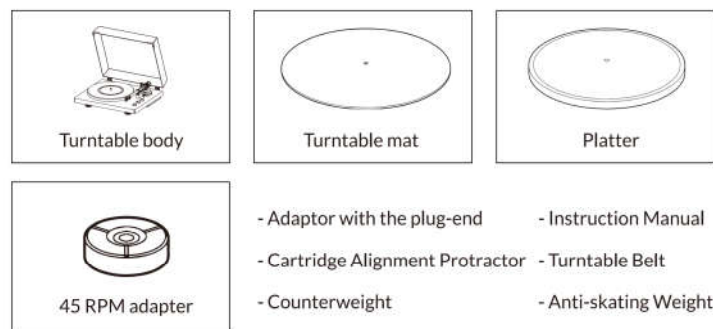

We suggest that you save all packaging materials for possible future storage, moving, or shipping.

This turntable is supplied with a factory-fitted and adjusted cartridge. The following instructions for adjusting the cartridge are provided in case the cartridge is replaced by a different model at a later date.

## Precautions Before Use

### Keep these instructions in mind

1. Do not use in wet or moist areas such as bathrooms, steamy kitchens or near swimming pools.
2. Do not cover or block any ventilation openings. When placing the device on a shelf, leave 5 cm (2") free space around the whole device.
3. Install in accordance with the supplied user manual.
4. Don't step on or pinch the power adaptor. Be very careful, particularly near the plugs and the cable's exit point. Do not place heavy items on the power adaptor, which may damage it. Keep the entire device out of children's reach! When playing with the power cable, they can seriously injure themselves.
5. Unplug this device during lightning storms or when unused for a long period.
6. Keep the device away from heat sources such as radiators, heaters, stoves, candles and other heat-generating products or naked flame.
7. Avoid using the device near strong magnetic fields.
8. Electrostatic discharge can disturb the normal usage of this device. If so, simply reset and restart the device following the instruction manual. During file transmission, please handle with care and operate in a static free environment.
9. Warning! Never insert an object into the product through the vents or openings. High voltage flows through the product and inserting an object can cause electric shock and/or short circuit internal parts. For the same reason, do not spill water or liquid on the product.
10. Although this device is manufactured with the utmost care and checked several times before leaving the factory, it is still possible that problems may occur, as with all electrical appliances. If you notice smoke, an excessive build-up of heat or any other unexpected phenomena, you should disconnect the plug from the mains power socket immediately.
11. This device must operate on a power source as specified on the specification label. If you are not sure of the type of power supply used in your home, consult your dealer or local power company.
12. The socket-outlet must be installed near the equipment and must be easily accessible.
13. Do not overload AC outlets or extension cords. Overloading can cause fire or electric shock.

## FCC Statement

This device complies with Part 15 of the FCC rules. Operation is subject to the following two conditions: 1) this device may not cause harmful interference, and 2) this device must accept any interference received, including interference that may cause undesired operation.

Note: This equipment has been tested and found to comply with the limits for a Class B digital device, pursuant to part 15 of the FCC Rules. These limits are designed to provide reasonable protection against harmful interference in a residential installation.

This equipment generates uses and can radiate radio frequency energy and, if not installed and used in accordance with the instructions, may cause harmful interference to radio communications. However, there is no guarantee that interference will not occur in particular installation. If this equipment does cause harmful interference to radio or television reception, which can be determined by turning the equipment off and on, the user is encouraged to try to correct the interference by one or more of the following measures:

- Reorient or relocate the receiving antenna.
- Increase the separation between the equipment and receiver.
- Connect the equipment into an outlet on a circuit different from that to which the receiver is connected.
- Consult the dealer or an experienced radio/TV technician for help.

Changes or modifications not expressly approved by the party responsible for compliance could void the user's authority to operate the equipment.

**Radiation Exposure Statement** This device complies with FCC RF radiation exposure limits set forth for an uncontrolled environment.

The FCC certification of this device refers to RF exposure testing performed in typical operating conditions, where a person is no closer than 20 centimeters from the device surface at all times, except for non-repetitive patterns with transient time intervals in the order of a second. Only in the stated conditions, the device is shown to fully comply with the FCC RF Exposure requirements of KDB 447498.

## Product Description

### Part names and functions

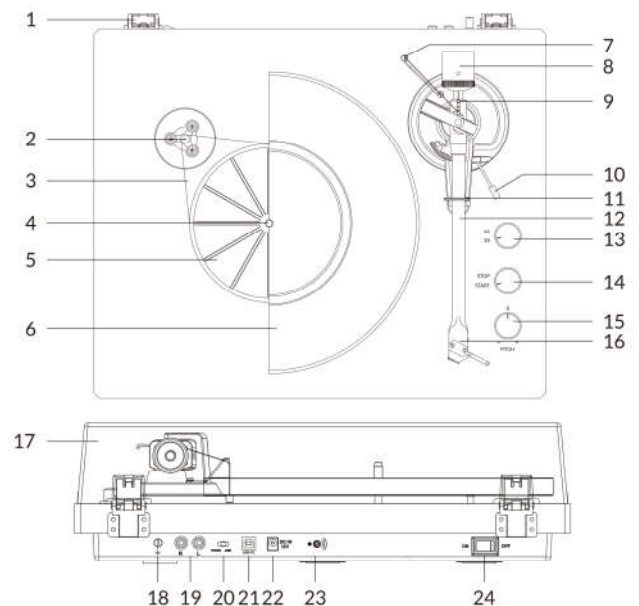

1. Lid Hinges	9. Anti-Skating Stub	17. Lid
2. Motor Pulley	10. Tonearm Lift Lever	18. Ground Connector
3. Drive Belt	11. Tonearm Rest & Clip	19. Phono & Line Out Jacks
4. Turntable Spindle	12. Tonearm	20. Phono & Line Out Switch
5. Turntable Sub-platter	13. 33/45 RPM Selector	21. USB Port for PC Link
6. Turntable Platter	14. Start/Stop Selector	22. AC-DC Power Jack
7. Anti-Skating Weight	15. Pitch Adjustment Knob	23. Bluetooth Indicator Light
8. Counterweight	16. Cartridge	24. Power Switch

## Product Description

### Technical Specifications

Nominal Speeds	33 1/3 & 45RPM
Speed Variance	+3%-2%
Wow and Flutter	≤0.15%
Signal to Noise	70dB
Down force Range	3.0-6.0g
Effective Tonearm Length	8.6" (218.5mm)
Overhang	0.73in
Power Consumption	5W (Max)
Outboard Power Supply	12V/500mA AC-DC
Dimensions (W x H x D)	420 x 360 x 125mm
Weight	5.7kgs
Platter wobbling	< 0.15%
Line out Output voltage	180mV(1KHz-10Db,33RPM)
Phono out Output voltage	2.5mV(1KHz-10Db,33RPM)

### Technical Specifications

### AT-3600L (audio-technica)

Frequency response	20Hz-20kHz
Recommended load resistance	47kohms
Channel balance	<2.5dB
Amplifier connection	MM - input
Channel separation	>18dB
Recommended tracking force	3.5±0.5g
Output voltage	2.5mV
Weight	5g
Trackability	> 90µm

## Installation

- Unpack all parts and remove protective material.
- Do not connect the unit to the mains before checking the mains voltage and before all other connections have been made.
- Those instructions are related only to products using power cable or AC power adaptor.

### 1-Installing the Lid

Install the Lid carefully over the hinge prongs

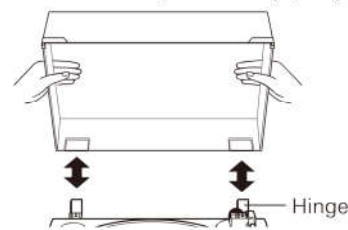

### 2-Turntable platter and belt setup

1. Insert the sub-platter into the turntable spindle located in the middle of the turntable.
2. Loop the drive belt around the sub-platter and motor pulley.
3. Carefully place the main platter onto the sub-platter (Figure 1).
4. Place the slip mat on top of the platter (Figure 2)

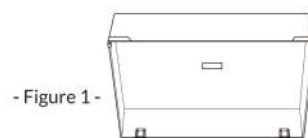

- Figure 1 -

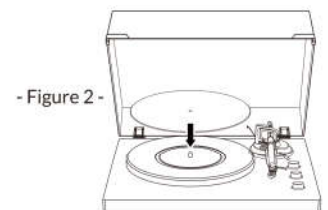

- Figure 2 -

# Installation

## 3-Cartridge tracking force adjustment

The counterweight supplied is suitable for cartridges weighing between 3.0-6.0g

- Gently push and turn the Counterweight onto the rear of the tonearm (with the scale facing toward the front of the turntable).
- Remove the cartridge protection cap.
- Lower the tonearm lift and position the cartridge in the space between tonearm rest and platter.

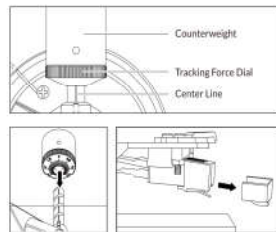

Carefully rotate the Counterweight until the tonearm balances out. The tonearm should return to the balanced position if it is moved up or down.

This adjustment must be done carefully.

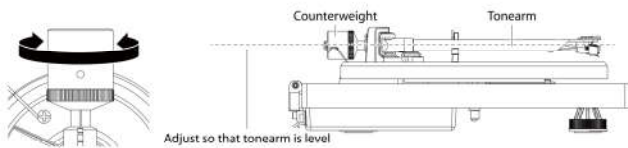

Once the tonearm is correctly balanced return it to its' rest. Hold the Counterweight without moving it, and gently rotate the Down force Scale ring until the zero is in line with black line on the rear of the tonearm. Check whether the arm still balances out.



# Installation

## 3-Cartridge tracking force adjustment

Rotate the counterweight counter clockwise (seen from the front) to adjust the down force according to the cartridge manufacturer's recommendations. One mark on the scale represents 0.05g of down force.

Note: The recommended down force for the factory fitted cartridge is  $3.5 \pm 0.5g$ .

## 4-Anti-skating force adjustment

The anti-skating force must be adjusted corresponding to the tracking force as follows:

Tracking Force	Groove in the stick
5-10 mN	1st from bearing ring
10-15 mN	2nd from the bearing ring
15-20mN	3rd from the bearing ring
20mN and bigger	4th from the bearing ring

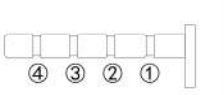

1. Slip the loop of the anti-skating weight's thread over the 3rd groove of the stub to set the correct anti-skating force for the factory-fitted cartridge.

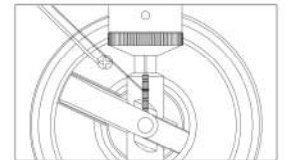

2. Feed the thread through the loop of the wire support.

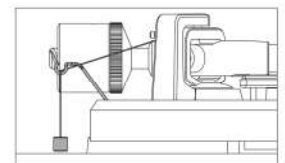

## Installation

### 5-Connection to the Amplifier

This turntable uses a moving magnetic cartridge. Set the PHONO & Line Out Switch on PHONO mode.

Connect the phono out cables to the phono input on your amplifier of the pre-amplifier (phono stage). Line inputs such as CD, Tuner, Tape, or Video are not suitable for phono inputs. Make sure the amplification of the selected input matches the type of cartridge being used.

The factory-installed cartridge is 47k ohms/MM-input.

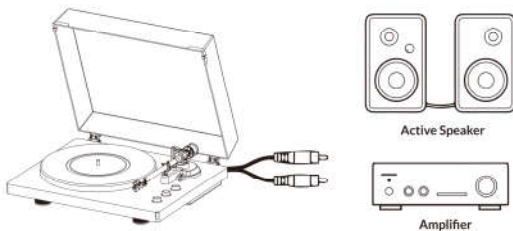

NOTE: If your amplifier does not have an input suitable for phono cartridges, you will need to purchase a separate phono amplifier for moving magnetic cartridges. This separate phono amplifier will then connect between your turntable and your amplifier.

### 6-Stereo System Connection

Set the PHONO & Line Out Switch on LINE mode. The RCA PHONO & Line Out Jacks output analog line-level signals and could be connected directly with a pair of active/powered speakers of the appropriate input of your stereo system.

The Red plug connects with the Right channel and the White plug connects with the Left channel.

NOTE: The RCA Jacks are not designed to be connected directly to the passive/unpowered speakers on LINE mode. If connected to the passive speakers, there is no sound

## Installation

### 7-Connecting to computers with USB input

Follow the settings for the pre-amplifier selector switch to connect the USB cable to the USB input of your computer.

The included USB cable connects the product to your computer without need for special drivers.

Audacity (refer to <http://www.audacityteam.org> for details) and other compatible third-party recording software packages are available allowing you to record from the product to your computer.

Be sure to set the pre-amplifier selector switch to the LINE position.

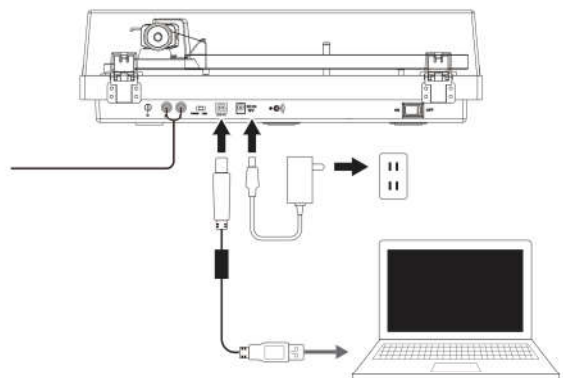

### 8-Main Power Connection

The power adaptor is in the foam packing material. Unpack the power adaptor and plug the small end into the DC power jack located at the back side of the turntable. Plug the power adaptor into your power outlet.

# Operation

## Turntable Operation

1. Connect the included power adapter to the unit and press the power rocker switch to be "ON" position.
2. Remove the needle cover from the cartridge. 
3. Place the slipmat on the platter and place a record on the slipmat. If using 45 RPM records, but the 45 RPM adapter on the center spindle before placing the record on the platter.
4. Set the 33/45 RPM Selector according to the type of record.
5. Unlock the arm clip and set the Lift Lever to the up position.
6. Position the tonearm over the desired location (groove) on the record. The platter will begin spinning.
7. Move the tonearm lift lever to the down position to move the tonearm toward the record. Alternatively, place the needle over the desired location on the record.
8. Carefully lower the tonearm on the record.
9. When you are finished playing the record, raise the tonearm, return it to rest on the arm clip.

## Bluetooth Operation

This unit has a Bluetooth transmitter to send audio to a Bluetooth speaker wirelessly.

1. Power on your Bluetooth speaker and ensure it is in pairing mode.
2. Power on the unit, the turntable will pair with your Bluetooth speaker automatically, the BT indicated blue light flashing.
3. When pairing, the light will flash twice per second, then change to the steady light indicates that the Bluetooth is paired with the device
4. If after 2 minutes no Bluetooth speaker can be found to pair with the Bluetooth transmitter will become inactive and the blue light turns to red, and the red light means it powered
5. To disconnect pairing, power off the turntable or turn off Bluetooth pairing on your Bluetooth speaker.

## Adjusting Pitch

Adjusting the pitch allows you to tailor the listening experience of music to your personal preferences. At 33 1/3 and 45 RPM, the pitch adjustment knob can reduce or increase the speed by 10%.

Turn the pitch adjustment knob clockwise to speed up the turntable speed, and turn the pitch adjustment knob counterclockwise to slow down the turntable speed.

# Maintenance and Cleaning

Your turntable requires little or no regular maintenance. Remove dust with a slightly damp antistatic cloth. Never use a dry cloth, this will create static electricity and attract more dust!

Antistatic cleaning agents are available at specialist stores, but must be applied sparingly to avoid damage to rubber parts. It is recommended to install the needle cover before cleaning or maintenance is carried out to avoid damage.

If the turntable is not used over a long period of time, the drive belt should be removed to prevent unequal stretching.

NOTE: If your amplifier does not have an input suitable for phono cartridges, you will need to purchase a separate phono amplifier for moving magnetic cartridges. This separate phono amplifier will then connect between your turntable and your amplifier.

### Useful Tips

The turntable should be positioned on a low-resonance surface such as wood or multiple layer ply board to avoid structural vibrations disturbing playback.

## Cartridge Replacement

1. Before replacement, put the stylus protector back on the stylus to prevent damage to the stylus during the replacement process.
2. Carefully remove the wire leads from the original cartridge.
3. Loosen the two screws on the headshell that are securing the cartridge and then remove the original cartridge.
4. Mount the new cartridge to the headshell and tighten it lightly. Do not completely tighten the screws at this moment.
5. Connect the wire leads to the new cartridge's terminals. The wire lead color codes are as below:

White Left channel positive (L+)

Black Left channel negative (L-)

Red Right channel positive (R+)

Black Right channel negative (R-)

## Cartridge Replacement

6. Adjust the cartridge's position to make sure it is precisely aligned on the headshell so that the stylus will be tracking the grooves in parallel perfectly.

To achieve this, place the included paper cartridge alignment protractor over the turntable spindle, carefully lift the tone arm and place the tip of the stylus on the points marked 130mm and 250mm respectively. Fine tune the cartridge's position on the headshell until the cartridge is perfectly in parallel with the reference lines at both points.

7. Tighten the screws completely once the perfect alignment is achieved.

If you are unfamiliar or uncomfortable with completing this procedure, we recommend consulting with a professional to perform the installation.

## Troubleshooting

### Potential Incorrect Use and Fault Conditions :

These turntables are manufactured to the highest standards and undergo strict quality controls before leaving the factory. Faults that may possibly occur are not necessarily due to material or production faults but can sometimes be caused by incorrect use or unfortunate circumstances. Therefore the following list of common fault symptoms is included.

Problem	Solution
The platter doesn't turn although the unit is switched on	<ul style="list-style-type: none"> <li>- The unit is not connected to the main power supply.</li> <li>- No power at the outlet.</li> <li>- Drive belt is not installed or has slipped off.</li> <li>- The unit automatically switched in standby mode, power OFF and ON again on the backside.</li> </ul>
No signal through one or other channel or both channels:	<ul style="list-style-type: none"> <li>- Phone input not selected at the amplifier.</li> <li>- Amplifier not switched on.</li> <li>- Amplifier or speakers muted.</li> <li>- No connection to the speakers.</li> <li>- No connection between turntable and amplifier.</li> <li>- Wire leads not connected to the cartridge.</li> </ul>
Strong hum on phono input:	<ul style="list-style-type: none"> <li>- No ground connection from the cartridge, arm, or arm cable to amplifier or ground loop.</li> <li>- Turntable too close to speakers.</li> </ul>
Distorted or inconsistent sound from one or both channels:	<ul style="list-style-type: none"> <li>- Turntable is connected to the wrong input of the amplifier.</li> <li>- Needle or cantilever damaged.</li> <li>- Drive belt overstretched or dirty.</li> <li>- Platter bearing without oil, dirty or damaged.</li> <li>- Dust on the stylus.</li> <li>- MM/MC switch on the pre-amplifier set incorrectly.</li> </ul>
Needle is not touching the record.	<ul style="list-style-type: none"> <li>• The screw on the tonearm rest may have loosened during transport. Gently turn this screw clockwise to move the needle stylus closer to the record.</li> </ul>
Needle is scratching the record's surface.	<ul style="list-style-type: none"> <li>• Gently turn the tonearm rest screw anticlockwise to move the needle stylus away from the turntable.</li> </ul>