

Android Tablet User Manual



Please read the instruction thoroughly before using this product and keep it for future reference.

English



- ① Headphone
- ② Micro SD Slot
- ③ Front Camera
- ④ Power Button
- ⑤ Volume +
- ⑥ Volume -
- ⑦ Reset
- ⑧ Type-C
- ⑨ Speaker
- ⑩ Rear Camera
- ⑪ Flash

Getting Started

POWER ON/POWER OFF

-Power on: Press and hold the Power button until the LCD screen turns on. Select your language and set up your tablet following the start guide.

-Power off: Press and hold the Power button until the Device Options menu appears, it will show "Power off", "Restart", select "Power off" to turn off the tablet.

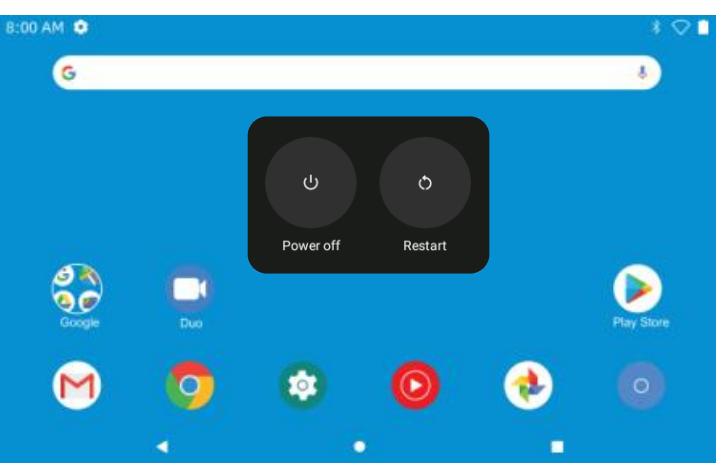

-Reboot: If it's frozen, press and hold the power button for 7-8s to do a force reboot.

02

SLEEP MODE

When the tablet is on, you can turn off the screen to save battery power. Simply press the power button once to turn the screen off. Press the power button again to turn the screen back on.

Tip: Go to **Settings-Display-Advanced-Screen timeout** to set the time gap for initiating "sleep mode".

BATTERY

A RECHARGEABLE Li-ion battery is installed in the tablet. We suggest you drain the battery completely once a month if you only use your tablet occasionally. Do Not dispose of the tablet in a fire.

SCREENSHOT

Press and hold the power button and volume "+" at the same time to screenshot. The screenshot will be saved in the photos file.



03

HOME SCREEN

ICONS ON THE BUTTON

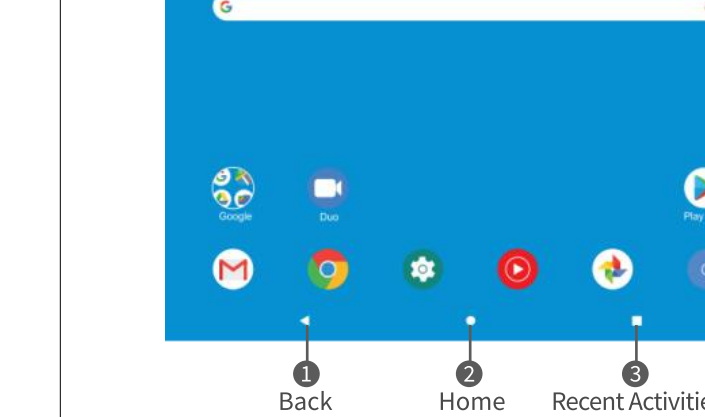

04

HOME SETTINGS & WIDGETS & WALLPAPER

Tap and hold your finger in any blank space on the home screen, you will see a pop-up menu: "Home Settings", "Widgets" and "Wallpaper buttons" will be displayed.

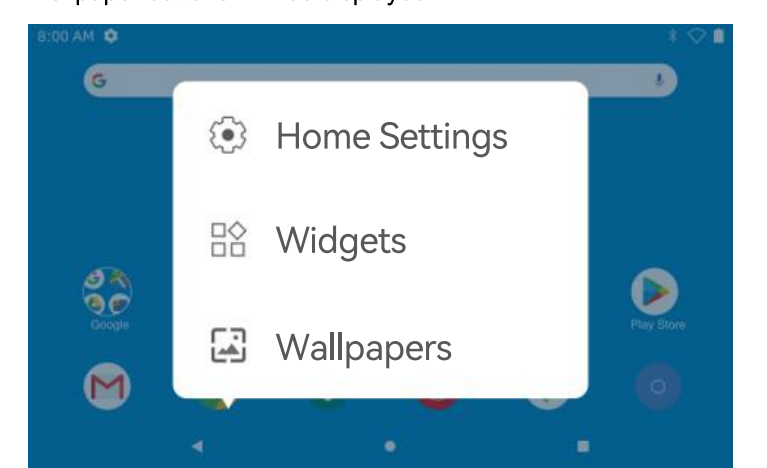

-Select "Home Settings" you can enable/disable "Add icons to Home Screen" This is applicable to any new Apps installed from "Play Store". You can also change settings for "pull-down actions", "notification dots" home screen style" and more.

-Select "Widgets" touch and hold any application(e.g.clock), then slide and add it to the Home screen, and remove it by sliding to "X Remove" above.

Tip: Hold one icon and drag it on top of another icon to create a new

05

Basic Settings

Swipe down vertically from the top to enter quick notification menu.

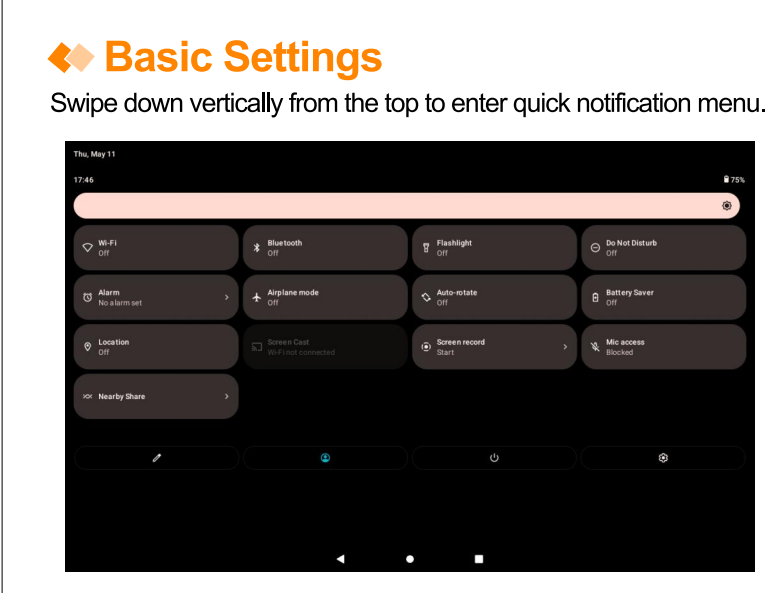

WiFi: Tap to connect/disconnect to a wireless network.
Bluetooth: Enable/disable the Bluetooth of this tablet.

06

Flashlight

Turn on/off the Flashlight of this tablet.
Do not disturb: Block sound after enabling this function.

Alarm: Tap to set up alarm

Airplane mode: Turn on/off all network connectivity.

Auto-rotate: Turn on/off the "Auto-rotate" of the screen.

Battery Saver: Tap to choose the power setting you prefer to save battery time.

Location: Turn on/off the location services for certain Apps

Screen cast: Turn on/off cast screen to device

Screen record: Tap to record screen action

Mic access: Turn on/off microphone access for apps and services

Nearby share: Tap to find nearby devices

Tap the icon to change the options in the "Quick Settings". Long press each icon to enter the interface of the detailed setting pages.

Tap the icon to set up user setting
Tap the icon to power off/restart tablet.

07

DETAILED SETTINGS

Swipe down from the top of the screen, tap icon to enter the detailed setting interface. Or tap the "Settings" App from the home screen to enter.

Network & internet
Connect to Wifi
Enable/disable "Airplane mode"
Monitor the data usage and more

Connected devices
Turn on/off Bluetooth
Pair with Bluetooth devices and check the paired devices
Check the received files from other devices via Bluetooth connection
Add and check printers and more

Apps
Check the Apps recently opened
Check all the Apps on the tablet
Set the App permissions

08

Storage

View and manage your storage space

Set a screen saver

Change the wall paper

Adjust the time for entering the sleep mode

Adjust Color and Contrast of display

Set to check the notifications and other info and more

Wallpaper
choose wallpaper from Live Wallpapers photos or wallpapers

Accessibility
For vision and hearing-impaired users, manage settings for Screen readers, Display, Interaction, controls and morewallpapers

09

Security

Set Screen lock pattern (password, PIN, Swipe etc.)and more

Privacy
Set App permissions, show account activity and save personal data

Location
Set App permissions, show account activity and save personal data

Passwords & accounts
Saved passwords, autofill, synced accounts

Digital Wellbeing & parental controls
Screen time, app timers, bedtime mode, etc.

Google
Set App permissions, show account activity and save personal data

DuraSpeed
Helps boost foreground APP speed by restricting background Apps

System
Set Language: Tap Language & input - Languages - Add a language to add your language

Restore Factory Setting: Tap Advanced - Reset options-Erase all data(factory reset)to restore the factory setting (please note that If you perform a Hard Reset, all user applications and user data will be deleted. Please remember to back up any important data before performing a Hard Reset)

Set date and time
Turn on/off the Back up to Google Drive

Check and update the tablet's system and more

About tablet
Basic information of device

10

Network Connection

Turn on the Wi-Fi

Tap "Network & Internet" and turn on the "Wifi" all available connections will be listed. Select your Wifi and input the correct password.

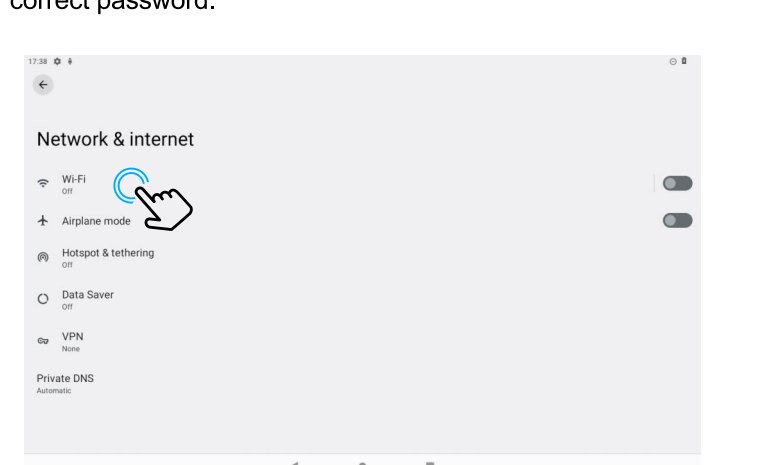

Internet Navigation

Please make sure the tablet is connected to a working Wifi network before navigating the internet. You may use the pre-installed Chrome browser or download one from Play Store.

12

Bluetooth

Please turn on the Bluetooth on your tablet and your Bluetooth device first.

Enter Settings - connected devices - Pair new device to enter the scanning interface. Devices available will be displayed after a few seconds.

Tap the desired device to get a pairing code and click PAIR on both devices. The automatic connection is applied to some devices.

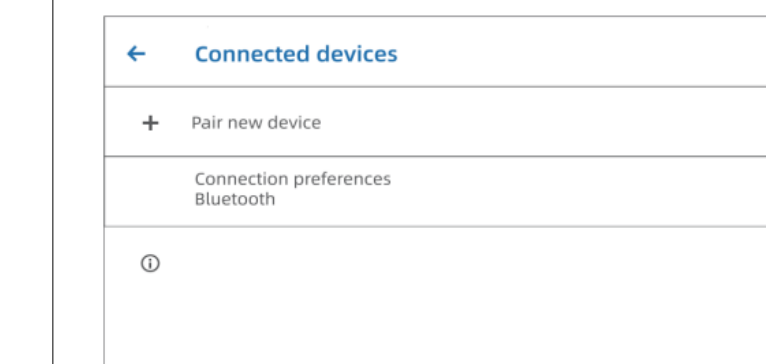

App Management

Open Play Store on the home screen
Log in your Google account, search and download the Apps you need

13

Move the APP

Tap and hold on the App, and slide it onto the desired places

Remove the App from Home Screen
Tap and hold on the App, slide to X Remove above, to remove it from your Home Screen

Uninstall the App
Touch and hold the App, then slide to the X above, to uninstall the App

Optional Connections

CONNECTING TO A COMPUTER
Connect your tablet to the computer with a USB cable
Go to your computer and find your tablet to transfer files between your tablet and computer

Tips:
Go to Quick Settings, tap Android system Charging this device to set USB preference.

File Transfer: for file transfer
USB tethering: share tablet's internet connection via USB

MIDI: Play MIDI instruments on the tablet
PTP: Transfer photos between the devices

No data transfer: to charge tablet only

14

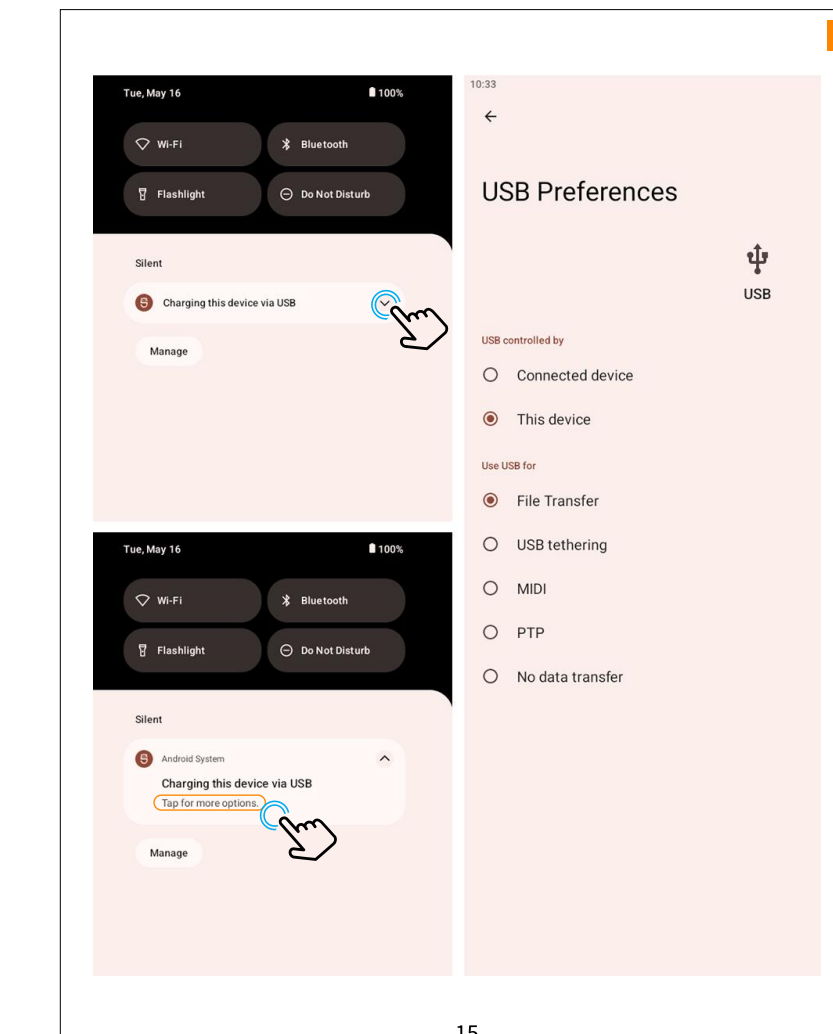

15

CONNECTING TO AN EXTERNAL SD CARD

Install the microSD card into the microSD card in the top of tablet slot and go to Quick Setting

Tap SET UP. Set the microSD card as portable storage by selecting Portable Storage. Enter MicroSD Card storage to move files between the card and tablet.

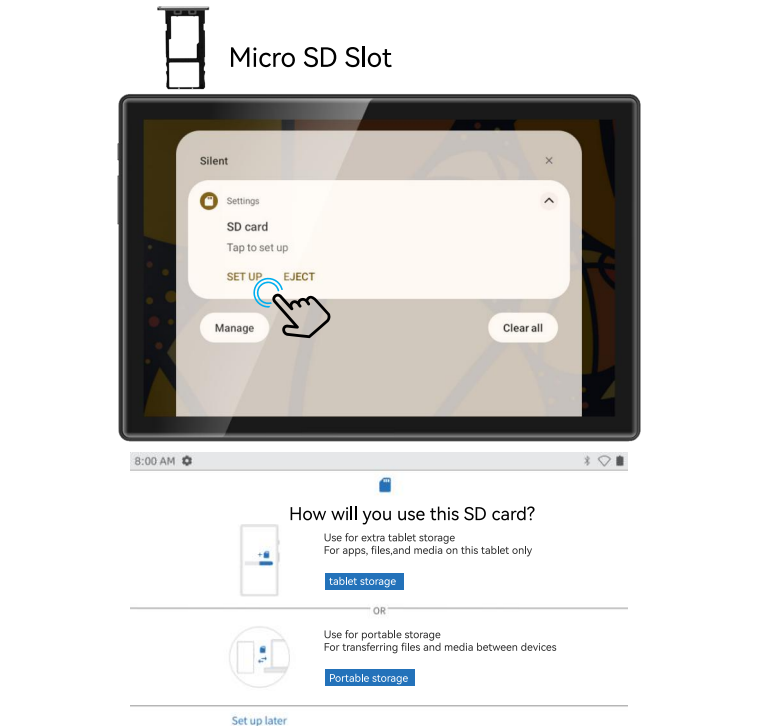

16

Specification

Display	10.1 inch
CPU	Qds Core, MTK9183 Quad-core Cortex-A73 2.0GHz+ Quad-core Cortex-A53 2.0GHz
ROM	128GB
RAM	8GB
Operation System	Android
Audio	Dual speakers
Ports	Type C3,5mm earphone port/MicroSD Card Slot (FAT32 formatted)
WiFi	IEEE 802.11a/b/g/n/ac, Dual-band 2.4GHz / 5GHz
Front Camera	8MP
Rear Camera	13MP
Power supply	5V/2A Type-C USB
Bluetooth	BT 4.2
GPS	Enable
Language	Support multi-language

17

Troubleshooting

Q1. The tablet doesn't power on.

Reboot your tablet after charging for 30 minutes.
Press the power button in case your device is in sleep mode.
Press the power button for about 7-8s to reboot.

Press the Reset button with a pin to reboot the tablet.

Q2. The tablet doesn't charge.

Keep your device plugged in for 30 minutes if it was completely drained.
Check and make sure the charger is properly plugged into the charging port.
Try another compatible USB cable and adapter.

Q3. Error message during operation.

Uninstall the application with an error message and download it to install again. You can also update certain applications with the error.

Q4. The tablet can't be detected by the computer.

Try another USB cable.
Connect your tablet to a different port on your PC.
Instead of Charge only, choose Media device(MTP) Or Camera(PTP) when connecting the tablet to the computer.

18

Q5. Device cannot connect to Wifi.

Make sure the Wifi on your tablet is ON.
Make sure you input the correct password

Restart the router.

Make sure there is no filtering setting or device connection limit in your router setting.

Forget the original Wi-Fi connection, reset the router, and connect again.

Q6. The storage space of the tablet is not enough.

Delete any applications you don't use.
Clean the caches in your device regularly.
Install a microSD card to expand the storage.

Q7. The tablet comes with scratches on the screen.

Check if the scratches are on the film, if yes, please remove the film.

Q8. The screen is unresponsive.

Check if the screen is dusty or greasy. If yes, please gently wipe the screen with a cloth.

Q9. How to use your voice to search for a fact?

Tap the microphone icon on Google Search bar, tell the tablet what you want to know and it will show you the search results.

19

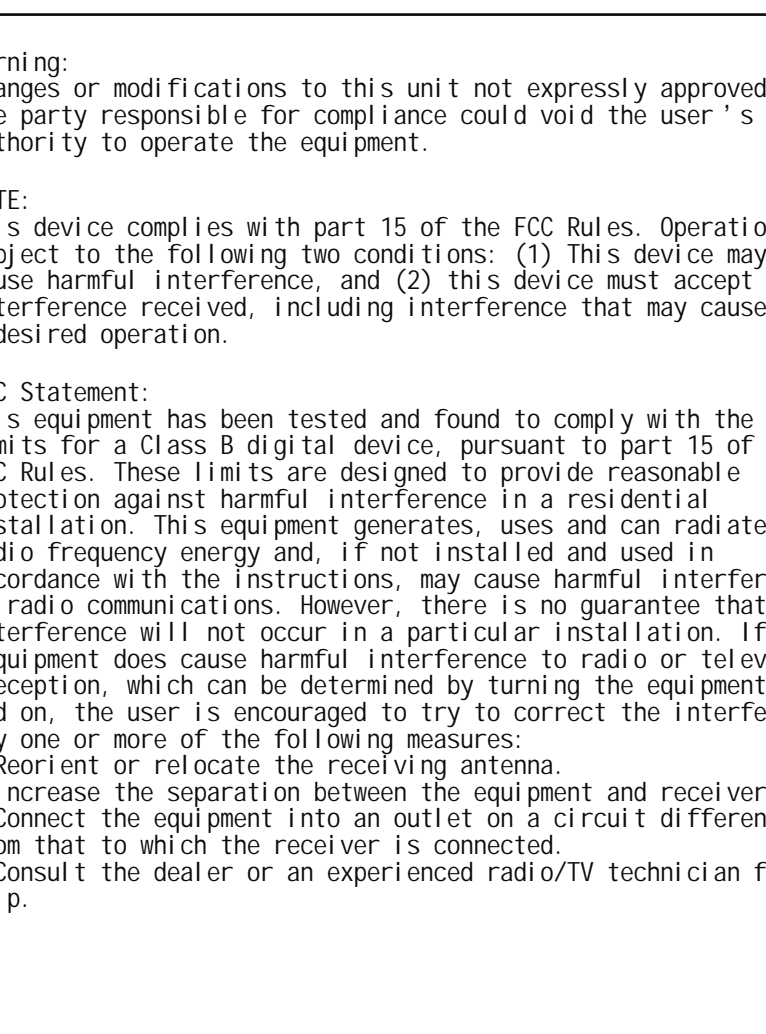

20