

BRUSHMO
Brushmo BM02
Instruction Manual

Introduction

Congratulations on your purchase and welcome to Brushmo! To fully benefit from the support that Brushmo offers, register your product at www.brushmo.com

Intended use

Brushmo electronic toothbrushes are intended to remove adherent plaque and food debris from the teeth to reduce tooth decay and improve and maintain oral health. Brushmo electronic toothbrushes are intended for consumer home use. Use by children should be with adult supervision.

Contents

- 1x Brushmo BM02 Handle
- 1x Brush Heads
- 1x Charger with USB Type-C
- 1x Power Adapter
- 1x Manual

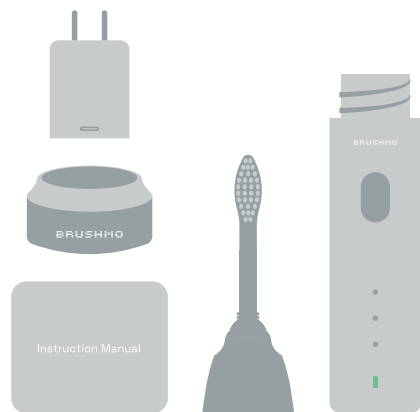

Getting Started

Attaching the brush head

1. Align the front of the brush head with the front of the toothbrush handle. Match the bars that are on the inside top of the removable nut with the notches inside the top of the handle and slide the brush head onto the handle.
2. Screw the brush head nut clockwise until it's firmly tightened. If the brush head rattles when in use, tighten the nut further.

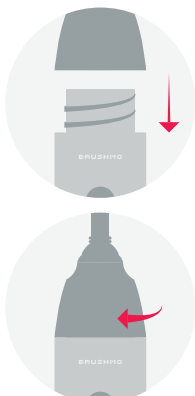

Charging your Brushmo toothbrush

1. Plug the USB Type-C charging cord into a wall adapter that is connected to an electrical outlet.
2. Place the handle on the charger.

The light of the battery level indicator illuminates. This indicates that the toothbrush is charging.

Note: It can take up to 13 hours to fully charge the battery, but you can use the toothbrush before it is fully charged.

Using your Brushmo toothbrush

If you are using your toothbrush for the first time, it is normal to feel more vibration than when using a non-electric toothbrush. It is common for first time users to apply too much pressure. Only apply gentle pressure and let the toothbrush do the brushing for you. Please follow brushing instructions below for the best experience.

Brushing Instructions

1. Wet the bristles and apply a small amount of toothpaste.
2. Place the toothbrush bristles against the teeth at a slight angle (45 degrees), pressing gently to make the bristles reach the gumline or slightly beneath the gumline.

Note: Keep the center of the brush in contact with the teeth at all times.

3. Press the power on/off button to turn on the Brushmo Toothbrush.
4. Gently keep the bristles placed on the teeth and in the gumline. Brush your teeth with small back and forth motion so the bristles reach between the teeth. Continue this motion throughout your brushing cycle.

Note: The bristles should slightly flare. It is not recommended to scrub as you would with a manual toothbrush.

5. To clean the inside surfaces of the front teeth, tilt the brush handle semi-upright and make several vertical overlapping brushing strokes on each tooth.

Note: To make sure you brush evenly throughout the mouth, divide your mouth into 4 sections using the Quadpacer feature.

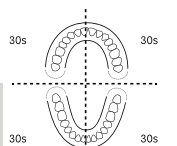

6. Begin brushing in section 1 (outside upper teeth) and brush for 30 seconds before you move to section 2 (inside upper teeth). Continue brushing in section 3 (outside lower teeth) and brush for 30 seconds before you move to section 4 (inside lower teeth).

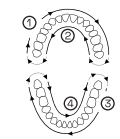

7. After you have completed the brushing cycle, you can spend additional time brushing the chewing surfaces of your teeth and areas where staining occurs. You can also brush your tongue, with the toothbrush turned on or off, as you prefer. Your Brushmo toothbrush should be safe to use on braces (brush heads wear out sooner when used on braces) and dental restorations (fillings, crowns)

If they are properly adhered and not compromised. If a problem occurs, please follow up with a dental professional.

Note: When the Brushmo toothbrush is used in clinical studies, the handle should be fully charged.

Battery Status

1. When handle is on a working charger.

Battery status	Battery indicator
Full	Solid green (turn off after 30 seconds)
Charging	Flashing

2. When handle is not placed on charger.

Battery status	Battery indicator
Full Battery	Solid green
Low Battery	Flashing red light

Note: To save energy, the battery light will turn off when not in use.

正反面 151 x 74

Modes

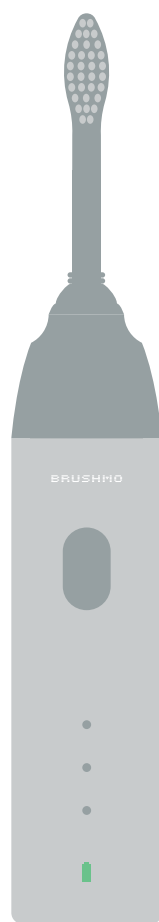

3 Modes:

Clean: For exceptional everyday clean

White: To remove surface stains

Gum Care: Special attention to molars

1. Press the power button to turn on the toothbrush.
2. Press a second time to switch modes.

Cleaning

You should clean your Brushmo toothbrush regularly to remove toothpaste and other residue. Failure to clean your toothbrush may result in an unhygienic product and damage to it may occur.

Warning: Do not clean product or accessories with sharp objects or in dishwasher, microwave, with chemicals or in boiling hot water.

Toothbrush handle

1. Remove the brush head and rinse the metal shaft area with warm water. Make sure you remove any residual toothpaste.

Caution: Do not push on the rubber seal on the metal shaft with sharp objects, as this may cause damage.

2. Wipe the entire surface of the handle with a damp cloth.

Note: Do not tap the handle on the sink to remove excess water.

Brush head

1. Rinse the brush head and bristles after each use.
2. Remove the brush head from the handle and rinse the brush head connection with warm water at least once a week. Rinse the travel cap as often as needed.



Charger

1. Unplug the charger before you clean it.
2. Wipe the surface of the charger with a damp cloth.

Storage

If you are not going to use the product for a long time, unplug it, clean it (see chapter "cleaning") and store it in a cool and dry place away from direct sunlight.

Replacement

Brush head

Replace Brushmo tooth brush heads every 3 months to achieve optimal results. Use only Brushmo replacement brush heads.

Disposal

- This product contains a rechargeable lithium-ion battery which must be disposed of properly.
- Contact your local town or city officials for battery disposal information. You can also call 1-800-822-8837 or visit www.call2recycle.org for battery drop-off locations.



IMPORTANT SAFEGUARDS

When using electrical products, especially when children are present, basic safety precautions should always be followed, including the following:

DANGERS

- To reduce the risk of electrocution:
- Do not place or store product where it can fall or be pulled into a tub or sink.
 - Do not place in or drop into water or other liquid.
 - Do not use while bathing.
 - Do not reach for a product that has fallen into water. Unplug immediately.
- After cleaning, make sure the toothbrush handle is completely dry before you connect it to the mains.

WARNINGS

If you've recently had surgery on your teeth or gums, consult your dentist before using the Brushmo toothbrush. If you experience excessive bleeding after using this device, please contact your dentist immediately. This toothbrush can be used by children and persons with reduced physical, sensory, or mental capabilities or lack of experience and knowledge if they have been given supervision or instruction concerning use of the appliance in a safe way and understand the hazards involved. Cleaning and user maintenance shall not play with the appliance. The toothbrush complies with safety

standards for electromagnetic devices. If you wear an implant or pacemaker and have questions about the device, please contact your doctor or the manufacturer of your implant or pacemaker.

SAFETY NOTE

Warning: For the purposes of re-charging the battery, only use the detachable supply unit provided with this appliance. This appliance contains batteries that are non-replaceable. Before using, please check that the voltage stated on the device complies with your local mains voltage. If the charger or connecting cable is damaged, please do not use or attempt to repair it yourself. The power cord cannot be replaced. If the cord is damaged, the entire device must be replaced. All repairs must be handled by a dealer or our customer service. Keep the charger away from water, and do not immerse in water or other liquids. Cleaning the charger: Disconnect from the mains before cleaning and reconnect only once the charger is completely dry. Never charge the device unattended.

ENVIRONMENTALLY FRIENDLY DISPOSAL

Do not dispose of this product with normal household waste at the end of its service life. Take it to a recycling center or official collection point. This helps protect the environment. The integrated rechargeable battery contains substances that may endanger the environment. So please take the used handset to an official recycling center or collection point.

BATTERY SAFETY INSTRUCTIONS

- Only use this toothbrush for its intended purpose and follow the general and battery safety instructions as described in this user manual. Any misuse can cause electric shock, burns, fire and other hazards or injuries.
- Charge, use and store the product at a temperature between 5 °C and 35 °C. To charge the battery, only use the USB cable provided with the product. Do not use an extension cord.
- Do not burn the toothbrush handle and its battery and do not expose them to direct sunlight or to high temperatures (e.g. in hot cars or near hot stoves). Batteries may explode if overheated.
- If the product becomes abnormally hot, gives off an abnormal smell, changes color or if charging takes much longer than usual, stop using and charging the

product and contact Brushmo customer service.

- Do not place the toothbrush handle and its battery inside microwave ovens or on induction cookers.
- This product contains a rechargeable battery that is non-replaceable. Do not open the toothbrush handle to replace the rechargeable battery.
- When you handle the battery to remove them during final product disposal, make sure that your hands, the product and the battery are dry.
- To prevent the battery from heating up or releasing toxic or hazardous substances, do not modify, pierce or damage the toothbrush handle and battery, and do not disassemble, short circuit, overcharge or reverse charge the battery.
- To avoid accidental short-circuiting of the battery after removal, do not let battery terminals come into contact with metal object (e.g. coins, hairpins, rings). Do not wrap the battery in aluminum foil. Tape battery terminals or put the battery in a plastic bag before you discard it.
- If the battery is damaged or leaking, avoid contact with the skin or eyes. If this occurs, immediately rinse well with water and seek medical care.

BATTERY SAFETY INSTRUCTIONS

Within the EU, this symbol indicates that this product must not be disposed of with household waste. Old appliances contain valuable recyclable order materials. They should be recycled to prevent harm to the environment or human health through improper waste disposal. Therefore, please dispose of old devices through a proper collection system or send the device back to where you purchased it for proper disposal. They will then ensure that the device is recycled accordingly.

BRUSHMO
Since 2009

This device complies with part 15 of the FCC Rules. Operation is subject to the following two conditions: (1) This device may not cause harmful interference, and (2) this device must accept any interference received, including interference that may cause undesired operation.

Any Changes or modifications not expressly approved by the party responsible for compliance could void the user's authority to operate the equipment.

Note: This equipment has been tested and found to comply with the limits for a Class B digital device, pursuant to part 15 of the FCC Rules. These limits are designed to provide reasonable protection against harmful interference in a residential installation. This equipment generates uses and can radiate radio frequency energy and, if not installed and used in accordance with the instructions, may cause harmful interference to radio communications. However, there is no guarantee that interference will not occur in a particular installation. If this equipment does cause harmful interference to radio or television reception, which can be determined by turning the equipment off and on, the user is encouraged to try to correct the interference by one or more of the following measures:

- Reorient or relocate the receiving antenna.
- Increase the separation between the equipment and receiver.
- Connect the equipment into an outlet on a circuit different from that to which the receiver is connected.
- Consult the dealer or an experienced radio/TV technician for help.
- This equipment complies with FCC radiation exposure limits set forth for an uncontrolled environment. This equipment should be installed and operated with minimum distance 20cm between the radiator & your body.