

# Quick Start

## Step 1: Power On

Press-and-hold the mode button and the volume up button.



## Step 2: Preparing

After powering on, the device defaults to the Bluetooth mode. Click the mode button once to switch to the Intercom mode.



## Step 3: Networking

Click the mode button twice on one of the devices to start the networking process. You will hear "enter networking mode", wait for a while and hear "networking successful".

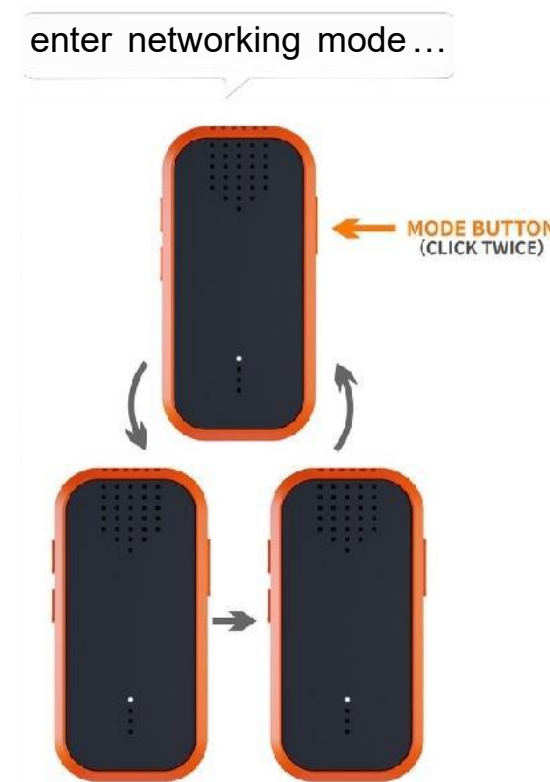

# Connect with Others

## Join a Group

To group with others, after finishing the step 2, then hold the new device near each other, and hold one of the device that is already connected and click the mode button twice until you hear "enter networking mode", wait for a while and hear "networking successful".

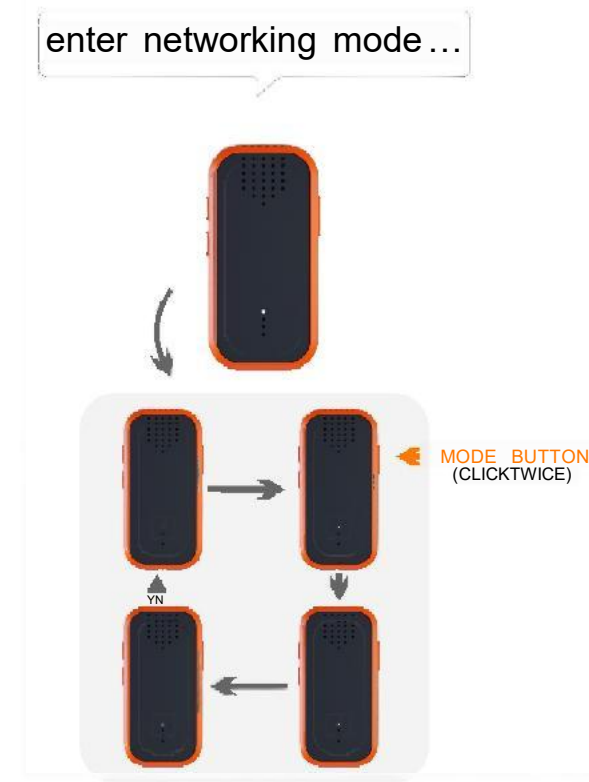

## Leave a Group

### Method 1: Power off

Press-and-hold the mode button and the volume up button.

### Method 2: Switch mode

Click the mode button to the Bluetooth mode. If you want to get back the group, you can switch over the Intercom mode.



## Clear the Networking Information

In Intercom mode, press-and-hold the mode button and the volume down button. You will clear the information about the current networking device. If you want to connect them again, you need to start from the step 1.



# Other Function

## Mute Mode

Press-and-hold the mode button for 2 seconds to enter mute mode until you hear “mute on”.Repeat the operation to cancel mute mode until you hear“mute off”



## Bluetooth Mode

Click the mode button once until you hear“Bluetooth mode”.You can connect the device to your phone and play music as a portable speaker.

### One-click the mode button:

Answer a call/hang up a call

### Double-click the mode button:

Reject a call

### Clear the Bluetooth Information

In Bluetooth mode,Press-and-hold the mode button and volume down button for 2 seconds



# Success Tips

## Not on the Same Group

Due to a false touch,multiple devices are networked separately and cannot be connected in one group.You need to clear the networking information for each device and start from the step 1.

## Unsuccessful Connection?

Please power it off (Press-and-hold the mode button and the volume up button at the same time)and try again.

## Can't hear the sound after the networking is successful?

After the networking is successful,if you can't hear the sound within 3 meter, you'll need to stay away from your partner to make a normal call.Because we did the noise cancellation function.

# Feature&Controls



## Charging

Use a USB-C cable to charge from any power adapter.

- Still charging
- Fully charged

Customer Support:pobovisupport@szelu.cn

This device complies with part 15 of the FCC Rules. Operation is subject to the following two conditions: (1) This device may not cause harmful interference, and (2) this device must accept any interference received, including interference that may cause undesired operation.

FCC warning:  
Any Changes or modifications not expressly approved by the party responsible for compliance could void the user's authority to operate the equipment.

Note: This equipment has been tested and found to comply with the limits for a Class B digital device, pursuant to part 15 of the FCC Rules. These limits are designed to provide reasonable protection against harmful interference in a residential installation. This equipment generates uses and can radiate radio frequency energy and, if not installed and used in accordance with the instructions, may cause harmful interference to radio communications. However, there is no guarantee that interference will not occur in a particular installation. If this equipment does cause harmful interference to radio or television reception, which can be determined by turning the equipment off and on, the user is encouraged to try to correct the interference by one or more of the following measures:  
-Reorient or relocate the receiving antenna.  
-Increase the separation between the equipment and receiver.  
-Connect the equipment into an outlet on a circuit different from that to which the receiver is connected.  
-Consult the dealer or an experienced radio/TV technician for help.

The device has been evaluated to meet general RF exposure requirement. The device can be used in portable exposure condition without restriction.



The Wetalk-Air has been tested for body-worn Specific Absorption Rate (SAR) compliance. The FCC has established detailed SAR requirements and has established that these requirements. RF Exposure Information The radio module has been evaluated under FCC Bulletin C95.1 and IEEE 1528 and found to be compliant to RF Exposure from radio frequency devices. This model meets the applicable government requirements for exposure to radio frequency waves. The highest reported SAR level for usage near the body (0mm) is 0.815W/kg, and for the simultaneous transmission is 0.815W/kg