

14+ AGES

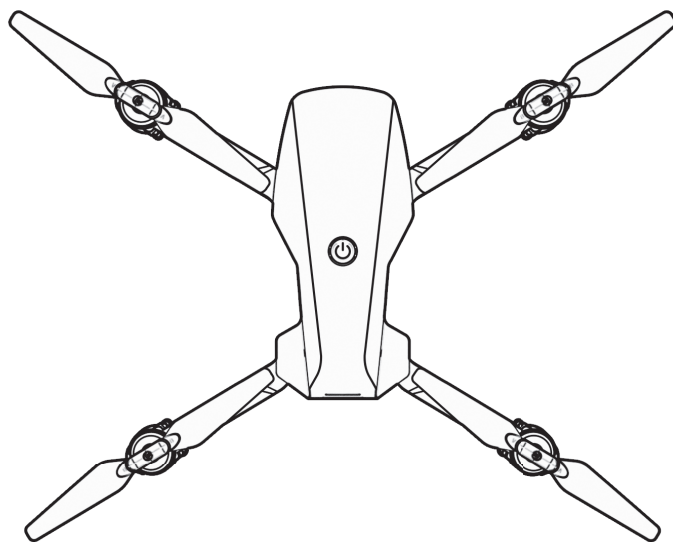

FOLDING DRONE

USER MANUAL

Thank you for choosing our products. Please read this manual carefully before operating. Please keep this manual for future reference. Please refer to the actual object, if the picture does not match the actual object.

SAFETY PRECAUTIONS AND STATEMENTS

- This product is suitable for people over the age of 14. Please ensure that you operate in a safe environment, Please be sure to use it correctly in strict accordance with safety precautions and the Operation Manual. Please note that any modification, disassembly, or improper use may cause unexpected hazards or accidents.
- The company is not responsible for improper assembly by users, unsafe environment, unauthorized modification, disassembly, and other illegal operations.
- This product is a high-tech operational consumable, so any disassembly or modification may cause damage to the components. If any improper operation causes problems with the product, it will not be possible to replace or return the product within the warranty conditions. If there are problems with use, operation, and maintenance, our agent or after-sales service will provide technical guidance and special price parts supply services.
- Drones are dangerous goods. When flying, be sure to stay away from people and obstacles, and operate within a safe distance (more than 4 meters). Improper assembly, damage to components, poor electronic control equipment, and improper operation can lead to unpredictable damage and accidents caused by uncontrolled flight. Pilots must pay attention to flight safety and understand flight requirements and responsibilities in detail.
- This product is suitable for indoor and outdoor use. It is strictly prohibited to fly it in areas with dangerous high-voltage electricity and prohibited by the state.
- When this product is not used for a long time, please turn off the power supply and take out the battery to prevent danger from battery leakage.

MAINTENANCE

- Frequently use a clean soft cloth to clean this product.
- Avoid exposing this product to sunlight or heat.
- Do not immerse this product in water, otherwise its electronic parts will be damaged.
- Regularly check the plug and other accessories. If any damage is found, please immediately stop using it until it is completely repaired.

The company reserves the final interpretation right of this manual

CONTENTS

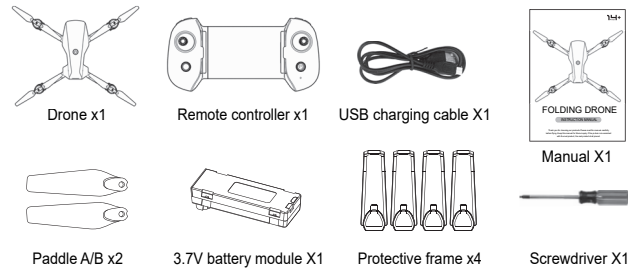

INTRODUCTION TO DRONE PARTS AND REMOTE CONTROLLER

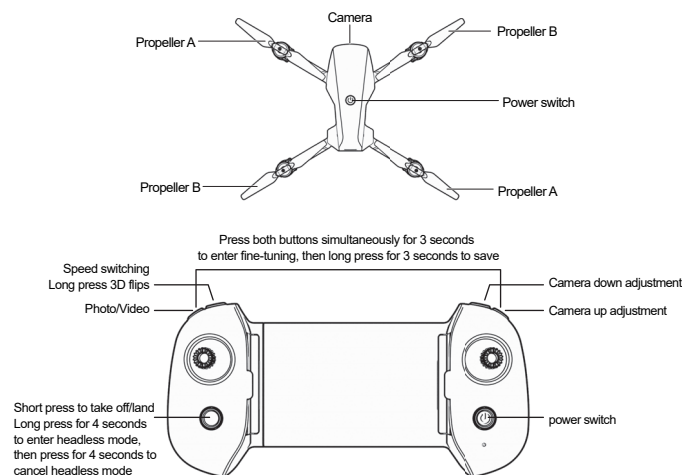

-1-

Propeller Replacement Method

- Please ensure that all propellers are installed in the correct orientation as shown in the following figure. If the installation is incorrect, the aircraft will not be able to fly normally. (Figure 1)
- Installed. (Figure 2)

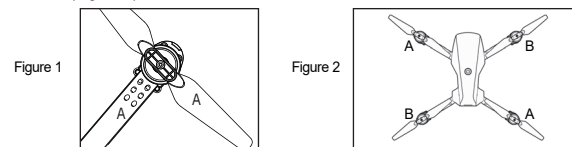

INSTALLATION METHOD OF PROPELLER GUARD

- Install the Propeller guard at the bottom of the motor frame.

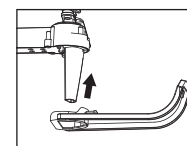

REMOTE CONTROLLER'S BATTERY INSTALLATION

When charging, the red light is always on; when fully charged, it goes off

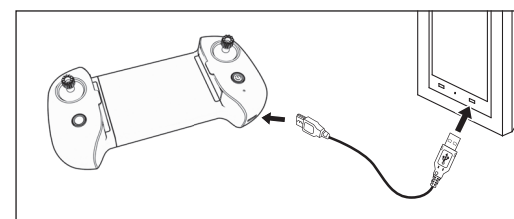

-2-

DRONE BATTERY INSTALLATION

- Install the battery module into the battery holder of the drone in the direction shown in the figure to a fixed position. (Figure 1)
- Installed. (Figure 2)

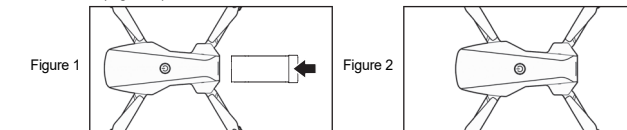

BATTERY CHARGING

- Connect one end of the USB charging cable to the adapter power port, and then connect the other end to the battery charging port. When charging normally, the battery socket port indicator light remains on for a long time.
- When charging, the red light is always on; when fully charged, it goes off (charging time is about 120 minutes).

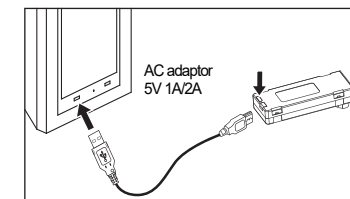

CHARGING PRECAUTIONS

- Do not place the battery in high temperatures or heated places, such as open flames or electric heating devices, otherwise it may be damaged or explode.
- Do not hit the battery or use it to hit the surface of hard objects.
- Do not disassemble the battery.
- Do not immerse the battery in water. The battery should be stored in a dry place.
- Do not leave when charging.
- Do not place the battery on flammable items such as blankets for charging.
- Do not charge the battery when it heats up after the drone running.
- Please use the original USB charging cable to charge the battery.

-3-

READY TO FLY

POWER ON / FREQUENCY ALIGNMENT

- Place the drone on a horizontal surface, turn on the drone power switch, and the lights flash. The drone is now in standby mode.

Note: The tail of the aircraft shall face the pilot.

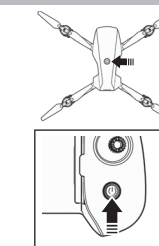

- Turn on the power switch of the remote control and wait for automatic frequency synchronization. After the remote control emits a beep sound, it indicates successful frequency synchronization. At this time, the aircraft lights will remain on.

HORIZONTAL CALIBRATION

Move the left and right control sticks of the Remote control left and right joysticks simultaneously move to the lower left and lower right corners, and the drone light will flicker to a constant light. At the same time, after the buzzer of the remote controller beeps, the horizontal calibration is completed

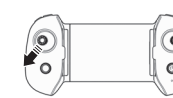

START THE DRONE

Method 1:

- Step 1: Move the remote controller's left control stick at 45° to the left and right control stick at 45° to the right, the propellers slowly rotate, and the drone unlocking is completed.

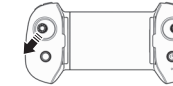

Step 2:

- After the drone is unlocked, push the left control stick of the remote controller upward, and the propellers accelerate to rotate and fly off the ground.

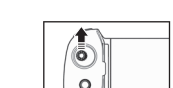

Method 2:

- When the drone is in a stationary state after completing frequency alignment and horizontal calibration, press the "One Press Takeoff" button on the remote controller. After the drone propellers rotate slowly, it automatically rises to a height of about 1.2 meters and hovers.

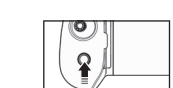

-4-

SHUT DOWN THE DRONE

- Method 1: Push the left control stick of the remote controller to the lowest position for 2-3 seconds, and then the drone shutdown.
- Method 2: When the drone is in flight, press the "One Press Landing" button, and the drone slowly descends to the ground and shut down the drone.

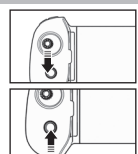

FLIGHT OPERATION MANUAL

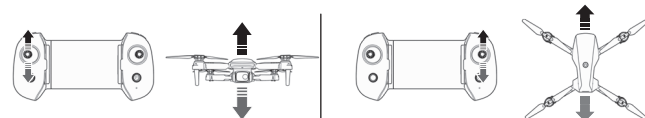

Push the left control stick upward, and the drone rises; Push the left control stick downward, and the drone descends.

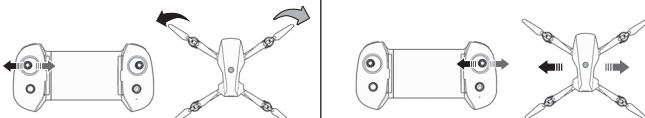

Push the left control stick to the left, and the drone rotates to the left; Push the right control stick to the right, and the drone moves to the right.

CAMERA ANGLE CONTROL

The shooting angle of the PTZ camera can be adjusted through the up or down button of the remote control steering gear. (as shown in the figure)

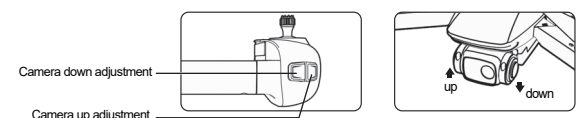

-5-

ONE PRESS TAKEOFF/LANDING

- After unlocking the drone, press the "One Press Takeoff" button on the remote controller, and the drone will automatically rises to a height of about 1.2 meters and hovers.
- When the drone is flying at high altitude, press the "One Press Landing" button on the remote controller, and the drone will slowly land. During the descent process you can control the drone to land at a designated location through the right control stick and the propellers will stop rotating.

HIGH AND LOW SPEED SWITCHING

During flight, you can press this function key to switch between forward, backward, left, and right flight speeds. The default setting when powering on is in low speed gear. Press this function key once to switch to medium speed gear, and the remote controller buzzer emits two "tick" sounds. Press this function key again to switch to high speed gear, and the remote controller buzzer emits three "tick" sounds. Press this function key again to switch back to low speed gear, and the remote controller buzzer emits one "tick" sound.

360° FLIP

Long press the "360° Flip" button, and the remote controller buzzer emits a "tick" sound. Push the right control stick and the drone rolls in the direction of the push. At the same time, the sound disappears, the drone enters the normal mode.



Note: When the battery is fully charged, the rollover effect is best. Unable to roll when under low power.

LOW POWER MODE

During flight the drone indicator light flashes slowly or the remote controller continuously emits drip sounds, indicating low battery power and the need to end the flight. Flying with low power can cause the drone to fall out of control and damage.

-6-

HEADLESS MODE

When the drone is taking off, the remote controller must be facing the tail of the drone. After the takeoff is completed, long press 4 seconds the remote controller "Headless Mode" button to enter the Headless Mode. The drone lights flash, Press the Headless Mode button again to exit the Headless Mode.

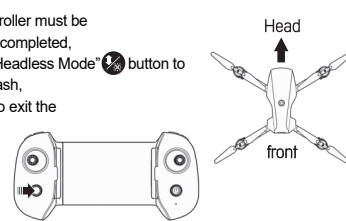

Note: When the direction of the remote controller changes, it is necessary to recalibrate the drone.

REMOTE CONTROL PHOTO AND VIDEO RECORDING

- Short press the remote controller photo button and the indicator light behind the drone quickly flashes.
- press and hold the remote control's capture button. The drone's rear light will flash twice, indicating that the drone has entered recording mode. Press and hold the capture button again; if the drone's rear light flashes twice and then remains steady, it means the drone has exited recording mode.

NOTE

- Remote control distance: 80-100 meters. The drone beyond this distance will not be subject to remote control. The drone is not equipped with a GPS locator and cannot return automatically beyond the remote control range. The Auto Return function provided by this drone needs to be within the remote control range for normal operation.
- Video transmission distance: 50 meters. Beyond this distance, the drone will not be able to transmit back the video.
- It is recommended to install propeller guards when using it otherwise multiple severe collisions may cause damage or insensitive response of to the drone resulting in inability to fly normally.

-7-

OVERHAUL PROCEDURE

Problem	Reason	Solution
The drone doesn't respond	1. The drone enters the low electric protection mode. 2. The remote controller battery is low, and the power indicator blinks.	1. Charge the drone. 2. Replace the remote battery.
The drone is not responsive	1. The remote controller has low power. 2. Remote controllers with the same frequency are transmitting interference.	1. Replace the battery. 2. Change to a place where there is no interference of the same frequency.
Fly sideways while hovering	1. Horizontal calibration is not performed.	1. Perform horizontal calibration again, see page 4 (Horizontal Calibration)
Deviation from straight ahead direction under Headless Mode	1. Deviation caused by multiple collisions.	1. Redefine the front direction, see "Headless Mode" on page 7 for details
Unstable height setting/ up and down movement	1. Horizontal calibration is not performed. 2. The atmospheric pressure is unstable under severe weather conditions. 3. Severe collision causes gyroscope data disorder.	1. Perform horizontal calibration again, see page 4 (Horizontal Calibration) 2. Try to avoid flying under severe weather conditions. 3. Perform horizontal calibration again, see page 4 (Horizontal Calibration)

Warm Tips

Lifetime Support and 24-hour customer service
Email: support@anzdrone.com
Contact us by Amazon for a Replacement or Refund if you receive the item with the defect. We apologize for any inconvenience caused and we will provide you with 100% assistance. Welcome to scan the QR code below to check the product information.



-8-

APP

Scan the QR code below or search "RADXFly" in the APP Store or Google Play to download the App.



Google play

For Smart Phone with Android 6.0+: Search and download "RADXFly" from Google Play. Or scan the QR code below to download.

App Store

For Smart Phone with IOS 11.0+: Search and download "RADXFly" from the App Store. Or scan the QR code below to download.

Connect to the APP:

- Turn on the drone.
- Enter the "Settings" menu of your mobile device.
- Then turn on "WiFi" and connect to the WiFi of "RADCLO_X-28_XXXXXX".
- Open the App, and you will see the real-time video from the drone camera, now you can start your flight!

Note: When using this APP for the first time, please disconnect the phone from the drone and use the data network or wifi to log in. Data network or wireless wifi is required to log in to the "TUTORIAL" page, please disconnect the mobile phone from the drone first.

-9-

This equipment has been tested and found to comply with the limits for a Class B digital device, pursuant to part 15 of the FCC Rules. These limits are designed to provide reasonable protection against harmful interference in a residential installation. This equipment generates, uses and can radiate radio frequency energy and, if not installed and used in accordance with the instructions, may cause harmful interference to radio communications. However, there is no guarantee that interference will not occur in a particular installation. If this equipment does cause harmful interference to radio or television reception, which can be determined by turning the equipment off and on, the user is encouraged to try to correct the interference by one or more of the following measures:

- Reorient or relocate the receiving antenna.
- Increase the separation between the equipment and receiver.
- Connect the equipment into an outlet on a circuit different from that to which the receiver is connected.
- Consult the dealer or an experienced radio/TV technician for help.

Caution: Any changes or modifications to this device not explicitly approved by manufacturer could void your authority to operate this equipment. This device complies with part 15 of the FCC Rules. Operation is subject to the following two conditions:

(1) This device may not cause harmful interference, and (2) this device must accept any interference received, including interference that may cause undesired operation. This equipment complies with FCC radiation exposure limits set forth for an uncontrolled environment. This equipment should be installed and operated with minimum distance 0cm between the radiator and your body.