

1

## Network Configuration 3: Click the "+" sign to add a device

Note: Please see a flashing red light before proceeding with this step

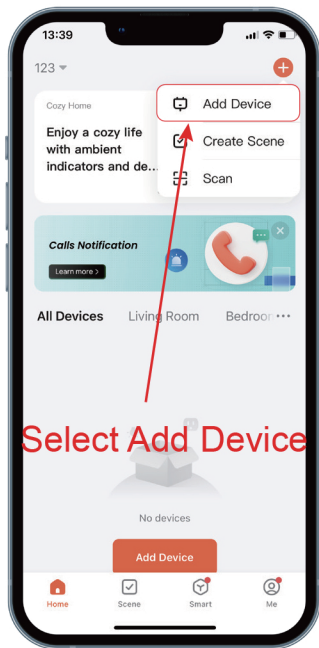
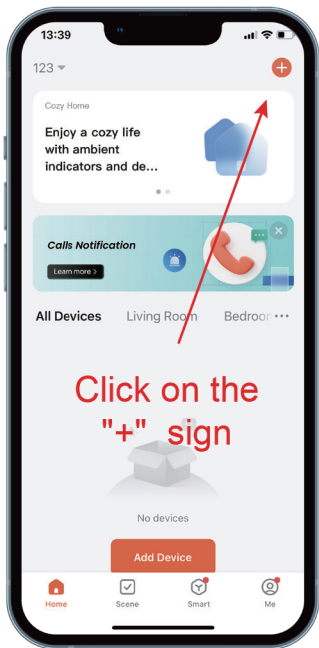

# 2

## Network Configuration 3: Choose Lighting and Click Strip Lights(BLE+Wi-Fi)

Choose Lighting

Click Strip Lights(BLE+Wi-Fi)

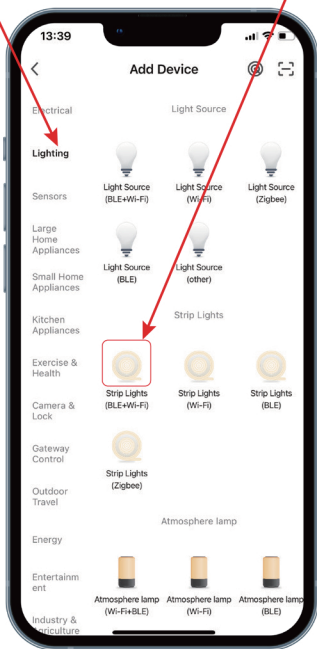

# 3

## Network Configuration 3:

Follow the instructions in the image(1)

(1)

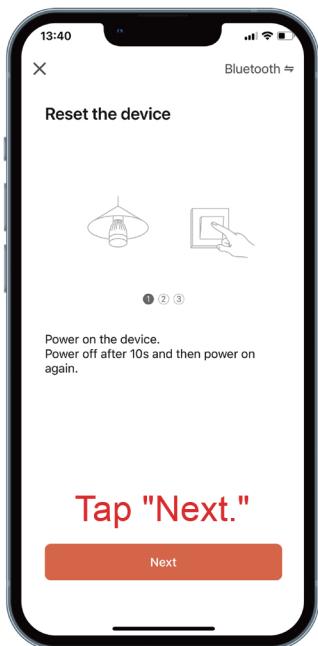

(2)

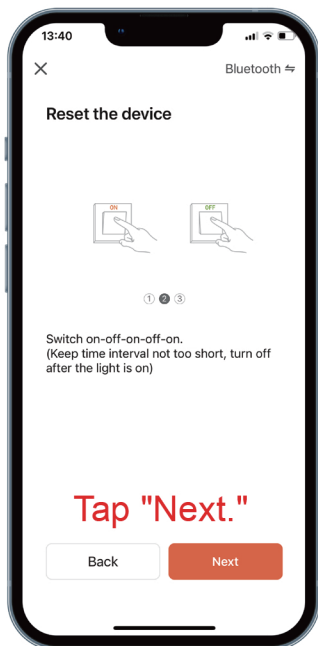

4

## Network Configuration 3:

Follow the instructions in the image(2)

(3)

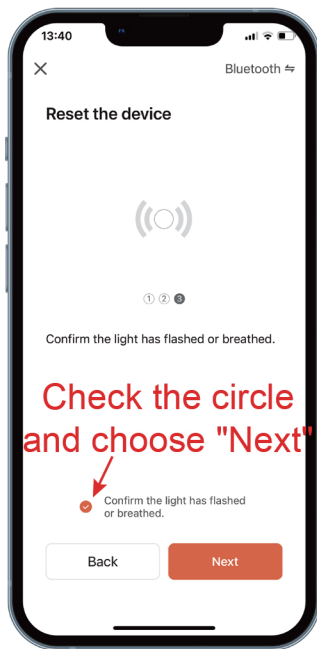

5

## Network Configuration 3: Input your wi-fi password and wait seconds to pair

### Your Home/Office Wi-Fi Name and Password

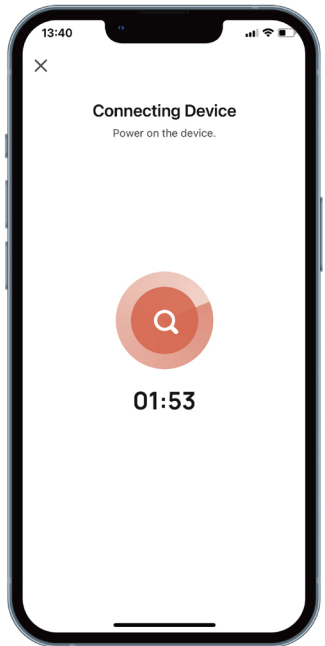
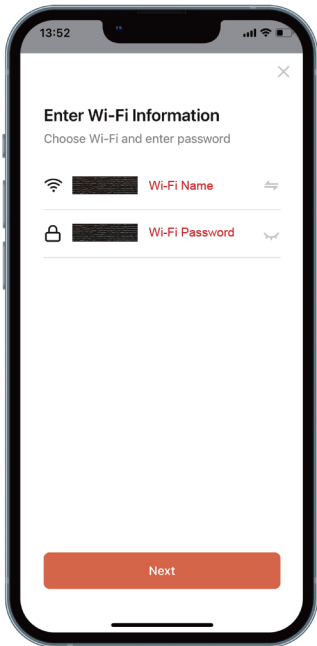

6

Network Configuration 3:  
Currently matching Wi-Fi, Wait 5  
seconds to complete matching

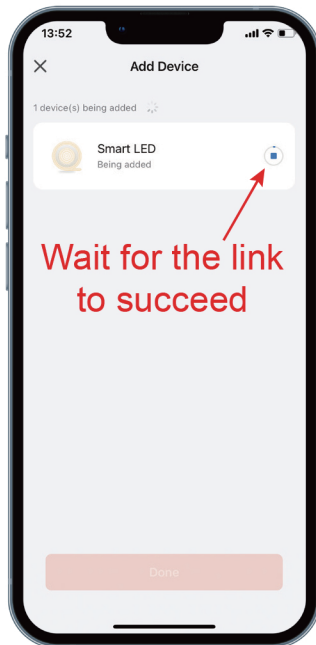

# 1 Combination equipment: Create light group

Click on the upper right corner to edit

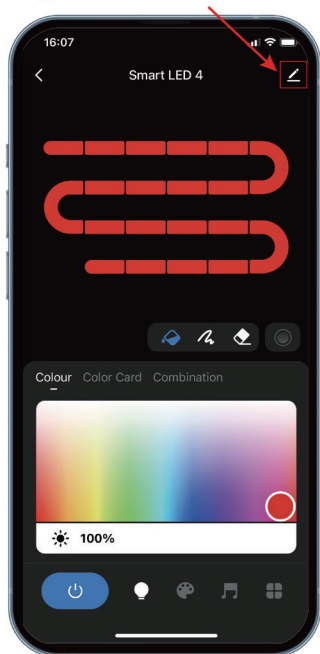

click create group

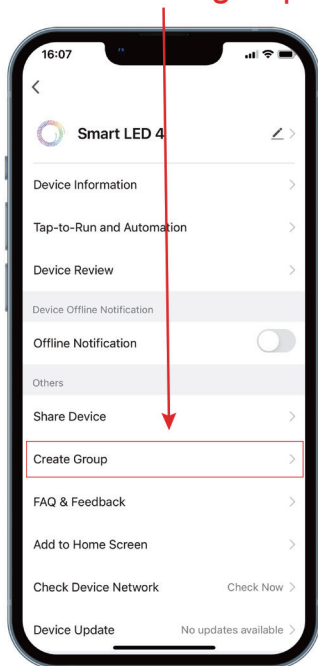

## 2 Combination equipment: Add all devices(1)

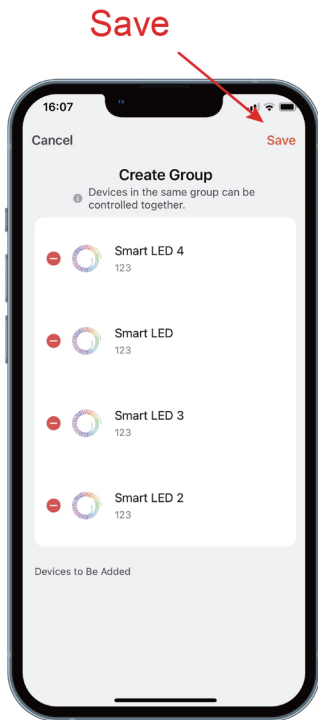
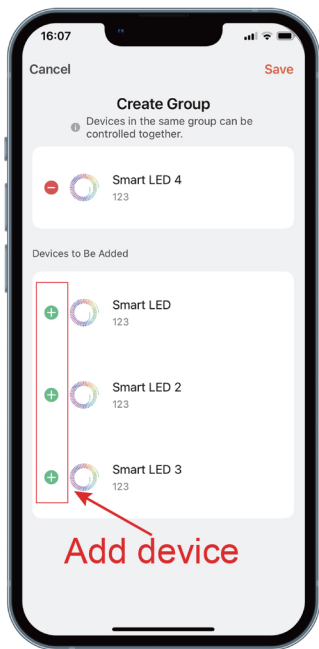



# 3 Combination equipment: Add all devices(2)

Enter the light group name and confirm

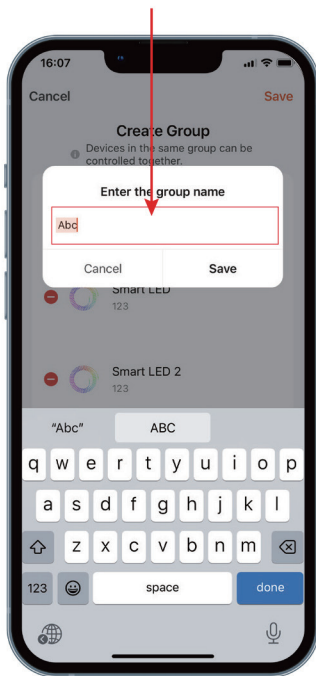

4

## Combination equipment: Light strip adaptation and control

Please click to set your  
strip length

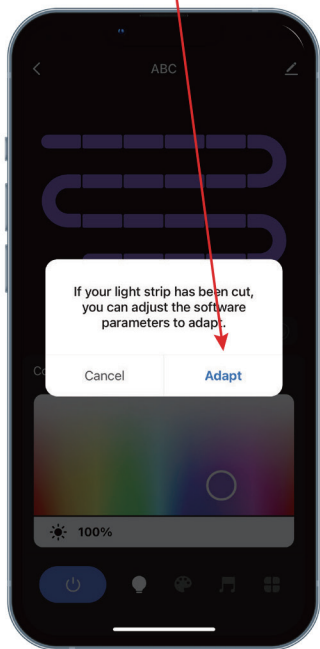

Click on the light  
group name to control

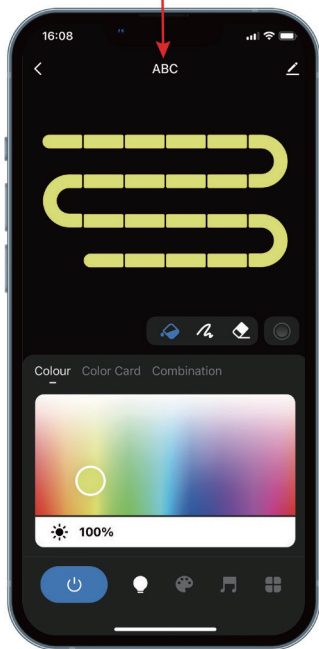

# 1

## DIY mode tutorial: Add DIY mode

Add DIY mode

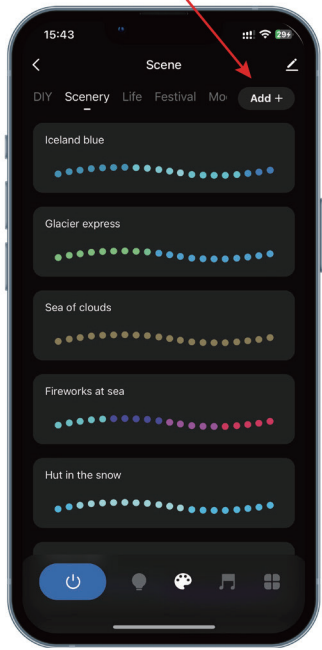
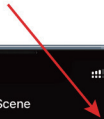

Change the color

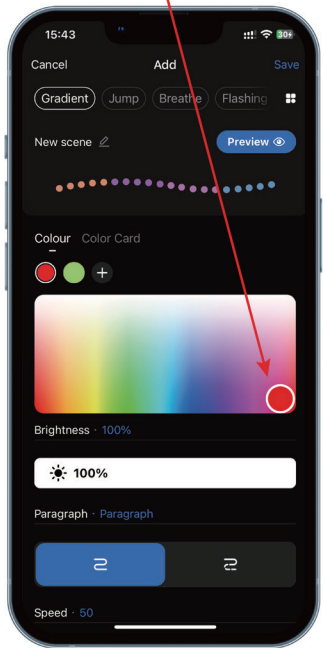

# 2

## DIY mode tutorial: Add patterns as well as colors

Click to expand mode selection

Add color

Selectable mode

Save

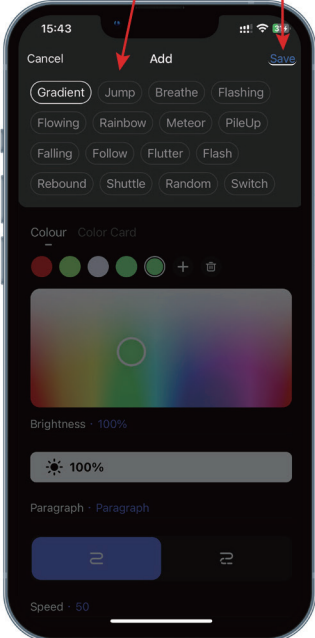
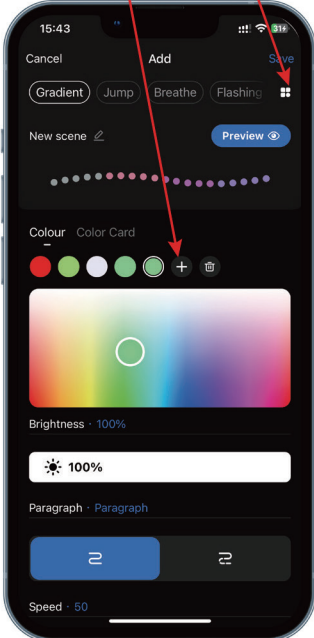

**Make your life colorful**

FCC Warning:

This equipment has been tested and found to comply with the limits for a Class B digital device, pursuant to part 15 of the FCC Rules. These limits are designed to provide reasonable protection against harmful interference in a residential installation. This equipment generates, uses and can radiate radio frequency energy and, if not installed and used in accordance with the instructions, may cause harmful interference to radio communications. However, there is no guarantee that interference will not occur in a particular installation. If this equipment does cause harmful interference to radio or television reception, which can be determined by turning the equipment off and on, the user is encouraged to try to correct the interference by one or more of the following measures:

- Reorient or relocate the receiving antenna.
- Increase the separation between the equipment and receiver.
- Connect the equipment into an outlet on a circuit different from that to which the receiver is connected.
- Consult the dealer or an experienced radio/TV technician for help.

Caution: Any changes or modifications to this device not explicitly approved by manufacturer could void your authority to operate this equipment.

This device complies with part 15 of the FCC Rules. Operation is subject to the following two conditions:

(1) This device may not cause harmful interference, and (2) this device must accept any interference received, including interference that may cause undesired operation.

This equipment complies with FCC radiation exposure limits set forth for an uncontrolled environment. This equipment should be installed and operated with minimum distance 20cm between the radiator and your body.