

5. Here we take the material library as an example, select a material and drag it into the canvas.
6. Adjust the material size and image properties according to your needs.
(The vector image does not have an image property adjustment bar)
7. Set the marking parameters, select red and blue light, as well as power and speed according to different materials.
(Note: bitmaps can only set the dotting time, while vector images can set the speed)

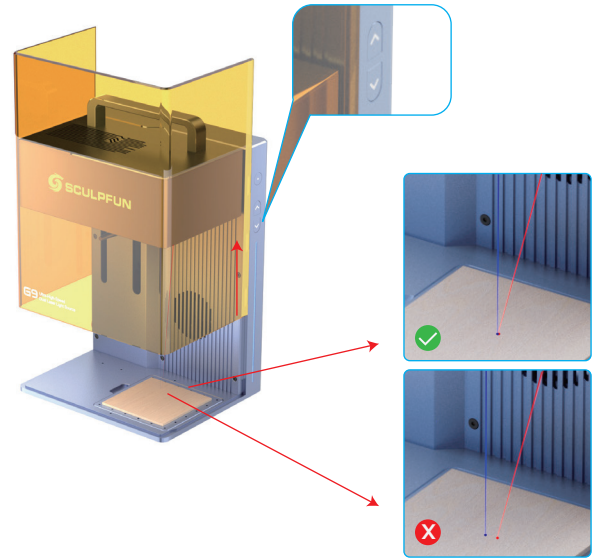

8. Click to focus, and adjust the machine height according to the focus dual light so that the two points coincide.
(Engraving materials of different heights requires refocusing)

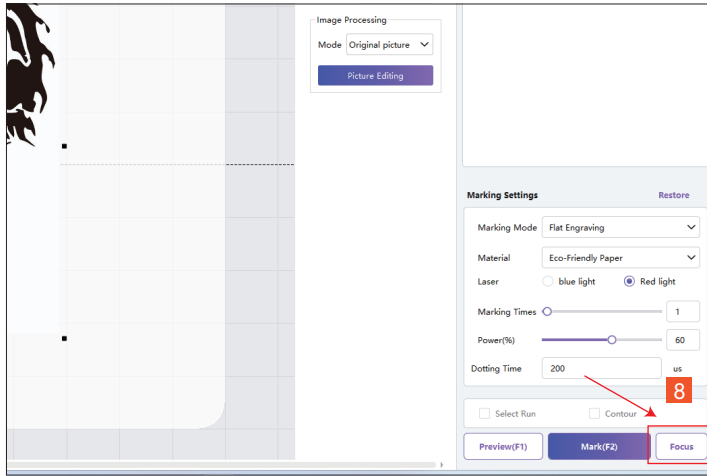
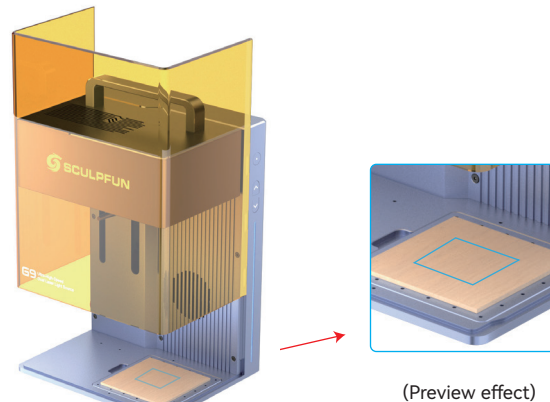
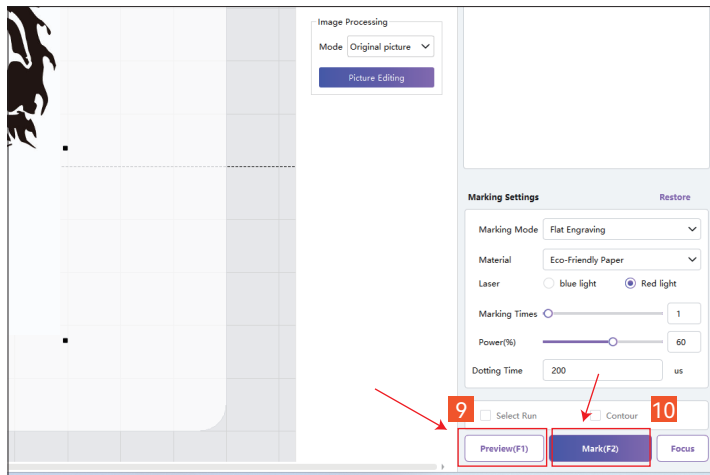

9. Click "Preview" to confirm the engraving position. You can adjust the position of the engraving objects or resize pattern.

10. After everything is OK, place the cover back on, click "Mark", and start engraving the material.

11

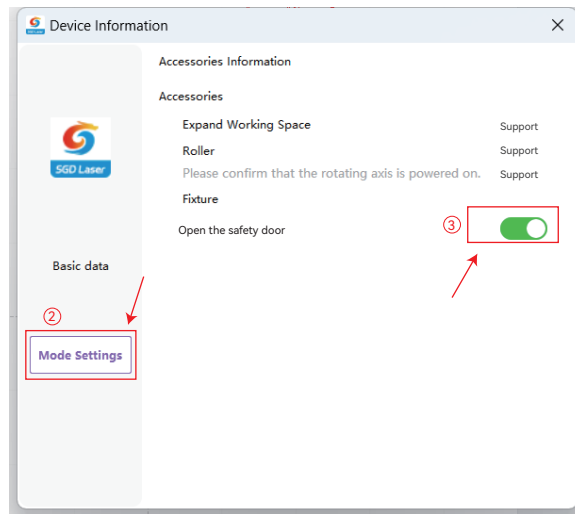
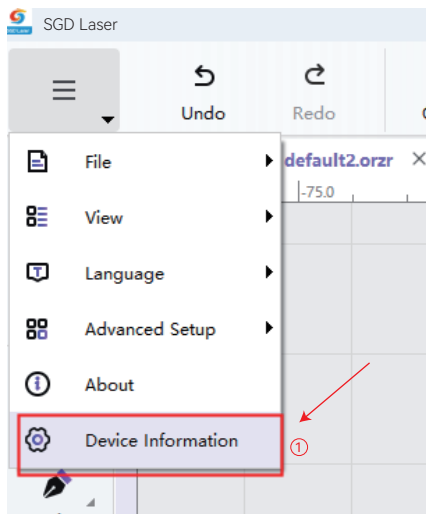

QR code

11. If it prompts that the safety door is open and cannot be engraved, you can close the safety door in the settings and continue engraving.

12. For more detailed usage tutorials, please scan the QR code to learn more.

If you want to remove the cover and engrave larger materials, you can close the safety door in the settings and continue engraving. (Note: Engraving without using the machine cover may cause laser leakage, so be sure to wear blue light blocking glasses when operating)

Using mobile apps

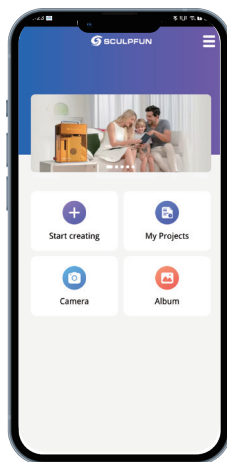

Software interface



QR code

After connecting the G9 to SGD Laser, you can start creating work content.
For detailed information on how to use the software to operate the G9 for material processing,
please scan the QR code to learn more.



Caution—use of controls or adjustments or performance of procedures other than those specified herein may result in hazardous radiation exposure.

Using mobile apps-Basic Operations



iOS



Android

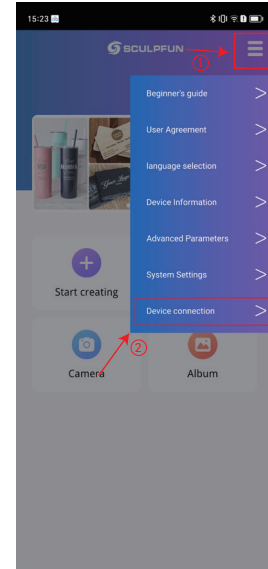
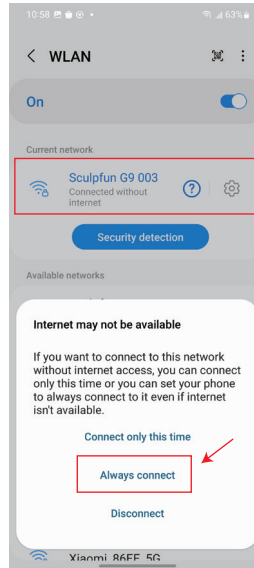

1. Download the "SGD Laser" app: Scan the QR code and turn on the G9.
2. Connect to G9 Wi-Fi:
 - Enable Wi-Fi on your phone.
 - Connect to "Sculpfun-G9 XXXX" using password: 12345678.
 - Maintain Connection: Select "Always connect."
3. In the App: Go to the main interface and select "Device Connection" in the settings.

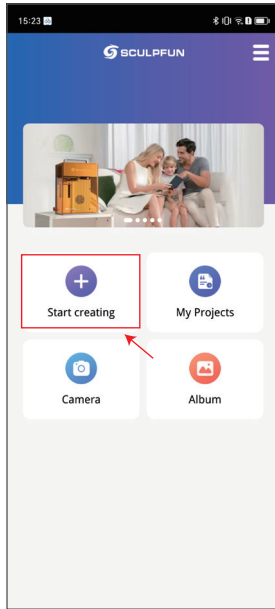

4

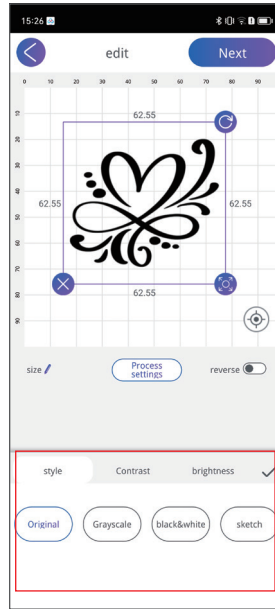

5

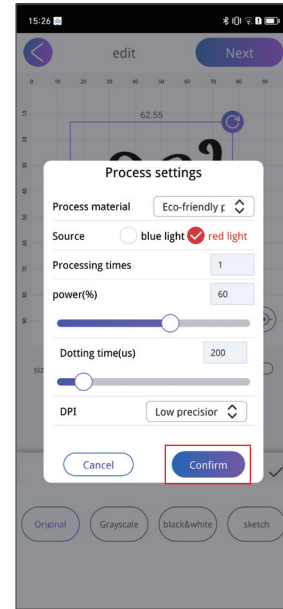

6

4. Create a New File and Select a Material. For this example, we'll use the material library.
 5. Adjust Material Size and Image Properties. Modify the material size and image properties as needed.
 6. Set Marking Parameters:
 - Choose the marking parameters, such as red and blue light, power, and speed, based on the material.
 - Click "Next" after completing the settings.
- (Note: Bitmap files can only have the dotting time adjusted, while vector files allow you to set both speed and other parameters)

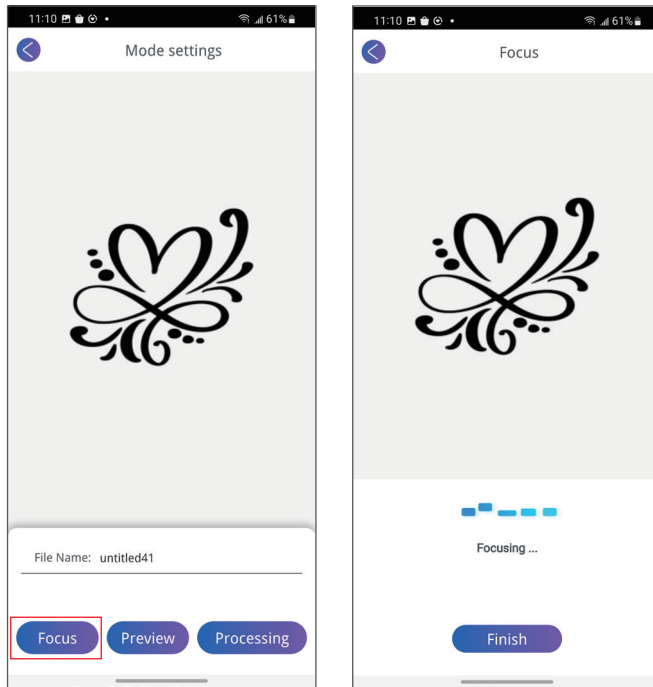

7

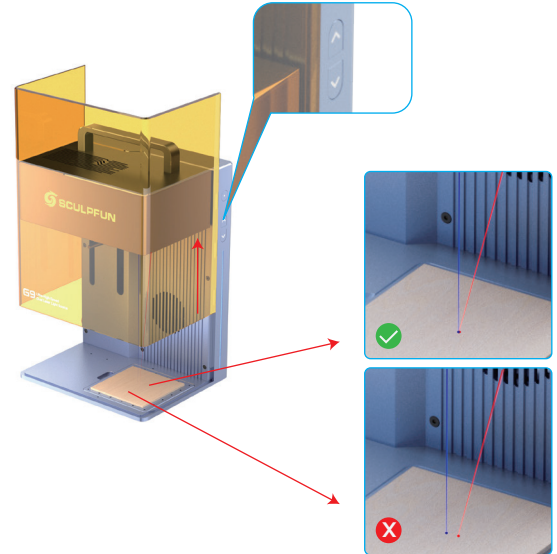

7.Focus the laser:

- Click the focus button.
- Adjust the machine height until the two focus points overlap.

(Note: For engraving materials of different heights, you will need to refocus the machine.)

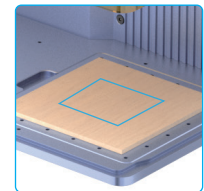
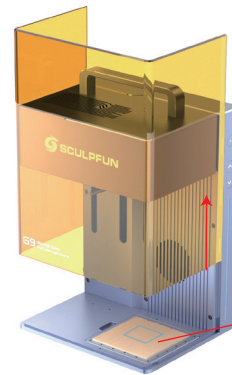
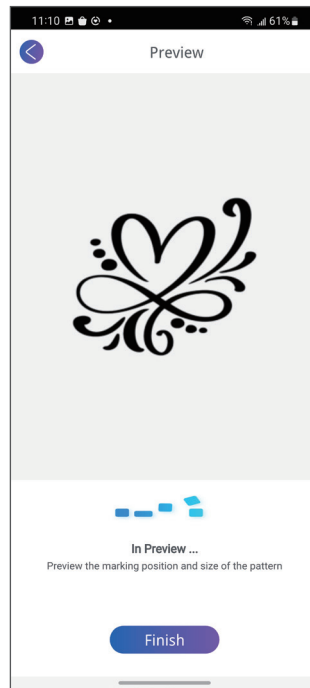

(Preview effect)

8. Click "Preview" to Confirm the Engraving Position:

- The machine will display the engraving area on the object.
- Adjust the position of the engraving object or resize the engraving pattern if needed.

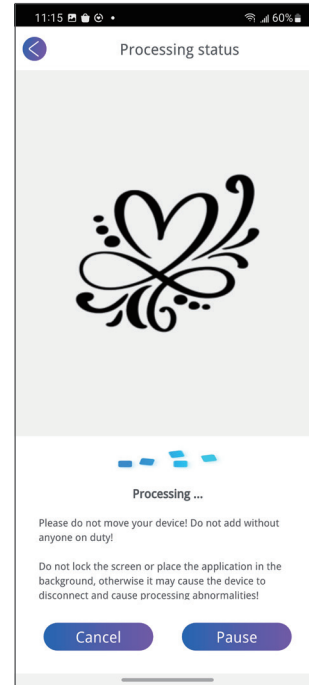
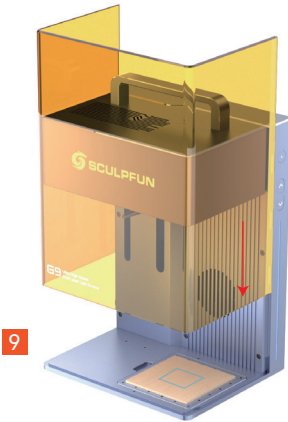

9. Once everything is set up, close the cover, click "Processing," and begin the engraving process.

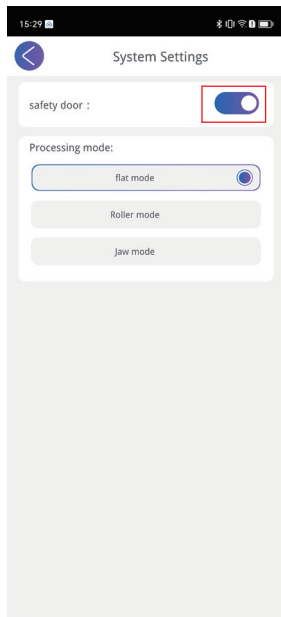
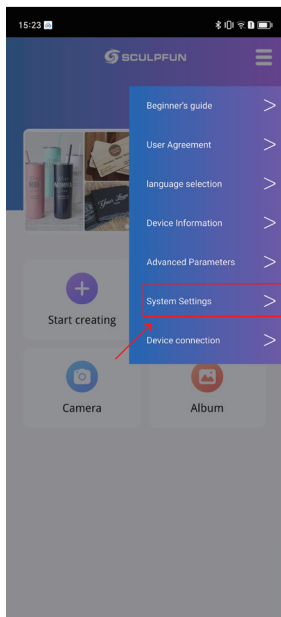

Engraving Large Materials Without the Cover:

If you need to remove the cover to engrave larger materials, you can disable the safety door in the settings and continue engraving.

(Note: Engraving without the cover may cause laser leakage. Always wear blue light blocking glasses when operating.)



QR code

10. Safety Door and Laser Cover:

- If the safety door is on and the laser cover is not installed, engraving cannot be performed.
- To engrave without the cover, disable the safety door setting in the app's System Settings.

11. Detailed Tutorials: for more detailed usage tutorials, please scan the QR code to learn more.

3 Engraving materials with different sizes

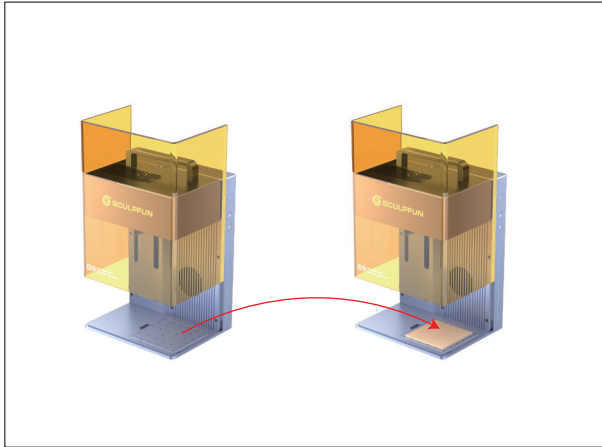

- Small size material processing

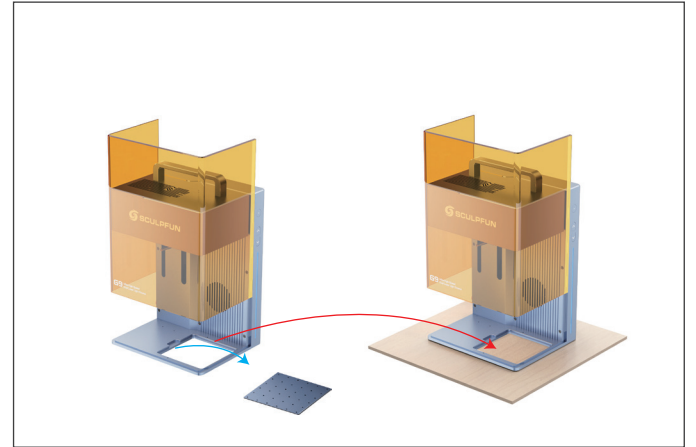

- Large size material processing

4 Focus Adjustment

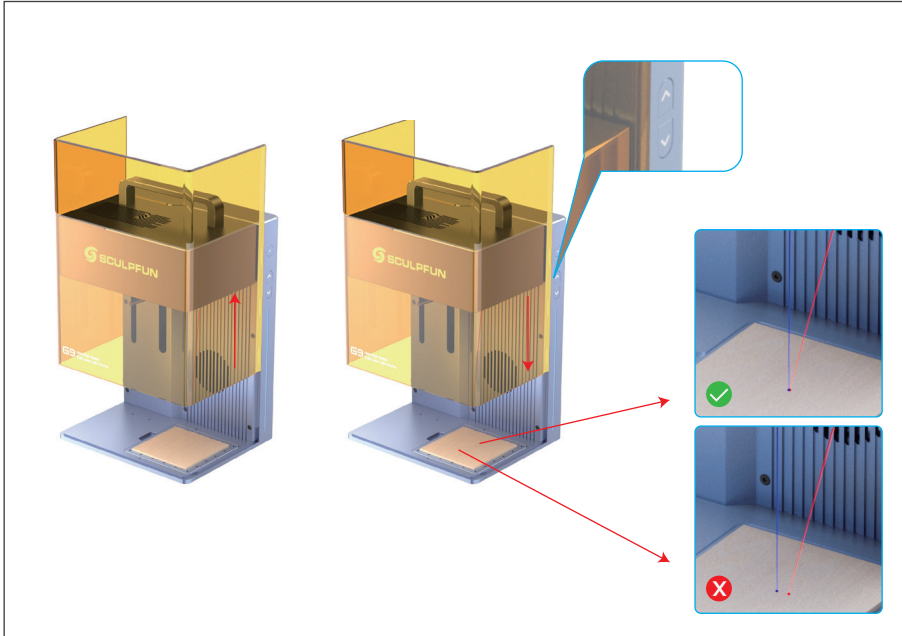

• Focus Adjustment

Each time you switch to a material of different thickness, refocusing is required.

Turn on the focus button in the PC software or app.

Adjust the focal length up and down until the red and blue light spots coincide.

Once the light spots overlap, the focus is complete, and you can start engraving.

5 Rapid positioning with material fixture

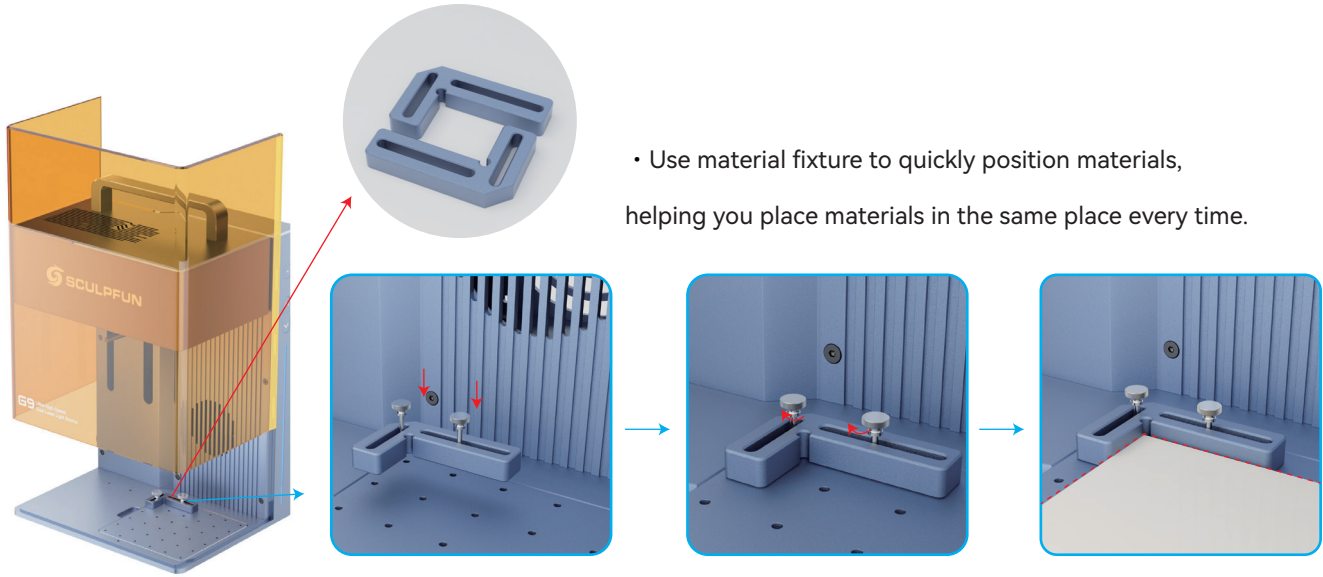

6 Emergency button

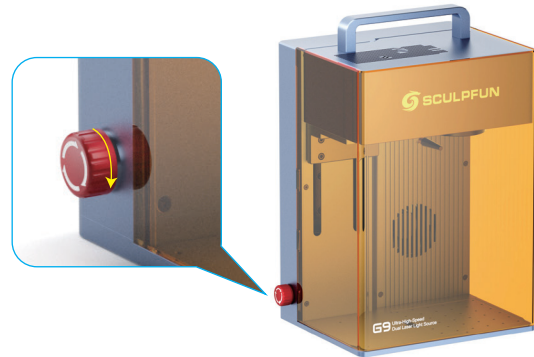
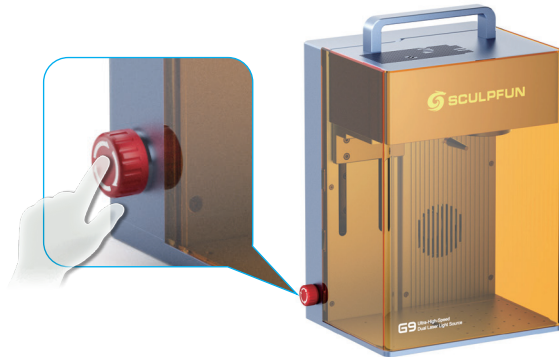

- Emergency Procedure:

- If a fault or danger occurs during processing, press the emergency button to cut off the machine's power.

- Rotate the emergency button to reset it.

7 USB Security Key

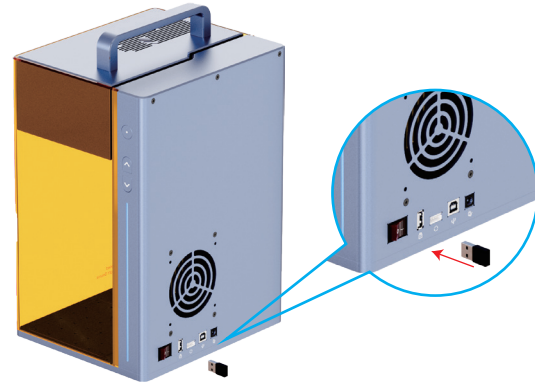
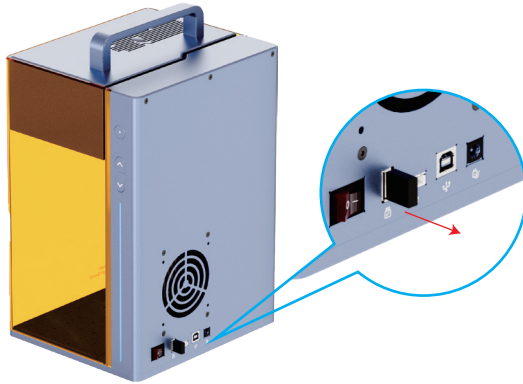

- The USB Security Key will be locked after being unplugged, preventing children or others from using it, and it needs to be plugged in to work normally.

8 Smoke exhaust pipe–optional accessories

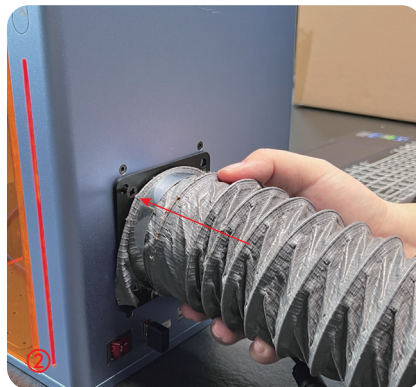

- Unscrew the screws on the fixing plate, connect the exhaust pipe to the plate, align it with the machine's exhaust port, and secure it with screws.

5 Machine maintenance and upkeep

1. After long-term use, the field lens may accumulate dirt. It is recommended to gently clean it using dust-free cloth or dust-free paper with alcohol.
2. When using or placing the machine, please be careful to avoid foreign objects falling into the top vents and affecting the operation of the machine.

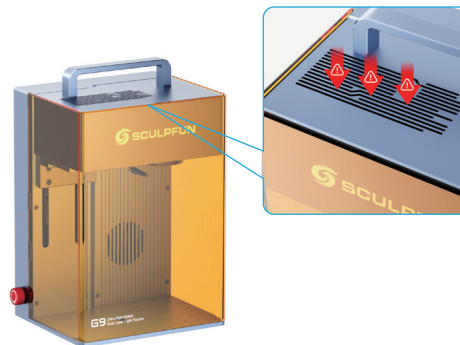
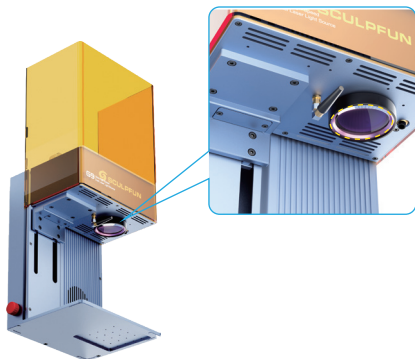

6 Warranty terms

- To the extent permitted by law, this warranty is exclusive and supersedes all other express, implied, or legal warranties (including any warranty for a specific purpose, as prescribed by regulations or any other circumstances), including but not limited to any liability applicable to goods for a specific purpose. Additionally, Sculpfun is not responsible for any accidental, special, indirect, or consequential damages (which may be caused by use, misuse, non-use, or product defects).
- Consumers are obligated to back up all important data in advance when applying for warranty services. During maintenance, if parts are replaced or product software versions are updated, data may be lost and Sculpfun will not provide data backups or restore data and set values.
- The warranty for the entire machine and key components is one year, and the warranty for functional components is three months. The product enjoys warranty service from the date of receipt.
- For any product that has been replaced or repaired, Sculpfun will provide the original product's remaining warranty period or a 30-day warranty period after replacement.
- When consumers apply for warranty service from Sculpfun for products sold outside of mainland China, due to laws and regulations, safety regulations, tariffs, repair technology, parts inventory, and other reasons, parts sold in other countries and regions cannot be returned to Sculpfun for warranty service. Therefore, Sculpfun can only provide limited warranty service. Consumers outside of mainland China, whether within the scope of warranty or not, need to seek warranty services through the path authorized by the country of origin and will incur inspection and manual processing fees. If the country imposes additional tariffs on the recipient, the consumer is responsible for them. Consumers who directly apply for warranty services from Sculpfun may also take similar measures.

- Distributors can sell Sculpfun products to consumers outside of mainland China. If a value-added service is provided that is different from this warranty, this service is only valid for the regions sold by the distributor and is not related to this warranty service.
- The processing quality is highly related to user operation, processing materials, and processing environment.



Note: It is forbidden to disassemble the device without authorization. If you disassemble the machine without the guidance of SCULPFUN official personnel, you will lose the warranty service and you will need to bear all risks associated with disassembling the machine.

7 After sales service&disclaimer

After-sale service

If you have any questions about your G9, please contact us and we will reply to you as soon as possible.

E-mail: support@sculpfun.com

Disclaimers

- This product is a laser marking device. Please scan the QR code on the cover to access the complete user manual, as well as the latest instructions and warnings. All information in this document has been carefully reviewed. If you find any formatting errors or content misunderstandings, please contact us. Technical improvements to the product (if any) will be included in the new manual without prior notice.
- If you encounter a problem or malfunction with the product, please provide the original marking file, the configuration parameters of the marking software used, the operating system information, the marking process video, and the operation steps when consulting customer service. Without this information, SCULPFUN may not be able to provide you with timely troubleshooting methods and after-sales service.
- SCULPFUN shall not be liable for any losses caused by the user's failure to use this product in accordance with the provisions of this manual. Users are prohibited from dismantling the machine on their own without the guidance of our technical personnel. Any losses resulting from such behavior will be borne by the user.
- SCULPFUN reserves the right to interpret these documents, subject to compliance with the law. SCULPFUN also reserves the right to update, modify, or terminate these terms without prior notice.