

This guide refers to the following products:

NOVATERM[®] IGS 868 MHz
NOVATERM[®] IGS 921 MHz
NOVATERM[®] BOX 868 MHz
NOVATERM[®] BOX 921 MHz

Dear Customer, Thank you for choosing Novaterm[®] from Groupe Berkem. For safe use, we advise you to read its quick start guide very carefully and follow all instructions. The contents of this quick start guide cannot exhaustively describe all aspects related to the use of the product. It is based on our own experience and remains non-binding. It does not evade compliance with the information indicated in the Safety Data Sheet available on request. The information in this documentation is indicated in the current state of the regulations. Any changes to these regulations will result in an update of this document. If you have any questions, your sales representative is available to answer them and take note of any suggestions you may have.

Contents

Manufacturer	
Caution	
Contents of the box	
Presentation of the product	
Maintenance and Cleaning	
868 MHz or 921 MHz NOVATERM [®] IGS	
868 MHz or 921 MHz NOVATERM [®] BOX	
Technical characteristics	
868 MHz or 921 MHz NOVATERM [®] IGS	
868 MHz or 921 MHz NOVATERM [®] BOX	
Main electrical power adapter included with the NOVATERM [®] BOX	
Operating conditions	
868 MHz or 921 MHz NOVATERM [®] IGS	
868 MHz or 921 MHz NOVATERM [®] BOX	
Certification and regulatory information	
CE certification	
FCC Statement	
Safety	
Definition of symbols	
Important safety instructions	
Precautions for use of the device	
User safety	
Safety of persons	
Storage	
Environment	
After-sales service and warranty	
After-sales service	

Manufacturer

NOVATERM[®] products are manufactured by GROUPE BERKEM
Address: 20, rue Jean DUVERT - 33290 BLANQUEFORT - France
Telephone: +33 5 64 31 06 60
Web site: <https://hygiene.groupeberkem.com> and novaterm.com



Please carefully read the manual and the "Safety" chapter before use.

Contents of the box

868 MHz or 921 MHz NOVATERM [®] IGS	868 MHz or 921 MHz NOVATERM [®] BOX
<ul style="list-style-type: none"> • One user manual and safety instructions • 16 NOVATERM[®] IGS <ul style="list-style-type: none"> • 16 main units or boxes • 16 loops or cartridges supports • 16 reclosable covers 	<ul style="list-style-type: none"> • One user manual and safety instructions • One main electrical power adapter SIMSUKIAN ESCM0118-050 • One NOVATERM[®] BOX

Presentation of the product

The NOVATERM® IGS and NOVATERM® BOX are intended to be used by professionals to deal with subterranean termites.

The NOVATERM® IGS are installed in the ground approximately 50 cm to 1 meter from the edges of buildings, approximately every 3 meters.

Two anti-termite bait cartridges can be inserted in a loop in the interior cavity of the NOVATERM® IGS.

The NOVATERM® IGS features a proprietary 868 MHz or 921 MHz radio telecommunication and measurement system, depending on the country. When the system is installed, the NOVATERM® IGS stations are paired with one or more NOVATERM® BOX units. The NOVATERM® BOX has a range of about 50 m, which may be reduced due to obstacles (concrete walls, metal partitions, etc.).

The measurements are transmitted to the NOVATERM® BOX, which then sends them to a server over an LTEM / NB-IOT type telecommunication network for analysis.

CONNECTED BAIT SYSTEM

Plug the main box power supply

Launch the App
Pair with the main box

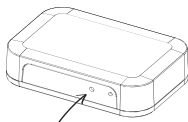
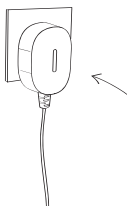

DISTRIBUTE THE IGS AROUND THE BUILDING EVERY 3 METERS

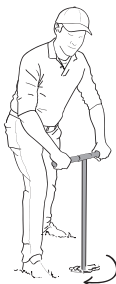
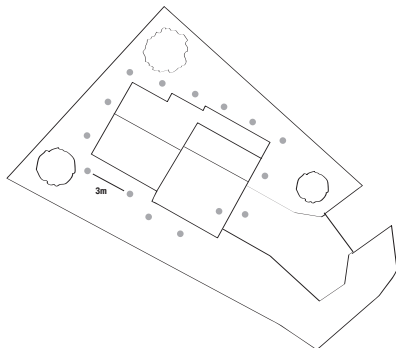

DIG THE HOLES

SETUP IGS MISE EN PLACE IGS

- 1 - Insert the 2 cartridges in the loop
- 2 - Pair the IGS one after the other
- 3 - Press the pair button

- 4 - Scan the QR code with the app
- 5 - Insert the IGS into the ground

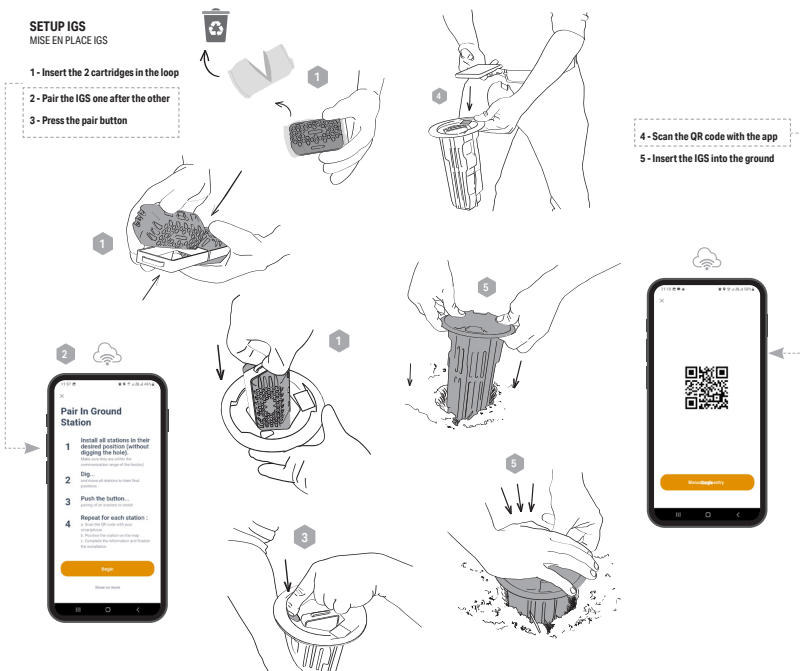

FEATURES

868 MHz or 921 MHz NOVATERM® IGS			
Step	Required action	LED	Comment
Forced transmission of a measurement	Press the button		Transmission of a message if the station is paired, then return to standby mode
Start the pairing process	2 seconds ≤ press the button ≤ 8 seconds	The LED flashes red	The telecommunication module is not yet connected
Reset	Press and hold the button ≥ 8 seconds	The LED is green	Reset with factory settings

868 MHz or 921 MHz NOVATERM® BOX			
Step	Required action	LED	Comment
Forced transmission of a measurement	Press and hold the button (≥ 2 seconds)	The LED is blue	Goes off after 120 seconds
Start-up		The LED flashes dark blue	The telecommunication module is not yet connected
Normal operation		The LED is green	The telecommunication module is connected
During an update		The LED flashes dark blue	Update in progress
After an update		The LED is white for 1 second, followed by start-up	Update complete

Maintenance and Cleaning

868 MHz or 921 MHz NOVATERM® IGS

Inspect your NOVATERM® IGS at least once a year. Clean the IGS after each inspection.

868 MHz or 921 MHz NOVATERM® BOX

Clean your NOVATERM® BOX at least once a year. The exterior of the BOX can be cleaned with a cloth to wipe off dust.

In the event of a failure, contact NOVATERM® customer service. Do not attempt to access the electronic circuit.

In the event of regular losses of data, position the NOVATERM® BOX in another location or at a different height. **Technical characteristics**

868 MHz or 921 MHz NOVATERM® IGS

- Supply voltage: 3.0 V
- Consumed current: 50 mA max.
- Power: 150 mW max.
- Battery: Primary, CR2477X (lithium)
- Electric shock protection class: III
- Weight without consumables: 0.5 kg
- Dimensions (l x w x h): 150 x 150 x 250 mm
- Product casing: ABS plastic and polyurethane resin
- Frequency bands:
 - 868 MHz (for the 868 MHz version)
 - 921 MHz (for the 921 MHz version)

868 MHz or 921 MHz NOVATERM® BOX

- Product power supply: Main electrical power adapter included
- Supply voltage: 5 V.
- Current: 2.5 A max.
- Power: 12.5 W
- Electric shock protection class: III
- Weight: 0.25 kg
- Size / Dimensions (l x w x h): 0.1 x 0.07 x 0.03 m
- Frequency bands:
 - 868 MHz (for the 868 MHz version)
 - 921 MHz (for the 921 MHz version)
 - CAT M1: LTE HD-FDD: B1/B2/B3/B4/B5/B8/B12/B13/B18/B19/B20/B25/B26/B27/B28/B66/B85
 - CAT NB2: LTE HD-FDD: B1/B2/B3/B4/B5/B8/B12/B13/B18/B19/B20/B25/B28/B66/B71/B85
 - EGPRS: GSM850/EGSM900/DCS1800/PCS1900

Main electrical power adapter included with the NOVATERM® BOX - SIMSUKIAN - SK01T8-0500300Z

- Nominal input voltage: 110-220 VAC
- Minimum and maximum input voltages: 90 - 264 VAC
- Main electrical power frequency range: 47 Hz - 63 Hz
- Output voltage: 5.0 V
- Maximum input current: 0.4 A
- Maximum inrush current: 100 A (typical value with a voltage of 220 VAC)
- Max. output current: 3 A
- Max. power: 15 W
- Electric shock protection class: II
- Input connectors: UL/PSE, CE, SAA, CCC
- Output connector: Plus 5.1 mm x 2.1 mm x 0.5 mm (center positive)
- Length of the output cable: 1.5 m

Operating conditions

868 MHz or 921 MHz NOVATERM® IGS

- Operating temperature: -10 °C to +40 °C
- Outdoor equipment = pollution degree 4
- Altitude: < 2,000 m
- Relative humidity < 80 % without condensation.

Operating conditions

868 MHz or 921 MHz NOVATERM® BOX

- Operating temperature: -10 °C to +40 °C
- Outdoor equipment = pollution degree 2
- Altitude: < 2,000 m
- Relative humidity < 80 % without condensation.

Certification and regulatory information

CE certification

Groupe Berkem declares that the NOVATERM® BOX 868 MHz and NOVATERM® IGS 868 MHz type radio electrical equipment complies with the directive 2014/53/EU.

These devices meet Standard RoHS 2011/65/EC. These devices do not contain any substances that exceed the maximum concentration values ("MCV") specified in the EU RoHS directive.



Go to the page <https://hygiene.groupeberkem.com/en/documents/> to view the Declaration of Conformity.

FCC Statement

Regarding the following equipment:

- NOVATERM® BOX 921 MHz - FCC ID: 28E2ZD-N80XV04
- NOVATERM® IGS 921 MHz - FCC ID: 28E2ZD-NIGSV04

GRUPE BERKEM is not responsible for any changes or modifications not expressly approved by the party responsible for compliance. Such modification could void the user's authority to operate the equipment.

NOTE : This equipment has been tested and found to comply with the limits for a Class B digital device, pursuant to part 15 of the FCC Rules. These limits are designed to provide reasonable protection against harmful interference in a residential installation. This equipment generates, uses and can radiate radio frequency energy and, if not installed and used in accordance with the instructions, may cause harmful interference to radio communications. However, there is no guarantee that interference will not occur in a particular installation. If this equipment does cause harmful interference to radio or television reception, which can be determined by turning the equipment off and on, the user is encouraged to try to correct the interference by one or more of the following measures:

- Reorient or relocate the receiving antenna.
- Increase the separation between the equipment and receiver.
- Connect the equipment into an outlet on a circuit different from that to which the receiver is connected.
- Consult the dealer or an experienced radio/TV technician for help

This device must be professionally installed

This equipment complies with FCC's radiation exposure limits set forth for an uncontrolled environment under the following conditions:

- This equipment should be installed and operated such that a minimum separation distance of 20cm is maintained between the radiator (antenna) and user's/nearby person's body at all times.
- This transmitter must not be co-located or operating in conjunction with any other antenna or transmitter.

Safety

Definition of symbols



Risk of danger. Important information.
Read the manual



FCC logo. Compliant with the applicable limits in part 15 of the FCC rules.



WEEE logo. This product complies with the marking requirements of the WEEE directive (2002/96/EC). This logo means that you must not dispose of this electrical/electronic product with household waste. Product category: In accordance with the types of equipment in Annex I of the WEEE directive, this is a category 9 product. Do not dispose of this product as unsorted municipal waste.



CE logo. Compliant with the European directives.

Important safety instructions

Please carefully read these safety instructions in order to use your devices correctly and in complete safety.

- The products in the NOVATERM® range must be handled by professional and qualified operators.
- Only use the products in the NOVATERM® range in accordance with the manufacturer's instructions. In the event of use that does not comply with this manual, the protection provided by the device may be compromised.
- Check the products before installing them. If the product is damaged or shows signs of deterioration, do not use it and contact the after-sales service.
- Do not remove or reuse the battery.
- Never try to repair a damaged device. Contact the after-sales service.
- The NOVATERM® IGS 868 MHz and 921 MHz can be used in humid environments.
- The NOVATERM® BOX 868 MHz and 921 MHz must be stored in a sheltered place, in accordance with the operating conditions.
- Never try to connect a damaged device to the main electrical power. Contact the after-sales service.
- Keep the products out of the sight and reach of children and pets.
- Obey local and national safety rules when installing and using the product.
- Always use the main electrical power adapter supplied with the NOVATERM® BOX. If the power cable or the adapter appears to be damaged, do not use the equipment and contact after-sales service. Do not try to repair the product.
- If the main electrical power socket is damaged or does not comply with the local and national safety rules, do not connect the main electrical power adapter.

Precautions for use of the device

The NOVATERM® IGS is compatible with NOVATERM® CARTRIDGES bait

User safety

- Please apply standard hygiene precautions. Avoid any contact with the skin, eyes and clothing. Do not eat, drink or smoke when working.
- We recommend the use of latex gloves.

Safety of persons

- Always close the NOVATERM® IGS with the NOVATERM® KEY until you hear the cover click into place.
- Always close the NOVATERM® AGS using the cover and the screws with a special heads provided.

Storage

- Keep the original recipient hermetically closed and in a dry place, sheltered from light and humidity.
- Keep the product under standard temperature conditions, sheltered from frost. Make sure that the place of storage is sufficiently ventilated.
- Keep well clear of food and drink, including those for animals. Do not store or transport in the vicinity of miscellaneous chemicals or wood treatment products.
- Service = 2 years.

Environment

- Product residue, packaging materials and any other waste produced by the treatment must be considered as hazardous, under the full responsibility of the owner of the waste and treated in a specialized facility, in accordance with the regulations in force.
- Do not dispose of the biocide in plumbing (sinks, toilets, etc.), gutters or waterways.
- Dispose of any unused product, its packaging and all other waste in an appropriate collection channel.

After-sales service and warranty

After-sales service

For all information about NOVATERM products and their conditions of installation and maintenance, please call +33 (0)564 310 660.

An aerial photograph of a house with a tiled roof, surrounded by trees and landscaping. Several hexagonal NOVATERM bait stations are visible, some on the roof and others in the garden, each with concentric circles around it.

NOVATERM[®]

Smart Termite Bait System

© January 2024 / Groupe Berkem / Reproduction forbidden / Illustration credits: Groupe Berkem

b groupe
berkem

b | Hygiène
& Protection
A business area of Groupe Berkem

20, rue Jean Duvert
33290 Blanquefort - FRANCE
groupeberkem@berkem.com



hygiene.groupeberkem.com

