

80mm

MELIFO MINI REMOTE CONTROL USER MANUAL



Battery Type: Lithium Battery (CR2032)
Operating Distance: 5m
FC CE RoHS
Made in China

Mailbox:melifo service@gmail.com

PART LIST



battery x 1



remote control x 1
(with battery)

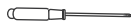

screwdriver x 1



screw x 2

1

CODE SETTING

If you get a new remote control, please code matching first. The method is as follows.



Code matching
The remote control will need to be re-coded after batteries were properly installed or replaced. Please refer to steps below:
step 1 : Long press the remote control, at same time, connect the lamp to power.
step 2: When the lights are slowly dimming, the code is successfully matched.

2

REMOTE CONTROL FUNCTION

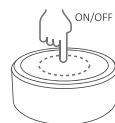

1. Turn on: short press the remote control once.
Turn off: when the lamp is on working, short press the remote control twice.
2. Adjust the color temperature of the lamp:
Short press the remote control:
Turn on-3000K-4000K-5000k-6500k-Turn off

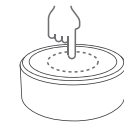

3. Adjust the brightness of the lamp:
When the lamp is on working, long press 3 seconds, then the remote control will stepless adjust brightness slowly.

4. Automatic brightness adjustment function diagram

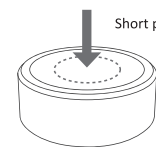

Short press 3 times

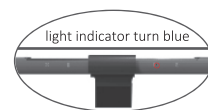

light indicator turn blue

(1) Adjust the brightness automatically:
Light sensor function: short press three times, the small indicator light turns blue, this function will start working: the light will adjust brightness automatically according to the environment.
Environment turns bright, the lamp turns dark gradually
Environment turns dark, the lamp turns bright gradually
(2) Turn off the function:
Short press the remote control for 3 times(or long press the remote control for 3 seconds), the blue indicator light will turn off, this function will also turn off.

3

HOW TO REPLACE BATTERY

If you need to replace the battery, pls check bellow steps.
Step1. Take off the screw by the screwdriver Step2. Take off the cover and replace batteries

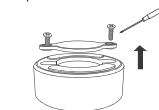

1pc CR2032 button cell

Step3. Put cover back and fix screw by screwdriver

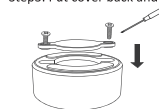

4

FCC Warning
This device complies with part 15 of the FCC Rules. Operation is subject to the following two conditions: (1) This device may not cause harmful interference, and (2) this device must accept any interference received, including interference that may cause undesired operation. Note: This equipment has been tested and found to comply with the limits for a Class B digital device, pursuant to part 15 of the FCC Rules. These limits are designed to provide reasonable protection against harmful interference in a residential installation. This equipment generates, uses and can radiate radio frequency energy and, if not installed and used in accordance with the instructions, may cause harmful interference to radio communications. However, there is no guarantee that interference will not occur in a particular installation. If this equipment does cause harmful interference to radio or television reception, which can be determined by turning the equipment off and on, the user is encouraged to try to correct the interference by one or more of the following measures:
—Reorient or relocate the receiving antenna.
—Increase the separation between the equipment and receiver.
—Connect the equipment into an outlet on a circuit different from that to which the receiver is connected.
—Consult the dealer or an experienced radio/TV technician for help.
Note: The Grantee is not responsible for any changes or modifications not expressly approved by the party responsible for compliance. such modifications could void the user's authority to operate the equipment.

The device has been evaluated to meet general RF exposure requirement.
The device can be used in portable exposure condition without restriction.

5

128g Coated paper, double-sided color, folded

80mm