

80mm

ONWAY LUXURY REMOTE CONTROL USER MANUAL



Battery Type: AAA Battery
Operating Distance: 8m
FC
RoHS
Made in China

Mailbox: onway.service@outlook.com

PART LIST



HOW TO MOUNT THE REMOTE CONTROL

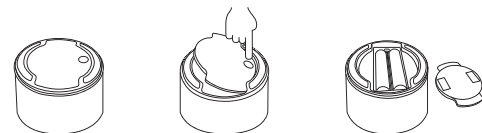

1. The battery box is at the bottom of the remote control. Turn the bottom of the battery box upward.
2. Press the circular depression at the bottom, the battery cover will pop up.
3. Insert the battery according to the positive and negative poles.
4. Put the battery cover back to bottom of remote control.

1

CODE SETTING

If you get a new remote control, please code matching first. The method is as follows.

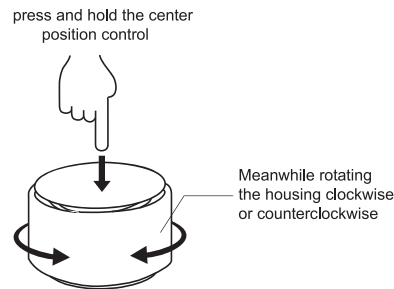

The remote control will need to be re-coded after batteries were properly installed or replaced. Please refer to steps below:

1. Connect the light to power, and long press the center position within 5 seconds, meanwhile rotate the housing clockwise or counterclockwise
2. If the light flashes, the code was successfully matched.

2

FUNCTION DIAGRAM OF REMOTE CONTROL

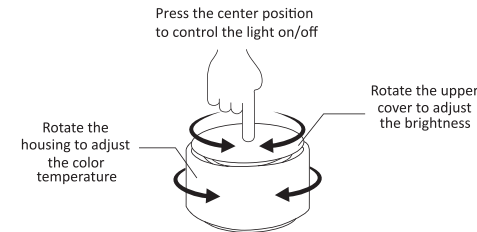

HOW TO USE THE REMOTE CONTROL

1. Turn on/off: short press center position once
2. 2-hour timer: long press the center position for 5 seconds, the light flash once, then turn on the 2-hour timer.
3. Adjust brightness: rotate the upper cover plate clockwise rotation: light up
counterclockwise rotation: light dims

3



4. adjust color temperature (3000k-6500k): rotate the housing clockwise rotation: 6500K cold light
counterclockwise rotation: 3000K warm light

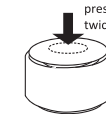

5. Automatic light sensor function:
short press twice, the small indication light turns green, this function will start working:
Environment turns bright, the lamp turns dark gradually;
Environment turns dark, the lamp turns bright gradually.
Short press the remote control for twice(or rotate the upper cover plate), the blue indicator light will turn off, this function will also turn off.

4

FCC Warning

This device complies with part 15 of the FCC Rules. Operation is subject to the following two conditions: (1) This device may not cause harmful interference, and (2) this device must accept any interference received, including interference that may cause undesired operation. Note: This equipment has been tested and found to comply with the limits for a Class B digital device, pursuant to part 15 of the FCC Rules. These limits are designed to provide reasonable protection against harmful interference in a residential installation. This equipment generates, uses and can radiate radio frequency energy and, if not installed and used in accordance with the instructions, may cause harmful interference to radio or television reception, which can be determined by turning the equipment off and on, the user is encouraged to try to correct the interference by one or more of the following measures:

- Reorient or relocate the receiving antenna.
- Increase the separation between the equipment and receiver.
- Connect the equipment into an outlet on a circuit different from that to which the receiver is connected.
- Consult the dealer or an experienced radio/TV technician for help.

Note: The Grantee is not responsible for any changes or modifications not expressly approved by the party responsible for compliance. such modifications could void the user's authority to operate the equipment.

The device has been evaluated to meet general RF exposure requirement. The device can be used in portable exposure condition without restriction.

5

128g Coated paper, double-sided color, folded

80mm