

# User Manual

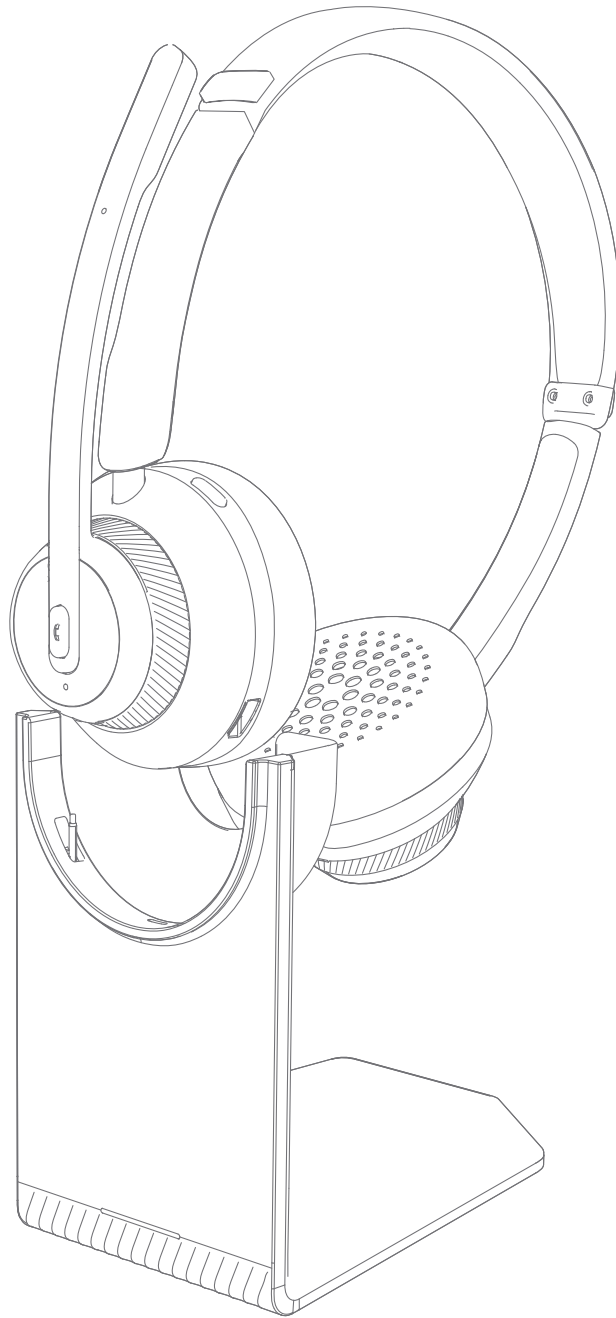

Thank you for purchasing Wireless headset.

# 1.Product Overview

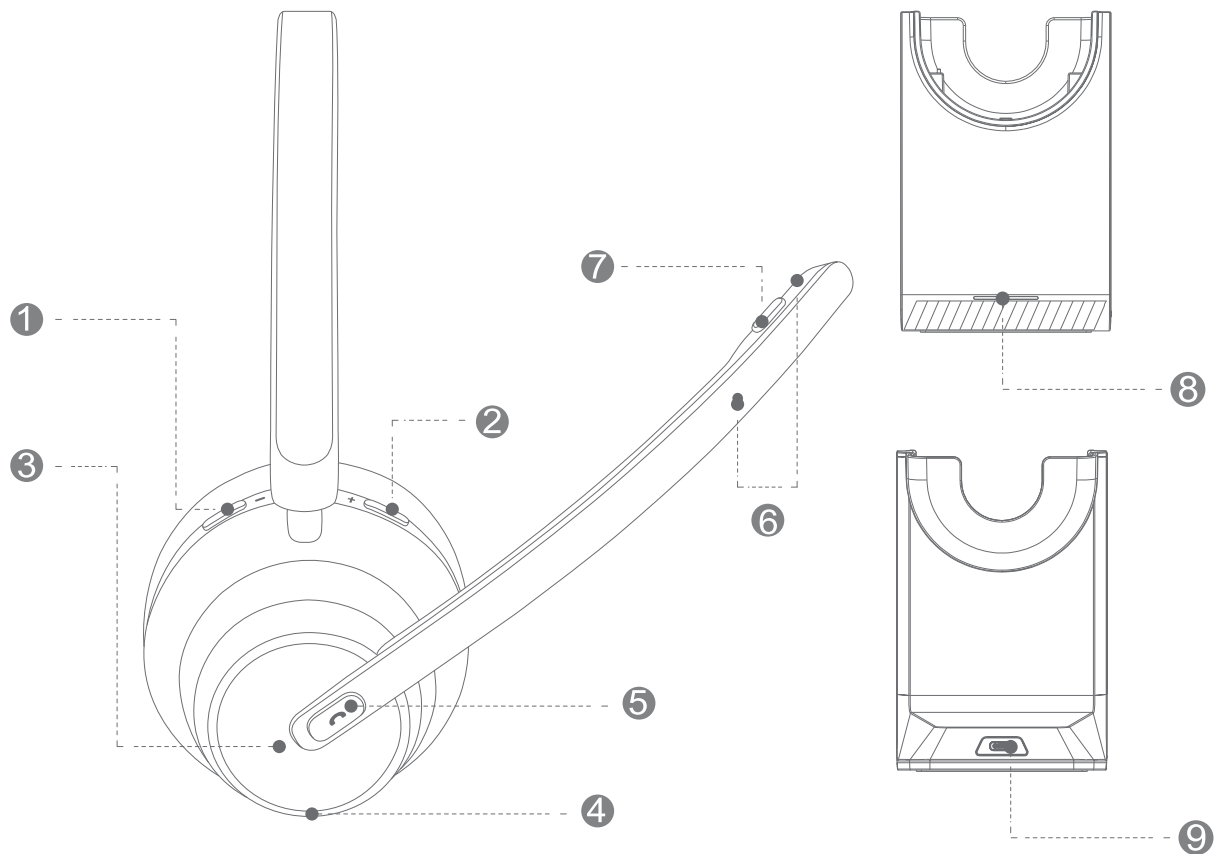

① Volume - Button

② Volume + Button

③ LED Indicator

④ USB-C Port

⑤ Power/Bluetooth Button

⑥ Microphone Boom

⑦ Mute Button

⑧ Charging indicator

⑨ USB-C Charging port

## 2.What's Included?



Headset

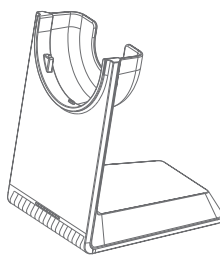

Charging Stand

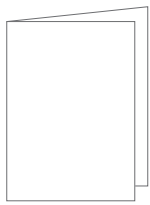

User Manual



Quick Start Guide

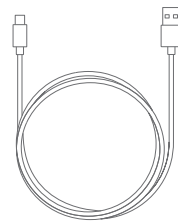

USB-C  
Charging Cable

### 3.Charging

- Connect the headset to the power supply via the USB-C charging cable.
- Choose the power supply by a charger or computer's USB output port.
- The LED indicator of the power/Bluetooth Button will turn from green to steady red when charging, and it will turn off when the headset is fully charged.

## Using the Charging Stand

1. Connect the charging stand to the power supply via the USB-C charging cable.

- The LED indicator on the charging stand will turn steady red when powered.

2. Align the charging pins on both the headset and the charging stand for successful charging.

- The LED indicator on the headset will turn red for charging, and turn steady green on the charging stand, and the headset indicator will turn off when it is fully charged.

\* Only available for the version with this charging stand.

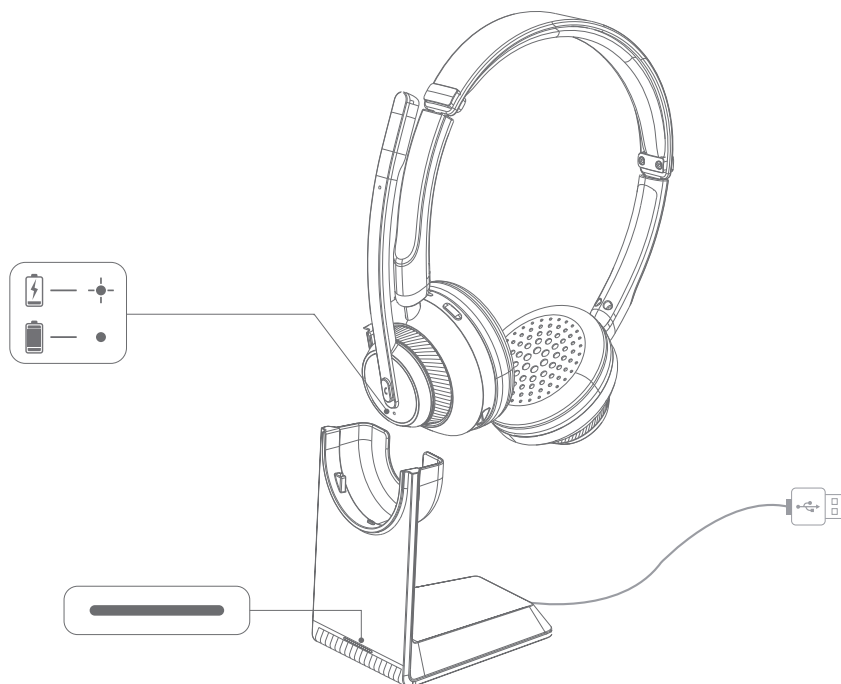

## 4. Battery Status

When the battery power is below 5%, the LED indicator on the headset will flash red twice and prompt “Battery low” voice every 3 minutes.

## 5. Wearing

- Wear the headset with the microphone boom on either side.
- Adjust the microphone boom close to your mouth.

### Tips:

When switching from one side to the other, the microphone boom must be lowered all the way down and directed towards your mouth so that the volume adjustment direction and sound channels can be adjusted accordingly.

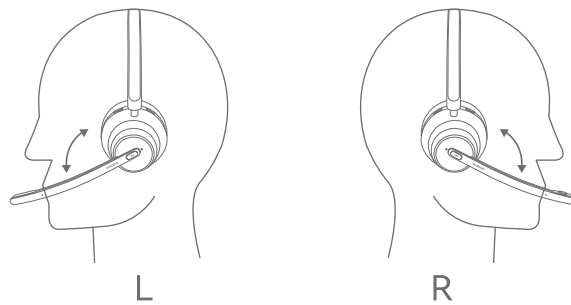

## 6.Power On/Off

Press and hold the power button for 2 seconds to power on and 4 seconds to power off.

- The LED indicator on the headset will turn green for 1 second when powered on, and turn red for 1 second when powered off.

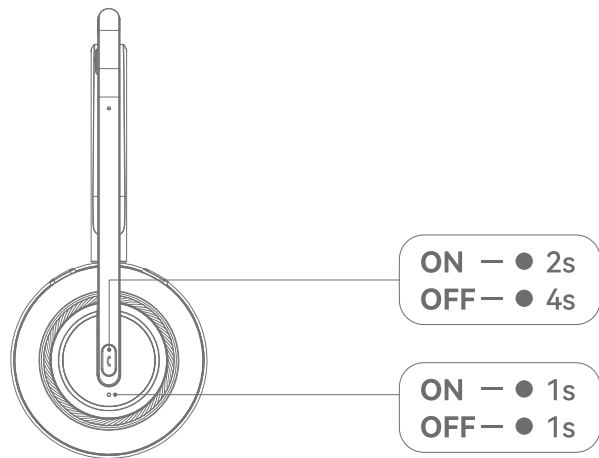

## 7.Pairing Bluetooth Pairing

Press and hold the power button for 4 seconds to enter Bluetooth pairing mode when in off status.

- The LED indicator on the headset will flash green and red during pairing status.
- Select “ headset ” on your device’s Bluetooth list to connect.
- When successfully conencted, the LED indicator on the headset will turn green steadily.

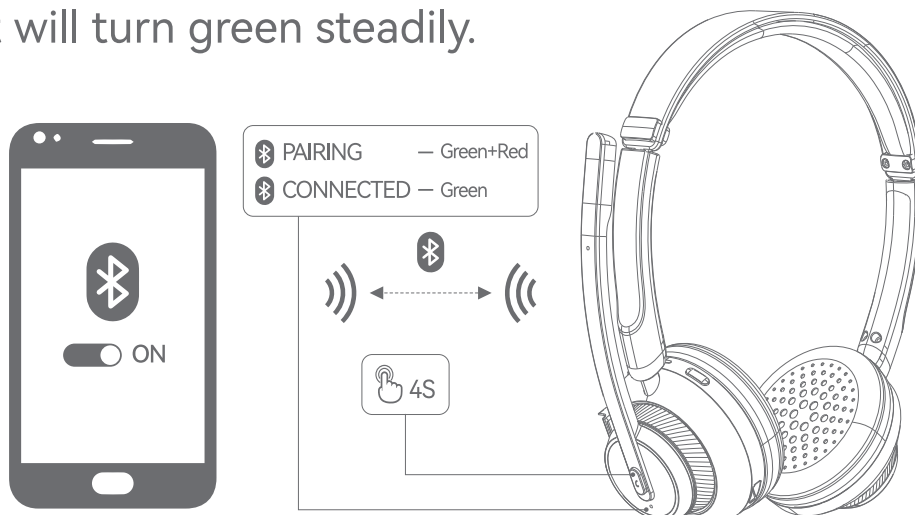

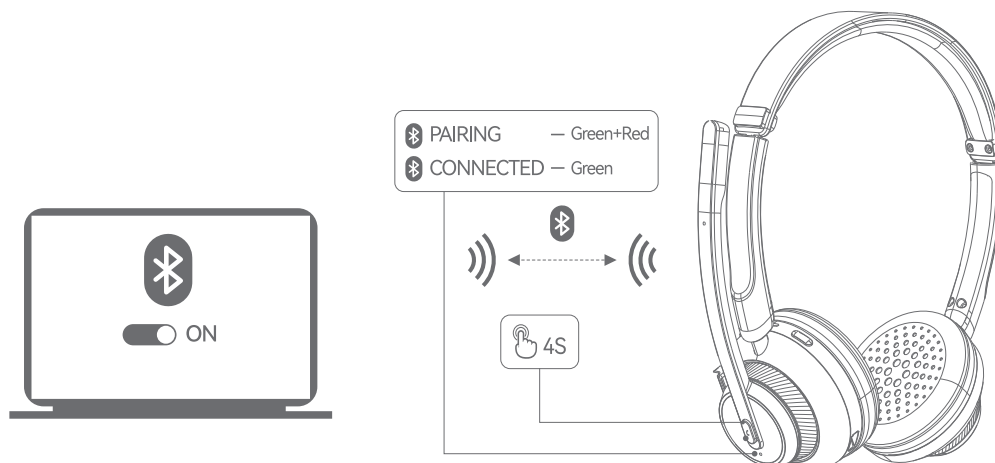

## Pairing with Two Devices

To pair with another device when already connected with one device.

- 1) First you need to power off the first device's Bluetooth and the headset will turn to repairing mode.
- 2) Then you need triple click the power/Bluetooth button to open the "Two devices" mode (Only one device can be connected default) .
- 3) Next you can connect to another device quickly.
- 4) Finally power on the first device's Bluetooth and manually connect the headset.

Tips: After that, it can automatically connect the last two devices when you power on it. Also you can triple click the power/Bluetooth button again to power off the "Two devices" mode during disconnected status.

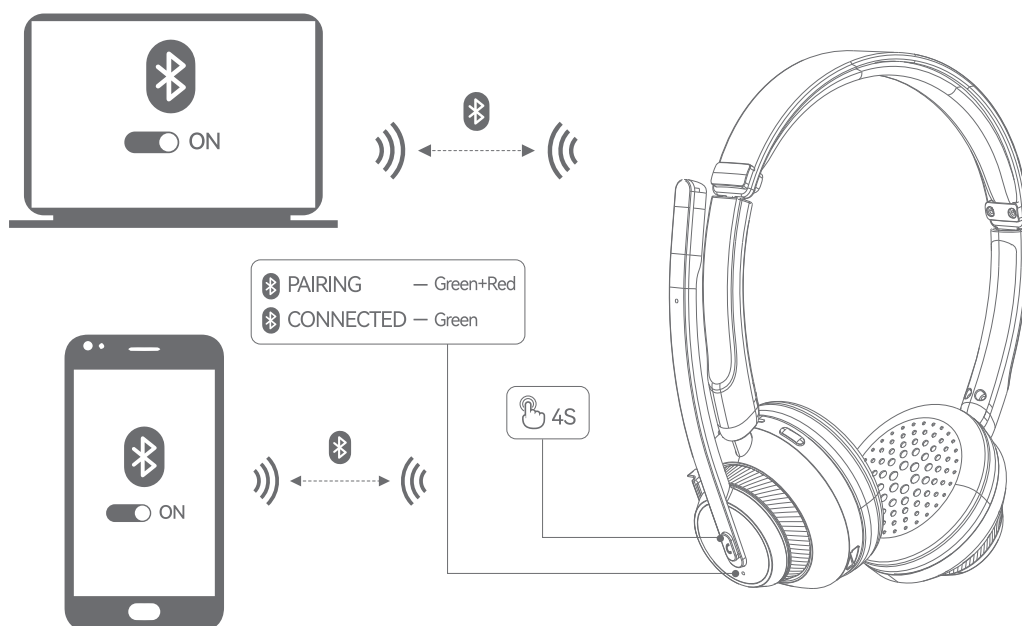

## 8.Controls

Buttons	Functions	Operations
Power/ Bluetooth	Power on	Press and hold for 2 seconds when powered off
	Power off	Press and hold for 4 seconds when powered on
	Play/Pause	Press once
	Answer/End a call	Press once when calls coming
	Reject a call	Press and hold for 2 seconds when calls coming
	Last number recall	Press twice
Volume+/-	Repairing	Press and hold for 4 seconds when powered off
	Volume up	Press once by volume+
	Volume down	Press once by volume-
	Next track	Press and hold volume+ for 2 seconds
Mute	Previous track	Press and hold volume- for 2 seconds
	Mute microphone	Press once
	Mute off	Press once

## 9. Specification

Input	5V=0.5A
Charging time	1h 30min
Playtime	48 hours
Call Time	32 hours
Battery capacity	400mAh
Driver size	30 mm
Microphones	Microphone boom with 2mics
Impedance	32 $\Omega$
Frequency response	20 Hz - 20 kHz
Headset Bluetooth version	V 5.1
USB receiver Bluetooth version	V5.0
Bluetooth range	10 m / 33 ft

Tips: Specifications are subject to change without notice.





**CAUTION**  
**RISK OF EXPLOSION IF BATTERY IS REPLACED**  
**BY AN INCORRECT TYPE**  
**DISPOSE OF USED BATTERIES ACCORDING**  
**TO THE INSTRUCTIONS**

## **RECYCLING**

This product bears the selective sorting symbol for Waste electrical and electronic equipment (WEEE). This means that this product must be handled pursuant to European directive 2012/19/EU in order to be recycled or dismantled to minimize its impact on the environment.

User has the choice to give his product to a competent recycling organization or to the retailer when he buys a new electrical or electronic equipment.



**RoHS**  
Green Product



**— — — DC voltage**



This device complies with part 15 of the FCC Rules.

Operation is subject to the following two conditions: (1) This device may not cause harmful interference, and (2) this device must accept any interference received, including interference that may cause undesired operation.

Any Changes or modifications not expressly approved by the party responsible for compliance could void the user's authority to operate the equipment.

Note: This equipment has been tested and found to comply with the limits for a Class B digital device, pursuant to part 15 of the FCC Rules. These limits are designed to provide reasonable protection against harmful interference in a residential installation. This equipment generates uses and can radiate radio frequency energy and, if not installed and used in accordance with the instructions, may cause harmful interference to radio communications. However, there is no guarantee that interference will not occur in a particular installation. If this equipment does cause harmful interference to radio or television reception, which can be determined by turning the equipment off and on, the user is encouraged to try to correct the interference by one or more of the following measures:

- Reorient or relocate the receiving antenna.
- Increase the separation between the equipment and receiver.
- Connect the equipment into an outlet on a circuit different from that to which the receiver is connected.
- Consult the dealer or an experienced radio/TV technician for help.

The device has been evaluated to meet general RF exposure requirement. The device can be used in portable exposure condition without restriction.

Any changes or modifications not expressly approved by the party responsible for compliance could void the user's authority to operate the equipment.