

LVTEL AirPods 6pro

User Manual



TRUE WIRELESS EARBUDS

Packing Contents

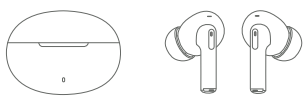

① Charging case X1 ② Earbuds X2



③ Couple Earbuds X3 ④ Type-C Charging Cable X1 ⑤ User Manual X1

Product Overview

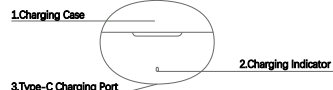

1. Charging Case 2. Charging Indicator

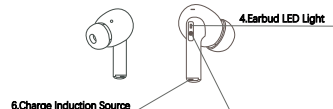

3. Type-C Charging Port 4. Earbud LED Light



6. Charge Induction Source 5. Touch Control Area

Wear

Step1: Choose comfortable earbuds

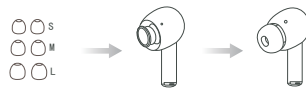

Step2: Wear it in ear and adjust to a comfortable position
(Please put the right and left earbuds on the correct ear)



Power On

Auto Power On:
Open the charging case, earbuds will power on automatically.

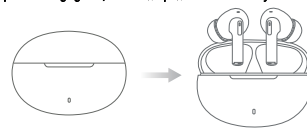

Manual Power On:
Long tap on touch control area of one earbud for 4s, earbud will power on and then earbud light will flash red for about 2-4 seconds, the earbuds will be automatically connected.



Power Off

Method 1
Put both earbuds into the charging case, and then close the case, earbuds will power off automatically.

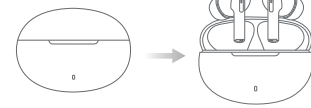

Method 2
Long tap on either earbud for 6s under the power on condition, earbud will power off, and then the Bluetooth icon on the phone shows disconnect LVTEL AirPods 6pro.



Specification

Model	D18
Version	V5.3
Charging Case Battery Capacity	200mAh
Charging Time for Charging Case	1.5 Hours
Charging Port	Type-C
Operation Mode	Touch Control
Operating Temperature Range	14°F - 113°F
Maximum Transmission Distance	<33FT

FCC Warning

This device complies with part 15 of the FCC Rules. Operation is subject to the following two conditions:
(1) This device may not cause harmful interference, and
(2) this device must accept any interference received, including interference that may cause undesired operation.
Any Changes or modifications not expressly approved by the party responsible for compliance could void the user's authority to operate the equipment.
Note: This equipment has been tested and found to comply with the limits for a Class B digital device, pursuant to part 15 of the FCC Rules. These limits are designed to provide reasonable protection against harmful interference in a residential installation. This equipment generates uses and can radiate radio frequency energy and, if not installed and used in accordance with the instructions, may cause harmful interference to radio communications. However, there is no guarantee that interference will not occur in a particular installation. If this equipment does cause harmful interference to radio or television reception, which can be determined by turning the equipment off and on, the user is encouraged to try to correct the interference by one or more of the following measures:
-Reorient or relocate the receiving antenna.
-Increase the separation between the equipment and receiver.
-Connect the equipment into an outlet on a circuit different from that to which the receiver is connected.
-Consult the dealer or an experienced radio/TV technician for help.
The device has been evaluated to meet general RF exposure requirement. The device can be used in portable exposure condition without restriction.
☎ Phone: (814) 420-2178

Auto Pairing

1. Open the charging case, the earbuds will power on automatically, then the earbuds will connect to each other and wait for pairing with your phone.

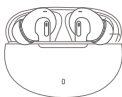

2. Turn on your phone's Bluetooth and search for "LVTEL AirPods 6pro", the earbuds will automatically connect with your phone.

Single Earbud Mode

1. Remove one earbud from the charging case (left/right) and close the charging case.
2. Turn on your phone's Bluetooth and select "LVTEL AirPods 6pro", the earbuds will be paired with your phone



Phone Calls Control

Answer / End Calls: Double tap on either earbud

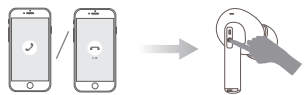

Reject Calls: Long tap on either earbud for about 1s



Note: The earbuds can be use individually or simultaneously

Music

Pause / Play:
Double Tap on either earbud



Previous Track: Quick triple tap on left earbud



Next Track: Quick triple tap on right earbud



Charging Method

Charging for Earbuds:
Put both earbuds into the charging case and close the case. The earbuds are charging and the LED power display on the charging case will move.

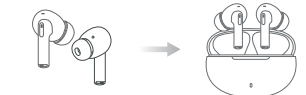

Charging for the case:

Use Type-C charging cable to connect an adapter (not provided) to charge your charging case. The charging case is charging when red indicator light flashes, once charging case is full, the indicator light stays red. (Charging time: 1.5 hours)

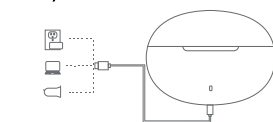

Security Guidance

- Using earphone at medium to high volume levels may result in permanent hearing damage. For your safety, it is recommended that you adjust the volume to a low to medium level.
- Do not use the earphone while driving a car, riding a bicycle, or performing other activities that require you to hear the sounds around.
- Do not use the earphone during thunderstorms, as the earphone may not function properly under such conditions and increases the risk of being struck by lightning.
- The earphone may not function properly under high temperature or high humidity conditions. Do not use any caustic cleaners/oils to clean the earphone.
- If the earphone is accidentally immersed in water, do not turn it on until it is completely dry.
- Please use the original charging cable provided by the earphone manufacturer for charging and select the appropriate adapter.

FAQ

Q: Why can't these earbuds pair with my phone?

- A: 1. Please make sure the earbuds are fully charged and turned on.
2. Please make sure your phone's Bluetooth is turned on.
3. If there is no problem with either of the above, please -insert the earbuds into the earbud charging case again and close the case, keep it on for 1 minute, and open the charging case and reconnect the earbuds to your phone.

Q: Why can't the earbuds charge and disconnect even after I put them into the charging case and close the case?

- A: Please make sure the charging case are not in low battery, if the charging case are in low battery, earbuds can not be charged and not disconnected even though they are in case. So, please use the type-c cable to charge the case fully.

Q: Why is the music intermittent?

- A: First of all, please do not allow more than 33 feet (unobstructed) between your earbuds and your phone. If the distance is less than 33 feet, please note the following two tips:
1. Please make sure there are no obstacles between your earbuds and your device.
2. Please make sure there are no microwave ovens/Wifi transmitters around, they are more likely to generate electromagnetic interference and cause signal interruption.

Warranty and Customer Support

If you have any issues, please feel free to contact us, and we will reply within 24 hours. We offer a lifetime warranty, if you are not satisfied with the quality, you can always contact us for a replacement or refund!
☎ Email: support@lvitel.net
Please have your order ID ready before contacting.