

# Smart vacuum cleaner

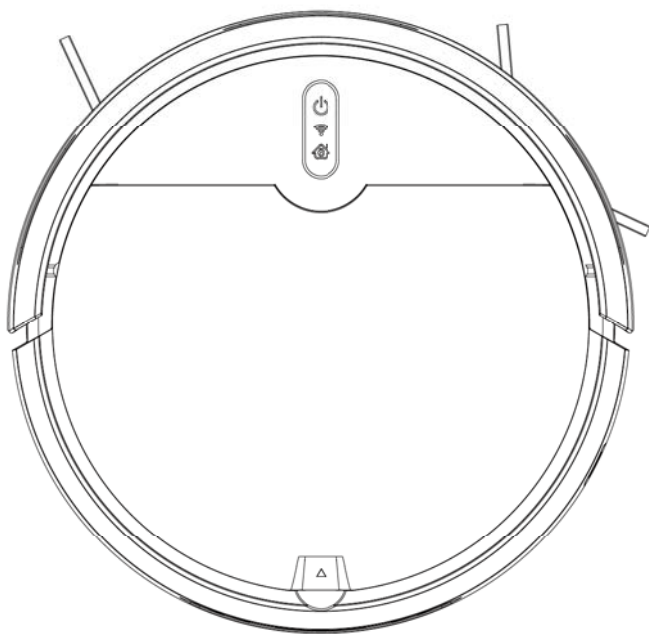

## Instruction manual

Thank you for purchasing this product, please read the instructions carefully before use.

# Safety Instructions

## Please follow the following safety precautions before using the product:

- Please read this manual carefully before using the product and use the product according to the instructions in this manual.
  - Keep it properly.
  - If you need to transfer the product to a third party, please attach the manual together with the product.
  - Any operation inconsistent with this manual may lead to the damage of the product and personal injury.
- 

### \*Caution

---

1. This product can only be dismantled by authorized technician. Such behavior without permission is not suggested.
2. Only the power adapter provided by the factory can be used with this product. The use of adapter of other specification may cause damage to the product.
3. Don't touch the cord, charging base and power adapter with a wet hand.
4. Keep the opening and running parts free of curtain, hair, clothes or finger.
5. Don't put the cleaner around burning objects, including cigarette, lighter or anything that is likely to cause fire. Don't use the cleaner to pick up combustible material, including gasoline or toner from printer, copier and mixer. Don't use it with inflammable around.
6. Please clean the product after charging, and turn off the product switch before cleaning.
7. Do not over-bend wires or place heavy or sharp objects on the machine.
8. This product is an indoor household appliance, please Don't use it outdoors.
9. The cleaner can't be used by children of 8 years and below or persons with mental disorder, unless they have been given supervision or instruction concerning the use of this appliance. Don't let your children ride on or play with the cleaner.

10. Do not use this product on wet or watery ground.
11. Possible problems in product cleaning shall be eliminated as soon as possible. Please clear up any power cord or small object on the floor before using the cleaner in case they hinder the cleaning. Fold over the fringed hem of carpet and prevent curtain or tablecloth from touching the floor.
12. If the room to be cleaned contains a staircase or any suspended structure, please test first whether the robot will detect it and not fall off the edge. If a physical barrier is needed for protection, make sure the facility does not cause such injury as tripping
13. When the product is not used for a long time, the machine shall be charged every three months to avoid battery failure due to low power for a long time.
14. Don't use it without dust bin and filters in place.
15. Make sure the power adapter is connected to the socket or charging base when charging.
16. Avoid any cold or heat. Operate the robot between -10°C to 50°C.
17. Before discarding the product, disconnect the cleaner from charging base, turn off power and remove the battery.
18. Make sure the product is not powered on when removing the battery.
19. Please remove and discard the battery in accordance with local laws and regulations before discarding the product.
20. Do not use the product with a damaged power cord or power socket. Do not use the product when the product cannot work normally due to falling, damage, outdoor use or water ingress.

# Product Introduction

WIFI light  
(Some products have this function)  
(Connect to mobile APP)

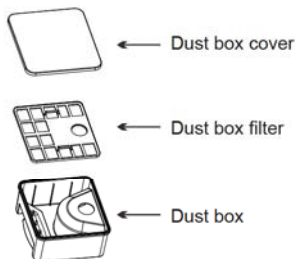
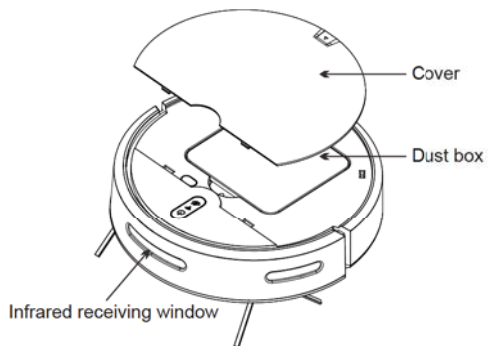
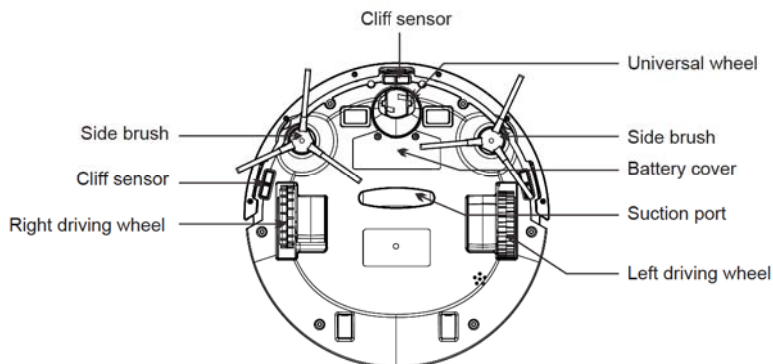
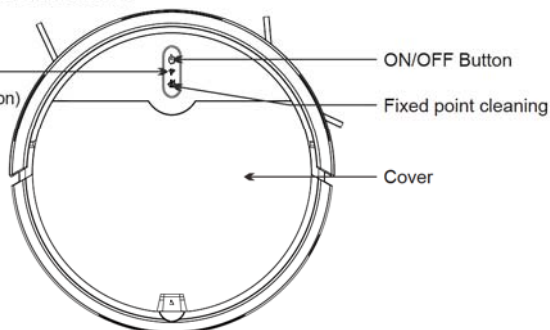

# Product packaging and parameters

## 1. Product packaging list

Main machine (including battery) X 1

Power adapter X 1

Side brush X 2

Charging dock X 1

Water tank (including mop) X 1

User manual X 1

## 2. Technical parameters

### Host machine

| Name            | Parameters      |
|-----------------|-----------------|
| Dimension       | 290x290x78mm    |
| Rated voltage   | 7.4V            |
| Rated power     | 15W             |
| Charging time   | About 4-6 hours |
| Cleaning time   | ≥ 80min         |
| Dust box volume | 370ML           |

### Adapter

| Name            | Parameters  |
|-----------------|-------------|
| Input voltage   | AC 100-240V |
| Input frequency | 50 - 60Hz   |
| Output voltage  | DC 12V      |
| Output current  | 1A          |

\* For the purpose of continuous improvement, all rights to change and interpret are reserved in terms of technology and design regarding the product.

\* The models only differ slightly in color and appearance without other essential difference.

# Charging guide

## How to use the charging base

(some products have this function)

Place the charging base on the flat ground, then connect the power adapter. The power indicator will be constantly on. The indicator light of the charging base will go out during normal charging.

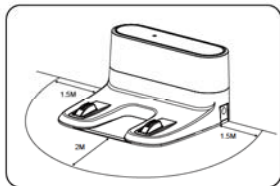

### \* Notes

Place the charging base on the flat ground, with the back against the wall, and remove all obstacles around the charging base of about 1.5 meter in width and 2 meters in front of the charging base, as shown in the figure.

## Two charging methods

1. Directly plug the power adapter into the machine, with the other end connecting with power Supply, as shown in figure A. Please use the power adapter provided.
2. Use the charging base for charging, as shown in figure B. (some products have this function)

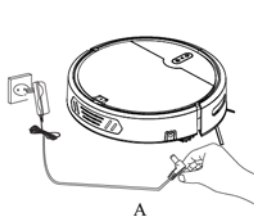

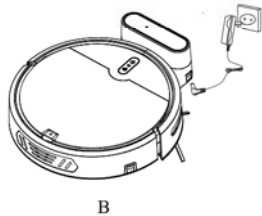

A



B

### • Notes

- A. Please charge the machine for not less than 12 hours when charging for the first time, and charge it until the red light of the power key  and  breathe. When the battery is fully filled, the green light will be constantly on.
- B. For daily use, please store the machine on the charging stand and make sure the charging stand is powered on.
- C. When not in use for a long time, please full charge the machine, turn off the power switch and store it in a cool and dry place.
- D. When setting the reservation mode, do not use manual charging mode. It is recommended to use automatic charging mode.

# Product operation

## 1. Water tank installation (some products have this function)

1. Paste the mop on the magic tape of the water tank.

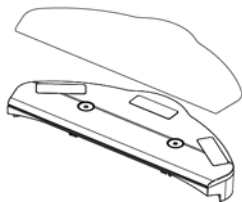

2. Open the inlet on the water tank and slowly inject the water into the water tank.

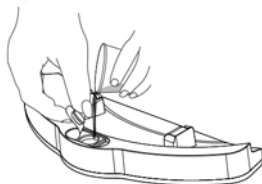

3. Place the bottom of the machine upward, align the positioning column of the water tank with the positioning hole of the carriage at the bottom of the machine, and press the water tank tightly.

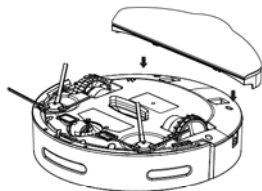

### Attention:

- The water tank has no function of closing water seepage, and it will start to seep after water injection. Please remove the water tank before charging.
- Pay attention when using the water tank, add water or clean in time, please remove the tank before adding water.
- Please do not use a water seepage tank on the carpet. When using the water tank to mop the floor, please fold up the edge of the carpet, so as to avoid foreign matters on the rag from polluting the carpet.
- After cleaning the mop, it is necessary to dry the mop until it does not drip, and then install it on the water tank. At the same time, the mop needs to be flat.

## 2. Power on

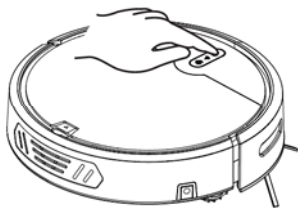

Function key



- On-off key
- WiFi light (some products with this function)
- Recharge key

Power on: Long press  key for 3 seconds to power on

Indicator status:

1. Start: The corresponding function is green on
2. Exception: The red light is blinking
3. Charging: red light breathing
4. Full: The green light is steady on

## Remote control unit

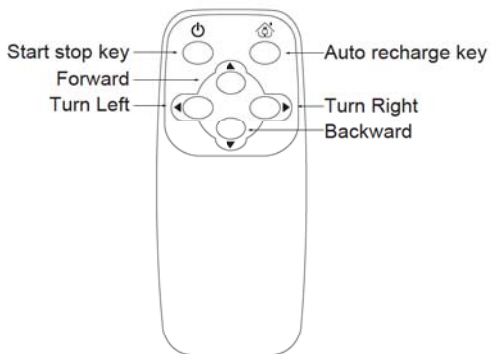

## Precautions before use

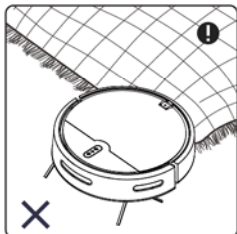

Fold the fringed edge of the carpet to prevent entanglement of the robot.

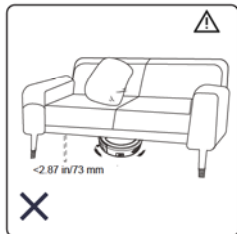

The robot cannot be used in a space lower than 73mm in height.



The machine should be used in a fenced environment to prevent the product from hanging and falling.

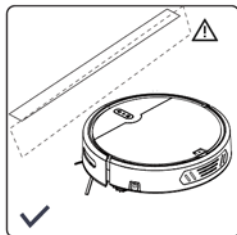

If they are dirty or used on reflective/dark colored floors, the effect may be reduced.



# Product maintenance

## 1. Clean the dust box



Open the cover.

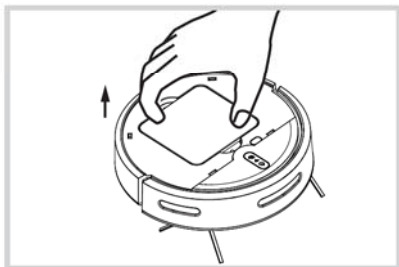

Take out the dust box.

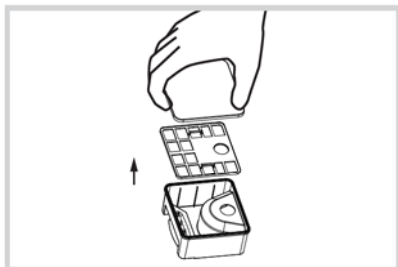

Dust box: Open the dust cover and remove the air filter.

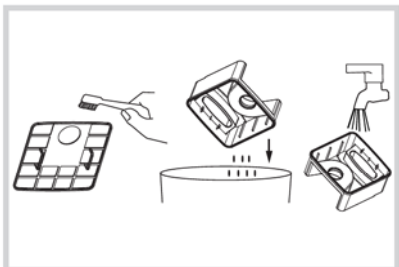

Clean the dust box: clean the filter with a brush, dump the garbage in the dust box, and then clean the dust box with water and wipe it dry.

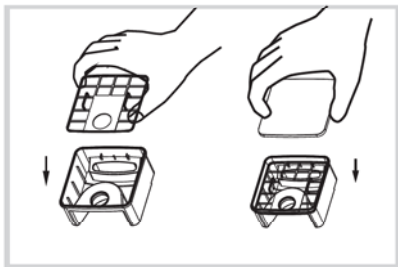

After cleaning, cover with dust cover and filter.

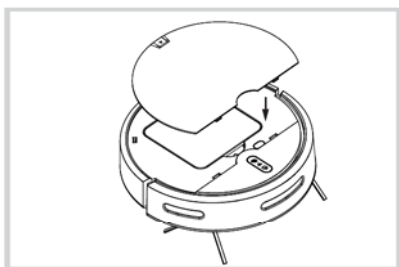

Put the dust box back into the sweeper and close the flap.

## 2. Clean other components

### Clean the side brush

Remove the side brush and wipe it with a clean cloth.

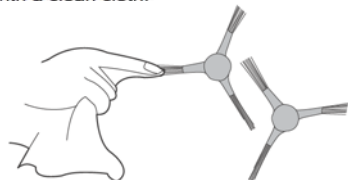

### Clean universal wheel

Clean the universal wheel to remove hair entanglement.

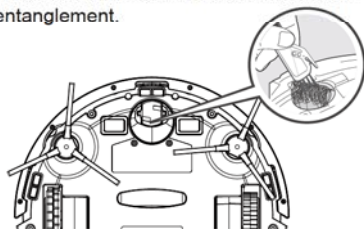

### Clean the cliff sensor

Clean the cliff sensor to ensure sensor sensitivity.

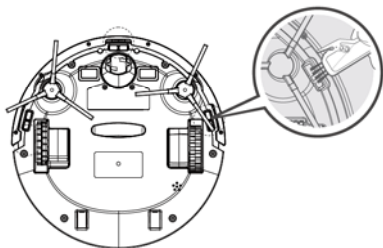

### Clean the sensor window

If there is a lot of dust in the suction port, please clean it with a cloth.

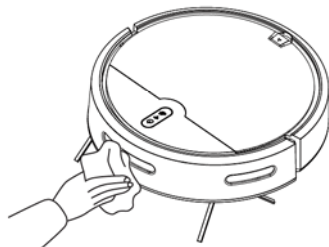

### Clean the charging electrode

Please use a dry cloth to clean the bottom of the machine and the charging electrode on the charging dock.

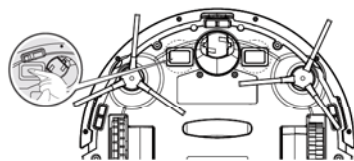

# Troubleshooting

| No. | Fault Condition   | Possible Reasons  | Solution  |
|-----|---|---|---|
| 1   | Robot fails to connect the APP  | Wrong router user name and password.  | Reset the correct router user name and password   |
|     |   | Robot is not in network signal range.   | Make sure the robot is in network signal range  |
|     |   | Robot is not configured.  | Configure the network for the robot.  |
|     |   | Robot does not connect to 2.4GHz network  | Robot can not connect to 5GHz network, please connect to 2.4GHz network.  |
| 2   | Robot fails to charge   | The adapter is not the original model   | The original adapter model should be used.  |
|     |   | Poor charging electrode contact when placing robot on the charging dock.  | Ensure that the robot and the charging electrode are fully plugged in place. Check whether the charging electrode and the machine are dirty and it should be cleaned by referring to the Maintenance instructions.  |
|     |   | The charging dock is not connected to the power supply.   | Make sure that the charging dock and the power supply is connected.   |
|     |   | Long-term non-use leads to battery overdischarge.   | If it is not used for a long time and cause the battery can not be charged, please contact after-sales service personnel.   |
| 3   | Robot fails to recharge   | The charging dock is placed incorrectly.  | Place the charging dock correctly according to the Charging method.   |
|     |   | The charging dock is powered off or manually moved.   | Please check whether the charging dock is connected to the power supply. Do not move the charging dock.   |
|     |   | The machine is stuck by ground obstacles (such as wires, carpet corners, electric fan base, etc.) or the door of the room with the charging dock is closed, which makes it impossible to return to the charging dock. | It is recommended to remove the ground objects with reference to the Precautions before using the robot to ensure smooth running. Avoid jamming and keep the recharging route smooth.   |
|     |   | The main engine did not start cleaning from the charging stand.   | It is recommended that the robot start cleaning from the location of the charging dock.   |
| 4   | When the robot is working, there are situations such as disorderly route, deviation, repeated cleaning and small areas fails to get cleaned up. | Wires, slippers and other objects placed on the ground affect the normal operation of the robot.  | Please arrange scattered wires, slippers and other objects on the ground before the robot works. In case of areas fails to get cleaned up, the robot will automatically detect the area and complete the cleaning, please do not intervene manually (such as moving the robot or blocking the robot's working route). |
|     |   | Working on the newly waxed and polished floor reduces the friction between the driving wheel and the ground.  | It is recommended to use the robot after the floor wax is dry.  |
|     |   | Due to different home environments, the robot cannot perform cleaning in some area.   | It is suggested to arrange the home environment to ensure that the robot can work on the floor.   |
| 5   | Robot is stuck during operation   | The robot is entangled or obstructed by scattered wires, drooping curtain cloth, carpet whisker, etc. on the ground.  | The robot will try to get out of trouble independently. If it fails to get out of trouble, it is recommended to help manually.  |
|     |   | The robot may be stuck by furniture which its bottom height is similar to that of the robot.  | It is suggested that furniture should be raised or sheltered artificially.  |
| 6   | When the robot is working, the running sound is loud  | Side brushes are entangled, dust bin and filter materials are blocked, etc.   | It is recommended to clean and maintain the side brushes, dust bin and filter materials regularly.  |
| 7   | Rolling brush does not rotate   | The rolling brush is entangled with hair.   | Remove the hair sewed on the rolling brush.   |
|     |   | Rolling brush and rolling brush shield are installed incorrectly.   | Reinstall the rolling brush assembly.   |
|     |   | The rolling brush assembly sucks in foreign matter.   | Disassemble the assembly and remove the foreign matter from the rolling brush assembly.   |
| 8   | Remote control failure  | Low battery of the remote controller .  | Replace the battery.  |
|     |   | The robot is turned off or low battery of the robot.  | Ensure that the machine power switch is turned on and the battery is full.  |

|                               |                              |  |   |
|-------------------------------|------------------------------|--|---|
| 9                             | Robot fails to start         | The robot is out of power or the power switch is off.                        | Please charge the robot or turn on the power switch.                    |
|                               | Robot shakes when running    | Side brush or caster tangled with hair.                                      | Please remove hairs from the side brush or the universal wheel.         |
|                               | Abnormal operating condition | The intake port is blocked or the dust bin is full.                          | Please check the suction port and clean the dust bin.                   |
|                               |                              | HEPA is blocked.   | Clean or replace the HEPA   |
|                               | Water not coming out.        | The outlet hole of the water tank is blocked or the water tank has no water. | Please blow the water outlet and fill it with water.                    |
|                               |                              | The pump does not work.  | Please contact our company for after-sales maintenance.                 |
|                               | Machine skid                 | The ground is too wet.   | Please wring out the mop cloth and clean the water stains on the floor. |
| Machine keeps going backwards | Abnormal cliff sensor        | Please clean the surface of the cliff sensor.                                |   |

If the problems cannot be solved according to the above operation, please contact the after-sales service.

## Warning code table

Robot will emit a series of beeps when it is in trouble, and the red light will flash or keep on.

|    |  |                        |  |
|----|--|------------------------|--|
| 1. | Beep once and the red light stays on               | Wheel is stuck         | please check if there are anything in the wheel gap and clean it up.         |
| 2. | Beep once and the red light keeps flashing         | Front bumper is stuck  | please check bumper Whether stuck and clean foreign matter in it.            |
| 3. | Beeps twice and the red light keeps flashing       | Side brush abnormal    | please check whether the side brush is entangled with hair and clean it up.  |
| 4. | Beeps three times and the red light keeps flashing | Ground sensor abnormal | Please check whether the ground sensor is covered by dirt and wipe it clean. |
| 5. | Beeps four times and the red light keeps flashing  | Power run cut          | please charge it as soon as possible.  |

### • Warm tips

If the above method does not solve the problem, please try the following:

- Restart the power of the machine.
- If the problem cannot be solved by restarting the machine, please send the machine to the after-sales service center for maintenance.

FCC Caution.

This device complies with part 15 of the FCC Rules. Operation is subject to the following two conditions:

- (1) This device may not cause harmful interference, and
- (2) this device must accept any interference received, including interference that may cause undesired operation.

Any Changes or modifications not expressly approved by the party responsible for compliance could void the user's authority to operate the equipment.

Note: This equipment has been tested and found to comply with the limits for a Class B digital device, pursuant to part 15 of the FCC Rules. These limits are designed to provide reasonable protection against harmful interference in a residential installation. This equipment generates uses and can radiate radio frequency energy and, if not installed and used in accordance with the instructions, may cause harmful interference to radio communications. However, there is no guarantee that interference will not occur in a particular installation. If this equipment does cause harmful interference to radio or television reception, which can be determined by turning the equipment off and on, the user is encouraged to try to correct the interference by one or more of the following measures:

- Reorient or relocate the receiving antenna.
- Increase the separation between the equipment and receiver.
- Connect the equipment into an outlet on a circuit different from that to which the receiver is connected.
- Consult the dealer or an experienced radio/TV technician for help.

\*RF warning for Mobile device:

This equipment complies with FCC radiation exposure limits set forth for an uncontrolled environment. This equipment should be installed and operated with minimum distance 20cm between the radiator & your body.