

# User Manual

For CarPlay & Android Auto

# (1) Product introduction

---

Car intelligent conversion box, mainly used for realizing the Wireless interconnection of mobile phone and car.

The conversion function integrates the mobile phone and the car screen, which will convert the diversified Mobile phones to car entertainment, providing users with music & abundant driving pleasure, reducing the frequency of using the mobile phone, providing users with a safer driving Car experience.

## (2) Wireless CarPlay— iOS Phone User

---

1. Connect the box to the original car USB or Type-C data interface; Read box data and wait for a Connection.

Turn on WLAN

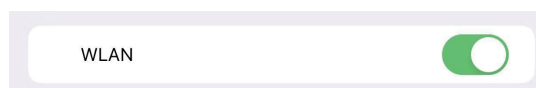

2. Turn on the Bluetooth of the iPhone, search for the Bluetooth Device naming "OKBox-BT\_\*\*\*\*" or "smartBox-\*\*\*\*" or "AIBox-BT\_\*\*\*\*" Pair it and allow the sync, finally click "Use CarPlay"

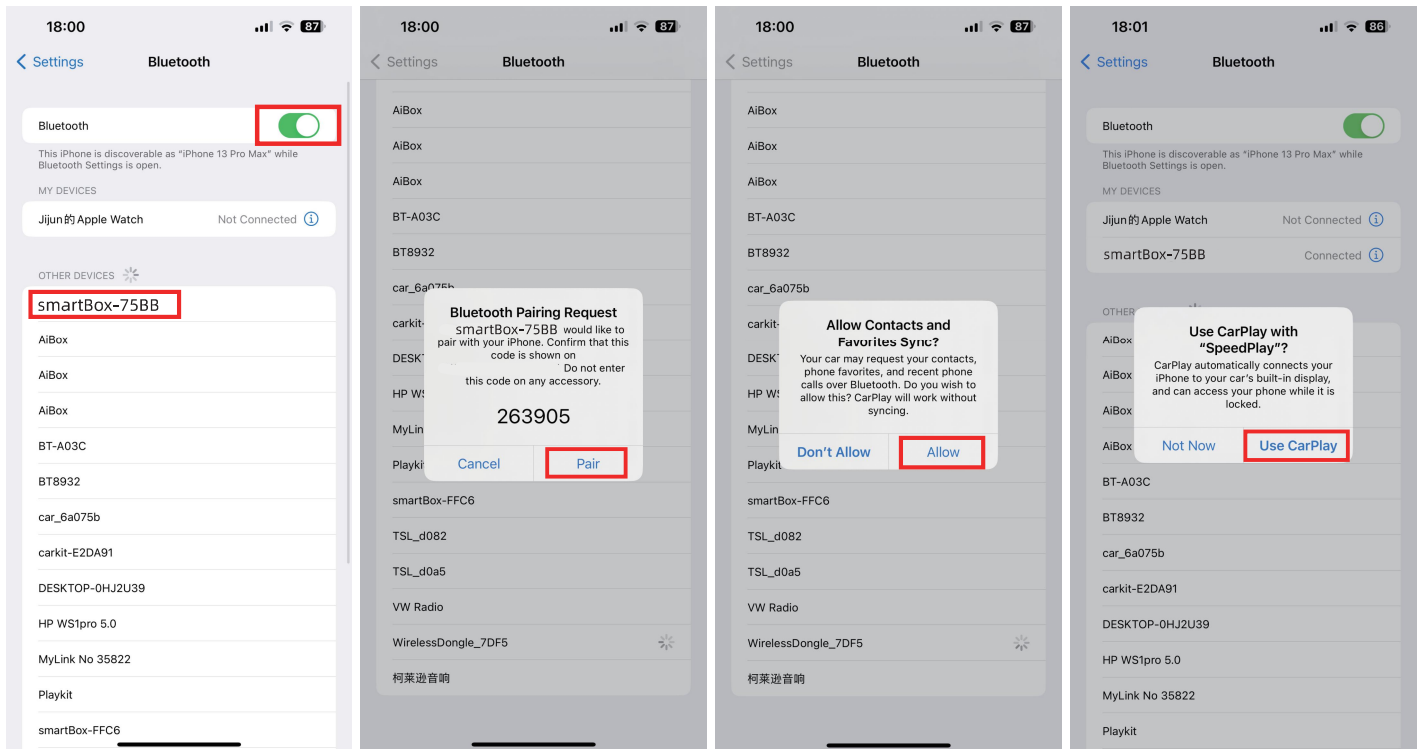

3. After the Connection please wait for a few seconds and CarPlay interface will be shown.



### (3) Wireless Android Auto—Andrid Phone User

1. Connect the box to the original car USB or Type-C data interface; Read box data and wait for a Connection.

Turn on WiFi



2. Turn on the Bluetooth of the Phone, search for the Bluetooth Device naming "OKBox-BT\_\*\*\*\*" or "smartBox-\*\*\*\*" or "AIBox-BT\_\*\*\*\*" The device name will change to "Your Car MyLink" after the link is successful.

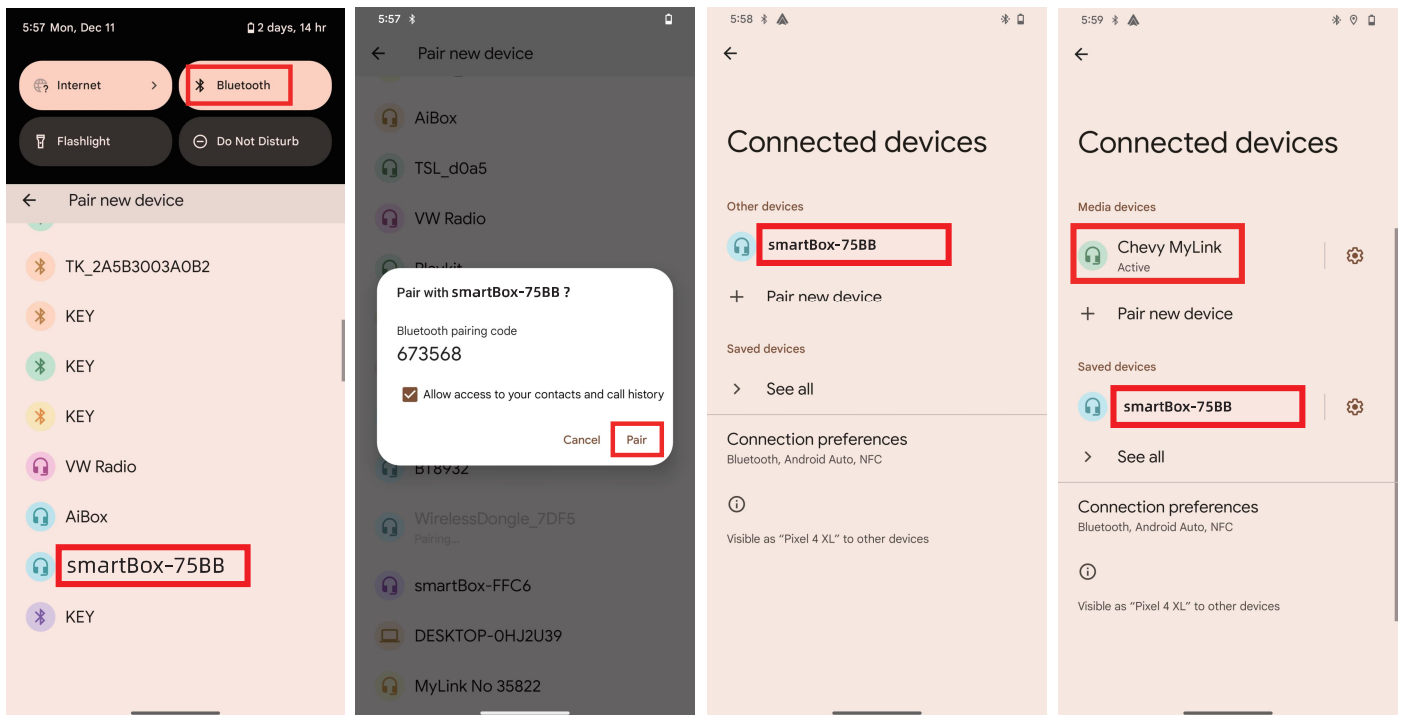

3. After the Connection please wait for a few seconds and Android Auto interface will be shown.



#### (4) If your car Built-in with wired CarPlay and wired Android Auto, both can be converted to wireless connectivity

---

You can open the corresponding options through the Settings of the original car (**Some machines do not need to be set up**), if you are an iPhone, open CarPlay for Bluetooth connection, if you are an Android phone, open Android Auto for Bluetooth connection.

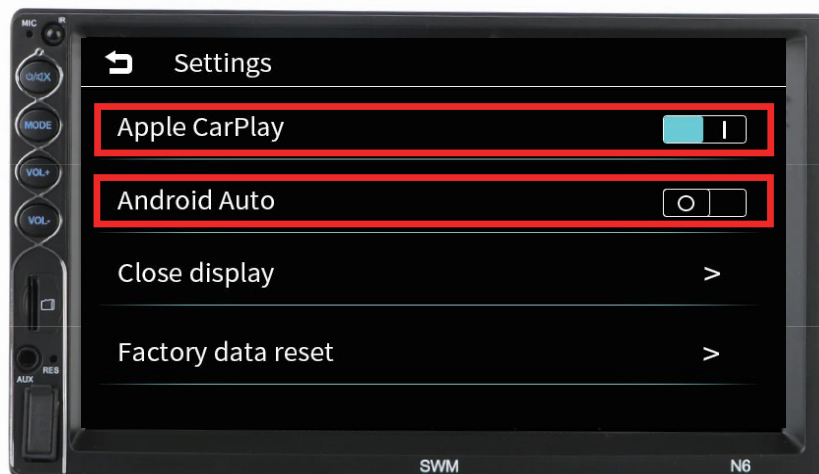

# (5) Box Upgrade

## 1. How to update the product?

Put directly into the USB 5V power supply upgrade, such as phones charger car charger USB. (If you plug the original USB port to upgrade, the upgrade will fail);



Join the WiFi devices naming "**OKBox-BT\_\*\*\*\***" or "**smartBox-\*\*\*\***" or "**AIBox-BT\_\*\*\*\***" on your Phone with password:**88888888**

### Online updates

Enter the IP Address

**192.168.1.101**

in your Browser, and press click to **upgrade**; wait for a few minutes for upgrade.

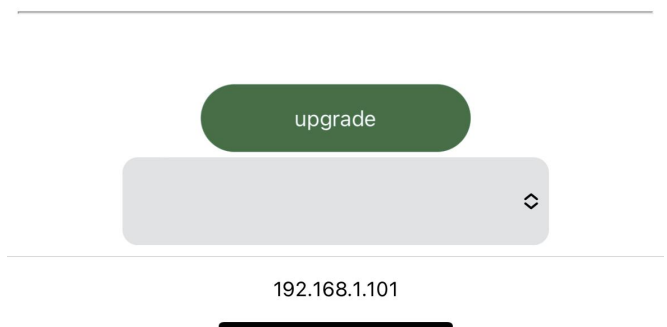

**[ Note: Please forget the Networks after upgrading successfully. ]**

## **2. Does the Ai Box have requirements for the phone?**

Yes, the wireless CarPlay is available for iOS 12.1 and above.  
wireless Android Auto is available for Android 10.0 and above.

## **3. How to check if Ai Box suit for my car?**

- a. If your Original car only supports wired CarPlay, it can only help you switch to wireless CarPlay.
- b. If your Original car only supports wired Android Auto, it can only help you switch to wireless Android Auto.
- c. If your Original car supports wired CarPlay and Android Auto, it can help you switch to wireless CarPlay and wireless Android Auto.

**[ Depending on whether the original car supports this feature, it just helps you switch from wired to wireless ]**

## **4. Do i have to sync the wireless Ai box adapter every time when starting my car?**

Don't worry, After the first adaptation, the wireless CarPlay or Android Auto adapter will automatically match the Bluetooth and WiFi of your iPhone every time.

## **5. How to upload the log data when the adapter doesn't work for my car unit?**

Please enter the IP address page & fill in the car info in the problem description sheet, and press "Submit" to upload your log data.



# (6) FCC Statement

---

This device complies with part 15 of the FCC Rules. Operation is subject to the following two conditions: (1) This device may not cause harmful interference, and (2) this device must accept any interference received, including interference that may cause undesired operation.

Note: This equipment has been tested and found to comply with the limits for a Class B digital device, pursuant to part 15 of the FCC Rules. These limits are designed to provide reasonable protection against harmful interference in a residential installation. This equipment generates, uses and can radiate radio frequency energy and, if not installed and used in accordance with the instructions, may cause harmful interference to radio communications. However, there is no guarantee that interference will not occur in a particular installation. If this equipment does cause harmful interference to radio or television reception, which can be determined by turning the equipment off and on, the user is encouraged to try to correct the interference by one or more of the following measures:

- Reorient or relocate the receiving antenna.
- Increase the separation between the equipment and receiver.
- Connect the equipment into an outlet on a circuit different from that to which the receiver is connected.
- Consult the dealer or an experienced radio/TV technician for help.

Note: The Grantee is not responsible for any changes or modifications not expressly approved by the party responsible for compliance. Such modifications could void the user's authority to operate the equipment.

The device has been evaluated to meet general RF exposure requirement.

This equipment complies with FCC's RF radiation exposure limits set forth for an uncontrolled environment. This device and its antenna(s) must not be co-located or in conjunction with any other antenna or transmitter.