

### FCC Caution:

This device complies with part 15 of the FCC Rules. Operation is subject to the following two conditions: (1) This device may not cause harmful interference, and (2) this device must accept any interference received, including interference that may cause undesired operation.

Any changes or modifications not expressly approved by the party responsible for compliance could void the user's authority to operate the equipment.

NOTE: This equipment has been tested and found to comply with the limits for a Class B digital device, pursuant to Part 15 of the FCC Rules. These limits are designed to provide reasonable protection against harmful interference in a residential installation. This equipment generates, uses and can radiate radio frequency energy and, if not installed and used in accordance with the instructions, may cause harmful interference to radio communications. However, there is no guarantee that interference will not occur in a particular installation.

If this equipment does cause harmful interference to radio or television reception, which can be determined by turning the equipment off and on, the user is encouraged to try to correct the interference by one or more of the following measures:

- Reorient or relocate the receiving antenna.
- Increase the separation between the equipment and receiver.
- Connect the equipment into an outlet on a circuit different from that to which the receiver is connected.
- Consult the dealer or an experienced radio/TV technician for help.

The device has been evaluated to meet general RF exposure requirement. The device can be used in portable exposure condition without restriction.

## wireless headphone

Operating instruction

### K10

Product parameters are laboratory test data, the specific data is subject to the use of data

### Product diagram



### Headset Configuration

Product Model: K10  
Running time: about 5 hours  
Operation mode: Touch control  
Effective distance: ≥10 m

Version: 5.3  
Talk time: about 5 hours  
Charging time: about 1 hour  
Horn: copper ring 8mm

### Packing list

1. Charging box \*1
2. Left and right earphones \*1
3. Large ear cap \*2
4. Product Manual \*1
5. Charging cable \*1

### Charging bin configuration parameters .

Charging port: Type-C  
Charging time: about 1 hours  
Input voltage: 5V/ 500mAh

### Wearing a way

Open the cover of the charging bin, take out the earphone of the right ear, and put the earphone horn end. Gently put into the ear canal of the right ear, and then gently swing the earphone not to shake. Wear the left earpiece in the same way.

### Mode of operation

#### 1. The boot

- (1) Open the cover of the charging bin, take out the earphone and turn it on Blue lights flashing
- (2) When the dryer is off, press the button for 3 seconds to start the machine

#### 2.To turn it off

- (1) Put the earphone back to the charging bin, and the earphone will automatically shut down and charge
- (2) When the headset is on, press the button for 5 seconds to power off the headset

### Pairs of ears connected

1. Open the cover of the charging bin, take out the earphone and start it automatically. The red and blue lights are flashing, and we're in automatic formation mode, one of them headphones lights went out, said a team success.
2. Open the wireless list of the device and search for "K10".
3. Click "K10" to connect. If the connection fails, Put the earphones back on the cover of the charging bin. Put the lid on and repeat the top The operation procedure is ok.
4. Ears left connected to the equipment normal distance at the same time, Headset The headset is connected back to the wireless headset, and the connection is not completed with in 5 minutes if the connection is successful, both ears will shut down automatically.
5. Double-click after the headset is turned on and before the phone is disconnected Automatically switch between Chinese and English on either side of ears  
(Only Chinese or only English products do not have this function)

After the device is connected for the first time, the next time the headset is restarted. It will automatically connect the last pair device

### Two-ear touch operation

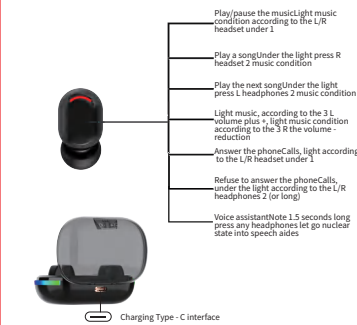

Earphone charging: The earphone is automatically charged in the charging case The charging indicator light is red and the red light goes out when it is full  
Charging case low power: digital tube single digit flashing  
Charging case charging: digital tube single digit flashing, full 100 stop

### F&Q

1. Q: How come only one earphone has sound?  
A: Put the two earphones back into the charging bin at the same time, close the cover to charge, and then take them out to see whether the dual-ear mode is restored  
If the fault is not rectified, restore the fault to factory Settings
2. Q: The phone can't connect to the headset?  
A: Delete the paired K10 on the mobile phone, and then make the paired connection.
3. Q: How can I listen to music/talk without sound?  
A: Android phones have a setting icon on the right side of the phone onnection record. Click enter to select two audioDeselect and then re-select. Enter audio Call mode in Setting General Accessibility, and select Automatic, if it is automatic, then other options, and then change to automatic, if not restored, Delete the pairing record retry attempt.
4. Q: Why is there a stutter/ stutter?  
A: If you use headphones, there are a lot of Wi-Fi devices, 4G signals, high power appliances and so on interference, stuttering and discontnuous conditions may occur, and the connection can be restored by changing the environment or re-pairing. .

### Matters needing attention

1. Please use a charger with safety certification from a formal source for charging
2. Adjust the volume of headphones to avoid damage to hearing
3. the correct use of the product to avoid falling from high or heavy extrusion
4. Children should be accompanied by adults to avoid accidental ingestion
5. Stay away from extreme environments such as high temperature or humidity
6. Do not disassemble the product