



## RETRO STYLE SPEAKER

MODEL: 4001974

### USER MANUAL



#### Operation Explanation:

#### Specifications :

Output power: 240 Watts  
 Driver Units: 5.25"x2 +3"x2+1"x2  
 Frequency response: 35Hz-20KHz  
 Separation: ≥40dB  
 S /N: ≥55dB  
 Distortion: ≤1%(1K,1W)  
 Power supply: ~100-240V 50/60HZ  
 Dimensions: L400 x H274 x D228(mm)

#### Features:

- Full audio spectrum performances, ideal for your favourite entertainment from Mp3, Mp4, CD/DVD movies and digital playbacks.
- Quality materials : Only the best components to recreate sound faithfully across all frequencies.
- Slim design

#### Package contents:

Speaker Unit	-----	1 pc
User manual	-----	1 pc
Audio input cord	-----	1 pc
Power cord	-----	1 pc
Remote control	-----	1 pc
FM Antenna	-----	1 pc

NO.1

#### Front panel

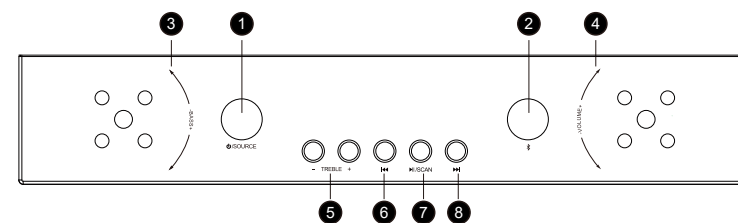

1.  $\phi$  /SOURCE: Turn on/Stand-by the speaker.  
SOURCE: Change the BT/Hd/OP/ARC/Ud/FM mode.
2. " BT " Denotes Bluetooth Mode.
3. BASS-/+ : Decrease/increase the bass.
4. Volume-/+ : Decrease/increase the volume.
5. TREBLE-/+ : Decrease/increase the treble.
6. " ⏮ " Press to play previous song, Press and hold to rewind.
7. " ⏸ /SCAN " Play/Pause the songs.In FM mode,press and hold to automatically search for FM radio stations.
8. " ⏭ "press to play next song,press and hold to fast foward.

NO.2

#### HOW to use the remote control

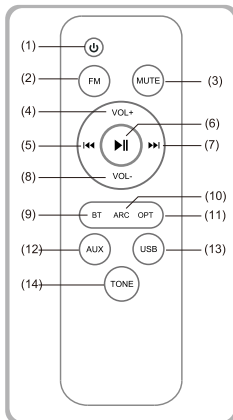

1.  $\phi$
2. FM
3. MUTE
4. VOL+
5. ⏮
6. ⏸
7. ⏭
8. VOL-
9. BT
10. ARC
11. OPT
12. AUX
13. USB
14. TONE

1.  $\phi$  : Power ON or standby modes.
2. FM: Press " FM " to enter FM mode.
3. MUTE: Short press is mute, long press is reset.
4. VOL+: Volume up.
5. ⏮: In BT&USB mode, short press "⏮" is playing previous song; in USB mode long press "⏮" is fast backward.In FM mode, short press "i" is playing last channel.self auto searching the previous channels.
6. ⏸: In BT&USB mode, short press "⏸" is Play or Pause, long press to force disconnect "⏸" the BT.In FM mode, short press "⏸" is choosing channels,long press "⏸" it will enter into automatic search channel.
7. ⏭: In BT & USB mode, short press "⏭" is playing next song; In USB mode long press "⏭" is fast forward; In FM mode, short press "⏭" is playing next channel, long press "⏭" is self auto searching the next channels.
8. VOL-: Volume down.
9. BT: Bluetooth mode.
10. ARC : ARC mode.
11. OPT: Optical mode.
12. AUX: AUX mode.
13. USB: USB mode.
14. TONE :Press to adjust Bass&Treble settings by using VOL+/-buttons.Bass&Treble levels: -6(min)~+6(max).

NO.3

#### BT Pairing Method

IN Bluetooth input mode, LED display start to flash fast to search the Bluetooth device. Turn on your mobile Bluetooth device and search the devicename " 4001974 ", paired them well. When you have successfully paired your mobile to the speaker system, the LED flashes slowly.When starting to play your mobile music, the LED is on . The functions as "PREVIOUS/NEXT", "PLAY/PAUSE", can operate via the front panel. On BT mode, when connecting with mobile, press "⏸" for 3 seconds, bluetooth function can be for disconnected.

#### Rear panel

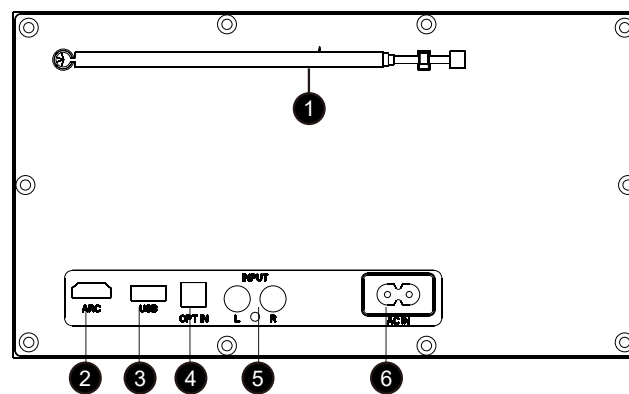

- 1.FM ANTE
2. ARC Input
- 3.USB Slot
- 4.OPTICAL Input
- 5.INPUT L/R Input
- 6.AC Power cord



\*\*\*Do NOT use USB for charging devices which can cause damage to your external devices. thank you.

NO.4

#### When in use please pay attention to the following items :

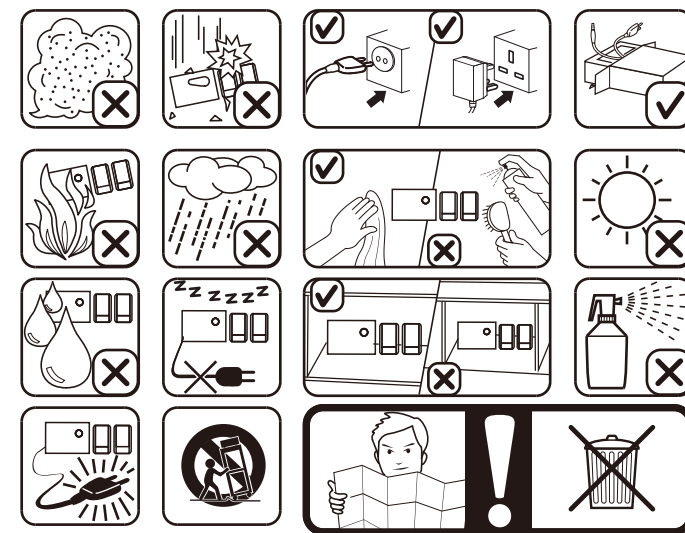

NOTE: The Remote Control range is restricted to within 5m to preserve the Retro aesthetics of the model using high quality metal mesh on the unit face. \*if the remote control cannot function, it is because the battery of remote control has been used up. thank you.



NO.5



**ALTAVOZ ESTILO RETRO**  
**MODELO: 4001974**  
**MANUAL DE USUARIO**



**Operación:**

**Especificaciones:**

Potencia desalida: 240Watts  
Bocinas internas: 5.25"x2 +3"x2+1"x2  
Respuesta de frecuencia: 35Hz-20KHz  
Separación: ≥40dB  
S /N: ≥55dB  
Distorsión: ≤1%(1K,1W)  
Alimentación: ~100-240V 50/60HZ  
Dimensiones: L400 x H274 x D228(mm)

**Características:**

- desempeño pleno de espectro de audio, ideal para disfrutar su entretenimiento favorito de Mp3, Mp4, películas en línea o CD/DVD.
- Materiales de alta calidad :Solo los mejores componentes pueden entregar el espectro completo de frecuencias de alta calidad.
- Diseño compacto.

**Contenido del paquete:**

Unidad principal	-----	1 pc
Manualde usuario	-----	1 pc
Cable de entrada de Audio	-----	1 pc
Cable de alimentación	-----	1 pc
Control Remoto	-----	1 pc
FMAntena	-----	1 pc

NO.1

**Panel frontal**

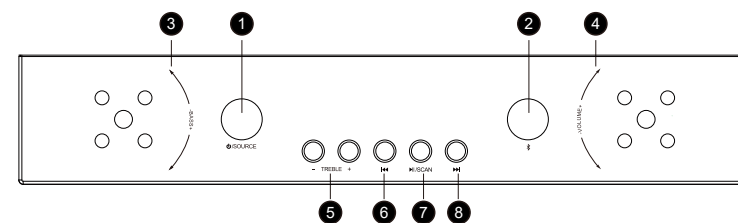

1. /SOURCE: Encender/Apagar el altavoz. FUENTE: Cambie el modo BT/HD/OP/ARC/USB/FM.
2. " BT " selecciona el modo Bluetooth.
3. BASS-/+ : Disminuye/aumenta los graves.
4. VOLUME-/+ : Disminuye/aumenta el volumen.
5. TREBLE-/+ : Disminuye/aumenta los agudos.
6. " ◀ " Presione para reproducir la canción anterior, presione y mantenga presionado para rebobinar.
7. " ▶ /SCAN " Reproducir/pausar las canciones en modo FM, manténgalo presionado para buscar automáticamente estaciones de radio FM.
8. " ▶▶ " Presione para reproducir la siguiente canción, presione y mantenga presionado para avanzar rápidamente.

NO.2

**CÓMO usar el mando a distancia**

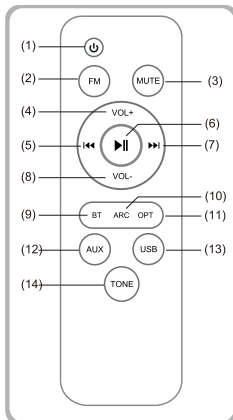

- 1.
2. FM
3. MUTE
4. VOL+
- 5.
- 6.
- 7.
8. VOL-
9. BT
10. ARC
11. OPT
12. AUX
13. USB
14. TONE

1. : Modos de encender o apagar.
2. FM: Presione " FM " para ingresar al modo FM.
3. MUTE: Pulsación corta para silenciar, pulsación larga se reinicia.
4. VOL+: Sube el volumen.
5. : En el modo BT y USB, presione brevemente "◀" reproduce la canción anterior; en modo USB pulsación larga "◀" para rebobinar. En el modo FM, presione brevemente para reproducir la última estación. Mantenga presionado para búsqueda automática de las estaciones anteriores.
6. : En el modo BT y USB, presione brevemente "▶" Reproducir o pausar, mantenga presionado para forzar la desconexión "▶" BT.En el modo FM, presione brevemente "▶" para elegir estaciones, mantenga presionado "▶" Ingresará al canal de búsqueda automática.
7. : En el modo BT y USB, presione brevemente "▶▶" reproduce la siguiente canción; En modo USB, mantenga presionado "▶▶" avanza rápidamente; En el modo FM, presione brevemente "▶▶" sintoniza la siguiente estación, mantenga presionado "▶▶" para búsqueda automática de las siguientes estaciones.
8. VOL-: Bajar volumen.
9. BT: Modo Bluetooth.
10. ARC : Modo ARC.
11. OPT: Modo óptico.
12. AUX: AUX FASHION.
13. USB: Modo USB.
14. TONE :Presione para ajustar la configuración de agudos graves mediante los botones VOL+/- . Niveles de agudos graves: -6 (min) ~ + 6 (max).

NO.3

**Método de emparejamiento BT**

En el modo de entrada Bluetooth, la pantalla LED comienza a parpadear rápidamente, para buscar el dispositivo Bluetooth, encienda su dispositivo móvil Bluetooth y busque el nombre del dispositivo "4001974", para emparejarlos. Cuando haya emparejado correctamente su móvil con el sistema de altavoces, el LED parpadeará lentamente. Al comenzar a reproducir la música de su móvil, el LED está encendido. Las funciones como "ANTERIOR/SIGUIENTE", "REPRODUCIR/PAUSA" pueden funcionar a través del panel frontal. En el modo BT, cuando se conecte con el móvil, presione "▶" durante 3 segundos, la función Bluetooth se desconectará.

**Panel posterior**

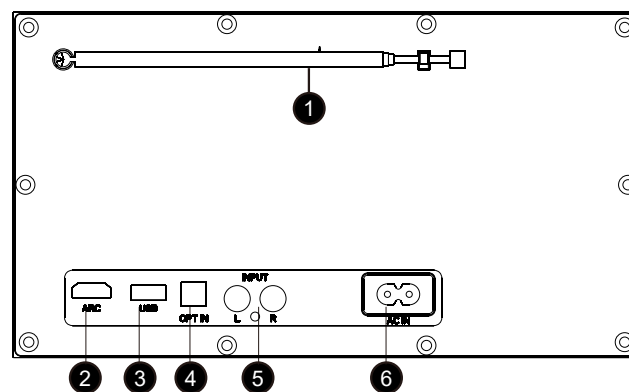

1. FMANT
2. Entrada ARC
3. Puerto USB
4. Entrada OPTICA
5. Entrada L/R
6. Cable de alimentación AC

\*\*\*NO utilice USB para cargar dispositivos esto puede causar daños al altavoz o a sus dispositivos externos. Gracias.

NO.4

**Cuando esté en uso, preste atención a los siguientes elementos :**

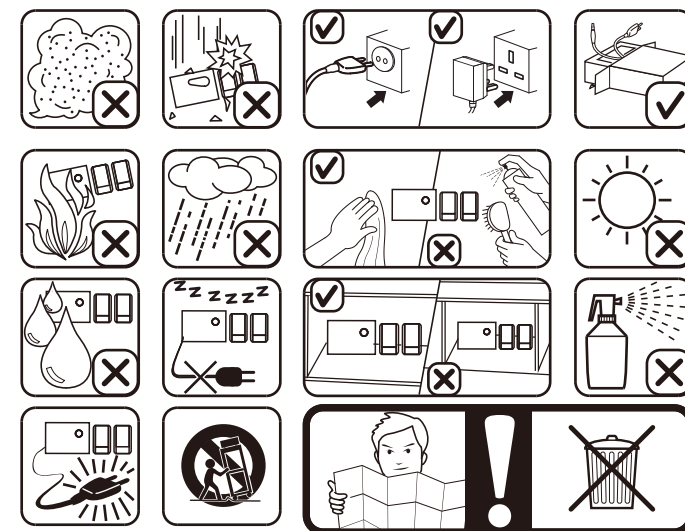

\*Si el mando a distancia no funciona, es porque se ha agotado la batería del mando a distancia. Gracias.  
NOTA: El alcance del control remoto está restringido a menos de 5 m para preservar la estética retro del modelo utilizando malla metálica de alta calidad en la cara de la unidad.



NO.5

## **FCC Statement**

This equipment has been tested and found to comply with the limits for a Class B digital device, pursuant to part 15 of the FCC rules. These limits are designed to provide reasonable protection against harmful interference in a residential installation. This equipment generates, uses and can radiate radio frequency energy and, if not installed and used in accordance with the instructions, may cause harmful interference to radio communications. However, there is no guarantee that interference will not occur in a particular installation. If this equipment does cause harmful interference to radio or television reception, which can be determined by turning the equipment off and on, the user is encouraged to try to correct the interference by one or more of the following measures:

- Reorient or relocate the receiving antenna.
- Increase the separation between the equipment and receiver.
- Connect the equipment into an outlet on a circuit different from that to which the receiver is connected.
- Consult the dealer or an experienced radio/TV technician for help.

To assure continued compliance, any changes or modifications not expressly approved by the party.

Responsible for compliance could void the user's authority to operate this equipment. (Example- use only shielded interface cables when connecting to computer or peripheral devices).

This equipment complies with Part 15 of the FCC Rules. Operation is subject to the following two conditions:

- (1) This device may not cause harmful interference, and
- (2) This device must accept any interference received, including interference that may cause undesired operation.

## **FCC Radiation Exposure Statement:**

The equipment complies with FCC Radiation exposure limits set forth for uncontrolled environment. This equipment should be installed and operated with **minimum distance 20cm** between the radiator and your body.