



Barra de sonido 2.1

Modelo: 4001949



ESTIMADO CLIENTE:
Gracias por comprar su Barra de Sonido RadioShack!
Antes del primer uso, lea atentamente el manual.

Operación:

Especificaciones:

Potencia de Salida: 300W
Bocinas: 5090 x 4 + 8"
Frecuencia de respuesta: barra: 140Hz-20KHz
subwoofer: 40Hz-150Hz
Separación: ≥40 dB
S / N: ≥55 dB
Distorsión: ≤1% (1K, 1W)
Alimentación: ~100-240V50/60Hz
Dimensiones: barra: L960 x D80 x H62 (mm)
subwoofer: L240 x W240 x H448 (mm)

Características:

- Barra de sonido de calidad con amplificador incorporado
- Funciones de espectro de audio completo, ideal para su entretenimiento desde Mp3, Mp4, películas CD/DVD y reproducción digital.
- Calidad de materiales: Sólo los mejores componentes para recrear el sonido fielmente en todas las frecuencias.

Contenido de paquete:

Barra de Sonido	1 pc
Subwoofer	1 pc
Manual de usuario	1 pc
Control remoto	1 pc
Cable de audio	2 pcs

NO.1

Panel lateral

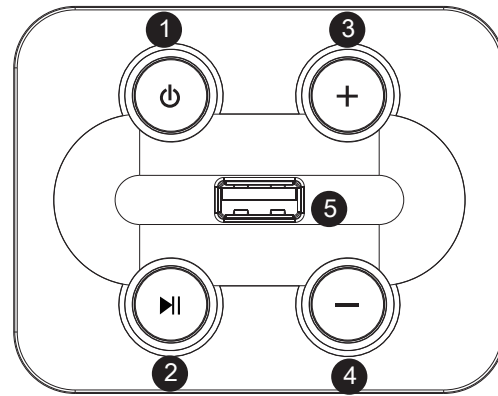

1. La barra de sonido esta en modo "⏻" (apagado) , cuando se enciende el LED parpadea. Presione "⏻" para seleccionar la entrada apropiada. Mantener el botón "⏻" presionado para volver al modo "⏻" (apagado). * Puede alternar entre los modos de entrada presionando el botón "⏻" . "BT" indica modo Bluetooth. "HD" indica modo ARC. "OP" indica modo Optico. "AU" indica modo 3.5mm. "Ud" indica modo USB.
2. Reproducir/ Pausar las canciones.
3. Mantener presionado para aumentar volumen/ presionar para siguiente pista.
4. Mantener presionado para reducir volumen/ presionar para pista anterior.
5. Puerto USB.

*****NO use el puerto USB para cargar dispositivos, no esta diseñado para carga. Gracias.**

NO.2

Como usar el control remoto

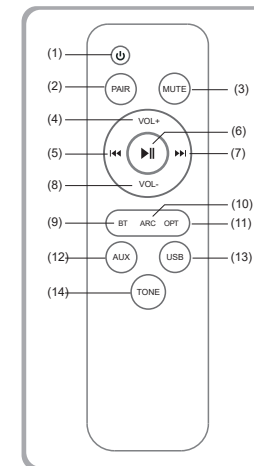

1. ⏻
2. PAIR
3. MUTE
4. VOL+
5. ⏪
6. ▶
7. ▶▶
8. VOL-
9. BT
10. ARC
11. OPT
12. AUX
13. USB
14. TONE

1. ⏻ : Encender o apagar.
2. Emparejar:
 - Mantener presionado el botón PAIR para seleccionar la frecuencia. La pantalla mostrará CH01, presione PAIR para cambiar de CH01, 02, 03, 04 o 05... Total 20 canales. NOTA: cuando haya problemas de emparejamiento entre el subwoofer y la barra de sonido, seguir el mismo procedimiento:
 - Codigo de emparejamiento ID: Presione continuamente el botón PAIR durante más de 5 veces hasta que la pantalla muestra "Id" y entra en el estado de emparejamiento. Encender el subwoofer (si ya está encendido, apagar y reiniciarlo) el indicador LED en el subwoofer parpadeará rojo y azul. Luego presione PAIR por 3 segundos para salir del estado de codigo de emparejamiento (o con 20 segundos sin operación se saldrá automáticamente). Cuando la luz azul es constante, está correctamente emparejado.
3. Silencio: activar/desactivar silencio.
4. VOL+ : Aumentar el Volumen presionando este botón.
5. ⏪: Reproducir cancion anterior, no en modo Audio.
6. ▶: Reproducir/ pausar en modo USB/ BT y Silencio en modo Audio.

NO.3

7. ▶▶: Reproducir siguiente canción, no en modo Audio.
8. VOL- : Reducir el Volumen presionando este botón .
9. BT: Modo Bluetooth. Presione el botón "BT" en el control remote para estar en el modo Bluetooth, el LED parpadeará rapido para buscar el dispositivo Bluetooth. En su celular encienda el Bluetooth y buscar por el nombre "4001949", emparejarlos. Cuando se ha emparejado correctamente su celular con la barra de sonido, el LED parpadea lentamente. Cuando se reproduce la música, el LED deja de parpadear. Las funciones como "ANTERIOR/ SIGUIENTE", "REPRODUCCIÓN/PAUSA", se pueden operar a través del panel lateral. En el modo BT, cuando se conecte con el celular, presione "▶▶" por 3 segundos, para forzar la desconexión de la función Bluetooth.
10. ARC: modo ARC.
11. OPT: modo Optico.
12. AUX: modo entrada de audio.
13. USB: modo USB.
14. TONE: Al presionarlo, el LED parpadea, entra en estado de ajuste de agudos, puede pulsar Vol+/Vol- para ajustar el nivel de agudos -6 (min)~ + 6 (max). Presionar de nuevo, el LED parpadea 2 veces, entra en estadode ajuste de bajos, puede pulsar Vol+ / Vol- para ajustar el nivel de bajos -6 (min)~ + 6 (max).

Panel trasero

Barra de sonido

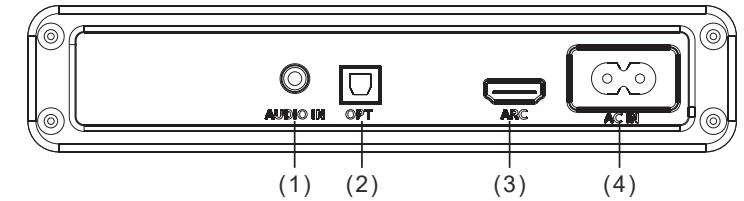

1. Entrada para conectar fuentes de audio como computadora, CD, Mp3, etc.
2. Entrada óptica.
3. Entrada ARC.
4. Entrada de AC.

NO.4

Subwoofer

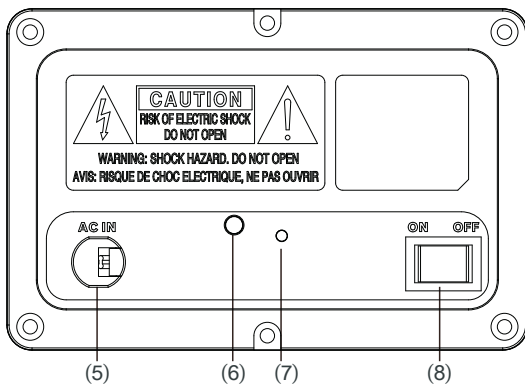

5. Entrada AC: Cable AC
 6. RESET: Usado para reiniciar la conexión entre el Subwoofer y la barra de sonido cuando ellos no se conectan entre ellos automáticamente.
 - (1). Presionar el botón "MUTE" del control remoto por 3 segundos para reiniciar la barra de sonido.
 - (2). Mantener presionado el botón "RESET" en el Subwoofer, después encenderlo por 5 segundos, luego soltar el botón. El Subwoofer se ha reiniciado. El Subwoofer se reiniciará al modo predeterminado.
- Explicación de la luz LED:
Conexión exitosa: Led azul
Desconectado: Led roja
Estado de emparejamiento: la luz roja y azul parpadean alternadamente
7. LED: Al encender la luz es roja, conectado con éxito la luz es azul.
 8. Encender/Apagar: El interruptor enciende o apaga la unidad.

NO.5

Diagrama de conexión

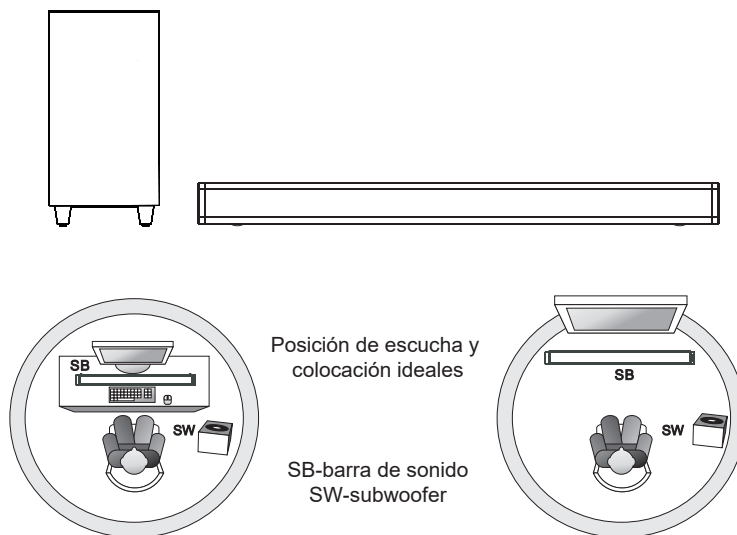

1. **Sub-woofer** Coloca el subwoofer en cualquier lugar del piso
2. **Barra de sonido** colocarla cerca del TV o reproductor DVD.

Tenga en cuenta:

* No dejar objetos que generan magnetismo cerca de los parlantes.

NO.6

FCC Caution

This device complies with part 15 of the FCC Rules. Operation is subject to the following two conditions: (1) this device may not cause harmful interference, and (2) this device must accept any interference received, including interference that may cause undesired operation. Any changes or modifications not expressly approved by the party responsible for compliance could void the user's authority to operate the equipment. NOTE: This equipment has been tested and found to comply with the limits for a Class B digital device, pursuant to Part 15 of the FCC Rules. These limits are designed to provide reasonable protection against harmful interference in a residential installation. This equipment generates, uses and can radiate radio frequency energy and, if not installed and used in accordance with the instructions, may cause harmful interference to radio communications. However, there is no guarantee that interference will not occur in a particular installation. If this equipment does cause harmful interference to radio or television reception, which can be determined by turning the equipment off and on, the user is encouraged to try to correct the interference by one or more of the following measures:
-- Reorient or relocate the receiving antenna.
-- Increase the separation between the equipment and receiver.
-- Connect the equipment into an outlet on a circuit different from that to which the receiver is connected.
-- Consult the dealer or an experienced radio/TV technician for help. To maintain compliance with FCC's RF Exposure guidelines, This equipment should be installed and operated with minimum distance between 20cm the radiator your body: Use only the supplied antenna.

NO.7

Durante el uso, preste atención a los siguientes elementos:

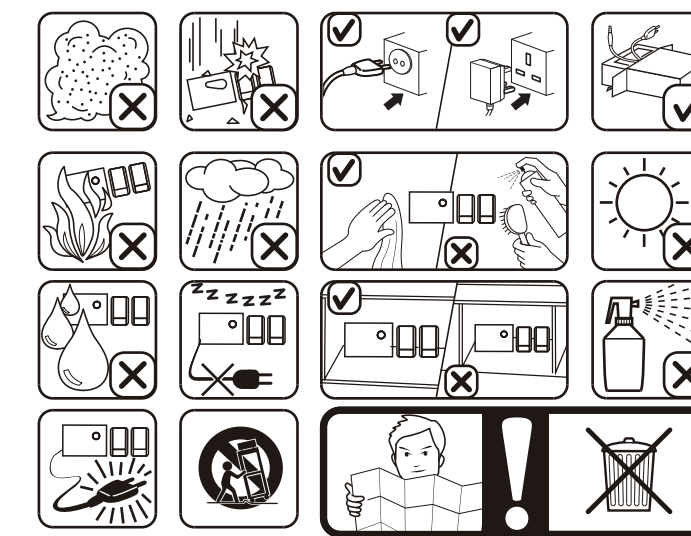

* Si el control remoto no funciona, se debe a que las baterías ya estan descargadas. Gracias.

NO.8



2.1 SOUND BAR
Model: 4001949



DEAR CUSTOMER:
Thank you to buy your RadioShack Sound Bar!
Prior to first use, please read the manual carefully.

Subwoofer

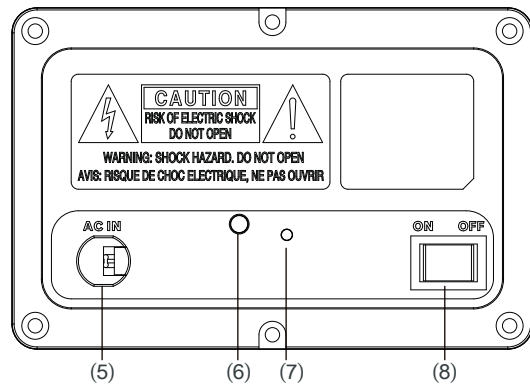

- 5. AC IN: AC Power cord
 - 6. RESET: Used to RESET the connection between Soundbar and Subwoofer when they do not connect with each other automatically.
 - (1). Long Press the "MUTE" key on the remote for 3 seconds to reset the soundbar.
 - (2). Long Press "RESET" Key. After that, POWER ON the subwoofer for 5 Seconds , Then release "RESET" key. Process finished. The subwoofer will RESET to default mode.
- Wireless subwoofer LED light explanation:
-Wireless connect successfully : LED is blue
-Wireless disconnect : LED is red
-Wireless pairing status : red and blue LED lights flash alternately
7. LED: Turn on the red light long, connected successfully long blue light
8. Power ON/OFF: Switch for turning on/off the unit.

背面

Operation explanation:

Specifications:

- Output power: 300W
- Driver Unist: 5090 x 4+ 8"
- Frequency response: soundbar: 140Hz-20KHz
subwoofer: 40Hz-150Hz
- Separation: ≥40 dB
- S / N: ≥55 dB
- Distortion: ≤1% (1K, 1W)
- Power supply: ~100-240V 50/60Hz
- Dimensions: soundbar: L960 x D80 x H62 (mm)
subwoofer: L240 x W240 x H448 (mm)

Features:

- Quality Soundbar with built-in amplifier
- Full audio spectrum performances, ideal for your favorite entertainment from Mp3, Mp4, CD/DVD movies and digital playbacks.
- Quality materials : Only the best components to recreate sound faithfully across all frequencies.

Package contents:

- Soundbar 1 pc
- Subwoofer 1 pc
- User manual 1 pc
- Remote control 1 pc
- Audio input cord 2 pcs

Side panel

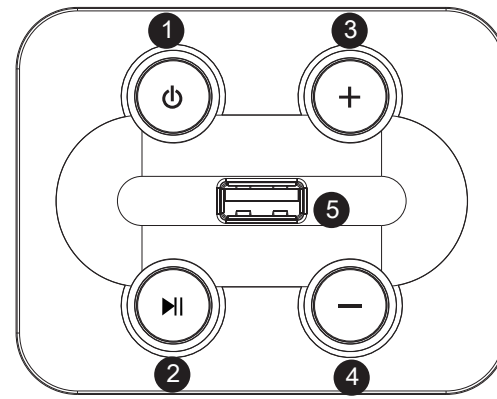

1. The Speaker system is in "⏻" (stand by) mode when power on, with the LED Flashing. Please press the "⏻" to select appropriate source. Keeping the "⏻" key pressed for long will put it back in "⏻" (stand by) mode.
- * You can toggle through the input modes by pressing the "⏻" key. "BT" denotes Bluetooth mode. "HD" denotes ARC mode. "OP" denotes mode. "AU " denotes Audio mode. "Ud" denotes USB card mode.
2. Play/Pause the songs.
3. Long press for volume increase/short press for next track.
4. Long press for volume decrease/short press for prev track.
5. USB Slot.

*** Do NOT use USB for charging devices, as it is not designed for charging. Thank you.

How to use the remote control

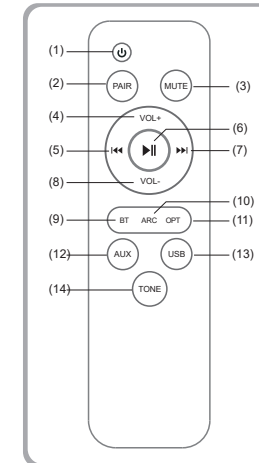

1. ⏻ : Power ON or Standby modes.
2. PAIR:
 - a. Long press "PAIR" for 3 sec to select the frequency , the display will show CH01, Short press "PAIR" to change from CH01, 02, 03, 04 or 05... Total 20 Channels. NOTE: when the pairing of the Soundbar and wireless subwoofer is disturbed, follow same procedure.
 - b. ID code pairing: Continuously short press key PAIR key for more than 5 times until the Soundbar display shows "Id" and it enters pairing state. Power on the subwoofer (if it is already on, power OFF and Restart it). The LED indicator on the subwoofer flashes red and blue. Then long press "PAIR" for 3 sec to exit the code-matching state (Or without operation for 20 sec, It will exit the code matching status automatically). When the Blue light is constant, it is paired successfully.
3. MUTE: Turn volume off. Depress again to activate the sound.
4. VOL+: To increase the Volume by short or long press of VOL+.
5. ⏮: Play the previous song by pressing "⏮" but not in Audio mode.
6. ⏪: Play/pause in USB/BT mode and MUTE in Audio mode.

7. ⏩: Play next song by pressing "⏩", but not in Audio mode.
 8. VOL-: To decrease the Volume by short or long press of VOL-.
 9. BT: Bluetooth mode.
- Press "BT" button on the remote to convert to Bluetooth input mode, LED flash fast to search the Bluetooth device. Turn on your mobile Bluetooth device and search the device name " 4001949 ", paired them well.
- When you have successfully paired your mobile to the speaker system, LED flashes slowly. When starting to play your mobile music, LED stopped flash. The functions as "PREVIOUS/NEXT", "PLAY/PAUSE", can operate via the front panel. On BT mode, when connecting with mobile, press "⏩" for 3 seconds, bluetooth function can be force-disconnected.
10. ARC: ARC mode.
 11. OPT: Optical mode.
 12. AUX: Audio input mode.
 13. USB: USB mode.
 14. TONE: Press it, LED flashes, it enter into treble adjustment status, can press Vol+/Vol- adjust treble level -6(min)~+6(max). Press it again, LED flashed 2 times, it enter into bass adjustment status, can press Vol+/Vol- adjust bass level -6(min)~+6(max).

Rear panel

Soundbar

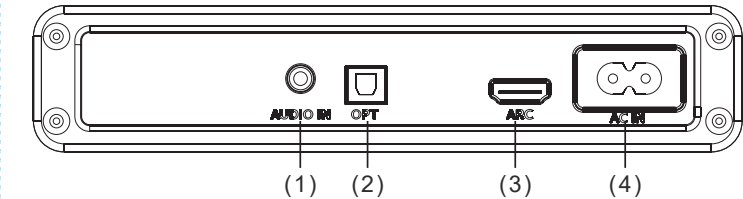

1. Input Connect to sound sources such as computer, CD player, Mp3, etc.
2. Optical Input.
3. ARC Input.
4. AC Power cord.

System connection diagram

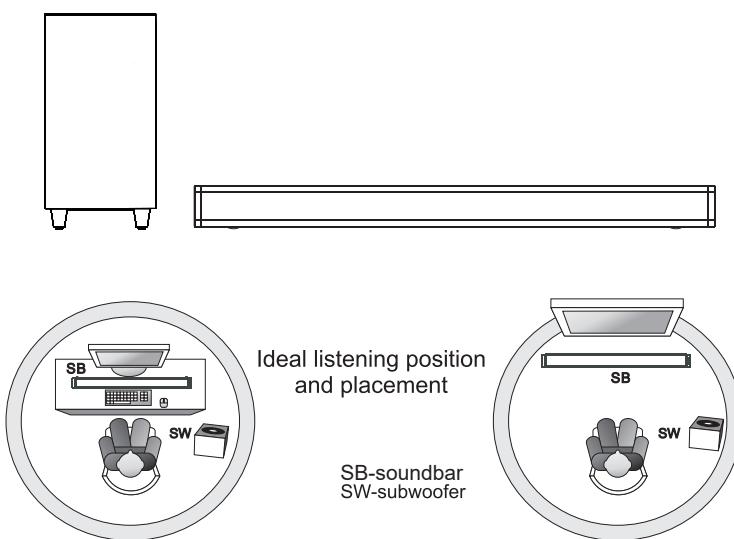

- ① **Sub-woofer** Place the sub-woofer any place on the floor.
- ② **Soundbar Speaker** Place it near the TV or DVD player.

Please Note:

* Do not leave objects generating magnetism near the speakers.

FCC Caution

This device complies with part 15 of the FCC Rules. Operation is subject to the following two conditions: (1) this device may not cause harmful interference, and (2) this device must accept any interference received, including interference that may cause undesired operation.

Any changes or modifications not expressly approved by the party responsible for compliance could void the user's authority to operate the equipment.

NOTE: This equipment has been tested and found to comply with the limits for a Class B digital device, pursuant to Part 15 of the FCC Rules. These limits are designed to provide reasonable protection against harmful interference in a residential installation. This equipment generates, uses and can radiate radio frequency energy and, if not installed and used in accordance with the instructions, may cause harmful interference to radio communications. However, there is no guarantee that interference will not occur in a particular installation.

If this equipment does cause harmful interference to radio or television reception, which can be determined by turning the equipment off and on, the user is encouraged to try to correct the interference by one or more of the following measures:

- Reorient or relocate the receiving antenna.
- Increase the separation between the equipment and receiver.
- Connect the equipment into an outlet on a circuit different from that to which the receiver is connected.
- Consult the dealer or an experienced radio/TV technician for help.

To maintain compliance with FCC's RF Exposure guidelines, This equipment should be installed and operated with minimum distance between 20cm the radiator your body: Use only the supplied antenna.

In use please pay attention to the following items:

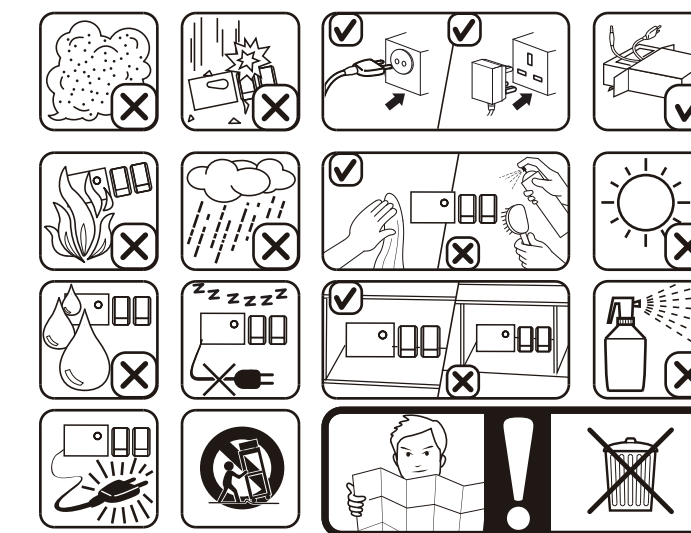

* If the remote control cannot function, it is because the battery of remote control has been used up. thank you.