

Wireless Video Doorbell Operation Guide

Model: H2/H5



V1.0



1. Construction:

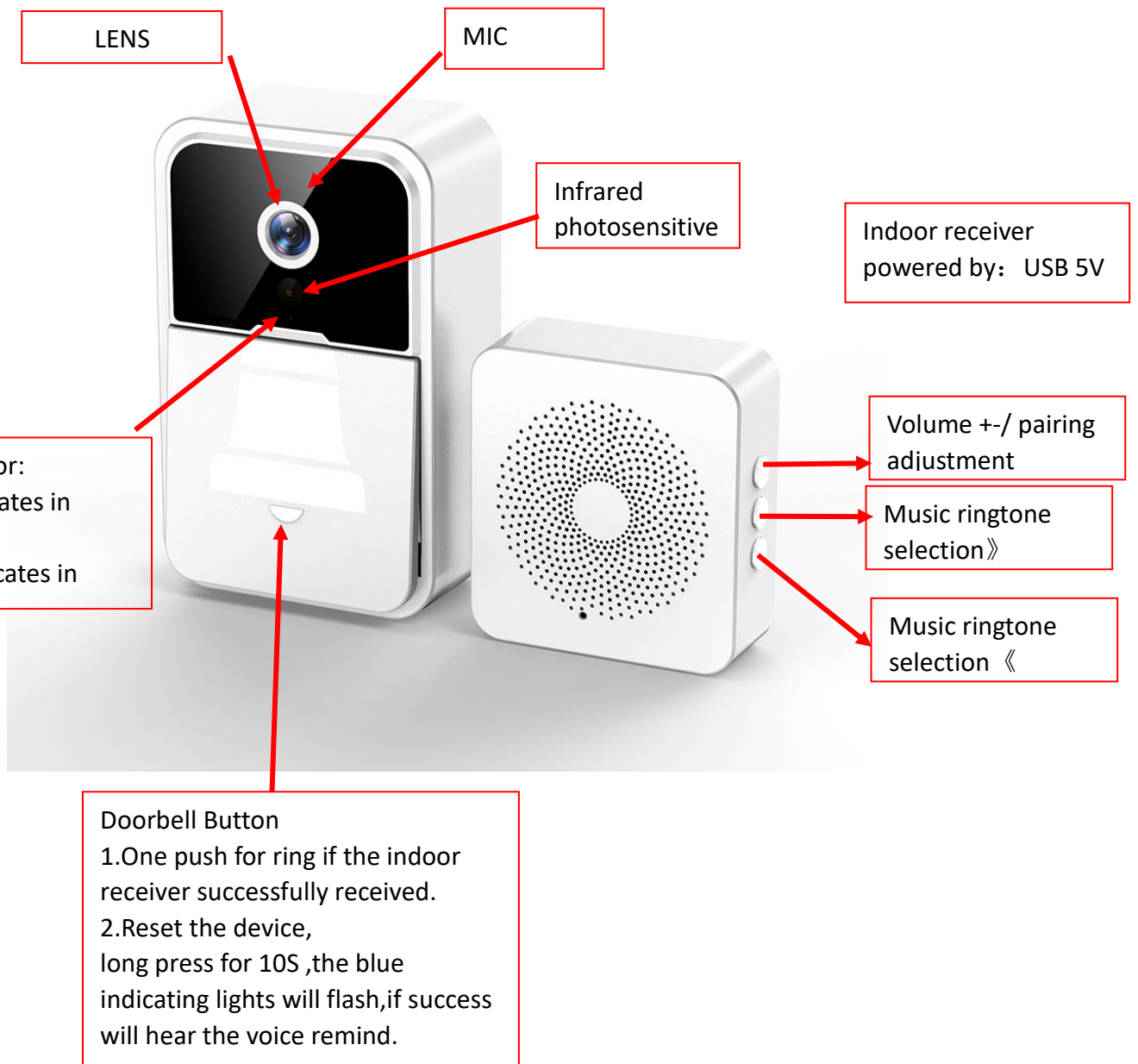

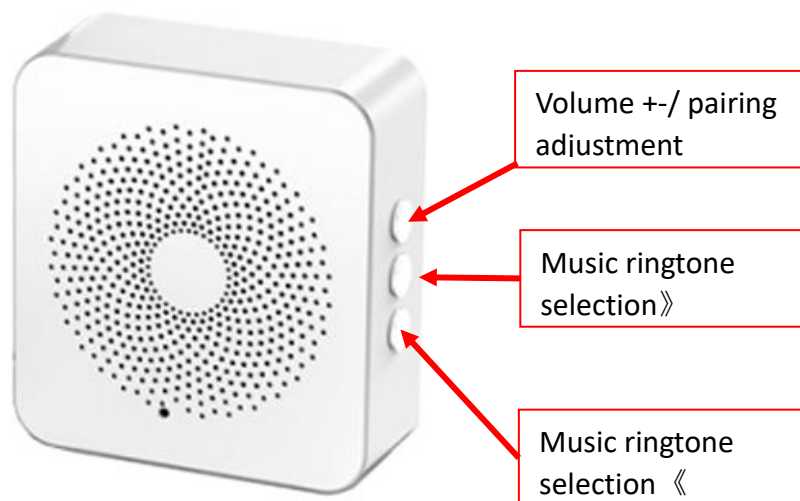
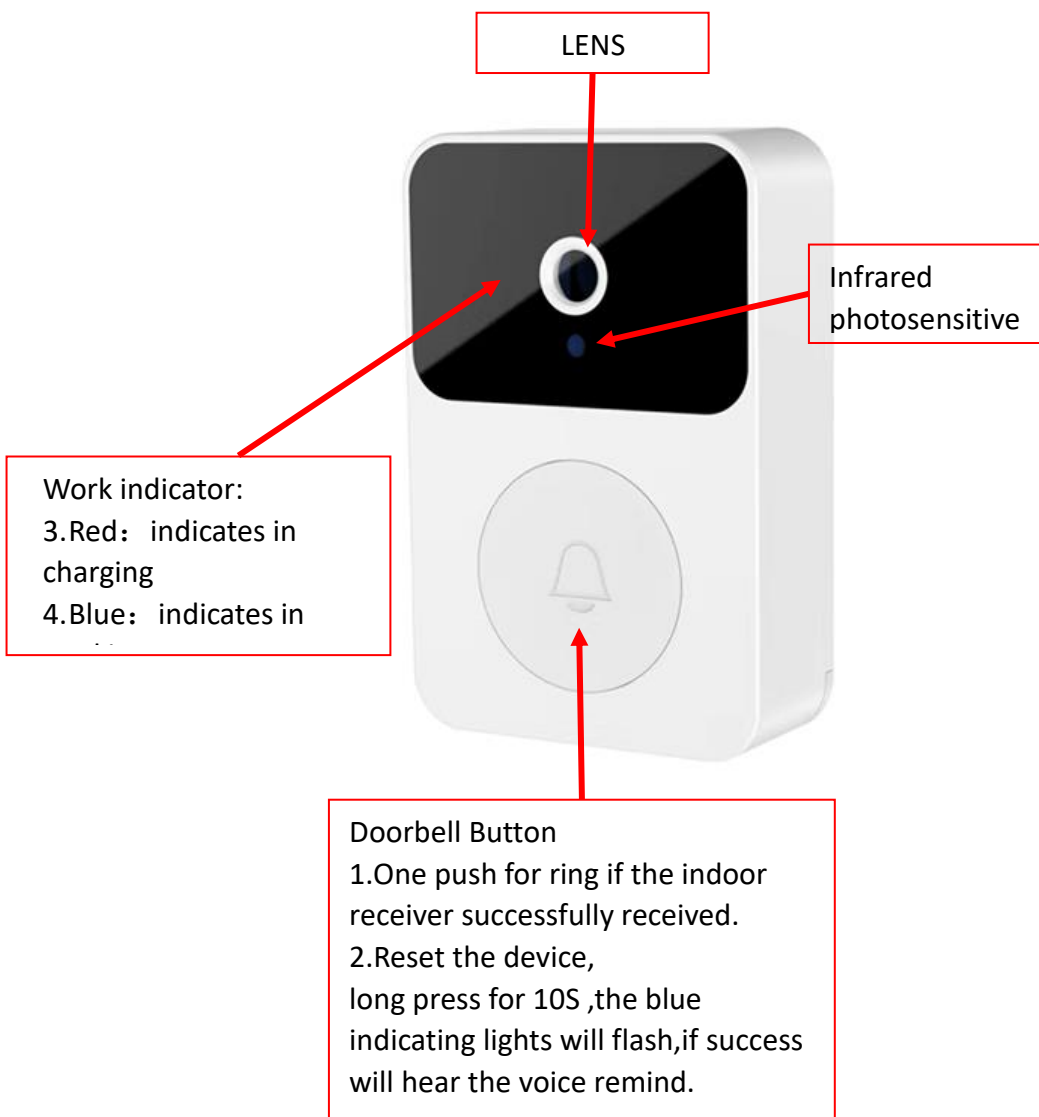

Features:

- Real-time Audio & Video Recording
- HD Video Resolution
- WiFi IP Network Function
- AUTO HD IR Night Vision
- 90 degree Lens View Angle
- Support Smartphone Tablet APP Remote View and Control
- Free cloud photo: Snap a photo every time when you ring the bell
- Video cloud storage: support users to open cloud storage according to their needs, at their own expense
- Support 3 users access at the same time
- Support Long time standby up to 365 days
- Battery&charging: Built-in 750mah battery,Charging time is about 1.5 hours,working time is about 6 months.
- H2 Charging model: Charge Voltage /DC=5V Battery capacity: 750Mah
- H5 Replacing the battery model: Battery installation/1.5V AAA battery

2. APP Download:

Installation

Download the app:

a. scanning below QR Code

b. Search for the app "**weihome**" in IOS store and google play.



3. Installation Notes

Note: this WiFi Imaging Camera only supports 2.4G WiFi, not 5G WiFi (better coverage for longer distances), 5 GHz (generally faster). When you connect and select Wi-Fi network, please select 2.4G network. SD card recording is not supported. Photos are stored in the cloud.

- A. Please confirm the power voltage before installation since unmatched power supply may damage the device.
- B. Device connection may fail if the router WIFI name and password contain special fonts or special symbols, if so, please change the WIFI name and password into normal English letters and numbers.
- C. Please try to make your camera, mobile phone and router close to each other when connecting, to prevent weak signal.

4. Working Light Indicator :



- a. AP mode: The system is turned on, and the AP hotspot is turned on when the Blue light flashes slowly.
- b. Charging mode: The device is charging when plugged in USB and the red light turns on; and it will automatically turn off when fully charged. (Notice: AA battery type machine cannot be charged)

- c. Reset mode: Long press the doorbell button for 10S, When the Blue indicator light changes from fast flashing to slow flashing, and hearing the voice remind then the reset is success down.
- d. Sleeping mode: when the machine is in sleeping mode, the light indicator will turn-off.
- e. Network mode: The Blue light keeps lighting on; And the indoor receiver received signal keeps ringing, at the same time the doorbell camera will auto-capture a real-time photo upload to the cloud and notice the user to check.
- f. Shutdown mode: The work indicator light does not light up when press the button, and there is no sound from the indoor ding-dong receiver too, that indicating the device is shut down due to low power, then, please charge or replace the battery in time.

5. APP Use Instruction

Please download the **【weihome】**_APP, Install the software and register with your email.

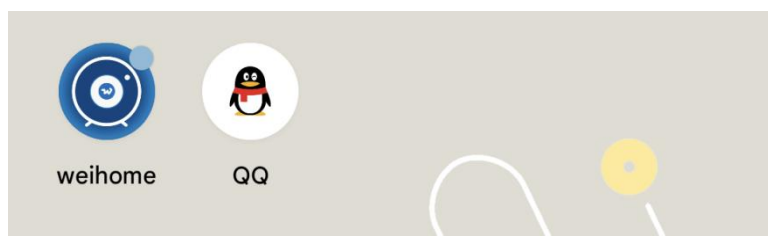

Register and log in by email: Enter the email address you want to use and click Register, Next tick ☒ in the User Agreement and Privacy Policy.



Sign Up

58845@qq.com

Sign up or log in

Please enter the Email

Continue

☒ Accept [User Agreement](#) and [privacy Policy](#)

Sign Up

Click the **【+】** icon to add device.

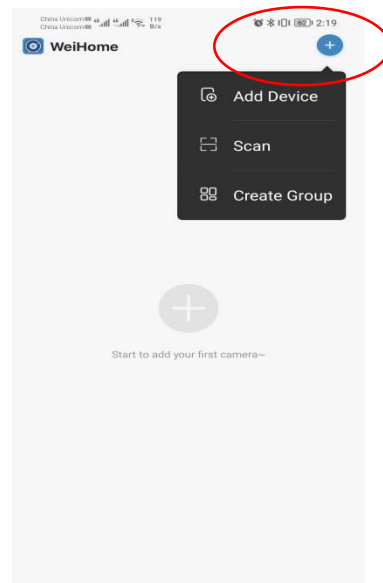
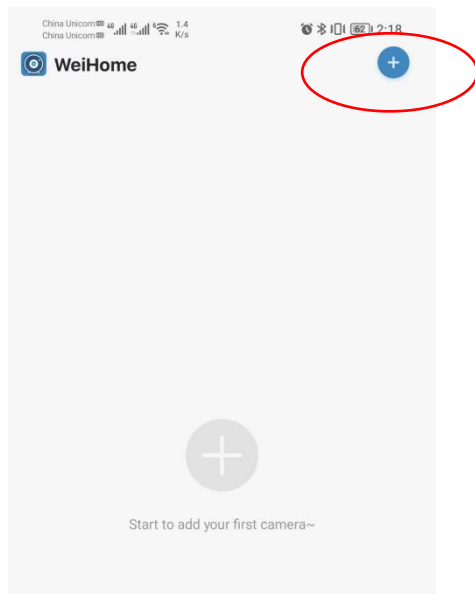

Choose the **【Doorbell Camera】** for the next step:

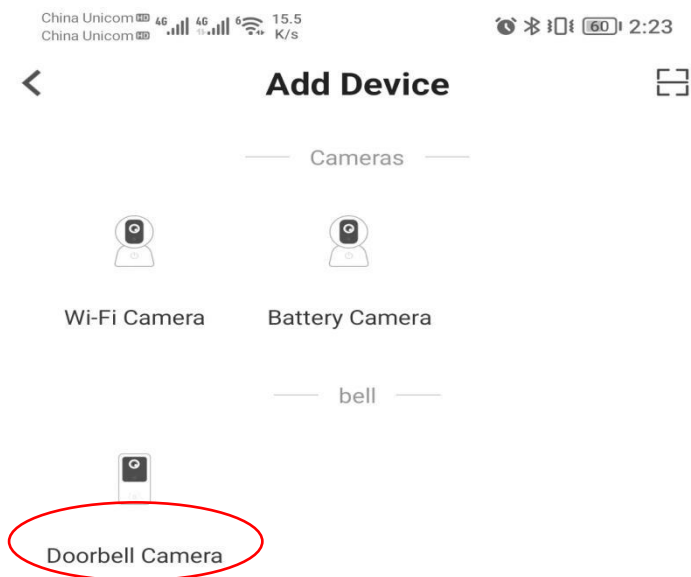

If the indicator light flashes fast, and hear the voice remind then go on for the next step.

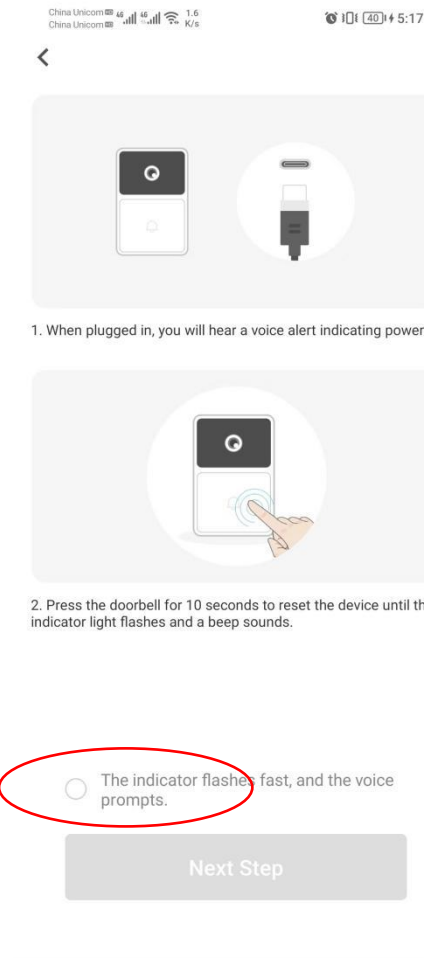

Click the 'Set Up WiFi'

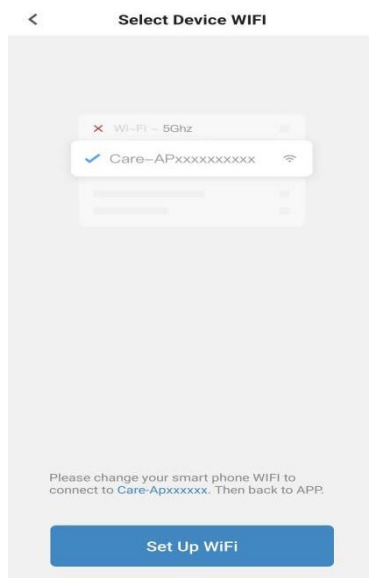

Find and connect the WiFi name by **Care-XXXXXXX** (ensure that the network is being well-connected)

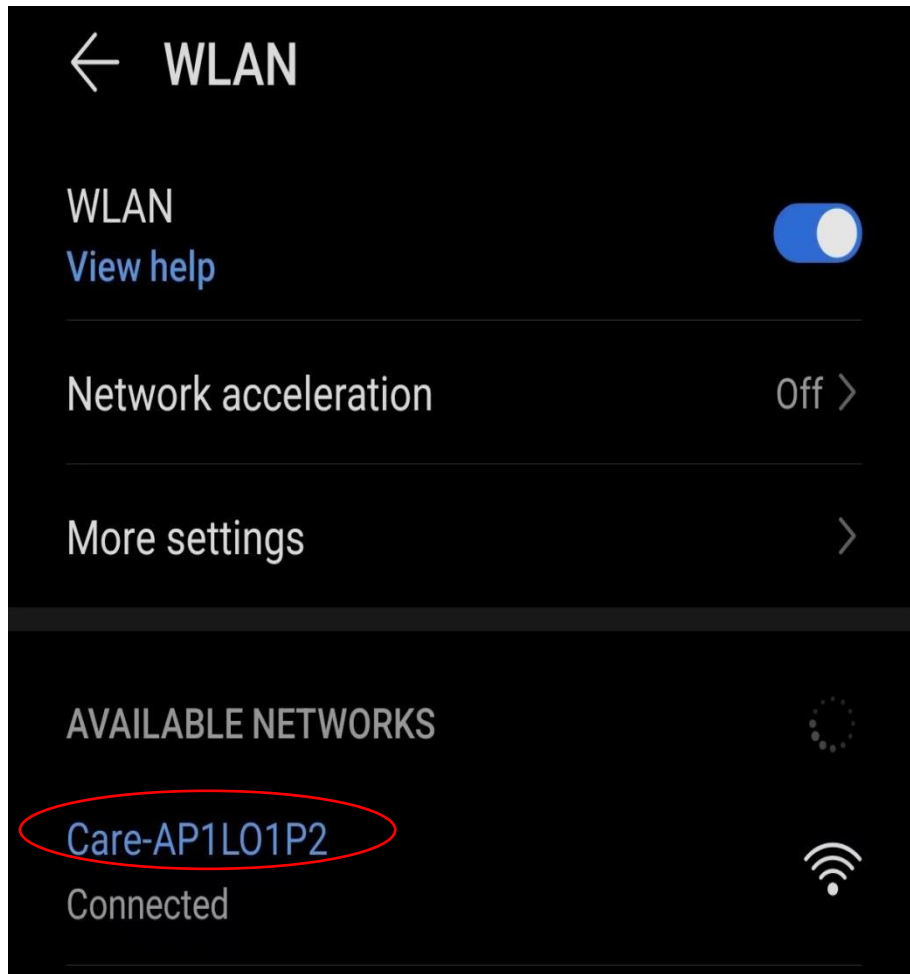

The dialogue box will pop up as below following picture when connecting with Caer-XXXXX-WIFI, and click the **CONNECT** button for next step.
Note: if not click CONNECT can **not move** on for the next step.



Direct connect for iPhone

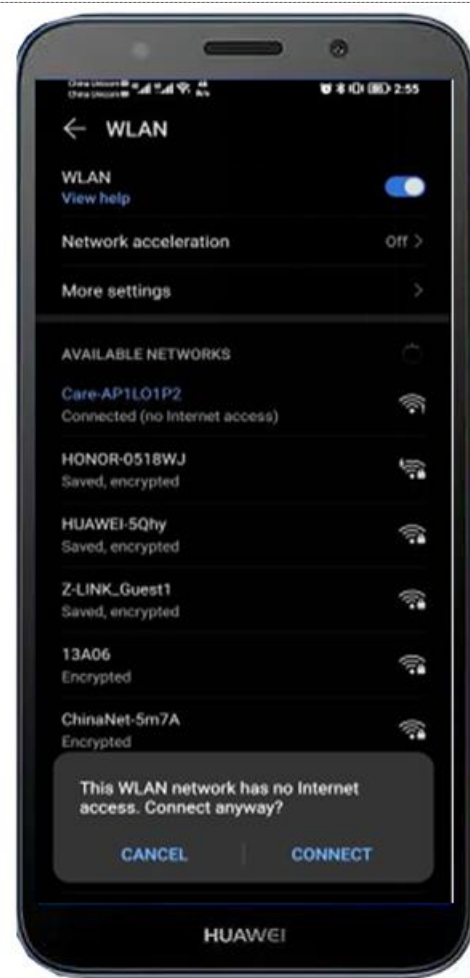

**Android phone click CONNET
for connection**

Click the back button to enter the APP main interface, as below picture, then click **【OK】** for the next step.

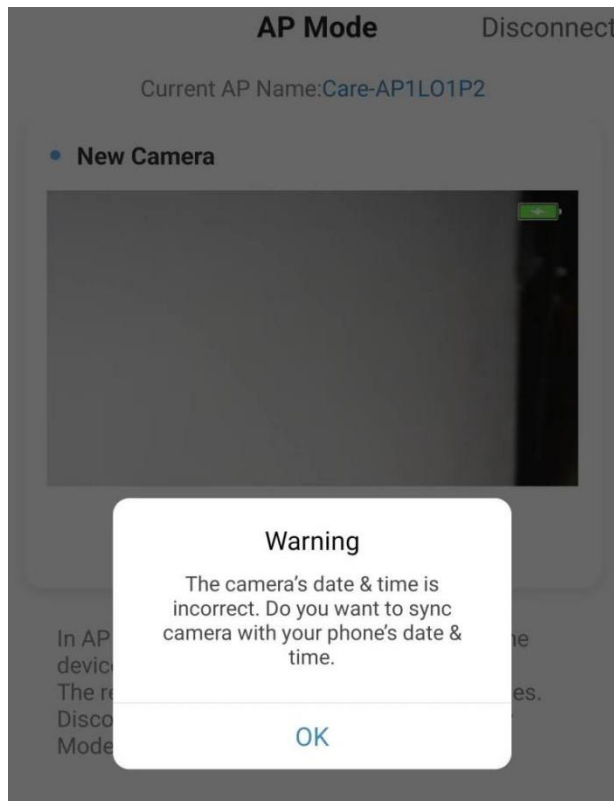

Click the red circle place in the image to enter AP direct connection mode, and you can preview the image in real time.

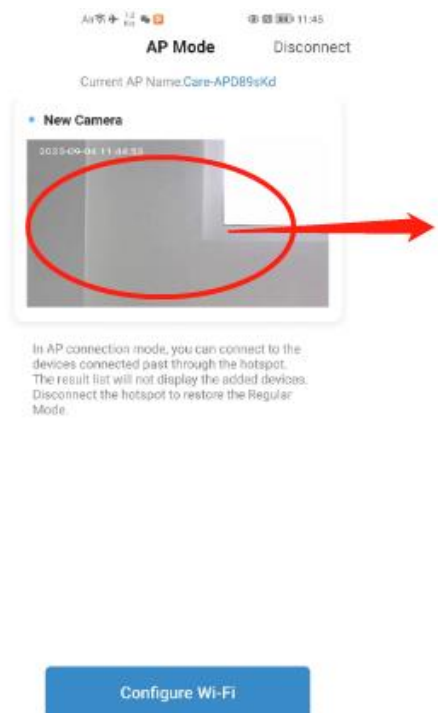

Click **【Configure WIFI】**

Find the WiFi that needs to be configured, and enter the WiFi password , next, click for connect.

Note:The blue indicator light will turn on and flash fast if wrong WiFi password was entered. Need to re-configure the WiFi by long press the RESET button for 10sec .

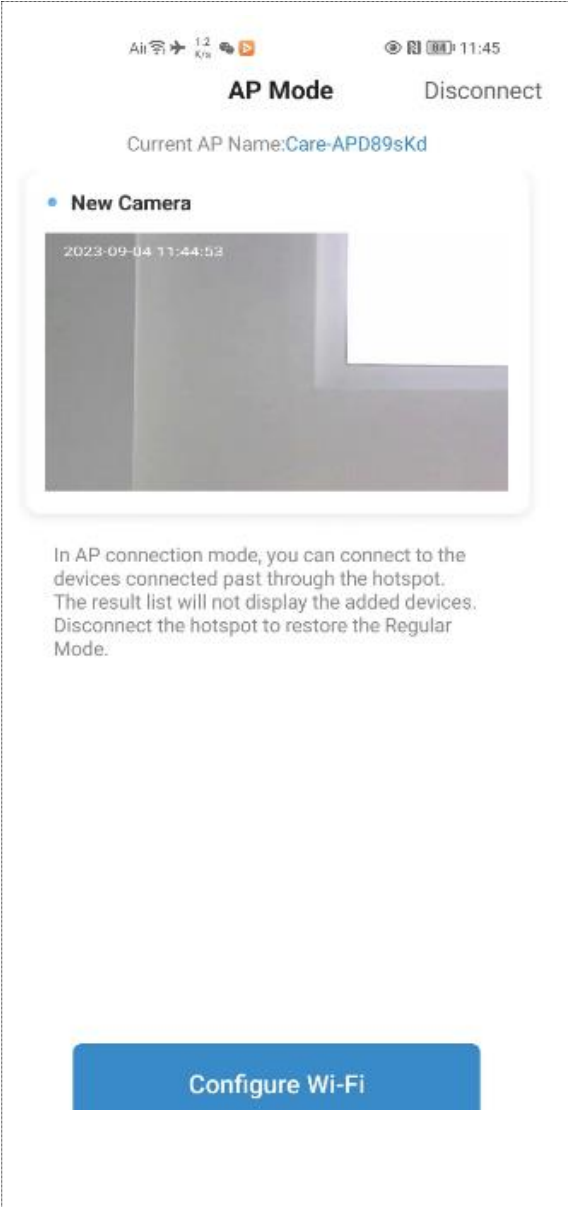
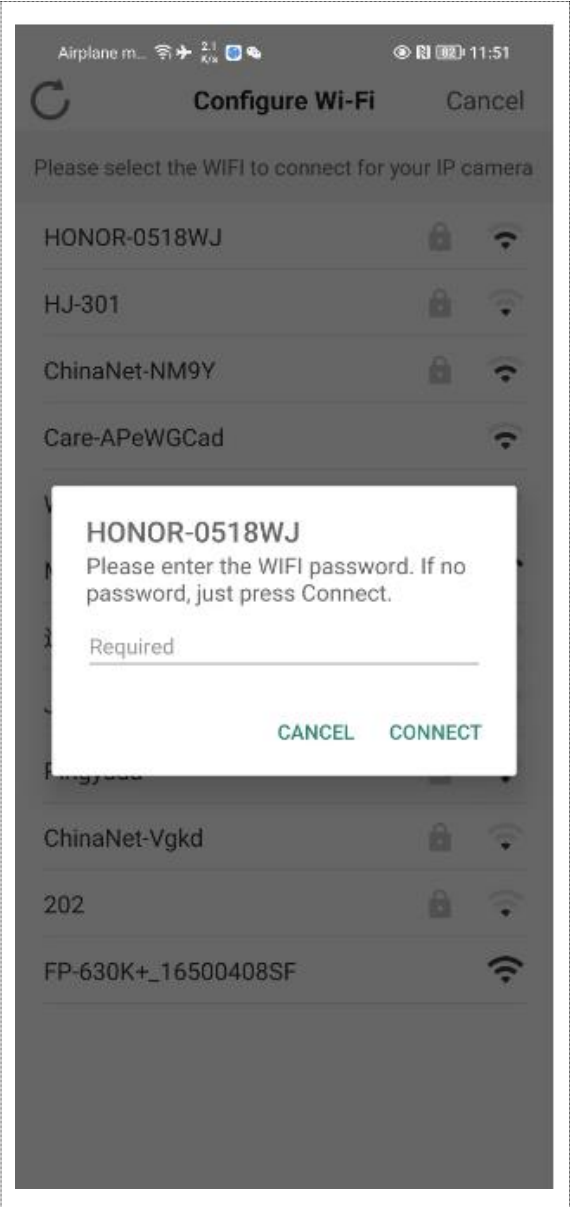
	
1	2

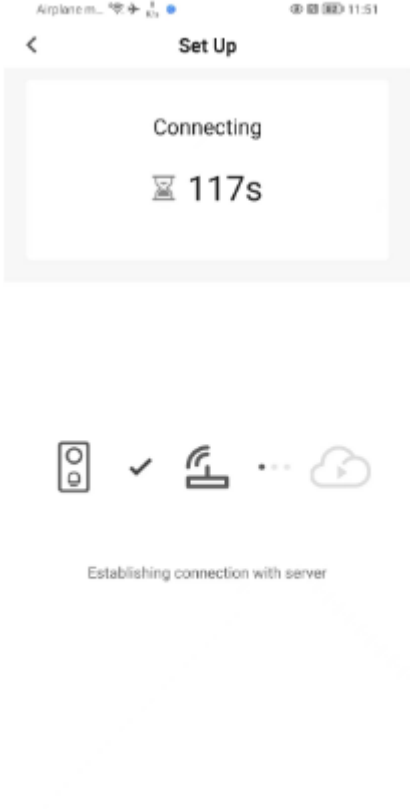
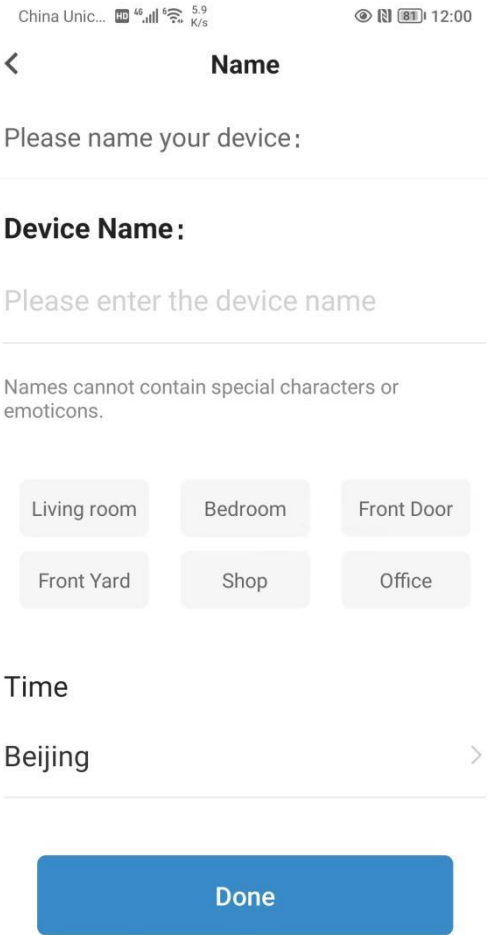
	
3	4



Configure WIFI finished, as shown in Image 4 Please name it as you like and click the screen to preview the real-time photos.



Play back: You can view the photos captured by the doorbell camera; if you have opened the cloud storage can download all the photos and videos.

When someone rings the doorbell, phone App will receive message reminder; if you clicked can direct enter and view the real-time preview video; If the ring was not answered, then, the photos and videos will be auto-saved and can watch and playback it later.

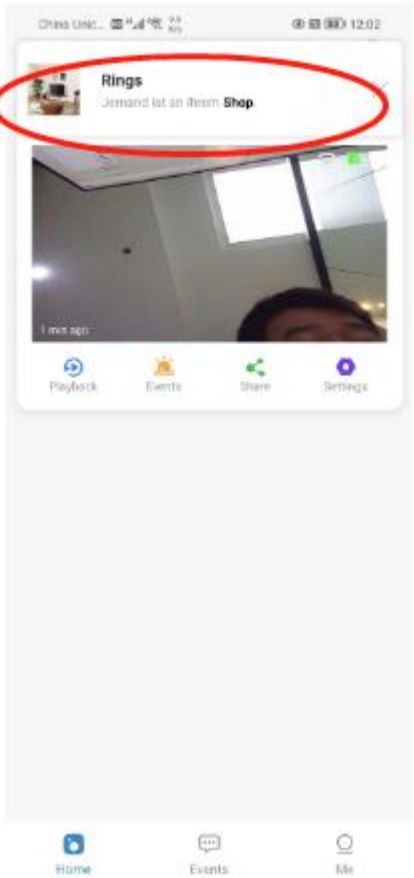
When someone rings the doorbell, the inner room reception will ring and your phone will pop up with reminder message as circled in below image1; Click the pops up message and you can choose pick up or hang up the call as image2.

	
<p>1</p>	<p>2</p>

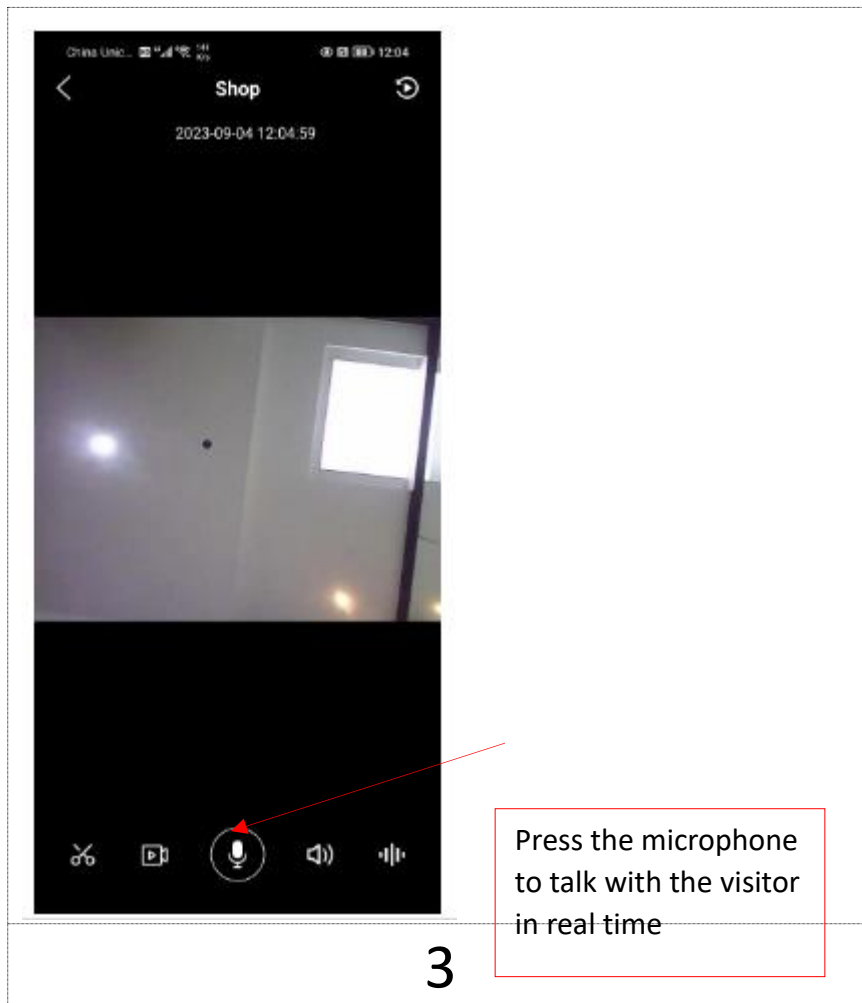

Sharing: Click to share the device with friends/family members, can share by two ways QR code or account number.

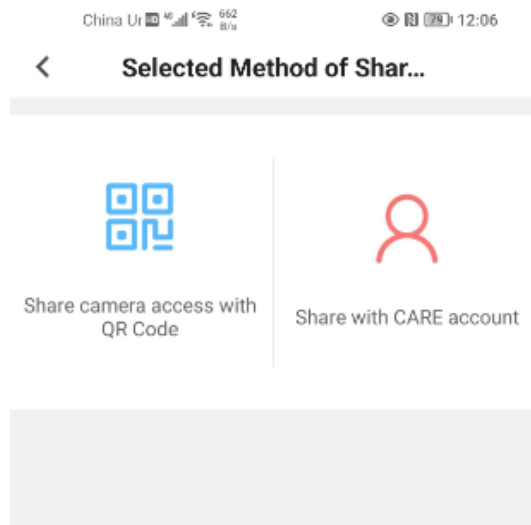

QR code sharing: scan the QR code via invitees' weihome APP to add sharing.
Account number sharing: input the registered email of the inviter to search for the account.

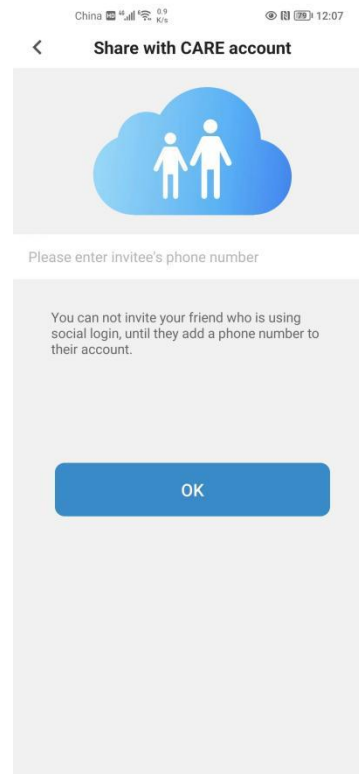

Delete the sharing account: after canceling for the sharing, the phone can no longer preview this doorbell camera's image and videos via the App.

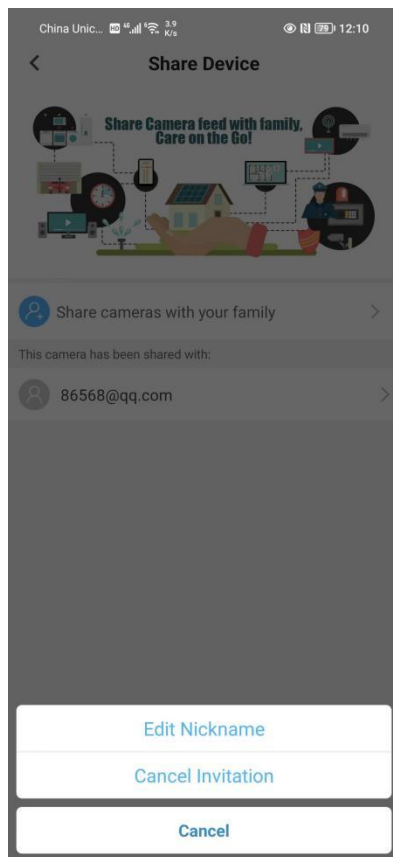

Viewing the APP album: click the menu button "Me" in the right corner of the homepage as below picture.

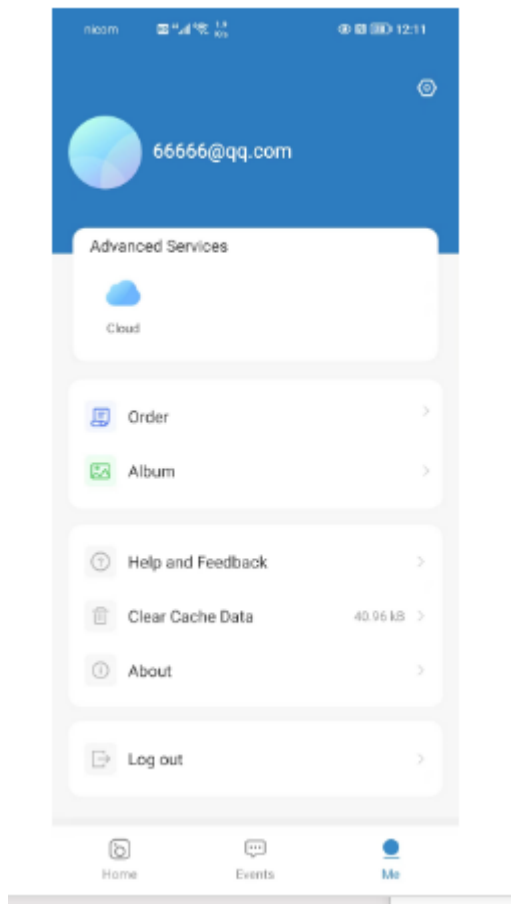

Find the photo or video album you would like to check and click for view.

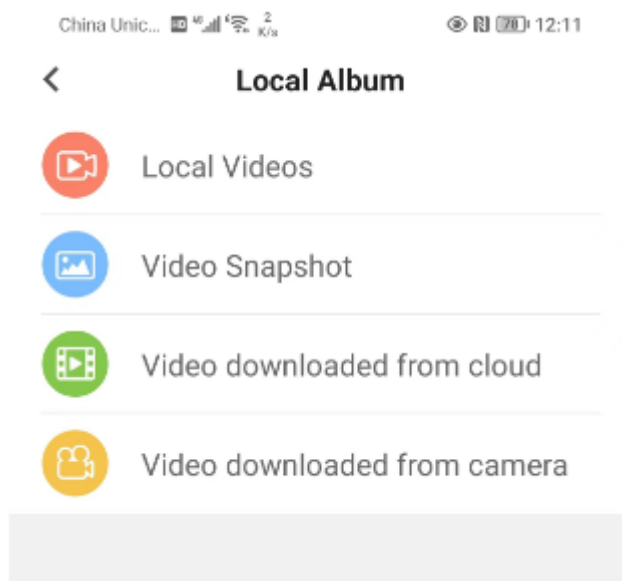

- A. Local video recording: Use the APP real-time preview to enter record; manually click for video record and saving the video locally on the phone.
- B. Local video screenshot: Use the APP real-time preview to enter screenshot, manually click to capture the picture and saving the screenshot locally on the phone.
- C. Download the cloud video: you can download the video remotely if opened the cloud storage service.

FCC Warning:

This equipment has been tested and found to comply with the limits for a Class B digital device, pursuant to part 15 of the FCC Rules. These limits are designed to provide reasonable protection against harmful interference in a residential installation. This equipment generates, uses and can radiate radio frequency energy and, if not installed and used in accordance with the instructions, may cause harmful interference to radio communications. However, there is no guarantee that interference will not occur in a particular installation. If this equipment does cause harmful interference to radio or television reception, which can be determined by turning the equipment off and on, the user is encouraged to try to correct the interference by one or more of the following measures:

- Reorient or relocate the receiving antenna.
- Increase the separation between the equipment and receiver.
- Connect the equipment into an outlet on a circuit different from that to which the receiver is connected.
- Consult the dealer or an experienced radio/TV technician for help.

Caution: Any changes or modifications to this device not explicitly approved by manufacturer could void your authority to operate this equipment.

This device complies with part 15 of the FCC Rules. Operation is subject to the following two conditions:

(1) This device may not cause harmful interference, and (2) this device must accept any interference received, including interference that may cause undesired operation.

This equipment complies with FCC radiation exposure limits set forth for an uncontrolled environment. This equipment should be installed and operated with minimum distance 20cm between the radiator and your body.