

Product Manual

TV Sensor Screen Sync Backlights

Warning: Changes or modifications to this unit not expressly approved by the party responsible for compliance could void the user's authority to operate the equipment.

NOTE: This device complies with part 15 of the FCC Rules. Operation is subject to the following two conditions:

- (1) This device may not cause harmful interference, and
- (2) this device must accept any interference received, including interference that may cause undesired operation.

FCC Statement: This equipment has been tested and found to comply with the limits for a Class B digital device, pursuant to part 15 of the FCC Rules. These limits are designed to provide reasonable protection against harmful interference in a residential installation. This equipment generates, uses and can radiate radio frequency energy and, if not installed and used in accordance with the instructions, may cause harmful interference to radio communications. However, there is no guarantee that interference will not occur in a particular installation. If this equipment does cause harmful interference to radio or television reception, which can be determined by turning the equipment off and on, the user is encouraged to try to correct the interference by one or more of the following measures:

- Reorient or relocate the receiving antenna.
- Increase the separation between the equipment and receiver.
- Connect the equipment into an outlet on a circuit different from that to which the receiver is connected.
- Consult the dealer or an experienced radio/TV technician for help.

This equipment should be installed and operated with minimum distance 20cm between the radiator and your body.

1

Warm tips

- ◆ 1. When installing the sensor, please install it in the middle of the TV;
- ◆ 2. When installing the light strip, please clean the back of the TV in advance, and there is no water;
- ◆ 3. When installing the light strip, please stick it to either side from the top middle of the TV;
- ◆ 4. Please stay away from sharp objects during the installation process.

Product Details

Model	TV Sensor Screen Sync Backlights
Input	5V-2A(RGB), 12V-1.5A(RGBIC)
Power(Max)	12W (RGB), 36W (RGBIC)
Control mode	APP+button+sound control
For TV Siz	55-65 inch/65-75 inch
Colors	55-65 inch/65-75 inch
Support TV size	12.47ft/16.4ft
Light size	-20-60 C
APP	uLamp
Supported OS	Android7.0 above or iOS 11.0 above

2

Dimension & Komponenten

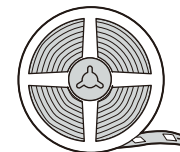

LED Strip Light *1

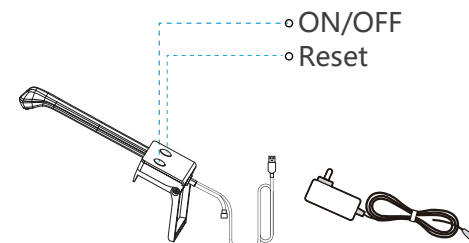

Induction&control unit *1

Power Adapter x1
(5V USB without Power Adapter)

3

Installation Steps

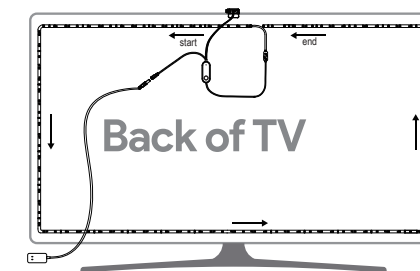
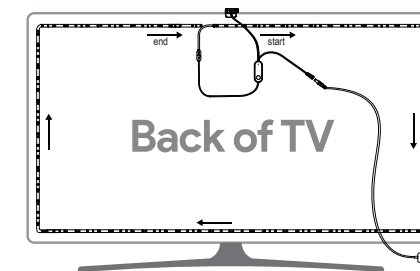

4

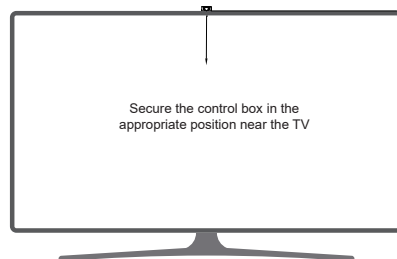

Secure the control box in the appropriate position near the TV

Download method

1. Scan the QR code to download



2. App Store download or app store download

- iOS users can search for "uLamp" on the Apple App Store App Store to download
- Android foreign users can search for "uLamp" on Google Play to download; Android domestic users can search for "uLamp" in the app store to download

5

Use of functions

1. Add devices

Open the uLamp App, and the home page of the app without adding the device is shown in the following figure.

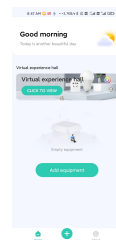

2. After the device is powered on

Click the "Add Device" button or the "+" button at the bottom of the homepage to enter the device addition page, and select the corresponding TV Light to add.

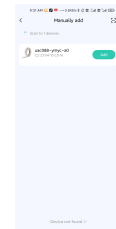

6

3. On the device added successfully page

You can modify the device name after the device is added successfully, and enter the home page of the device details page by default after saving.

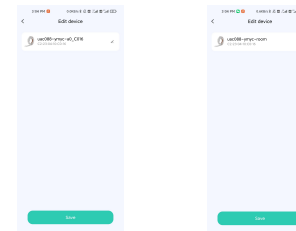

4. The device details page can control the main device switch, turn on/off linkage, switch scenes, etc., as shown below

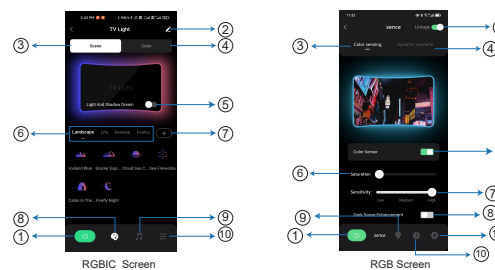

7

5. RGBIC device details page

- ① Main equipment TV Light switch button;
- ② Click to modify the name of the main device;
- ③ Scene mode, corresponding to (6) 4 scene classifications, a total of 24 scene modes, namely: Iceland Blue, Glacier Express, Cloud Sea Scene, Sea Fireworks, Snow Cabin, Firefly Night, Game, Holiday, Work, Party, Trend, Sports, Christmas, Valentine's Day, Halloween, Thanksgiving, Mother's Day, Father's Day, Summer Madrigal, Sea Dream, Love and Dream, Spring Fishing, Neon World, Dreamland;
- ④ Click to enter the segmented smudge color page, which supports global smearing, segmented smearing, erasing, as well as colored cards and recommended combination color;
- ⑤ Color sensor work on/off button;
- ⑦ DIY scene mode, click the "+" button to enter the DIY page, support full segmentation/segmentation, effect, color, brightness, speed and other settings;
- ⑧ Scene mode/color adjustment, corresponds to (3), (4), (6);
- ⑨ Music rhythm mode, support 6 music rhythm modes, namely: rock, jazz, classical, rolling, energy, spectrum;
- ⑩ Settings. Supports setting of countdown, number of lamp beads and line order

6. RGB device details page

1. Main device TV RGB Light switch button;
2. Sub-equipment linkage switch, turn on/off linkage, (need to buy matching linkage products, no sub-equipment can be turned off);
3. TV color sensing settings;
4. Scene mode/music mode;
5. TV synchronous sensor on/off;
6. Color saturation adjustment;
7. TV sensor color sensitivity adjustment;
8. Color Shadow enhanced on/off;
9. Color palette and brightness adjustment;
10. The timing switch is set;
11. Product equipment information.

8