

Watch Wireless Charger

(Model:W07)

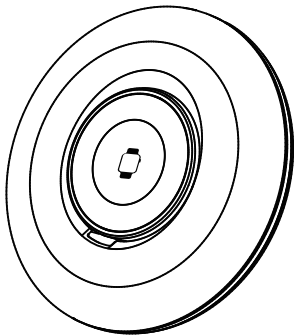

USER MANUAL

Wireless charging, always on the go

Packaging accessories



Watch Wireless
Charger



USB-A to USB-C
Cable



User Manual

Product Parameters

Model: W07

Input: 5V/1A

Watch: 2.5W

Compatible Models

1.Smartwatch

Work For Apple Watch: Ultra/Series/SE series

Product Description

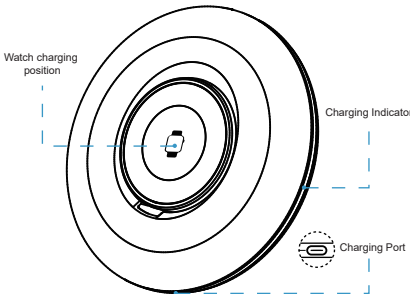

How to use

Charging the watch: ①. Open the watch module upwards
②. Place the watch in the wireless charging position and align it with the magnet. The blue light of the charging indicator is always on, indicating that the watch is charging.If charging is not normal, the blue light flashes rapidly

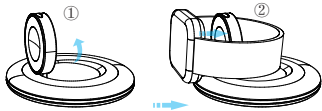

How to use

Please pay attention to the following matters, otherwise it may cause malfunctions such as improper charging, overheating of charging, intermittent charging, or even failure to charge and other malfunctions.

1. Place the watch in the correct charging area.
2. Make sure there are no metal or magnetic objects around the 2.36-inch center of the back of the watch when charging.

3. The lower the temperature, the faster the charging speed, and the charging speed is faster in winter than in summer.
4. Do not charge in a hot and humid environment as this may damage the circuitry.

How to use

This equipment complies with FCC radiation exposure limits set forth for an uncontrolled environment. This equipment should be installed and operated with minimum distance 7.87in(20cm) between the radiator& your body.

This device complies with part 15 of the FCC rules operations subject to the following two conditions:(1)this device may not cause harmful interference.(2)this device must accept any interference received including interference that may cause undesired operation.

FCC Warning :

Any Changes or modifications not expressly approved by the party responsible for compliance could void the user's authority to operate the equipment.

Note: This equipment has been tested and found to comply with the limits for a Class B digital device, pursuant to part 15 of the FCC Rules. These limits are designed to provide reasonable protection against harmful interference in a residential installation. This equipment generates and can radiate radio frequency energy and if not installed and used in accordance with the instructions may cause harmful interference to radio communications.

However, there is no guarantee that interference will not occur in a particular installation. If this equipment does cause harmful interference to radio or television reception, which can be determined by turning the equipment off and on, the user is encouraged to try to correct the interference by one or more of the following measures: Reorient or relocate the receiving antenna. Increase the separation between the equipment and receiver. Connect the equipment into an outlet on a circuit different from that to which the receiver is connected. Consult the dealer or an experienced radio/TV technician for help.