

Product Certification

Product Name : Intelligent Sweeping Robot

Model Number : _____

Production Date : _____

Inspector : QC01

This product has been inspected to meet the stipulated quality standards and is granted to leave the factory.

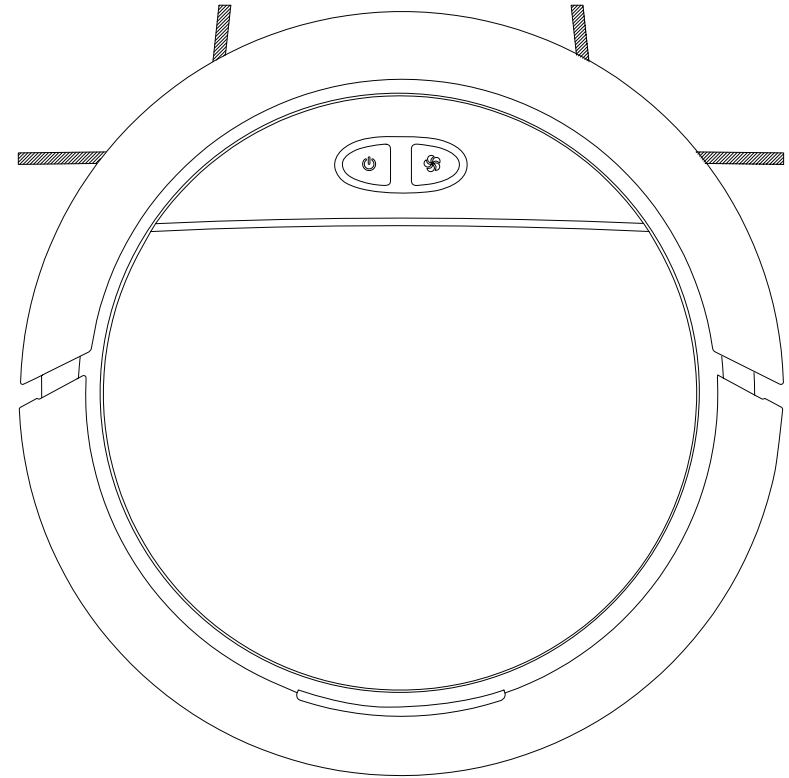
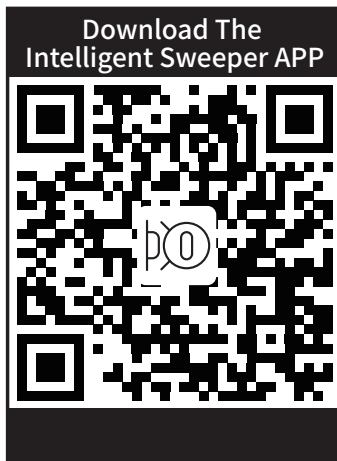

MAKE LIFE INTELLIGENCE

ROBOTIC VACUUM CLEANER

Thanks for purchasing Intelligent Sweeping Robot!
Hope you enjoy it.

Be careful! Battery leakage exudate can cause human injury! If the battery leaks exudate, make sure it doesn't come out to contact with the eyes or skin. In case of contact, wash hands and eyes with clean water immediately. If you still feel unwell, seek medical advice immediately.

ROBOTIC VACUUM CLEANER

Component Sort	Hazardous Substance					
	Lead (Pb) and its compounds	Mercury (Hg) and its compounds	Cadmium (Cd) and its compounds	Hexavalent Chromium (Cr (VI)) and its compounds	Polybromobiphenyl (PBB)	Polybrominated Diphenyl Ether (PBDE)
Plastic Parts	○	○	○	○	○	○
Hardware	×	○	○	○	○	○
Main Engine Circuit Module	×	○	○	○	○	○
Electronic Components	○	○	×	○	○	○
Battery	○	○	○	○	○	○
Plug Power Cord (Metal Part)	×	○	○	○	○	○

Note: This form is compiled in accordance with SJ/T 11364.
 ○: Indicate that the content of the hazardous substance in all homogeneous materials of the part is below the limit specified in the current valid version of GB/T 26572.
 ×: Indicate that the content of the hazardous substance in at least one of the materials of the part exceeds the limit requirement specified in the current valid version of GB/T 26572, and there is no mature alternative solution in the industry, which meets the environmental requirements of the eu RoHS directive.

Product use/APP download and connection

Phone APP operation steps:

1. The mobile phone scans the QR code, download and install the product APP.



2. Make sure that the power of the sweeping robot is sufficient.

Master switch According to the "-" state.

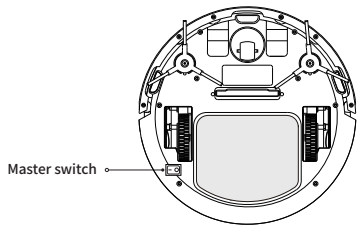

3. Open the APP to connect the sweeping robot.

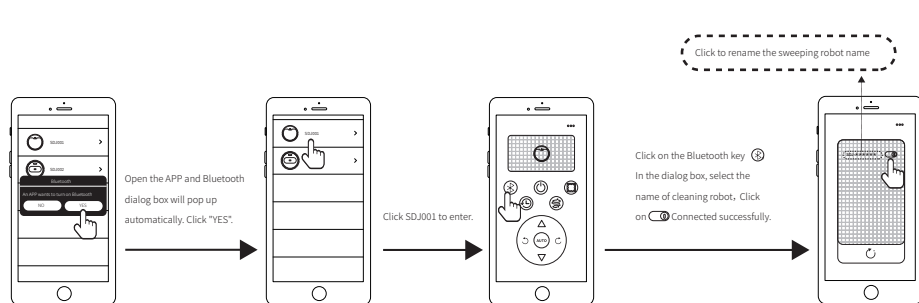

Product Usage/Operation Procedure

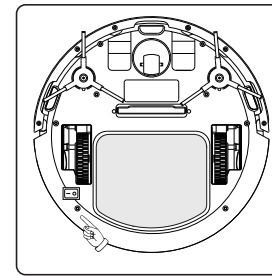

1. Bottom master switch According to the "-" state.

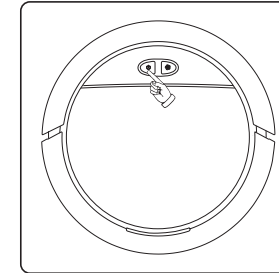

2. Boot mode one: Press cleaning robot power switch start.

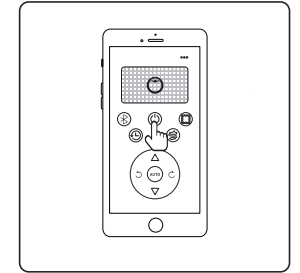

3. Boot mode two: The key to operating the APP Start the sweeping robot.

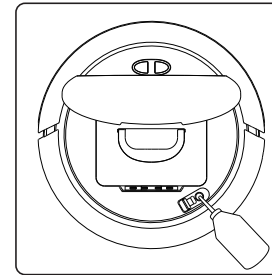

4. ① Open the flip panel
② Turn on the water filling plug
③ Use the special bottle to add water (less than 100ml) It is strictly prohibited to use other bottles for water injection

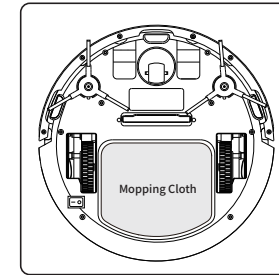

5. Mop Function: Paste Mopping Cloth on the bottom of the product.
* Please don't use water tank modules on carpet

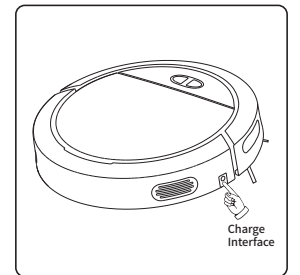

6. When the indicator light is blue and flashes, the product will stop working. The indicator light will be red when the product is charging, and will go out when the product is fully charged.

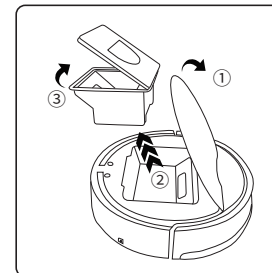

7. ① Open the magnetic cover,
② Raise upward the dust box,
③ Open the dust box to take out the garbage and reload the box for next use.

Product Parameter

Product Model	
Charge Time (h)	≈3.5H
Product Dimensions	300x300x78mm
Battery Capacity	2400mAh,17.8WH

*Charging at a voltage above 5V is prohibited!

*Due to the need of continuous improvement of the products, the products in the manual are in kind. We reserve the right to update the products.

Phone APP function

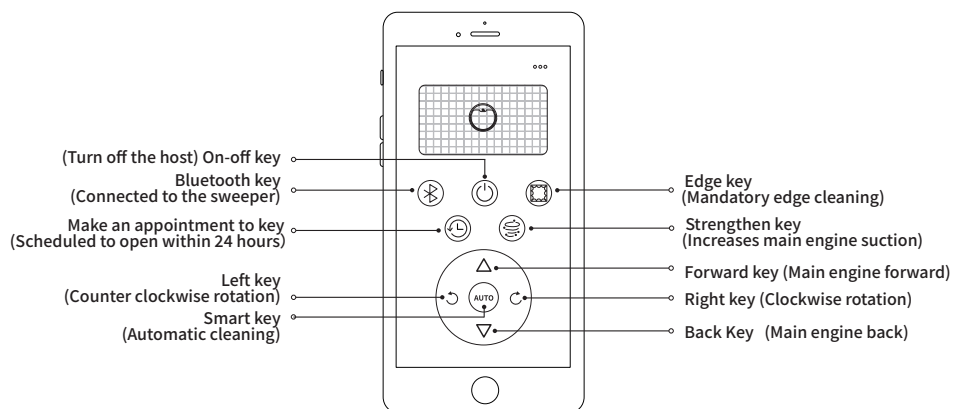

Product Composition/Packaging Contents

Serial Number	Description	Quantity
1	Main Engine (including Battery)	1
2	Brush	1
3	USB Cable	1
4	Operating Manual	1
5	Mopping Cloth	1

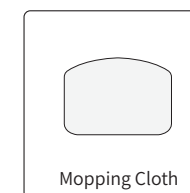
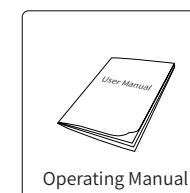
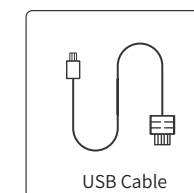
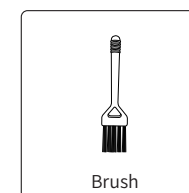
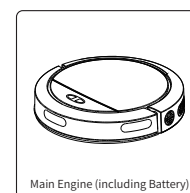

Front view of machine

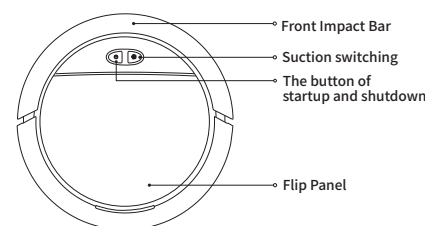

Bottom view of machine

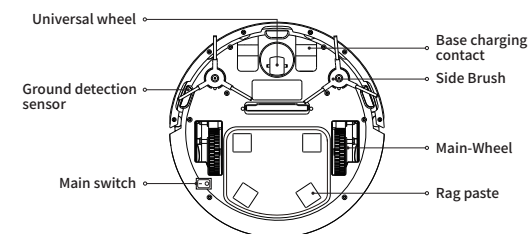

FCC Warning:

This equipment has been tested and found to comply with the limits for a Class B digital device, pursuant to part 15 of the FCC Rules. These limits are designed to provide reasonable protection against harmful interference in a residential installation. This equipment generates, uses and can radiate radio frequency energy and, if not installed and used in accordance with the instructions, may cause harmful interference to radio communications. However, there is no guarantee that interference will not occur in a particular installation. If this equipment does cause harmful interference to radio or television reception, which can be determined by turning the equipment off and on, the user is encouraged to try to correct the interference by one or more of the following measures:

- Reorient or relocate the receiving antenna.
- Increase the separation between the equipment and receiver.
- Connect the equipment into an outlet on a circuit different from that to which the receiver is connected.
- Consult the dealer or an experienced radio/TV technician for help.

Caution: Any changes or modifications to this device not explicitly approved by manufacturer could void your authority to operate this equipment.

This device complies with part 15 of the FCC Rules. Operation is subject to the following two conditions:

(1) This device may not cause harmful interference, and (2) this device must accept any interference received, including interference that may cause undesired operation.

This equipment complies with FCC radiation exposure limits set forth for an uncontrolled environment. This equipment should be installed and operated with minimum distance 20cm between the radiator and your body.