



Mudita Kompakt

User manual

1. Get started

FIRST INSTALL THE SIM



2. Charging and turning on

EN

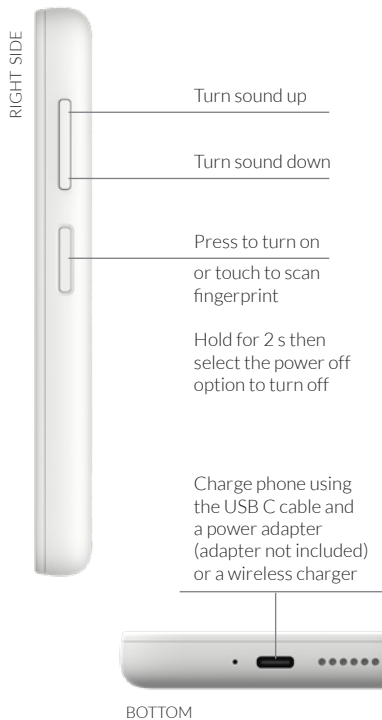

3. Offline+

Gain focus and tranquillity while ensuring privacy and zero radio frequency emissions by disconnecting the antenna and microphones and disabling the camera, WIFI and Bluetooth.



Switch up for full phone function
Switch down to use Offline+

4. Navigate the apps

EN

Plug in headphones (headphones not included)

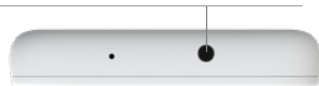

Go back

Go home

Open Control
Center



For a full set of controls and more information, please scan QR code or visit <http://www.mudita.com/kompakt/specs/>

Mudita Center

Get the most out of your Kompakt with our free software for Windows, Mac OS and Linux.

Download the latest updates
Import and backup your contacts
Find help and support

You can find Mudita center at [Web address to support page in bold]

Important Safety and Legal Information

The Mudita Kompakt is designed to send and receive phone calls and messages.

We may not be able to fix or replace your phone if you use it in a way that we advise not to, so please read this information very carefully.

By using the device, you accept the terms of the software license. You can find it online at [Web address to support page in bold] and in the phone settings. Enjoy!

Contents

IMPORTANT SAFETY INSTRUCTIONS	8
Introduction	8
General Safety Precautions	8
Medical Device Interference	9
Power Cord	9
Situational Awareness	9
Radio Frequency (RF) Exposure	10
TECHNICAL AND DISPOSAL INFORMATION.....	10
Frequency Bands and Power	10
Battery Type	12
Charging Power Adapter	12
Battery Warnings	12
BATTERY DISPOSAL	13
Disposal Information	13
Regulatory Information	14
Wireless Regulatory Compliance	14
EU Compliance	14
FCC and ISED Canada Compliance.....	14
SAR Limit of Europe.....	16
SAR Limit of USA (FCC).....	17
Intended Use.....	17
Before First Use	17
CLEANING, STORAGE AND MAINTENANCE	18
Cleaning.....	18
Storage	18
Maintenance	18
GUARANTEE INFORMATION	18
Our Guarantee.....	18
Contact Details.....	18
For More Information.....	19
Our Address	19

Important Safety Instructions

INTRODUCTION

Read these instructions carefully and retain them for future use. If this device is passed to a third party, then these instructions must be included.

When using electrical appliances, basic safety precautions should always be followed to reduce the risk of fire, electric shock, and/or injury to persons including the following:

⚠️WARNING Risk of suffocation! Keep any packaging materials away from children – these materials are a potential source of danger, e.g. suffocation.

⚠️WARNING Risk of electric shock! Do not use the device while in the bath or in other wet environments.

GENERAL SAFETY PRECAUTIONS

- Do not drop, strike, or shake the device severely. It may harm the internal circuit boards.
- Do not expose the device to direct sunlight.
- The device is not waterproof. Do not use it in wet environments.
- Do not handle the device with wet hands while it is being charged. It may cause an electric shock or seriously damage the product.
- Do not disassemble the device.
- Only authorized personnel should service the device and its accessories. Faulty installation or service may result in accidents and consequently invalidate the warranty.
- If you suspect damage to the phone or the battery, discontinue the use immediately.
- No liability will be accepted for damages resulting from improper use or non-compliance with these instructions.

MEDICAL DEVICE INTERFERENCE

The device contains magnets as well as components and/or radios that emit electromagnetic fields and might interfere with medical devices.

Consult your physician or the manufacturer of your medical device regarding potential interference from mobile phone signals.

⚠️WARNING Risk of hearing loss! To prevent possible hearing damage, do not listen at high volume levels for long periods.



Listening to sound at high volumes may damage your hearing.

Background noise, as well as continued exposure to high volume levels, can make sounds seem quieter than they actually are. Turn on audio playback and check the volume before inserting anything in your ear.

POWER CORD

- Do not damage the power cord by bending, twisting, pulling, or heating.
- Do not use the plug if it is loose as it may cause electric shock or fire.
- Do not place any heavy items on the power cord.
- Do not allow the power cord to be crimped as it may cause electric shock or fire.
- Do not sit or sleep on the power cord.
- If the power cord is damaged, stop using it immediately.

SITUATIONAL AWARENESS

- Using the device in some circumstances may distract you and might cause a dangerous situation (for example, avoid using headphones while riding a bicycle). Observe rules that prohibit or restrict the use of mobile devices or headphones.
- Always be aware of your surroundings when using the device.

- Do not use the device in high explosive areas as the phone may generate sparks.
- Do not use a hand-held phone while driving or operating machinery.
- Do not use the device in areas where its use is prohibited.
- Always follow the airlines instructions when traveling by plane.

RADIO FREQUENCY (RF) EXPOSURE

- The device emits radio frequency electromagnetic fields during operation unless in Offline+.
- Maintain a minimum distance between the device and your body especially when not in use or in Offline+.
- Use hands-free options (such as speakerphone or headphones) whenever possible.

Technical and Disposal Information

FREQUENCY BANDS AND POWER

Here is the maximum radio frequency power for each of the frequency bands that the phone uses:

Mode	Frequency Bands	Power Output (Power Value)
GSM (2G)	850/900	GSM900:32.79dBm GSM850: 32.75dBm (conducted)/29.55dBm(ERP)
	1800	GSM1800:29.46dBm
3G	2100/850/900	WCDMA B1:22.74dBm WCDMA B8:22.85dBm WCDMA B5: 23.27dBm (conducted)/20.07dBm(ERP)

Mode	Frequency Bands	Power Output (Power Value)
LTE (4G)	1/3/5/7/8/12/13/18/19/20/26/34/38/39/40/41	LTE B1:22.22dBm LTE B3: 22.85dBm LTE B7: 21.92dBm LTE B8: 22.67dBm LTE B20: 22.31dBm LTE B34: 22.49dBm LTE B38: 22.13dBm LTE B40: 21.76dBm LTE B5: 22.71dBm (conducted)/19.51dBm(ERP) LTE B12: 22.58dBm (conducted)/19.27dBm(ERP) LTE B13: 22.64dBm (conducted)/19.40dBm(ERP) LTE B18: 22.87dBm (conducted)/19.66dBm(ERP) LTE B19: 22.88dBm (conducted)/19.68dBm(ERP) LTE B26: 22.92dBm (conducted)/19.72dBm(ERP) LTE B41: 22.95dBm (conducted)/22.68dBm(EIRP)
BLUE-TOOTH	IEEE 802.15.1 (2402-2480 MHz or 2.4 GHz)	8.0 dBm (EIRP)
WIFI / WLAN	IEEE 802.11 b/g/n (2412-2484 MHz or 2.4 GHz)	14.5 dBm (EIRP)
WIFI / WLAN	IEEE 802.11 a/ac/n (4915-5925 MHz or 5 GHz)	10.9 dBm (5150-5250 MHz, EIRP) 11.5 dBm (5250-5350 MHz, EIRP) 12.7 dBm (5470-5725 MHz, EIRP) 12.9 dBm (5725-5825 MHz, EIRP)
WIRELESS CHARGING		10W
NFC	13.56 MHz	42dB μ A/m @10m

Battery Type

Lithium-(ion-)Polymer (LiPo, Li-Poly) rechargeable

Charging Power Adapter

Please make sure the AC power adapter you use is certified with a Limited Power Source output per IEC 60950-1/62368-1 rated: 5 Volts DC, maximum 1.5 Amp.

Using a different one may damage the battery.

BATTERY WARNINGS

- Keep batteries out of the reach of children.
- Remove batteries from the device if it will not be used for an extended period of time unless it is for emergency purposes.
- Do not expose the battery charger or adapter to direct sunlight or use it in places with high humidity, such as a bathroom.
- If the battery leaks avoid contact with skin and eyes. Rinse affected areas immediately with plenty of clean water, then consult a doctor.
- Before disposal, the battery must be removed from the device.
- Do not dispose of batteries in fire or with hazardous or flammable materials.
- Charge the battery in a well-ventilated area and avoid overcharging.
- Do not leave the battery charging for a prolonged period of time when the device is not in use.
- Do not charge the battery overnight.
- Unplug the power cord and charger during lightning storms to avoid electric shock or fire.
- Ensure that no sharp-edged items, such as animal's teeth or nails, come into contact with the battery. This could cause a fire.
- If the device appears to be bulging or shows other undesirable behavior (e.g. excess noise, strange smells), stop using it immediately.
- Batteries produce heat when charging and discharging.
- If the device becomes too hot to touch, switch it off and unplug it immediately.

- Do not cover the device while charging the battery.
- Charge the device in a well-ventilated environment.
- Charge the device once every 3 months to avoid shortening its battery life.
- Charge the device only with a compatible power source from reputable manufacturer certified with a Limited Power Source output per IEC 60950-1/62368-1 rated 5 V 1.5 A.

BATTERY DISPOSAL



Do not dispose of used batteries with your household waste. Take them to an appropriate disposal/collection site.

DISPOSAL INFORMATION



The Waste Electrical and Electronic Equipment (WEEE) Directive aims to minimise the impact of electrical and electronic goods on the environment, by increasing re-use and recycling and by reducing the amount of WEEE going to landfill.

The symbol on this device or its packaging signifies that this device must be disposed separately from ordinary household wastes at its end of life.

Be aware that this is your responsibility to dispose of electronic equipment at recycling centers in order to conserve natural resources.

Each country should have its collection centers for electrical and electronic equipment recycling.

For information about your recycling drop off area, please contact your related electrical and electronic equipment waste management authority, your local city office, or your household waste disposal service.

Regulatory Information

WIRELESS REGULATORY COMPLIANCE



This mobile phone has been tested and complies with the Wi-Fi standards set by the Wi-Fi Alliance. It is designed to provide reliable wireless connectivity and interoperability with other Wi-Fi certified devices.



This mobile phone has been tested and complies with Bluetooth® standards set by the Bluetooth Special Interest Group (SIG). It is designed to provide seamless connectivity and interoperability with other Bluetooth-enabled devices.

The Bluetooth® word mark and logos are registered trademarks owned by the Bluetooth SIG, Inc. and any use of such marks by Mudita Sp. z o.o. is under license.

Other trademarks and trade names are those of their respective owners.

This mobile phone complies with the Specific Absorption Rate (SAR) limits set by regulatory authorities.

The SAR value for this device has been tested and falls within the permissible limits established for safe usage.

EU COMPLIANCE



Hereby, (Mudita sp. z o.o.) declares that the radio equipment type Kompakt is in compliance with Directive 2014/53/EU.

The full text of conformity is available at the following internet address: <http://www.mudita.com/kompakt/specs/>

FCC AND ISED CANADA COMPLIANCE



This equipment has been tested and found to comply with the limits for a Class B digital device, pursuant to part 15 of the FCC

Rules. These limits are designed to provide reasonable protection against harmful interference in a residential installation.

This equipment generates uses and can radiate radio

frequency energy and, if not installed and used in accordance with the instructions, may cause harmful interference to radio communications. However, there is no guarantee that interference will not occur in a particular installation.

If this equipment does cause harmful interference to radio or television reception, which can be determined by turning the equipment off and on, the user is encouraged to try to correct the interference by one or more of the following measures:

Reorient or relocate the receiving antenna.

Increase the separation between the equipment and receiver. Connect the equipment into an outlet on a circuit different from that to which the receiver is connected. Consult the dealer or an experienced radio/TV technician for help. This device and its antenna(s) must not be co-located or operating in conjunction with any other antenna or transmitter.

This device complies with part 15 of the FCC rules and RSS-247 of Industry Canada.

Operation is subject to the following two conditions: (1) this device may not cause harmful interference, and (2) this device must accept any interference received, including interference that may cause undesired operation.

Le présent appareil est conforme aux CNR d'Industrie Canada applicables aux appareils radio exempts de licence. L'exploitation est autorisée aux deux conditions suivantes : (1) l'appareil ne doit pas produire de brouillage, et (2) l'utilisateur de l'appareil doit accepter tout brouillage radioélectrique subi, même si le brouillage est susceptible d'en compromettre le fonctionnement.

This Class B digital apparatus complies with Canadian ICES-003. Cet appareil numérique de la classe B est conforme à la norme NMB-003 du Canada.

NOTICE Unauthorized modifications could void the user's authority to operate the equipment.

You can find a copy of all the regulatory information and certificates on your phone:

Control Center Button > Settings > About > Regulatory Information

Regulatory information also be found in the full user manual.

SAR LIMIT OF EUROPE

The SAR limit of Europe is 2.0 W/kg. Device types Kompakt has also been tested against this SAR limit.

The highest SAR value reported under this standard during product certification for use at the ear is 0.490 W/kg and when properly worn on the body is 1.064 W/kg.

This device was tested for typical body-worn operations with the back of the handset kept 5 mm from the body.

To maintain compliance with RF exposure requirements, use accessories that maintain a 5 mm separation distance between the user's body and the back of the handset.

The use of belt clips, holsters and similar accessories should not contain metallic components in its assembly. The use of accessories that do not satisfy these requirements may not comply with RF exposure requirements, and should be avoided.

For the French market: limb SAR is 3.502 W/kg. This device was tested for typical body-worn operations with the back of the handset kept 0 mm from the body.

SAR LIMIT OF USA (FCC)

The SAR limit of USA (FCC) is 1.6 W/kg averaged over one gram of tissue. Device types Kompakt (FCC ID: 2BCWI-KOMPAKT) has also been tested against this SAR limit.

The highest SAR value reported under this standard during product certification for use at the ear is 0.97 W/kg and when properly worn on the body is 0.78 W/kg.

This device was tested for typical body-worn operations with the back of the handset kept 10mm from the body.

To maintain compliance with FCC RF exposure requirements, use accessories that maintain a 10mm separation distance between the user's body and the back of the handset.

The use of belt clips, holsters and similar accessories should not contain metallic components in its assembly. The use of accessories that do not satisfy these requirements may not comply with FCC RF exposure requirements, and should be avoided.

Hereby, Mudita s.p. z o.o. declares that the radio equipment type Kompakt is in compliance with the UK Radio Equipment Regulations SI 2017 No. 1206. The full text of conformity is available at: <http://www.mudita.com/kompakt/specs/>

INTENDED USE

- This device is intended for household use only. It is not intended for commercial use.
- This device is intended to be used in dry areas only.
- No liability will be accepted for damages resulting from improper use or non-compliance with these instructions.

BEFORE FIRST USE

⚠ DANGER Risk of suffocation! Keep any packaging materials away from children – these materials are a potential source of danger, e.g. suffocation.

- Check the device for transport damages.
- Remove all the packing materials.

Cleaning, Storage and Maintenance

⚠ DANGER Risk of electric shock!

- Switch the device off before cleaning.
- During cleaning do not immerse the electrical parts of the device in water or other liquids.
- Never hold the device under running water.

CLEANING

- To clean the device, wipe with a soft, slightly moist cloth.
- Dry the device after cleaning.
- Never use corrosive detergents, wire brushes, abrasive scourers, metal or sharp utensils to clean the device.

STORAGE

- Store the device in its original packaging in a dry area.
- Keep away from children and pets.
- Do not store the device in temperatures lower than -25°C or greater than +60°C.
- Do use the device in temperatures lower than 0°C or greater than +50°C.

MAINTENANCE

- Any other servicing than mentioned in this manual should be performed by a professional repair centre.

Guarantee Information

OUR GUARANTEE

We try to ensure that all our products are manufactured to the highest of standards and offer a manufacturer's 1 year guarantee from purchase.

Customers in the EU have 2 years guarantee from purchase under EU Law.
Even if your guarantee expires, please don't hesitate to contact us as we will do our best to help!

Contact Details

FOR MORE INFORMATION

You can find how-to videos, the user manual, frequently asked questions and more at:

<http://www.mudita.com/kompakt/specs/>

If you can't find an answer please don't hesitate to email our customer support: support@mudita.com

OUR ADDRESS

Mudita Sp. z o.o.
Jana Czczozota 6,
02-607 Warsaw,
Poland

Mindfully designed in Europe. Manufactured in China.

2024 © Mudita All images and content may not be used without permission. Mudita® are registered trademarks of Mudita Sp. z.o.o., registered in the EU.
Country of Origin: China.