

BtcLink Smart Wireless Thermometer.

website: www.btcclink.tech

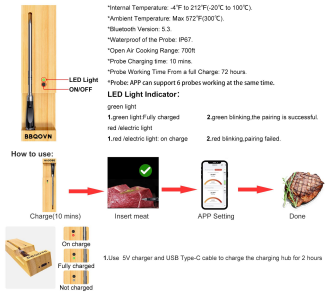

Download the APP

Search the keyword "BRCOVN" in App Store or Google play or scan from following QR code.



Connect the probe with Bluetooth:

Firstly, remove the probe from the charging block. Then it will be connected via Bluetooth if your phone Bluetooth is on.

Note: The probe can be connected to several phones or tablets.

Connect to a probe during initial setting:

If this is the first time you use the probe on your device, you can follow the APP Bluetooth process for the initial.

The APP does not have a cloud server and will not automatically collect customer private information.



How to insert the probe into the meat correctly:

Probe insert the probe into the meat deep enough (up to safe line) to get the accurate temperature.

Please avoid touching the bones which can affect the accuracy of the temperature while inserting the probe.

Smart APP Cooking Operation Guide:

Report Missing Permissions: 1. Turn on your phone's Bluetooth connection to connect the probe. 2. Click "Select menu" to choose your food.

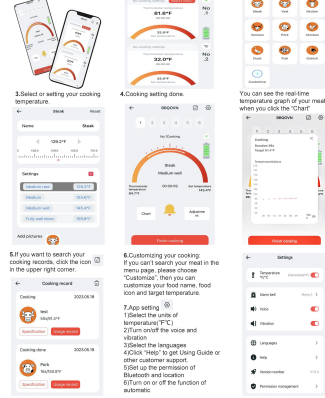

Note:

About trunks and ovens: Please do not use the probe in the oven.

About Relays and Grills: Please do not use the probe in the grill.

1. The distance of the probe is influenced by the grilling equipment. 2. Probe will be very hot during to get cook a cook. DO NOT touch it with bare hands.

Warranty:

1.6 months after-sale service.

2. If you need any further information or assistance, please feel free to contact us.

3. E-mail: Address@btcclink.tech

4. website: www.btcclink.tech

FCC Warning Statement: Changes or modifications to this unit not expressly approved by the party responsible for compliance could void the user's authority to operate the equipment. This equipment has been tested and found to comply with the limits for a Class B digital device, pursuant to Part 15 of the FCC Rules. These limits are designed to provide reasonable protection against harmful interference in a residential installation. This equipment generates, uses and can radiate radio frequency energy and, if not installed and used in accordance with the instructions, may cause harmful interference to radio communications.

However, there is no guarantee that interference will not occur in a particular installation. If this equipment does cause harmful interference to radio or television reception, which can be determined by turning the equipment off and on, the user is encouraged to try to correct the interference by one or more of the following measures:

- Reorient or relocate the receiving antenna.
- Increase the separation between the equipment and receiver.
- Connect the equipment into an outlet on a circuit different from that to which the receiver is connected.
- Consult the dealer or an experienced radio/TV technician for help.

This device complies with Part 15 of the FCC Rules. Operation is subject to the following two conditions: (1) this device may not cause harmful interference, and (2) this device must accept any interference received, including interference that may cause undesired operation.

FCC Radiation Exposure Statement

The device has been evaluated to meet general RF exposure requirement. The device can be used in portable exposure condition without restriction.