Bluetooth speaker with somatosensory vibration

BKZQ01

Instructions

Version 0.10

Thank you for choosing our company's products, please read this instruction manual carefully before use

Directory

Directory	2
Chapter I Logotype	1
1.1 Product name and model	1
1.2 Change Description	1
1.3 Manufacturer information	1
Chapter II Product Installation	2
2.1 Hardware Installation	2
2.2 System Configuration Diagram	2
Chapter III Product specifications	3
3.1 Parts list	3
3.2 Function description	3
3.3 Technical indicators	4
3.4 Form factor	5
3.5 Environmental conditions and limits on work and storage	7
3.6 FCC Warning:	9
3.7 IC WRING	10

Chapter I Logotype

1.1 Product name and model

Brand: Hangzhou Zhiyuan Technology Co., Ltd.

Products: Bluetooth speaker with somatosensory vibration

Model: BKZQ01

1.2 Change Description

Version	Time	Illustrate	Edit	Audit	Approve
V0.10	20230912				

1.3 Manufacturer information

Manufacturer: Hangzhou Zhiyuan Technology Co., Ltd.

Address : No. 10, Naxian Street, Liangzhu Mainland Industrial Park, Hangzhou, Zhejiang Province

Telephone: 0571-88212500

Email: zengrt@allytech.com.cn

Chapter II Product Installation

2.1 Hardware Installation

Control Box Installation

- 1) Connect the desired number of vibrators and speakers according to the requirements;
- 2) Insert the power cord into the power interface to supply power to the control box and turn on the system;

2.2 System Configuration Diagram

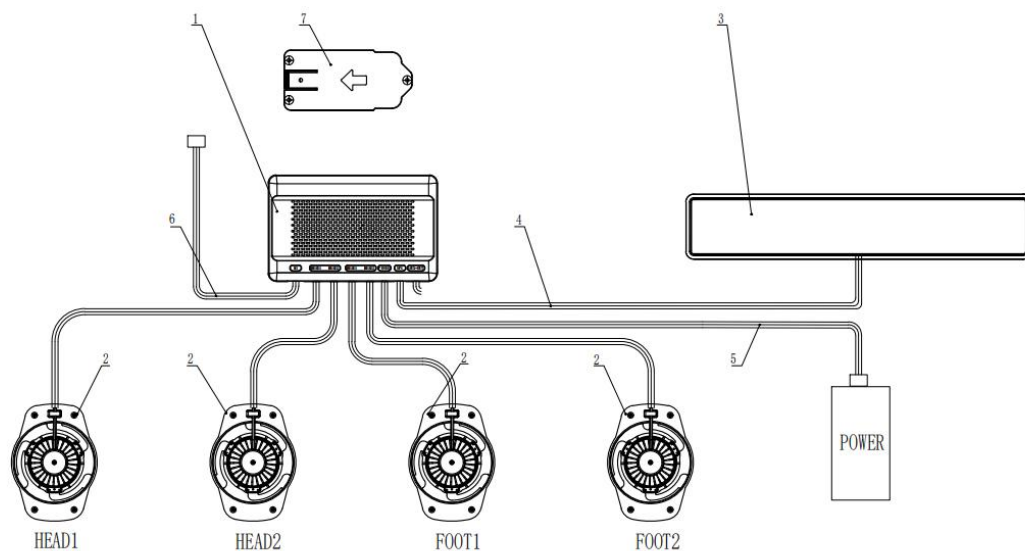

Serial Number	Parts	Serial Number	Parts
1	Control box	5	Power supply line
2	Vibrator	6	Communication line
3	Speakers	7	Control box fixing plate
4	Speaker cable		

Chapter III Product specifications

3.1 Parts list

Component	Unit	Quantity
Control Box	pcs	1
29V Power Supply	pcs	1
Speaker	pcs	1
Vibrator	pcs	4
Power supply line	pcs	1
Speaker cable	pcs	1

3.2 Function description

Interactive control function:

Serial Number	Function	Introduction
1	Bluetooth playback	After powering on, press the Bluetooth on/off button on the remote control to turn on the Bluetooth. Use a device that can act as a Bluetooth host to search for the Bluetooth name "Base Speaker-N*****". Once found, connect to this device and it will be able to play the audio output from the host. Through the remote control buttons, you can control the audio

		<p>playback, including functions such as pause/resume, volume adjustment, and previous/next track.</p>
2	Follow the audio vibration function	<p>When audio is playing, the vibrator will vibrate in sync with the low-frequency fluctuations of the audio. The vibration intensity can be adjusted in three levels.</p>
3	Massage function	<p>There are three massage modes available: continuous massage, pulse massage, and wave massage. The massage intensity can be adjusted in three levels. Continuous massage means the vibrator will vibrate continuously. Pulse massage means the vibrator will vibrate for 3 seconds and then stop for 3 seconds, repeating this cycle. Wave massage means the vibrator will start at level one and gradually increase the vibration evenly within 3 seconds, then continue at level three for 3 seconds, followed by a gradual decrease in vibration within 3 seconds back to level one, and finally, it will continue for 1 second before repeating the cycle.</p>

3.3 Technical indicators

1. Input: DC 24-30V 4A Max.
2. Output: 80W Max.
3. Oscillator impedance: 8ohm
4. Oscillator power rating: 20W
5. Oscillator output power: 10W/pcs (Follow the audio) , 15W/pcs (Massage)
6. Oscillator frequency response: 20-200Hz

7. Horn power: 8W*2

8. Speaker frequency response: 40-20kHz

9. The oscillator outputs the maximum peak-to-peak: $\pm 15.2V$

10. Operating temperature range: $-10^{\circ}C \sim 50^{\circ}C$

3.4 Form factor

A. Control box

Size: 168.5mm*106.6mm*42mm Tolerance $\pm 0.5mm$

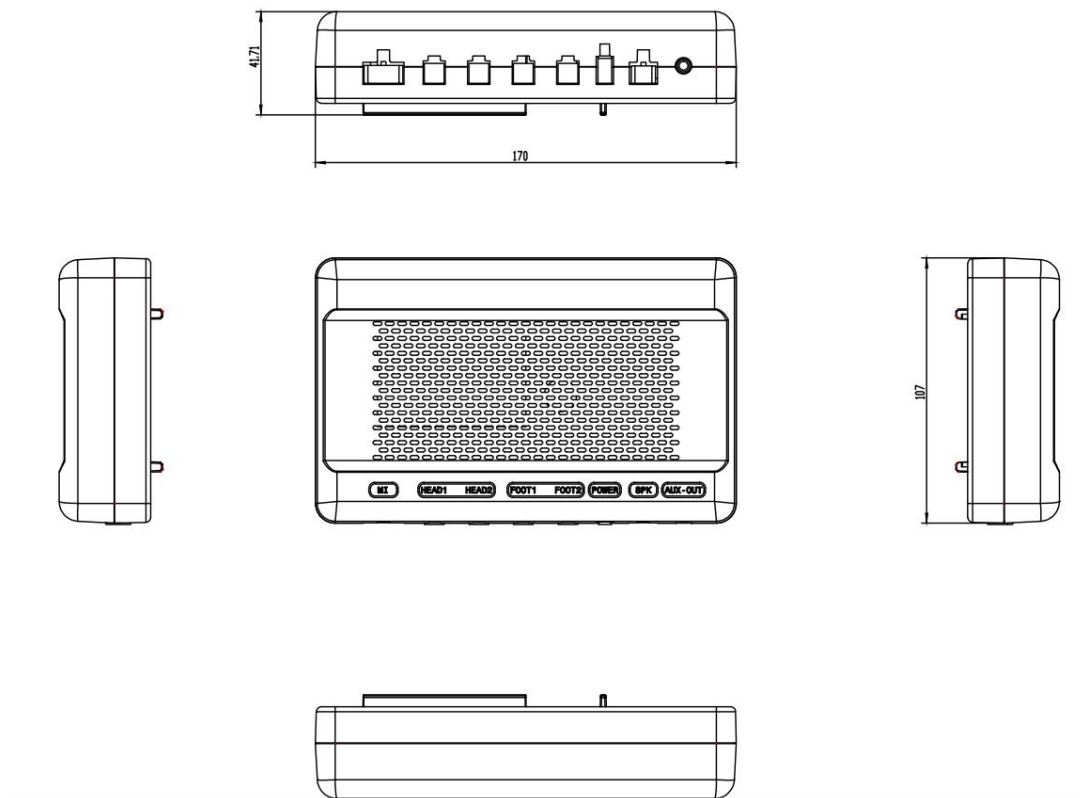

B. Vibrators

Size: 235.9mm*173.0mm*27mm ± 0.5 mm

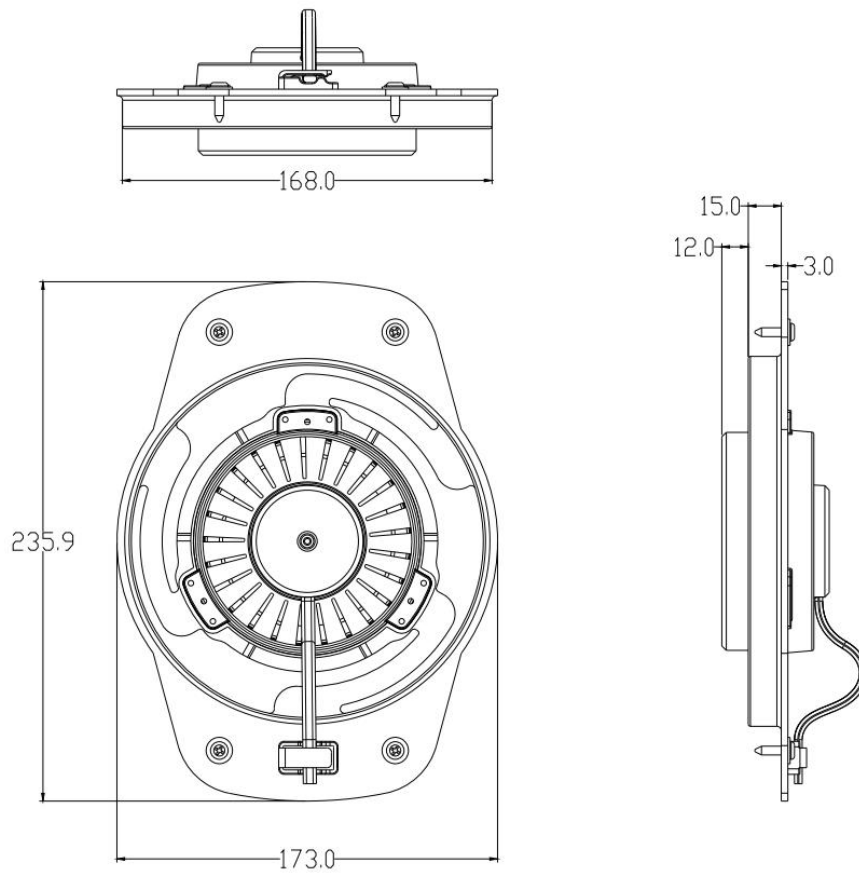

C. Speaker

尺寸 347.6mm*65.6mm*50.0mm ± 0.5 mm

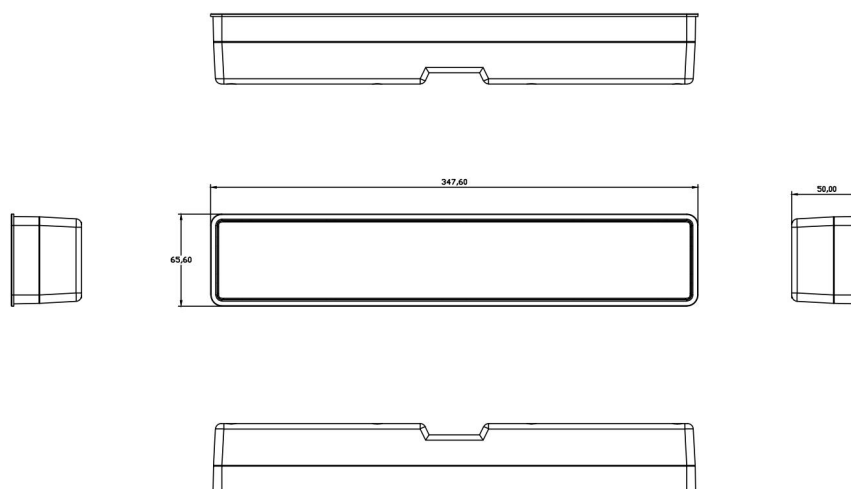

D. Control box fixing plate

尺寸 129.1mm*61.0mm*5.7mm ± 0.5 mm

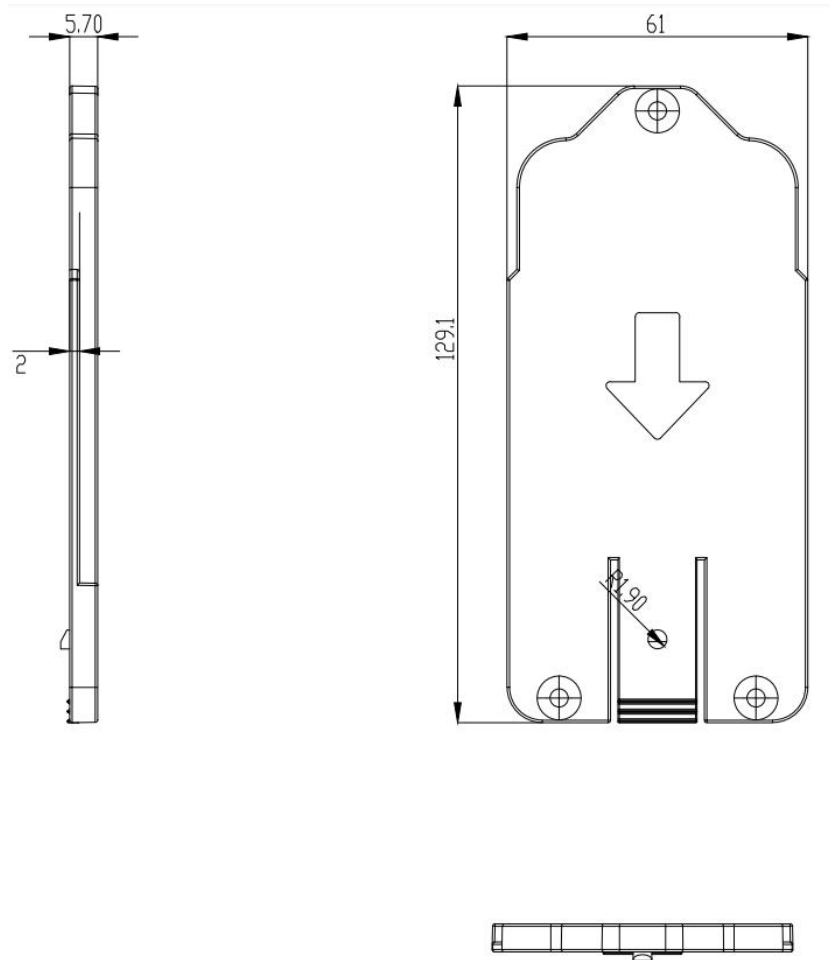

3.5 Environmental conditions and limits on work and storage

Storage environment

1. Please do not place your device in extremely cold or hot places.
2. Please avoid severe impacts or electric shocks to your device.

Working environment

1. The device is not waterproof, so please keep it dry. Avoid exposing the device to water and steam. Do not touch the device with wet hands.

2. Please do not use the device in dusty, humid, dirty, or magnetic environments.

Cleaning and maintenance

1. Before cleaning or maintaining the device, please turn it off and disconnect it from the power source.
2. Please do not use chemical cleaners, cleaning powders, or other chemical agents (such as alcohol and benzene) to clean the device. You can use an anti-static slightly damp soft cloth for wiping.

Summary of Security Information

1. Please read these safety precautions carefully to ensure the correct and safe use of your device.
2. Please connect the device to the appropriate power voltage. Exceeding the voltage range may pose a risk of damage.
3. It is recommended to use the device in the following environment:
Temperature: -10°C to 50°C; Humidity: 20% to 90%.
4. It is recommended to store the device in the following environment:
Temperature: -20°C to 70°C; Humidity: 5% to 95%.

3.6 FCC Warning:

This equipment has been tested and found to comply with the limits for a Class B digital device, pursuant to part 15 of the FCC Rules. These limits are designed to provide reasonable protection against harmful interference in a residential installation. This equipment generates, uses and can radiate radio frequency energy and, if not installed and used in accordance with the instructions, may cause harmful interference to radio communications. However, there is no guarantee that interference will not occur in a particular installation. If this equipment does cause harmful interference to radio or television reception, which can be determined by turning the equipment off and on, the user is encouraged to try to correct the interference by one or more of the following measures:

- Reorient or relocate the receiving antenna.
- Increase the separation between the equipment and receiver.
- Connect the equipment into an outlet on a circuit different from that to which the receiver is connected.
- Consult the dealer or an experienced radio/TV technician for help.

This device complies with Part 15 of the FCC Rules. Operation is subject to the following two conditions:

- (1) this device may not cause harmful interference, and
- (2) this device must accept any interference received, including interference that may cause undesired operation.

Any changes or modifications to this unit not expressly approved by the party responsible for compliance could void the user's authority to operate the equipment.

The equipment complies with FCC radiation exposure limits set forth for an uncontrolled environment, This transmitter must not be co-located or operating in conjunction with any other antenna or transmitter.

The equipment should be installed and operated with minimum distance 20cm between the radiator and your body.

3.7 IC WRING

This device complies with Innovation, Science and Economic Development Canada license-exempt RSS standard(s). Operation is subject to the following two conditions:

- (1) this device may not cause interference, and
- (2) this device must accept any interference, including interference that may cause undesired operation of the device.

Le présent appareil est conforme aux CNR d'Industrie Canada applicables aux appareils radio exempts de licence. L'exploitation est autorisée aux deux conditions suivantes :

- (1) l'appareil ne doit pas produire de brouillage, et
- (2) l'utilisateur de l'appareil doit accepter tout brouillage radioélectrique subi, même si le brouillage est susceptible d'en compromettre le fonctionnement.

CAN ICES-3(B)

NMB-3(B)

The equipment complies with ISED radiation exposure limits set forth for an uncontrolled environment, This transmitter must not be co-located or operating in conjunction with any other antenna or transmitter. The equipment should be installed and operated with minimum distance 20cm between the radiator and your body.

Déclaration d'exposition aux radiations: Cet équipement est conforme aux

limites d'exposition aux rayonnements ISED Canada établies pour un environnement non contrôlé. Cet équipement doit être installé et utilisé avec un minimum de 20 cm de distance entre la source de rayonnement et votre corps.