



Appendix D

Photographs

1. SAR measurement System
2. Photographs of Tissue Simulate Liquid
3. Photographs of EUT test position
4. EUT Constructional Details







1. SAR measurement System

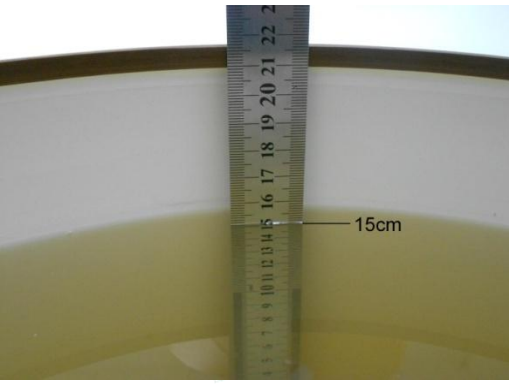
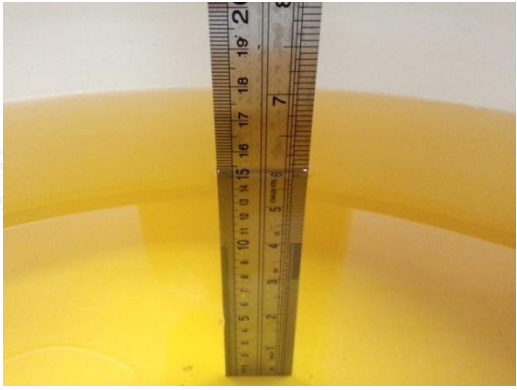
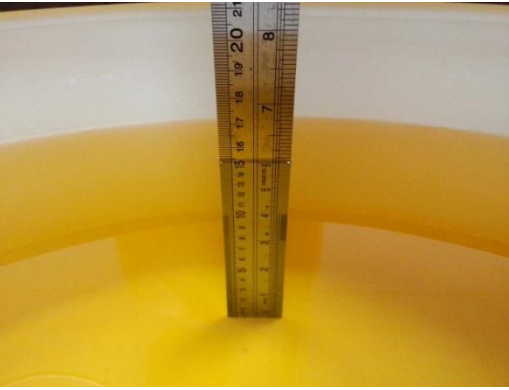

2. Photographs of Tissue Simulate Liquid

Photo 1: Tissue Simulant Liquid for Head 750	Photo 2: Tissue Simulant Liquid for Head 835
	
Photo 3: Tissue Simulant Liquid for Head 1750	Photo 4: Tissue Simulant Liquid for Head 1900
	
Photo 5: Tissue Simulant Liquid for Head 2450	Photo 6: Tissue Simulant Liquid for Head 2600
	
Photo 7: Tissue Simulant Liquid for Head 5000	NA





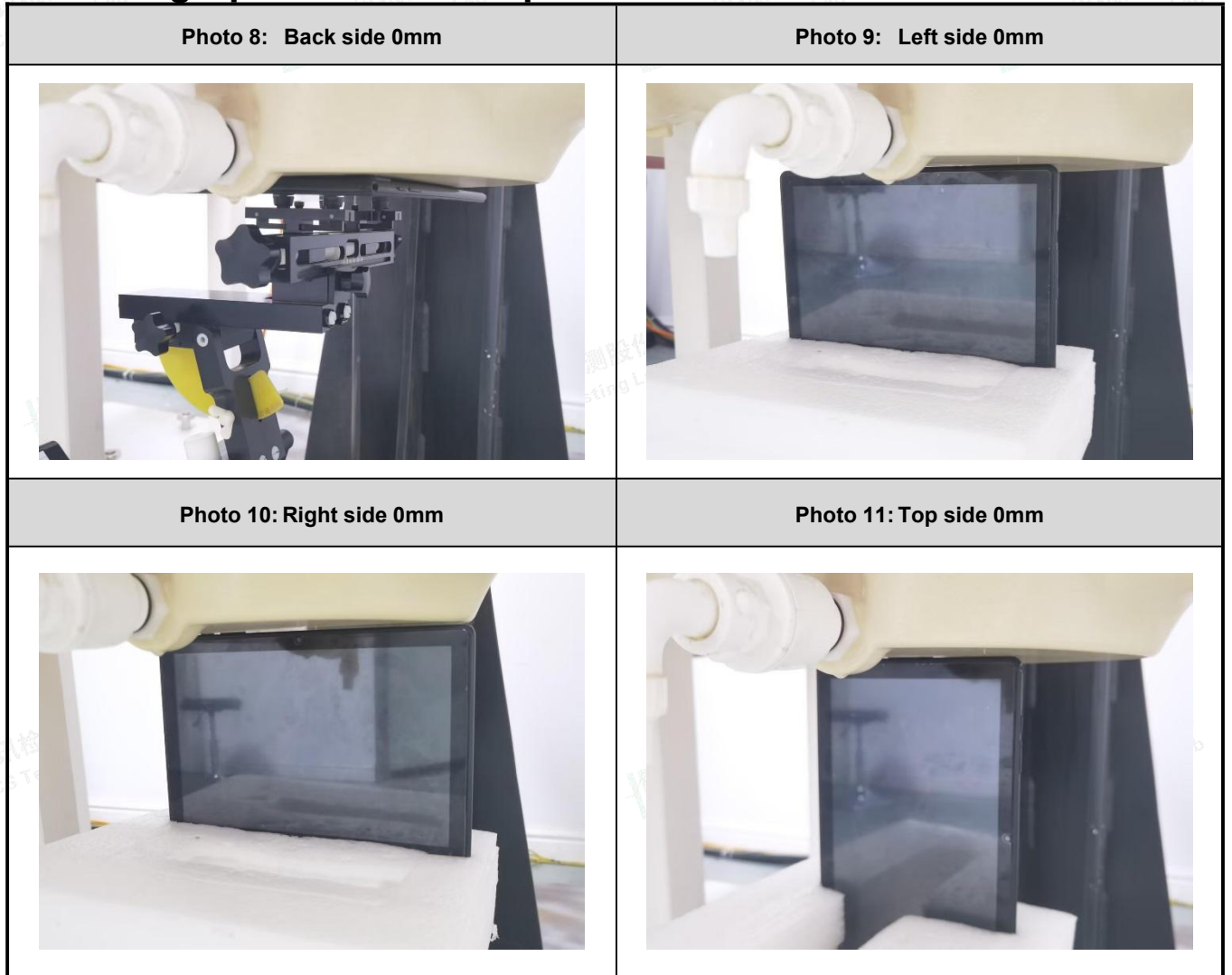

3. Photographs of EUT test position





4. EUT Constructional Details

Photo 12: Front View	Photo 13: Back View
	



Shenzhen LCS Compliance Testing Laboratory Ltd.
Add: 101, 201 Bldg A & 301 Bldg C, Juji Industrial Park Yabianxueziwei, Shajing Street, Baoan District, Shenzhen, 518000, China
Tel: +(86) 0755-82591330 | E-mail: webmaster@lcs-cert.com | Web: www.lcs-cert.com
Scan code to check authenticity