

## Instruction of 2.4G Armored-Warrior Twistable and Amphibious Car

### 1. About remote controller

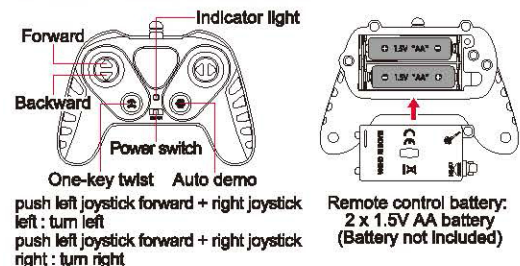

The pairing of remote controller:  
First turn on the remote. When the light is flashing, turn on the car, and then the light of remote is off, meaning the pairing is done.

### 2. Watch controller (To be purchased separately)

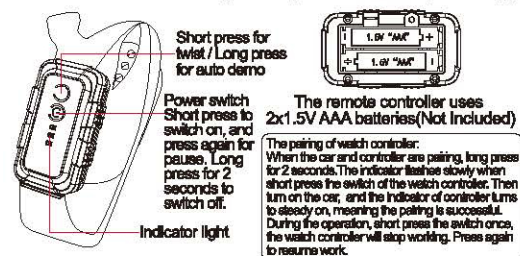

### 4. Remote control operation

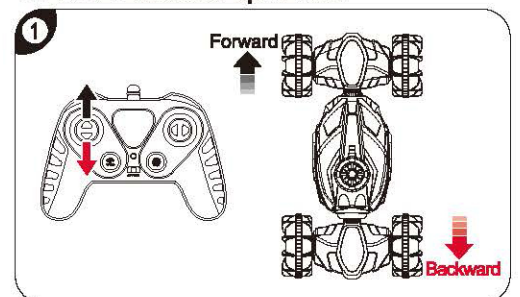

**1. Forward, Backward**  
Push left joystick up to make the car go forward.  
Push left joystick down to make the car go backward.

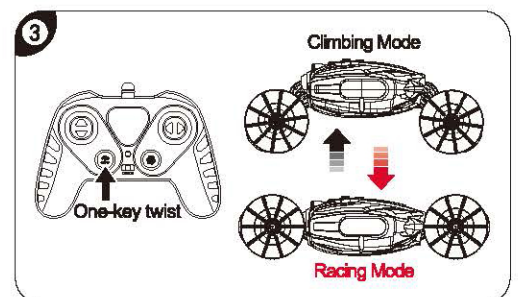

3. One-key twist

### 3. Battery installation of the car

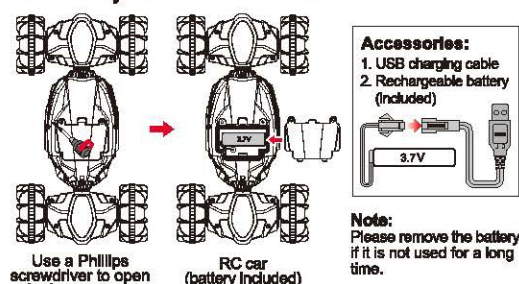

### Attention for Charging via USB

- Battery should be fully charged for the first time using. The battery will still self-discharge when not in use. If not in use for a long time, please ensure that the battery has about half of the power to prevent overcharge damage. Overcharging can shorten battery life.
- Please regularly check the cord, plug, casing and other accessories and stop using before being repaired if any damages are found.
- Do not connect the toys with the power that is not recommended. Charging conditions: Connect the USB smart charging cable with the original battery.
- Please use appropriate adapter instead of fast charger for charging.
- Please use the right adapter for charging. Input: 100-240V-50/60Hz 0.2A; output: 5.0V --- 500mA 0.5-1.5A.
- Charging notes: To charge the battery, please connect the battery with smart USB charging cable, which has access to power media with USB interface, such as: desktop, laptop, mobile power, USB socket. Alternatively, you can use a USB adapter to connect with the power for charging.
- Please remove the battery for the remote control truck and the remote controller if they are not expected to use for a long period of time.

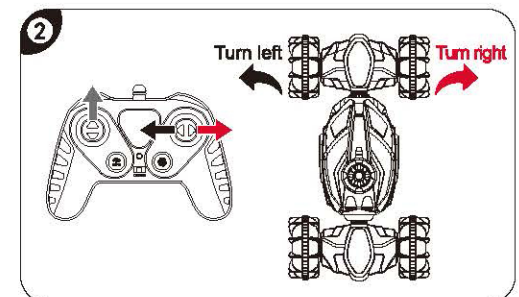

**2. Turn left, Turn right**  
Push left joystick up and right joystick left to make the car turn left. Push left joystick up and right joystick right to make the car turn right.

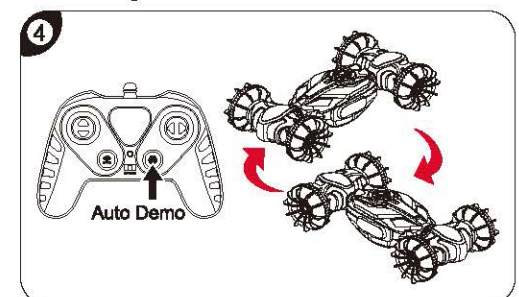

4. Auto Demo

### 5. Play with the Watch Controller

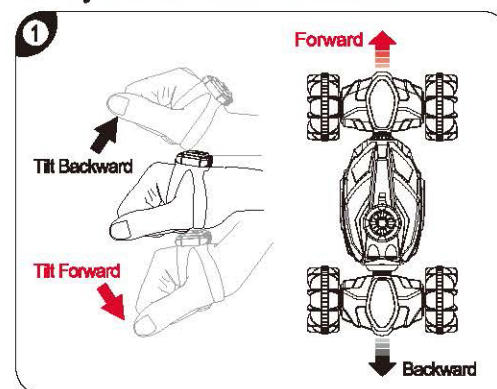

**1. Forward and Backward**  
It will move forward when your fist horizontally tilts forward and move backward when your fist horizontally tilts backward.

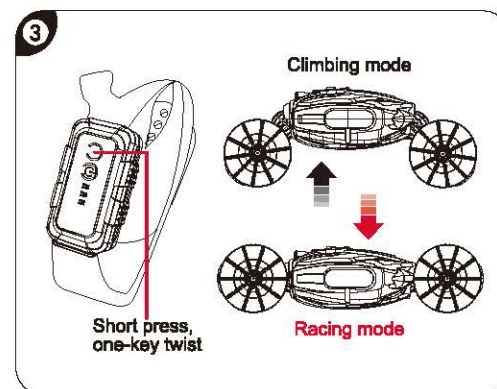

3. One-key twist

### 6. Battery Storage

- Do not fully charge the battery before keeping it for a long time, otherwise it would result in the passivation, which speeds up the process of self-discharge.
- Place the battery in dry indoor space with appropriate temperature between 10°C-30°C.
- Conduct a charge cycle every other 3 months to keep it active and perform well.

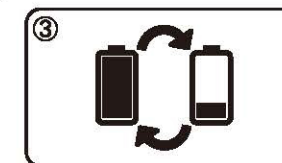
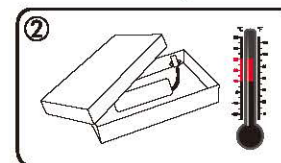

- Notes:
- When playing in the water, you must be accompanied by an adult. Avoid drowning risks.
  - It is forbidden to play in waters with large waves to avoid insufficient power of the car.
  - After the car plays in the water, clean the dust and water on the car with a rag.
  - When the car power is low, the controller light will flash slowly, then please take the car back in time, especially when playing in the water, to avoid being too far away from the shore without enough time to take it back.

\*Please read through this manual before operation and keep it properly for future reference.

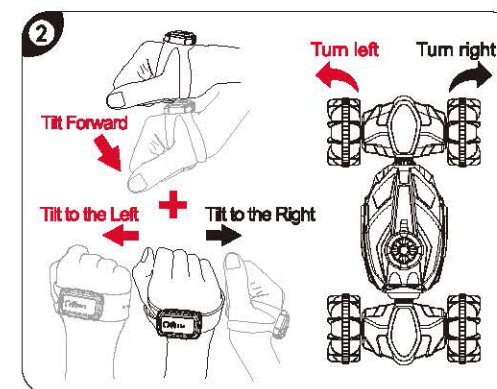

**2. Turn left, turn right**  
Tilt the fist forward, then left, to make the car turn left. Tilt the fist forward, then right, to make the car turn right.

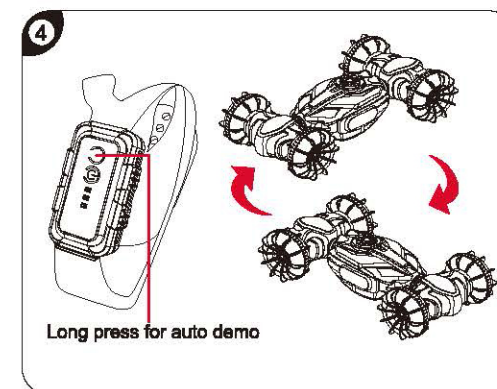

4. Auto demo

Any changes or modifications not expressly approved by the party responsible for compliance could void the user's authority to operate the equipment.

This device complies with Part 15 of the FCC Rules. Operation is subject to the following two conditions:

- (1) this device may not cause harmful interference, and
- (2) this device must accept any interference received, including interference that may cause undesired operation.

Note: This equipment has been tested and found to comply with the limits for a Class B digital device, pursuant to Part 15 of the FCC Rules. These limits are designed to provide reasonable protection against harmful interference in a residential installation. This equipment generates, uses, and can radiate radio frequency energy, and if not installed and used in accordance with the instructions, may cause harmful interference to radio communications. However, there is no guarantee that interference will not occur in a particular installation. If this equipment does cause harmful interference to radio or television reception, which can be determined by turning the equipment off and on, the user is encouraged to try to correct the interference by one or more of the following measures:

- Reorient or relocate the receiving antenna.
  - Increase the separation between the equipment and receiver.
  - Connect the equipment into an outlet on a circuit different from that to which the receiver is connected.
  - Consult the dealer or an experienced radio/TV technician for help.
- "CAUTION: Any changes or modifications not expressly approved could void the user's authority to operate the equipment."

The device has been evaluated to meet general RF exposure requirement.

USA Adress: 5354 Irwindale Ave Unit A Irwindale CA 91706  
Tel: 626-330-1988