

105 mm

85 mm

765 mm

QplusTM
smartQUICK & EASY
START GUIDE**Before you begin**

- Make sure your mobile device is running the latest version of iOS or Android.
- Verify your network and ensure your mobile device is connected to a 2.4 GHz Wi-Fi channel.

1 Download

Download the **Smart Life-Smart Living** App from the App Store or Google Play on your mobile device.



Smart Life - Smart Living
Tuya Inc.
Lifestyle

**2 Register / Login**

Launch the Smart Life App from Tuya Inc. To register, enter your mobile phone number or email address. Create a password and log in.

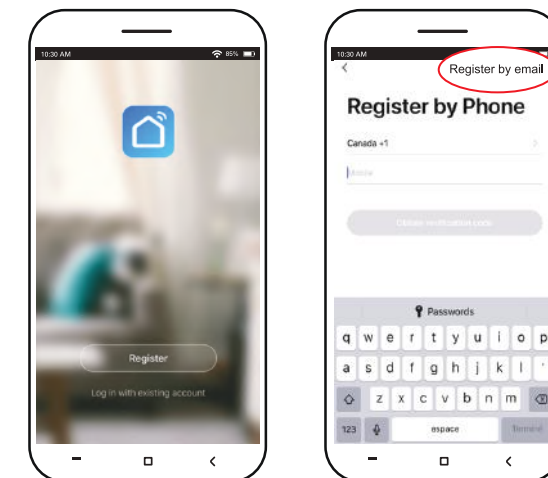
**3 Light it up**

Install your smart bulb. The bulb will blink, which is normal since it is in search mode. If the bulb goes on normally without blinking, it has already been set up. You must close and open the switch 3 times in a row to enter search mode. Follow the instructions on the application.

4 Add the Device

Select the “+” symbol on the top right corner. Select “Smart Lighting” and then “Lighting Devices”. Follow the instructions to pair the device.

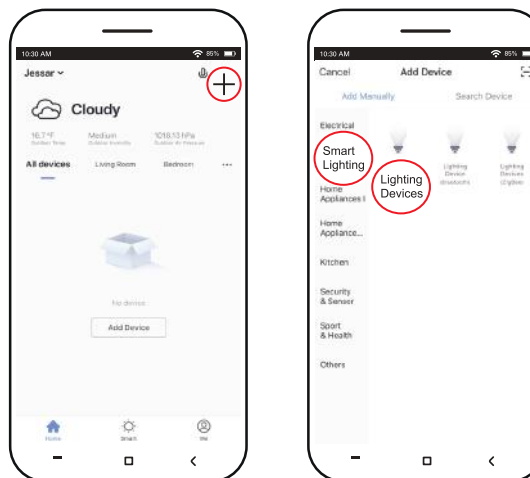
**5 Setting up a third-party for your voice assistant**

In the “Smart life” menu, go to the “ME” page followed by “More Service” mode to help you select your voice assistant step by step.

From your **Google Home** application:

1. In the home menu select the symbol “+” following “Set up device.”
2. Find the Smart Life app and select “Enable.”
3. Enter the same registry that you previously used in the Smart Life app.

You can now say commands such as:

“OK Google, dim the bedroom lights to 10%.”
“Ok Google, turn on / off the lights in my bedroom.”

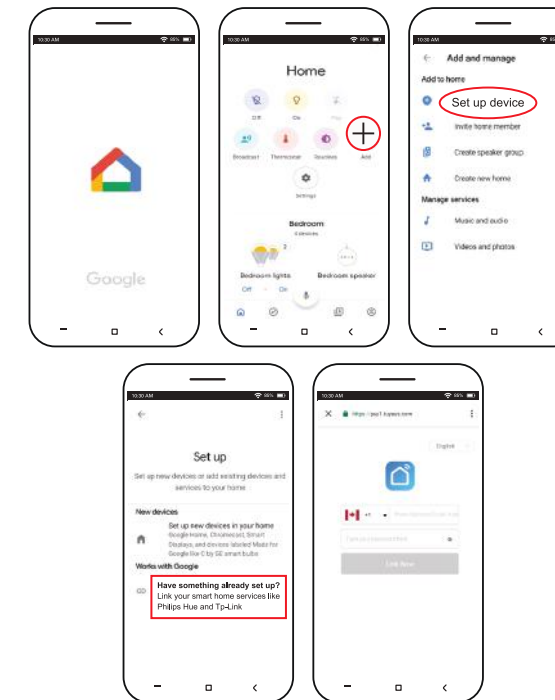

Or;

From your **Amazon Alexa** application:

1. In the “Skills” menu search for the Smart Life app and select “Enable.”
2. Enter the same registry that you previously used in the Smart Life app.

You can now say commands such as:

“Alexa, dim the lights of the kitchen to 10%.”
“Alexa, turn on / off the lights in my room.”

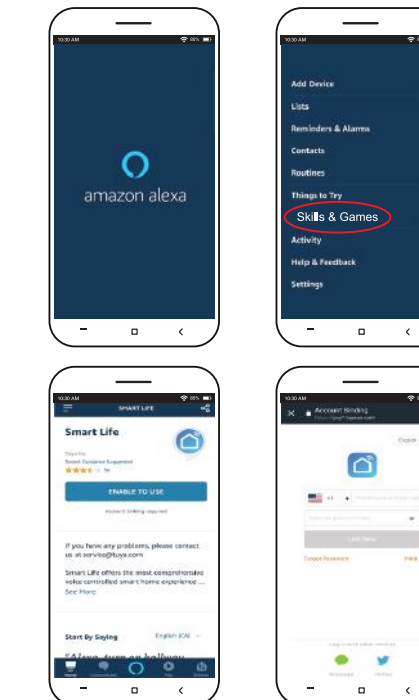

105 mm

85 mm

765 mm



GUIDE DE DÉMARRAGE RAPIDE ET FACILE

Avant de commencer

- Assurez-vous que votre appareil mobile est sur la version la plus récente du IOS ou Android.
- Vérifiez que votre appareil mobile soit sur un réseau sans fil (Wi-Fi) de 2.4 GHz.

1 Télécharger

Téléchargez sur votre appareil mobile l'application **Smart Life-Smart Living** depuis l'App Store ou Google Play.



Smart Life - Smart Living
Tuya Inc.
Lifestyle



2 Enregistrement / Connexion

Lancez l'application Smart Life de Tuya Inc. Pour vous enregistrer, entrez votre numéro de téléphone mobile ou votre adresse courriel. Créer un mot de passe puis, connectez-vous.

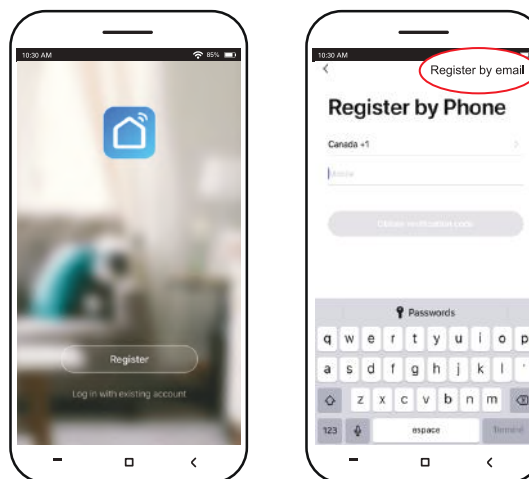

3 Allumez l'appareil

Vissez votre ampoule intelligente. L'ampoule clignotera, cela est normal puisqu'elle est en mode recherche. Si l'ampoule s'allume normalement sans clignoter c'est qu'elle a déjà été configurée. Vous devez allumer et éteindre l'interrupteur 3 fois de suite pour entrer en mode recherche. Suivez les directives sur l'application.

4 Ajouter un Appareil

Sélectionnez le symbole "+" dans le coin supérieur droit. Sélectionner l'ampoule intelligente et suivez les directives.

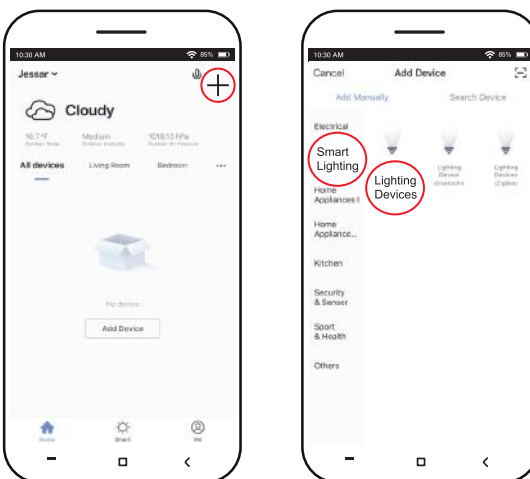

5 Configuration d'un tiers parti sur votre assistant vocale

Dans le menu du "Smart Life" allez sur la Page "ME" suivi du mode "More Service" pour vous aider à sélectionner votre assistant vocale.

De l'application **Google Home**:

1. Dans le menu d'accueil, sélectionnez le symbole "+", ensuite "Set up device."

2. Recherchez l'application Smart Life et sélectionnez "Enable."

3. Entrez le même registre que vous avez utilisé précédemment dans l'application Smart Life.

Vous pouvez maintenant dire des commandes tel que:

"OK Google, tamise les lumières de la chambre à 10%."

"OK Google, allume / éteint les lumières de ma chambre."

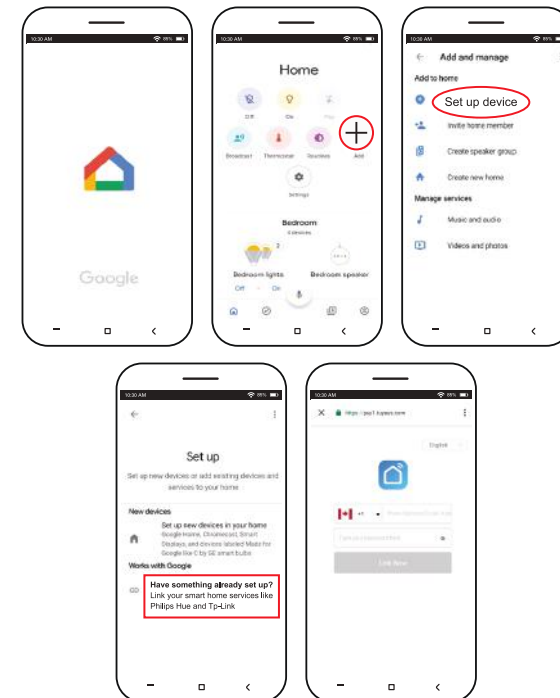

Ou encore ;

De l'application **Amazon Alexa**

1. Dans le menu "Skills" recherchez l'application Smart Life et sélectionnez "Enable."

2. Entrez le même registre que vous avez utilisé précédemment dans l'application Smart Life.

Vous pouvez maintenant dire des commandes tel que:

"Alexa, tamise les lumières de la cuisine à 10%."

"Alexa, allume / éteint les lumières de ma chambre."

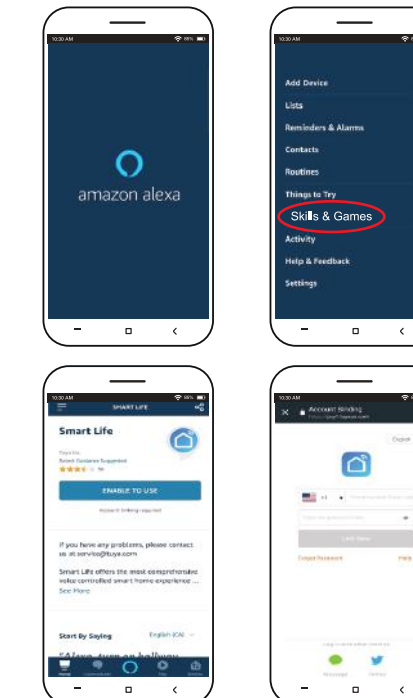

FCC Caution:

Any Changes or modifications not expressly approved by the party responsible for compliance could void the user's authority to operate the equipment.

This device complies with part 15 of the FCC Rules. Operation is subject to the following two conditions: (1) This device may not cause harmful interference, and (2) this device must accept any interference received, including interference that may cause undesired operation.

IMPORTANT NOTE:

Note: This equipment has been tested and found to comply with the limits for a Class B digital device, pursuant to part 15 of the FCC Rules. These limits are designed to provide reasonable protection against harmful interference in a residential installation. This equipment generates, uses and can radiate radio frequency energy and, if not installed and used in accordance with the instructions, may cause harmful interference to radio communications. However, there is no guarantee that interference will not occur in a particular installation. If this equipment does cause harmful interference to radio or television reception, which can be determined by turning the equipment off and on, the user is encouraged to try to correct the interference by one or more of the following measures:

—Reorient or relocate the receiving antenna.

—Increase the separation between the equipment and receiver.

—Connect the equipment into an outlet on a circuit different from that to which the receiver is connected.

—Consult the dealer or an experienced radio/TV technician for help.

This equipment complies with FCC radiation exposure limits set forth for an uncontrolled environment. This equipment should be installed and operated with minimum distance 20cm between the radiator & your body.

ISED Warning

This device complies with Innovation, Science, and Economic Development Canada licence-exempt RSS standard(s). Operation is subject to the following two conditions:

(1) this device may not cause interference, and

(2) this device must accept any interference, including interference that may cause undesired operation of the device.

Le présent appareil est conforme aux CNR d'Innovation, Sciences et Développement économique Canada applicables aux appareils radio exempts de licence. L'exploitation est autorisée aux deux conditions suivantes :

(1) l'appareil ne doit pas produire de brouillage, et

(2) l'utilisateur de l'appareil doit accepter tout brouillage radioélectrique subi, même si le brouillage est susceptible d'en compromettre le fonctionnement.

The device is compliance with RF exposure guidelines, users can obtain Canadian information on RF exposure and compliance. The minimum distance from body to use the device is 20cm.

Le présent appareil est conforme Après examen de ce matériel aux conformité ou aux limites d'intensité de champ RF, les utilisateurs peuvent sur l'exposition aux radiofréquences et la conformité and compliance d'acquérir les informations correspondantes. La distance minimale du corps à utiliser le dispositif est de 20cm