

Add your Camera

To begin viewing your camera, add it to the Night Owl app or to a compatible recorder.

For more detailed setup steps, scan the QR codes below.



Standalone
(Add to the App)



Ecosystem
(Add to a Recorder)

Status LED Guide

LED Status	Camera Status
Solid Red	Camera Powering ON
Fast Blinking Blue	Ready to Pair
Slow Blinking Blue	Pairing / Reconnecting
Solid Blue	Camera ON and Paired
Fast Blinking Red & Blue	Firmware Upgrade



Remove Protective Film

Quickly remove the clear protective film from the camera lens.

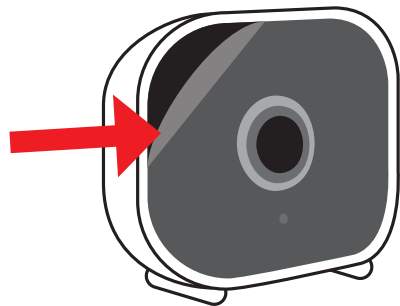

Install the Camera

Your camera can be set up 3 different ways:

- a** Use the stand and place the camera on a flat surface.



- b** Remove the stand and place the camera cube on a flat surface.



- c** Mount the camera using the camera stand and mounting hardware.

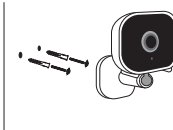

Need Help?

We are here for you

Our support site is filled with self-help material. From your support page you can use the Live Chat feature or contact our Live Phone support.

1. Please visit Support.NightOwlSP.com
2. Enter FWIP2 into the Search bar

FCC RADIATION NORM FCC

This device complies with Part 15 of the FCC Rules. Operation is subject to the following two conditions: (1) this device may not cause harmful interference, and (2) this device must accept any interference received, including interference that may cause undesired operation.

FCC Compliance Statement These limits are designed to provide reasonable protection against frequency interference in residential installation. This equipment generates, uses, and can radiate radio frequency energy, and if not installed or used in accordance with the instructions, may cause harmful interference to radio communication. However, there is no guarantee that interference will not occur in television reception, which can be determined by turning the equipment off and on. The user is encouraged to try and correct the interference by one or more of the following measures:

- Reorient or relocate the receiving antenna.
- Increase the separation between the equipment and the receiver.
- Connect the equipment into an outlet on a circuit different from that to which the receiver is connected.
- Consult the dealer or an experienced radio/TV technician for help.

CAUTION!

The Federal Communications Commission warns the user that changes or modifications to the unit not expressly approved by the party responsible for compliance could void the user's authority to operate the equipment. This equipment should be installed and operated with a minimum distance of 8 inches between the radiator and your body.

Quick Setup Guide

Let's get started

What's Included

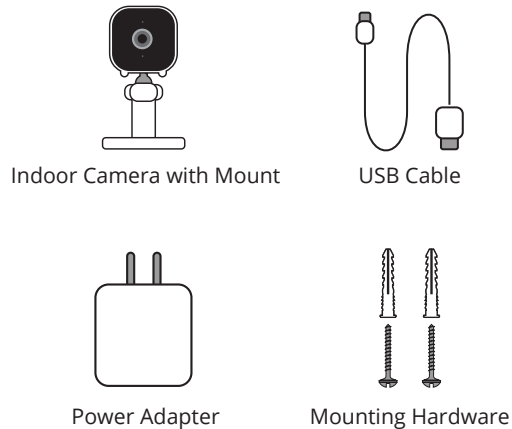

NOTE: If mounting the camera, you will need a screwdriver or drill (not included).

Camera Details

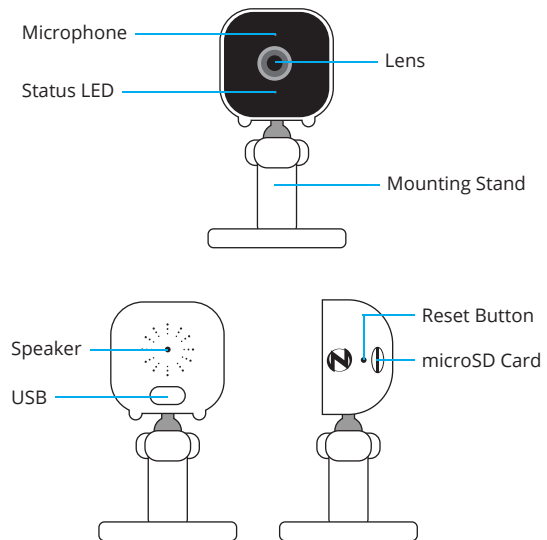

Download the Night Owl App

If you are a first-time user, go ahead and download the Night Owl app. Quickly create an account and log in.

Already have an account? Simply log in.



Plug It In

Use the provided USB cable and power adapter to plug your camera into an outlet.

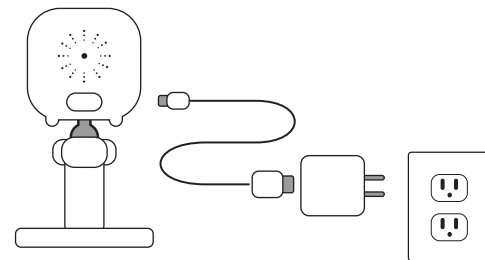

NOTE: For initial setup/pairing, have your camera within 1 to 3 feet of your router or recorder.