

Installation instructions:

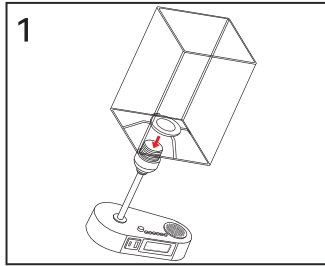

1. Install the lampshade on the lamp base

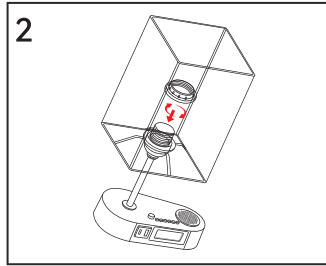

2. Lock the lamp cap nut

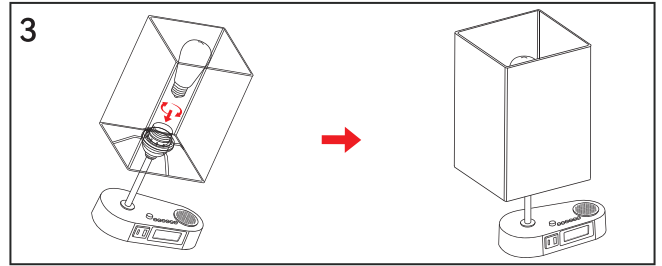



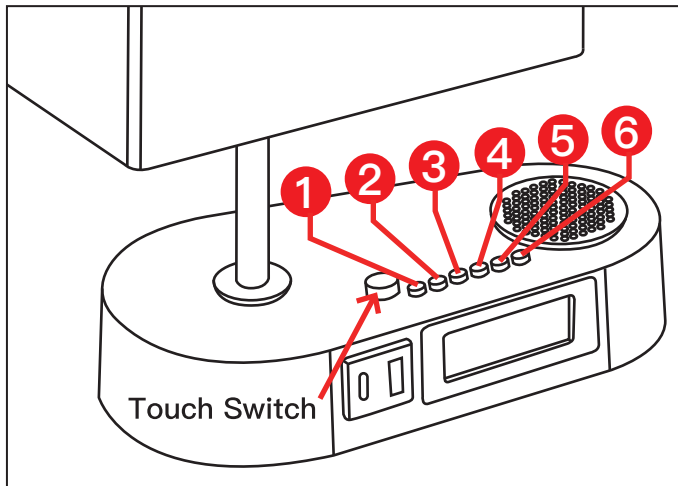



3. Install the bulb into the base
(Don't tighten the bulb too hard, or the bulb will be poorly contacted, just feel slight resistance)



Introduction of keys:

 Touch switch: touch to turn on, hold on to touch to turn off

1.  Power key: function mode
2.  Time set/Bluetooth playback pause
3.  - key
4.  + key
5.  VOL - key
6.  VOL + key

Product Function Introduction:

1. Touch switch: three levels brightness (low, medium and high) can be adjusted
2. Dual alarm clocks: three alarm times available (Mon to Fri, Sat to Sun, Mon to Sun)
3. Bluetooth supported: connected with playback devices
4. Dual output port: USB + USB-C
5. LED display: two levels brightness (Exit Bluetooth mode, hold on to press 1 to adjust)
6. Twelve-hour clock (AM/PM): automatically calibrates the time when bluetooth connected

Specification:

Lamp Wattage: 120V/21W
Bulb Wattage: 120V/6W
Voltage Output: 5V-2.1A(USB, USB-C)
Color Temperature: 2700K
Bluetooth Name: CA0503BT
Bluetooth Connection Distance: 10M

Packing list:

Bulb x1
Lampshade x1
Lamp body x1
Lamp cap nut x 1
Instruction x1

Warm Tips







When you set clock and alarm clock, pls exit bluetooth mode.

When the alarm clock rings, bluetooth will exit automatically, pls connect again after alarm clock ends.





When the table lamp is unplugged or power cut, it will factory reset, pls set again.

Any questions about the lamp or manual, pls contact us, we will surely help with videos and more details.















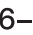



Bluetooth Setting

Enter Mode	Press  to enter bluetooth mode, "BT" will flash on the display screen, there will be voice prompt after connected CA0503BT
Function Selection	Press  to play/pause music,press  to play the last song,press  to play the next song
Vol Setting	Press or hold on to press  to reduce vol, press or hold on to press  to increase vol

Clock Setting

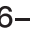
Pls press  to exit bluetooth mode before set clock time, "BT" off	
Enter Mode	Hold on to press  , enter the time set mode
Manual Setting	Press  to adjust hour,press  to adjust minute,wait the digitals stop flashing, save automatically
Auto Setting	Time will be automatically synchronized when bluetooth connected (PS: Time automatically updates with iOS system; Time can be only updated after information authorized with Android system)

Alarm Clock Setting

AL1 Setting (Pls press  to exit bluetooth mode before set AL1, "BT" off)	
AL1 State	Press  to turn on or turn off AL1, AL1 state shows on the display screen
Enter Mode	Hold on to press  until the digitals flash to enter the AL1 setting.
Setting Steps	Press  to adjust hour,press  to adjust minute→press  to enter AL1 time selection, press  or  to select AL1 time(1-5, 6-7,1-7) → wait the digitals stop flashing, save automatically (default ringtone, the volume will gradually increase)
Ditch the Alarm Clock	Press  or  to turn off when AL1 rings
AL2 Setting (Pls press  to exit bluetooth mode before set AL2,"BT" off)	
AL2 State	Press  to turn on or turn off AL2, AL2 state shows on the display screen.
Enter Mode	Hold on to press  until the digitals flash to enter the AL2 setting.
Setting Steps	Press  to adjust hour,press  to adjust minute→press  to enter AL2 time selection, press  or  to select AL2 time(1-5, 6-7,1-7) → wait the digitals stop flashing, save automatically (default ringtone, the volume will gradually increase)
Ditch the Alarm Clock	Press  or  to turn off when AL2 rings

FCC Caution:

This device complies with part 15 of the FCC Rules. Operation is subject to the following two conditions: (1) this device may not cause harmful interference, and (2) this device must accept any interference received, including interference that may cause undesired operation.

Any changes or modifications not expressly approved by the party responsible for compliance could void the user's authority to operate the equipment.

NOTE: This equipment has been tested and found to comply with the limits for a Class B digital device, pursuant to Part 15 of the FCC Rules. These limits are designed to provide reasonable protection against harmful interference in a residential installation. This equipment generates, uses and can radiate radio frequency energy and, if not installed and used in accordance with the instructions, may cause harmful interference to radio communications. However, there is no guarantee that interference will not occur in a particular installation.

If this equipment does cause harmful interference to radio or television reception, which can be determined by turning the equipment off and on, the user is encouraged to try to correct the interference by one or more of the following measures:

- Reorient or relocate the receiving antenna.
- Increase the separation between the equipment and receiver.
- Connect the equipment into an outlet on a circuit different from that to which the receiver is connected.
- Consult the dealer or an experienced radio/TV technician for help.

To maintain compliance with FCC's RF Exposure guidelines, This equipment should be installed and operated with minimum distance between 20cm the radiator your body: Use only the supplied antenna.