

Wire Your Device

Before installing, prepare a Phillips and slotted screwdriver, pliers, wire strippers, and a non-contact voltage detector.

- 1 **Turn off** the circuit breaker. Use a voltage detector to ensure there is no power going to the outlet.

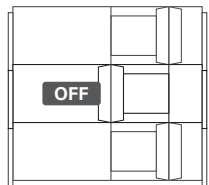

- 2 **Remove** the old outlet and gently pull it out.

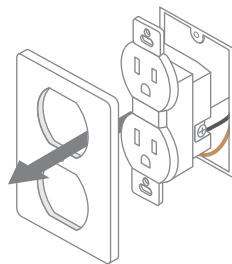

- 3 **Identify** the wires and disconnect the old wires.

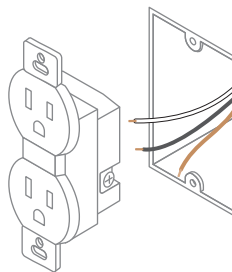

Neutral: Usually white.

Ground: Usually green or copper.

Line: Usually black and coming from the circuit breaker.

- 4 **Connect** the wires to the correct terminals of your new outlet as shown below. Follow the instructions on the product label or refer to your old outlet's wiring. If you are unsure, consult a qualified electrician.

Note:
Use 14 AWG or larger wires and the recommended wire-stripping length is 12 mm/0.47 inch.

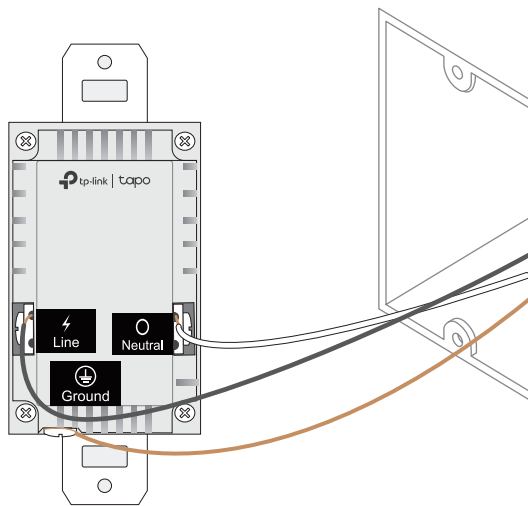

- 5 **Line** up the outlet with mounting holes and secure it with the longer screws provided.

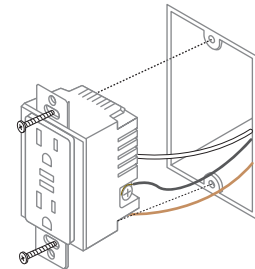

- 6 **Secure** the wallplate connector with the shorter screws provided. Ensure the UP arrow on the back of the wallplate points up, and then snap on the wallplate.

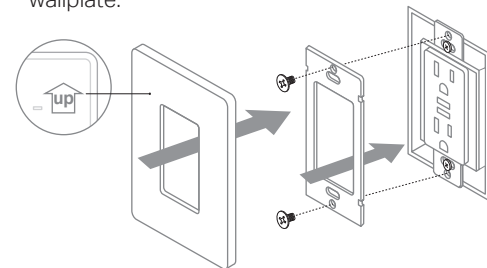

Set Up Your Device via Tapo

STEP 1 DOWNLOAD Tapo

Get the **Tapo** app from the App Store or Google Play.



STEP 2 SET UP

Tap the ⊕ button in the app. Select **Plugs** and then your model. Follow the step-by-step app instructions to set up your smart plug.

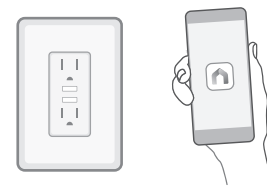

Set Up Your Device via Matter

No longer limited to a specific smart home app.

Integrate your Tapo Matter device into your preferred ecosystem, such as Amazon Alexa, Apple Home, Google Home, and more.

- 1 Turn on Bluetooth on your phone.
- 2 Open the smart home app. Either input the given numeric code on the outlet before securing the wallplate and its connector, or scan the Matter QR code on the label in the package.

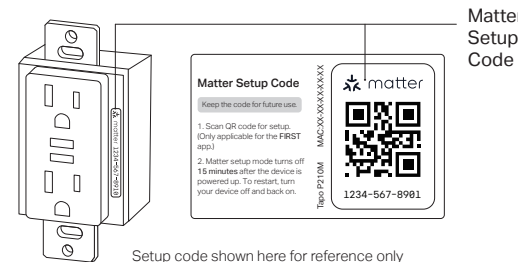

- 3 Follow the instructions in the app to complete setup.

For more details and troubleshooting, please refer to the Matter QIG or visit: <https://www.tp-link.com/support/faq/3520/>

Appearance

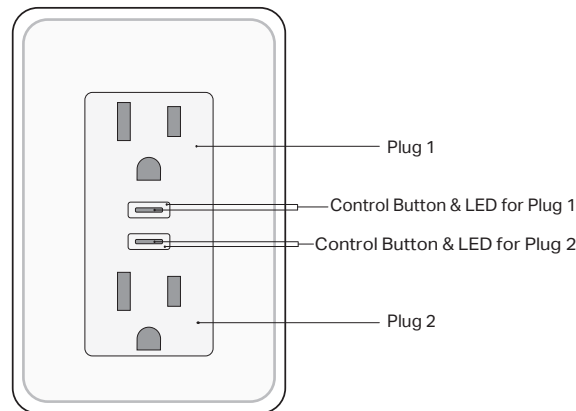

Control Button

- Press the corresponding button:
Turn on/off the plug.
- Press any one of the two buttons for at least **5s**:
Reset Wi-Fi while keeping other settings.
- Press any one of the two buttons for at least **10s**:
Restore factory default settings.

LED Status

Blinking amber & green	Ready for setup; device resetting
Blinking green	Connecting to Wi-Fi
Solid Green	Initializing; working properly
Blinking green slowly	Firmware upgrading
Blinking red	Disconnected from Wi-Fi
Solid amber	Disconnected from cloud

Supported Load Types

Load Type	Max Current	Max Power (at 125V~)
Iron	15 A	1875 W
Kettle	15 A	1875 W
Heater	15 A	1875 W
Toaster	15 A	1500 W
Coffee Maker	15 A	1200 W
Desk Lamp	1.2 A	80 W
TV	4 A	350 W
PC	7 A	600 W
Motor	4.4 A	367 W(1/2HP)
Fan	4.4 A	367 W(1/2HP)
Water Pump	4.4 A	367 W(1/2HP)
Power Adapter/ USB Charger *	2.4 A	200 W

Note:

1. *Power Adapters/USB Chargers rated under 75W do not support PFC (Power Factor Correction). PFC can reduce the inrush current generated when the relay is turned on.
2. Avoid plugging your appliances with a motor/compressor higher than 1/2HP, such as an air conditioner. Frequent on/off switching may damage the compressor. You can check the motor/compressor value listed on your appliances or consult their customer support.
3. EV charging is not supported as it demands higher power and a charging current that surpasses the plug's rated capacity.

CAUTION

High Voltage - Disconnect power supply at the circuit breaker before servicing.

- FOR INDOOR USE ONLY; USE ONLY IN DRY LOCATIONS.
- Timer could turn-on unexpectedly without the user being present. To Reduce the Hazardous Condition – Unplug the appliance from the receptacle before servicing.

MISE EN GARDE

Haute tension: débranchez l'alimentation électrique au niveau du disjoncteur avant l'utiliser.

- POUR UNE UTILISATION EN INTÉRIEUR UNIQUEMENT; UTILISER UNIQUEMENT DANS DES ENDROITS SECS.
- La minuterie pourrait s'allumer de manière inattendue sans la présence de l'utilisateur. Pour réduire les conditions dangereuses – Débranchez l'appareil de la prise avant l'entretien.

Safety Notice

Before installing, servicing or removing the outlet, read and follow all safety precautions including the following:

- CAUTION – Risk of Electric Shock – More than one disconnect switch may be required to de-energize the equipment before servicing. A circuit breaker which disconnects the Line and Neutral conductor simultaneously is suitable. Ensure power is off at the circuit breaker before removing or installing any outlet. Use a non-contact voltage tester to ensure the power is off.
- CAUTION – Risk of Electric Shock - The product should be installed by a qualified electrician.
- The Smart Outlet must be installed and used in accordance with the National Electric Code (NEC) or your local electrical code.
- Do not install the Smart Outlet with wet hands or when standing on wet or damp surfaces.
- Install only in a suitable UL Listed outlet box (suitable dimensions: H > 2.95 in./75 mm, W > 1.81 in./46 mm, D > 3.15 in./80 mm).
- Tighten terminal screws to 13 lbf-in.



Need some help?

Visit <https://www.tapo.com/support/> for technical support, FAQs, warranty & more



Quick Start Guide

Smart Wi-Fi Outlet

©2024 TP-Link 7106511237 REV1.0.0

*Images may differ from your actual product.

This equipment has been tested and found to comply with the limits for a Class B digital device, pursuant to part 15 of the FCC Rules. These limits are designed to provide reasonable protection against harmful interference in a residential installation. This equipment generates, uses and can radiate radio frequency energy and, if not installed and used in accordance with the instructions, may cause harmful interference to radio communications.

However, there is no guarantee that interference will not occur in a particular installation. If this equipment does cause harmful interference to radio or television reception, which can be determined by turning the equipment off and on, the user is encouraged to try to correct the interference by one or more of the following measures:

- Reorient or relocate the receiving antenna.
- Increase the separation between the equipment and receiver.
- Connect the equipment into an outlet on a circuit different from that to which the receiver is connected.
- Consult the dealer or an experienced radio/TV technician for help.

FCC Radiation Exposure Statement

This device complies with FCC radiation exposure limits set forth for an uncontrolled environment and it also complies with Part 15 of the FCC RF Rules.

This equipment must be installed and operated in accordance with provided instructions and the antenna(s) used for this transmitter must be installed to provide a separation distance of at least 20 cm from all persons and must not be co-located or operating in conjunction with any other antenna or transmitter.

End-users and installers must be provided with antenna installation instructions and consider removing the no-collocation statement.

This device complies with Part 15 of the FCC Rules. Operation is subject to the following two conditions:

- (1) this device may not cause harmful interference, and
- (2) this device must accept any interference received, including interference that may cause undesired operation.

Caution!

Any changes or modifications not expressly approved by the party responsible for compliance could void the user's authority to operate the equipment.

We, TP-Link USA Corporation, has determined that the equipment shown as above has been shown to comply with the applicable technical standards, FCC part 15. There is no unauthorized change is made in the equipment and the equipment is properly maintained and operated.

Canadian Compliance Statement

This device contains licence-exempt transmitter(s)/receiver(s) that comply with Innovation, Science and Economic Development Canada's licence-exempt RSS(s). Operation is subject to the following two conditions:

- (1) This device may not cause interference.
- (2) This device must accept any interference, including interference that may cause undesired operation of the device.

L'émetteur/récepteur exempt de licence contenu dans le présent appareil est conforme aux CNR d'Innovation, Sciences et Développement économique Canada applicables aux appareils radio exempts de licence. L'exploitation est autorisée aux deux conditions suivantes :

- 1) L'appareil ne doit pas produire de brouillage;
- 2) L'appareil doit accepter tout brouillage radioélectrique subi, même si le brouillage est susceptible d'en compromettre le fonctionnement.

Radiation Exposure Statement:

This equipment complies with IC radiation exposure limits set forth for an uncontrolled environment. This equipment should be installed and operated with minimum distance 20cm between the radiator & your body.

Déclaration d'exposition aux radiations:

Cet équipement est conforme aux limites d'exposition aux rayonnements IC établies pour un environnement non contrôlé. Cet équipement doit être installé et utilisé avec un minimum de 20 cm de distance entre la source de rayonnement et votre corps.

Industry Canada Statement

CAN ICES-3 (B)/NMB-3(B)