

Travel Power Bank

PS-B009WALR

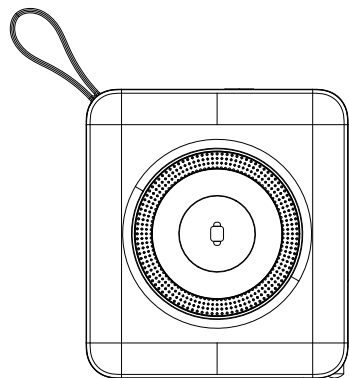

User Manual

Product Diagram

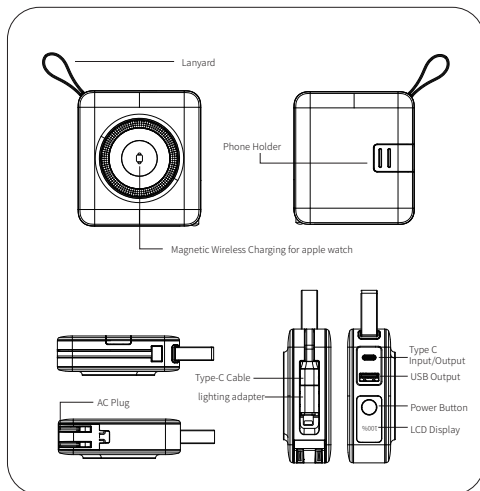

Product Parameter

Model: PS-B009WA	Material: ABS+PC Fireproof
Capacity: 10000mAh@3.7V 37Wh	AC Input: 100~240V AC 50Hz/60Hz 0.3A(Max)
Type-C Input: DCSV-12V PD18W Max	Type-C Output: DC 5V-12V PD 20W Max
Type-C Cable Output: DC 5V-12V PD 20W Max	lighting adaptor output: DC 5V~2.4A, 9V~2.0A
USB Output: DC 5V/3A, 9V/2A, 12V/1.5A 18W Max	Wireless Output: 15W (2.5W Max for apple watch)
Size: 89mm X 98mm X 31.5mm	Adaptor Mode Output: 10W Max

WHAT' S INCLUDED

1 x Multi-function Power Bank

Optional Accessories

- 1 x AU Adapter Plug
- 1 x EU Adapter Plug
- 1 x UK Adapter Plug
- 1 x UL Adapter Plug
- 1 x IN Adapter Plug
- 1 x KC Adapter Plug

User Guide



Wall Charger



Phone Holder



adapters



Wireless Charger

CHARGING & RECHARGING

Using the Power Bank

Please select your charging method from below and connect to a device.

1. Built-in Cables
2. USB-A Port
3. Type-C Port

Using the Wall Charger

1. Pull out the Prongs and connect to a wall outlet.
2. Plug a cable into the the USB or Type-C charging port and into a device.

Checking the Battery Level

1. Quick press the power button and the current percentage level will display on the digital screen.
2. Double Click the power button or in standby for about 30 seconds, the display and power will be turned off automatically.

Recharging the Multi-function Power Bank

There are two ways to charge the internal battery:

1. Use the Wall Plug & and an AC Outlet
2. Use the Type-C to USB Cable and a Power Adapter.

WARNING

- The power bank is NOT a toy and should be kept away from children.
- Please do NOT use the power bank in direct sunlight or extreme heat for extended periods of time.
- Please do NOT submerge the power bank in water.
- Please do NOT leave the power bank near the fire.
- Please do NOT subject the power bank to harsh chemicals.
- Please do NOT use the power bank if it has been damaged and/or modified.
- Please do NOT insert any foreign objects into the openings or port of the power bank.
- Please do NOT attempt to disassemble, repair, or open the power bank in any way.

FCC Warning Statement

Changes or modifications not expressly approved by the party responsible for compliance could void the user's authority to operate the equipment. This equipment has been tested and found to comply with the limits for a Class B digital device, pursuant to Part 15 of the FCC Rules. These limits are designed to provide reasonable protection against harmful interference in a residential installation. This equipment generates uses and can radiate radio frequency energy and, if not installed and used in accordance with the instructions, may cause harmful interference to radio communications. However, there is no guarantee that interference will not occur in a particular installation. If this equipment does cause harmful interference to radio or television reception, which can be determined by turning the equipment off and on, the user is encouraged to try to correct the interference by one or more of the following measures:

- - Reorient or relocate the receiving antenna.
- - Increase the separation between the equipment and receiver.
- - Connect the equipment into an outlet on a circuit different from that to which the receiver is connected.
- - Consult the dealer or an experienced radio/TV technician for help.

FCC Radiation Exposure Statement

The device has been evaluated to meet general RF exposure requirement. The device can be used in portable exposure condition without restriction.

This device complies with Part 15 of the FCC Rules. Operation is subject to the following two conditions:

- (1) This device may not cause harmful interference, and
- (2) This device must accept any interference received, including interference that may cause undesired operation.