

POWER BANK 10000mAh TRAVEL CHARGER

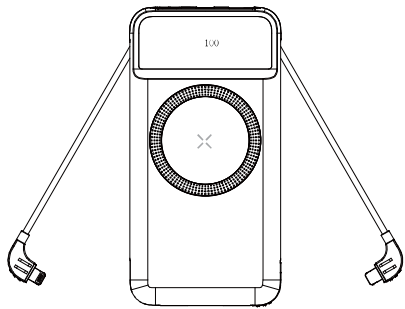

User Manual

Product Diagram

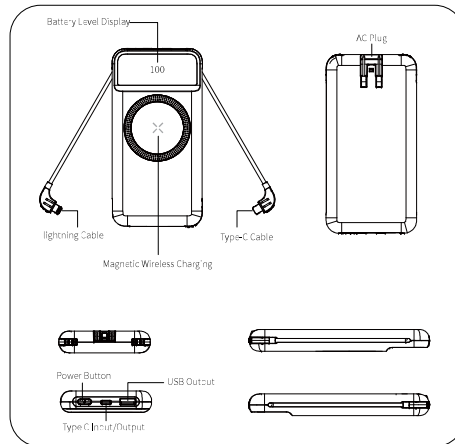

Product Parameter

Model: PS-8005WA	Material: Fireproof ABS+PC
Capacity: 10000mAh (3.85V 38.5Wh)	Alt. Input: 110~240V AC 50/60Hz (0.3A Max)
Type-C Input: 5V~3A, 9V~2A, 12V~1.5A 18W Max	Type-C Output: 5V~3A, 9V~2.22A, 12V~1.67A P2 20W Max
Adapter Mode Output: 5V~3A 15W Max	USB Output: 5V~3A, 9V~2A, 12V~1.5A 18W Max
Wireless Output: 5W/7.5W/10W/15W Max	Type-C Cable Output: 5V~3A, 9V~2.22A, 12V~1.67A P2 20W Max
Size: 151 x 76 x 18mm	Lightning Cable Output: 5V~3A Max
Total Sharing Output: 5V~3A 15W Max	

WHAT'S INCLUDED

1 x Power Bank Travel Charger

Optional Accessories

- 1 x AU Adapter Plug
- 1 x EU Adapter Plug
- 1 x UK Adapter Plug

User Guide



Wall Charger



Battery Level Display



Power Bank



Magnetic Wireless Charger

CHARGING & RECHARGING

Using the Power Bank

Please use the below charging methods. You are able to charge multiple devices simultaneously.

1. Built-in Cables
2. USB-A Port
3. Type-C Port
4. Wireless Charger

Using as a pass-through Wall Charger

1. Pull out the Prongs (or connect an Adapter Plug). There should be a click when inserted fully.
2. Connect to a wall outlet.
3. Plug a cable into the USB-A or Type-C charging port and into your device.
4. You can also use the Magnetic Wireless Charger whilst connected to a wall outlet.

Checking the Battery Level

1. Quick press the power button and the current percentage level will display on the digital screen.
2. Double Click the power button or in standby for about 30 seconds, the display and power will be turned off automatically.

Recharging the Power Bank Travel Charger

There are two ways to charge the internal battery:

1. Use the Wall Plug & and an AC Outlet
2. Use the Type-C to USB Cable and a Power Adapter.

WARNING

- The power bank is NOT a toy and should be kept away from children.
- Please do NOT use the power bank in direct sunlight or extreme heat for extended periods of time.
- Please do NOT submerge the power bank in water.
- Please do NOT leave the power bank near the fire.
- Please do NOT subject the power bank to harsh chemicals.
- Please do NOT use the power bank if it has been damaged and/or modified.
- Please do NOT insert any foreign objects into the openings or port of the power bank.
- Please do NOT attempt to disassemble, repair, or open the power bank in any way.

FCC Warning:

This equipment has been tested and found to comply with the limits for a Class B digital device, pursuant to part 15 of the FCC Rules. These limits are designed to provide reasonable protection against harmful interference in a residential installation. This equipment generates, uses and can radiate radio frequency energy and, if not installed and used in accordance with the instructions, may cause harmful interference to radio communications. However, there is no guarantee that interference will not occur in a particular installation. If this equipment does cause harmful interference to radio or television reception, which can be determined by turning the equipment off and on, the user is encouraged to try to correct the interference by one or more of the following measures:

- Reorient or relocate the receiving antenna.
- Increase the separation between the equipment and receiver.
- Connect the equipment into an outlet on a circuit different from that to which the receiver is connected.
- Consult the dealer or an experienced radio/TV technician for help.

Caution: Any changes or modifications to this device not explicitly approved by manufacturer could void your authority to operate this equipment.

This device complies with part 15 of the FCC Rules. Operation is subject to the following two conditions: (1) This device may not cause harmful interference, and (2) this device must accept any interference received, including interference that may cause undesired operation.

The device has been evaluated to meet general RF exposure requirement.