

Setup Guide

Wireless 2-Camera & Hub Kit P1

At a glance



Smart Battery Cam *2
SS 113



Ceiling bracket - 1



Screws
($\phi 2.0 \times 4.0 \text{ mm}$) - 3



Drywall anchors
($\phi 4.0 \times 25.0 \text{ mm}$) - 3

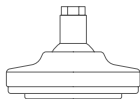

Mounting bracket - 1



Anchor plate - 1



USB-C
charging cable - 1



Smart Hub*1
SS011

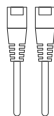

Ethernet network cable - 1

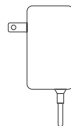

Power adapter - 1

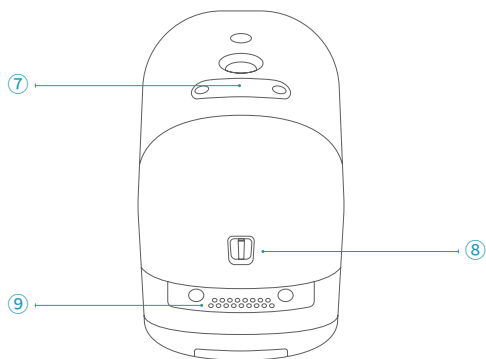
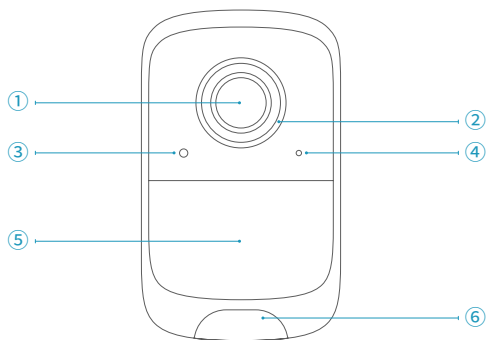

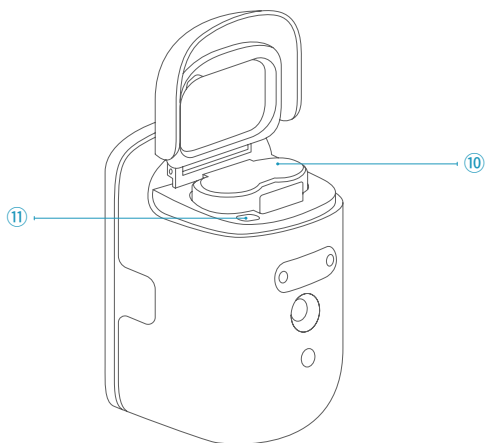

- ① Camera lens
- ② LED indicator
- ③ Light sensor
- ④ Microphone
- ⑤ Motion sensor
- ⑥ Spotlight
- ⑦ USB-C charging port
- ⑧ Battery latch
- ⑨ Speakers
- ⑩ Removable & rechargeable battery
- ⑪ ⏻ SYNC

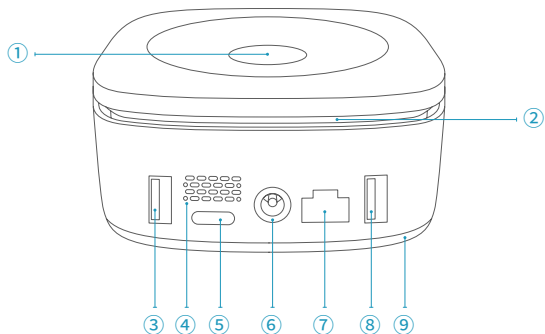

- ① Mode switch/alarm off button
- ② LED indicator
- ③ USB 2.0 port 1
- ④ Speaker
- ⑤ On/off & sync button
- ⑥ Power port
- ⑦ Ethernet port
- ⑧ USB 3.0 port 2
- ⑨ SSD insert slot

Expand storage space*

*Additional hard drive sold separately

Before installing or removing the hard drive:

Confirm that the hub is powered "Off."

Step 1: Prepare the hard drive

Supported SSD sizes: M.2 2242, M.2 2260, M.2 2280

Supported SSD type: M.2 NVMe SSD (M Key or B+M)

Step 2: Install the hard drive

Remove the bottom screws from the hub to open the SSD insert slot.

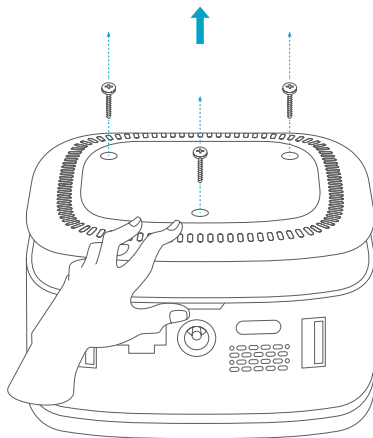

Install the SSD according to the specifications shown above hub's SSD insert slot.

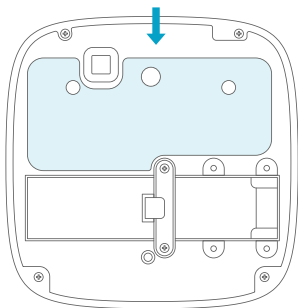

Set up the hub

Step 1:

Connect the power adapter and Ethernet cable to the hub. Then, turn on the hub. The LED indicator will turn blue when the hub is ready for setup.

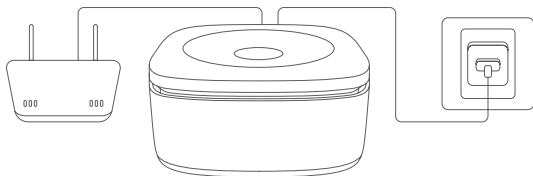

Step 2:

Download and install the Safemo App, and then create an account.



Step 3:

Follow on-screen instructions to add the hub and the camera(s) to your list.

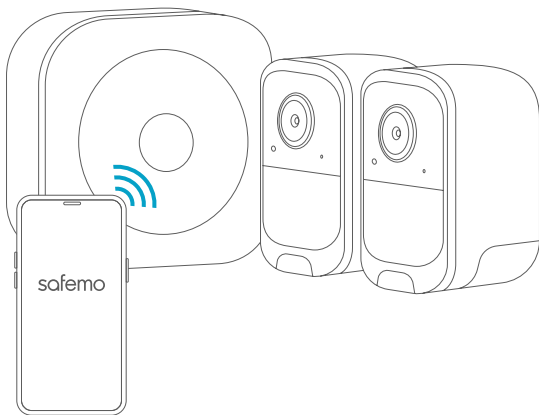

Charge the camera

Step 1: Remove the insulation sheet

Open the bottom cover of the battery compartment as directed by the instructions, press and remove the metal sheet, remove the battery insulation sheet, and let the battery power on.

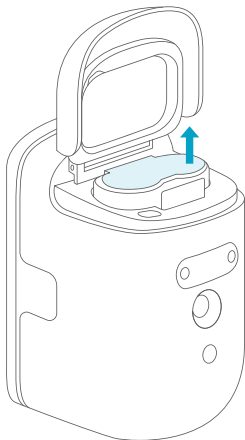

Step 2: Fully charge the camera for its first use

Option 1: Charge the battery directly by plugging it into a power source with the provided USB cable.

Option 1

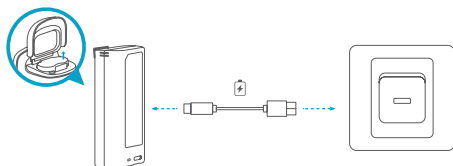

Option 2: Charge the battery by plugging the camera (with the battery inside) into the hub.

Option 2

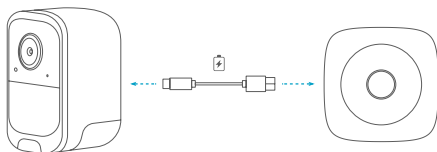

Option 3: Charge the camera with the battery inside by plugging it into a power source with a 5V/1A (2A) wall charger*.

Option 3

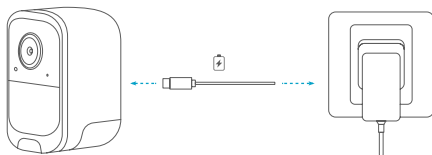

*To be purchased separately from any electronics retailer

Mount the camera

Step 1: Choose the area where you wish to record

We recommend hanging the camera 7-10 ft (2-3 m) above the ground to capture the desired camera angle.

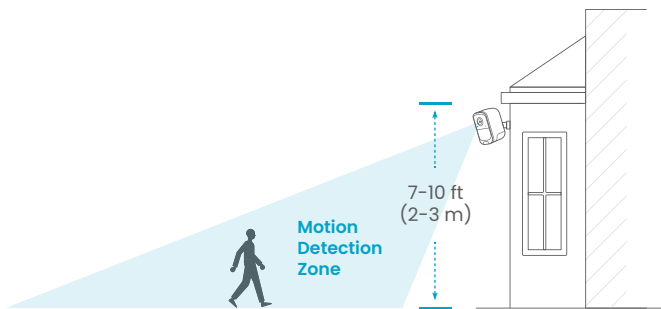

Step 2: Mount the anchor plate

i. Drill holes with a 15/64-inch (6 mm) drill bit in the place where you want the base.

ii. Insert the drywall anchors into the holes if necessary.

*Drywall anchors are necessary for walls made out of concrete, brick, or stucco, etc.

iii. Affix the anchor plate to the wall.

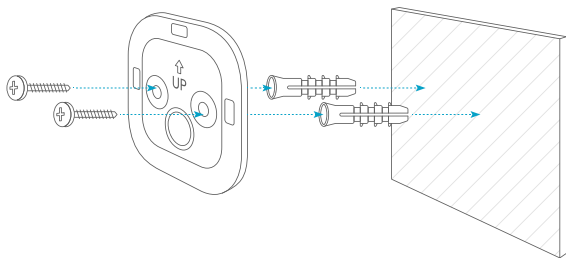

Step 3: Mount the camera at the desired area

Wall

i. Tighten the screws at the bottom of the mounting bracket to secure it to the camera.

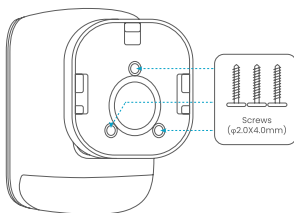

ii. Fasten the camera to the anchor plate.

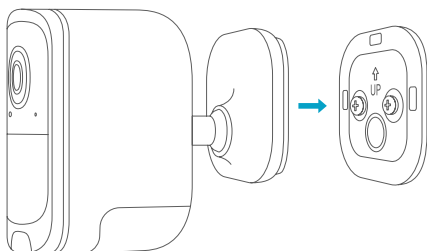

iii. Adjust to the appropriate angle for monitoring.

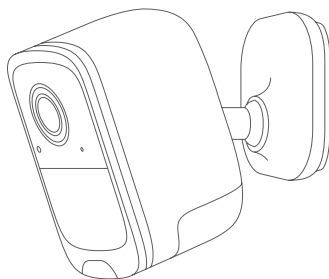

Desk

i. Tighten the screws at the bottom of the mounting bracket to secure it to the ceiling bracket.

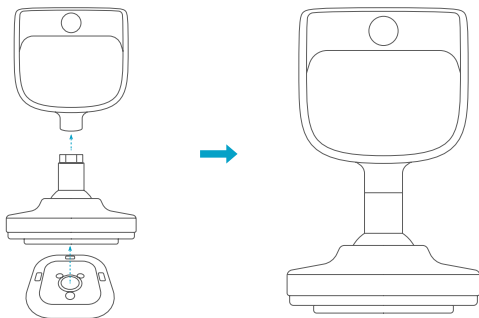

ii. Fasten the camera to the ceiling bracket in the upright position.

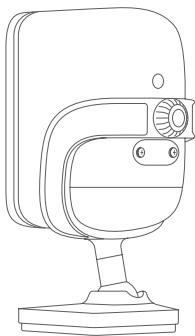

iii. Adjust to the appropriate angle for monitoring.

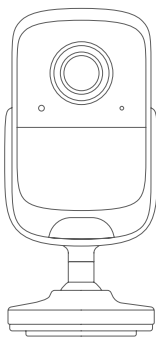

Ceiling

i. Tighten the screws at the bottom of the mounting bracket to secure it to the ceiling bracket.

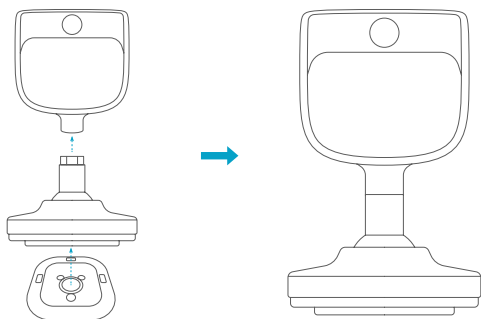

ii. Fasten the camera to the ceiling bracket in the downward position, where the camera lens is positioned near the base of the ceiling bracket.



iii. Adjust to the appropriate angle for monitoring.

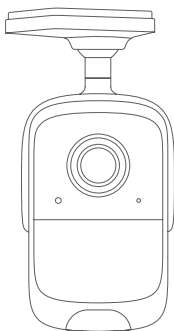

Safety

- Do not use the device in extreme temperatures, and never expose the device to strong sunshine or a humid, wet environment.
- The suitable temperature for SS011 and its accessories is -10°C / 14°F to 45°C / 113°F .
- The suitable temperature for SS113 and its accessories is -20°C / -4°F to 50°C / 122°F (The temperature for charging is 0°C / 32°F to 45°C / 113°F).
- The best environment is a temperature range from 5°C / 41°F ~ 25°C / 77°F .
- When charging, please place the device(s) at room temperature in a place with good ventilation.
- The adapter should be installed near the equipment and be easily accessible for best use.
- Only use the adapter supplied by the manufacturer. Using unauthorized adapters may cause danger and will violate the device authorization and void its guarantee.
- This adapter is for indoor use only. The adapter type for SS011 hub's rated output voltage/current is 12 V DC/2A. The plug is considered a disconnected device from the adapter. (The camera's rated output voltage/current is 5V/DC 1.5A)

Warning

- Replacing the battery with an incorrect version can destroy the safety mechanisms within the device.
- Inappropriate battery disposal--for example, into a fire or a hot oven, or mechanically crushing or cutting the battery--can result in an explosion.
- Leaving a battery in a very high-temperature environment can result in an explosion or the leakage of flammable liquid or gas.
- A battery subjected to extremely low air pressure may result in an explosion or the leakage of flammable liquid or gas.

Attention

- Remplacement d'une batterie par un type incorrect pouvant supprimer une protection
- Mise au rebut d'une batterie dans un feu ou dans un four chaud, ou écrasement mécanique ou coupure d'une batterie, susceptible de provoquer une explosion;
- Maintien d'une batterie dans un environnement à très haute température pouvant provoquer une explosion ou la fuite de liquide ou de gaz inflammables; et
- Batterie soumise à une pression de l'air extrêmement faible pouvant provoquer une explosion ou la fuite de liquide ou de gaz inflammables.



CAUTION: RISK OF EXPLOSION IF BATTERY IS REPLACED BY AN INCORRECT MODEL. DISPOSE OF USED BATTERIES ACCORDING TO THE INSTRUCTIONS.



ATTENTION RISQUE D'EXPLOSION SI LA BATTERIE EST REMPLACÉE PAR UN TYPE INCORRECT. ÉLIMINER LES BATTERIES USÉES SELON LES INSTRUCTIONS.

Notice

FCC Statement

This device complies with Part 15 of the FCC Rules. Operation is subject to the following two conditions:

- (1) this device may not cause harmful interference;
- (2) this device must accept any interference received, including interference that may cause undesired operation.

Warning: Changes or modifications not expressly approved by the party responsible for compliance could void the user's authority to operate the equipment.

Note: This equipment has been tested and found to comply with the limits for a Class B digital device, pursuant to Part 15 of the FCC Rules. These limits are designed to provide reasonable protection against harmful interference in a residential installation.

FCC Radio Frequency Exposure Statement

The device has been evaluated to meet general RF exposure requirements. The device can be used in fixed/mobile exposure conditions. The min separation distance is 20 cm.

Notice: Shielded cables

This equipment generates,uses and can radiate radio frequency energy and,if not installed and used in accordance with the instructions,may cause harmful interference to radio communications.

However, there is no guarantee that interference will not occur in a particular installation. If this equipment does cause harmful interference to radio or television reception, which can be determined by turning the equipment off and on, the user is encouraged to try to correct the interference by one or more of the following measures:

- (1) Reorient or relocate the receiving antenna.
- (2) Increase the separation between the equipment and receiver.
- (3) Connect the equipment into an outlet on a circuit different from that to which the receiver is connected.
- (4) Consult the dealer or an experienced radio/ TV technician for help.

All connections to other computing devices must be made using shielded cables to maintain compliance with FCC regulations.

IC Statement

This device complies with Industry Canada Licence-exempt RSS standard(s). Operation is subject to the following two conditions:

- (1) this device may not cause interference, and
- (2) this device must accept any interference, including interference that may cause undesired operation of the device.

Le présent appareil est conforme aux CNR d'Industrie Canada applicables aux appareils radio exempts de licence. L'exploitation est autorisée aux deux conditions suivantes:

- (1)l'appareil nedoit pas produire de brouillage, et

(2) l'utilisateur de l'appareil doit accepter tout brouillage radioélectrique subi, même si le brouillage est susceptible d'en compromettre le fonctionnement.

This Class B digital apparatus complies with Canadian ICES-003.

Cet appareil numérique de la classe B est conforme à la norme NMB-003 du Canada.

IC RF Statement

When using the product, maintain a distance of 20cm from the body to ensure compliance with RF exposure requirements.

Lors de l'utilisation du produit, maintenez une distance de 20 cm du corps afin de vous conformer aux exigences en matière d'exposition RF

EU Statement



This product complies with the radio interference requirements of the European Community. Hereby, Safemo Pte. Ltd. declares that this device is in compliance with the essential requirements and other relevant provisions of Directive 2014/53/EU. For the declaration of conformity, visit the Web site: <https://www.safemo.com>
This product can be used across EU member states.

RF exposure information

The Maximum Permissible Exposure (MPE) level has been calculated based on a distance of $d=20$ cm between the device and the human body. To maintain compliance with RF exposure requirement, use product that maintain a 20cm distance between the device and human body.

SS011 Wi-Fi Operating Frequency Range: 2412~2472 MHz (2.4G), Wi-Fi Max Output Power: 20 dBm (EIRP);

SS011 Bluetooth Operating Frequency Range: 2402~2480 MHz; Bluetooth Max Output Power: 8 dBm (EIRP);

SS113 Wi-Fi Operating Frequency Range: 2412~2472 MHz (2.4G), Wi-Fi Max Output Power: 20 dBm (EIRP);

SS113 Bluetooth Operating Frequency Range: 2402~2480 MHz; Bluetooth Max Output Power: 8 dBm (EIRP);



This product is designed and manufactured with high quality materials and components, which can be recycled and reused.



This symbol means the product must not be discarded as household waste, and should be delivered to an appropriate collection facility for recycling. Proper disposal and recycling helps protect natural resources, human health and the environment. For more information on disposal and recycling of this product, contact your local municipality, disposal service, or the shop where you bought this product.

UK Statement



This product complies with the radio interference requirements of the United Kingdom Declaration of Conformity.

Hereby, Safemo Pte. Ltd. declares that this product is in compliance with Radio Equipment Regulations 2017. The full text of the UK declaration of conformity is available at the following internet address: <https://www.safemo.com>



For more information, please visit our website:

www.safemo.com



If you have any queries, feel free to contact us:

support@safemo.com

