

尺寸: 68x98MM
材质: 铜板纸

MT02

WIRELESS HANDSFREE CAR KIT

With FM Transmitter
and QC3.0+PD20W Fast charging



» User Guide

Friendly Tips:

After receiving the product, do not hurry to insert the product into the cigarette light hole of the car. After starting your car, firstly an idle FM channel with no local radio station program patiently on the car radio, and the standard is a slight rustling sound. Then insert the product into the cigarette hole, and adjust same FM frequency of the product as the FM frequency of the car. At this time, the car radio will be very quiet and there is no static interference. (If it's still not quiet, try to find new ones again. The free channel), and finally connect your phone with the product via wireless. When they are pairing successfully, you can enjoy the song from your phone.

Federal Communications Commission (FCC) Statement.
This device complies with part 15 of the FCC Rules.
Operation is subject to the following two conditions:
(1) This device may not cause harmful interference, and
(2) this device must accept any interference received, including interference that may cause undesired operation.
Note: This equipment has been tested and found to comply with the limits for a Class B digital device, pursuant to part 15 of the FCC Rules. These limits are designed to provide reasonable protection against harmful interference in a residential installation. This equipment generates, uses and can radiate radio frequency energy and, if not installed and used in accordance with the instructions, may cause harmful interference to radio communications. However, there is no guarantee that interference will not occur in a particular installation. If this equipment does cause harmful interference to radio or television reception, which can be determined by turning the equipment off and on, the user is encouraged to try to correct the interference by one or more of the following measures:
•Reorient or relocate the receiving antenna.
•increase the separation between the equipment and receiver.
•Connect the equipment into an outlet on a circuit different from that to which the receiver is connected.
•Consult the dealer or an experienced radio/TV technician for help.
Warning: Changes or modifications made to this device not expressly approved by Shenzhen James Audio Technology Co., Ltd. may void the FCC authorization to operate this device.
Note: The manufacturer is not responsible for any radio or TV interference caused by unauthorized modifications to this equipment. Such modifications could void the user's authority to operate the equipment.
RF exposure statement:
This device complies with FCC RF radiation exposure limits set forth for an uncontrolled environment. The device is installed and operated without restriction.

This Wireless car FM transmitter allows you to transmit music and calls directly from your Wireless device to your car FM audio system. The built-in Wireless V5.3 provides hands-free call function and music transmission. It also has two fast charging port (QC3.0 +PD 20W), which will greatly save time charging your phone. Please read the user manual carefully before use. Hope this device will make your driving more fun and safer.

Package contents:

- FM transmitter*1
- Instruction manual*1
- Air outlet bracket*1
- 3.5MM audio cable*1
- 4A fuse*1

Specifications:

Model	MT02
Wireless Version	V5.3
Wireless Connection Distance	10M (MAX)
Frequency range	88.1-107.9MHz&2400-2483.5MHz
FM transmission distance	about 3M
In put	DC12-24V
Type-C Output	PD20W(5V~3A, 9V~2.22A, 12V~1.67A)
USB Output	QC3.0(5V~3A, 9V~2A, 12V~1.5A)
"U" U disk port output	5V~1A
USB: (Max capacity)	64G
Music format	MP3,WMA,WAV
Total power	43W(Max.)

Product Overview:

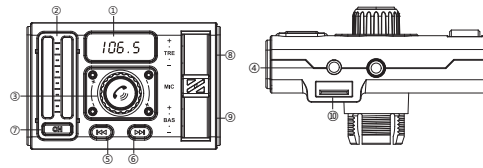

1. FM Channel Display
2. Color lighting
3. Multi-function button:
 - ① Short press: answer/hang up, play/pause
 - ② long press: Activate siri&google
 - ③ Press twice: Call back the last answered call
 - ④ Rotate Left: volume - (In frequency modulation mode, FM frequency-)
 - ⑤ Rotate right: volume + (In frequency modulation mode, FM frequency+)
4. AUX(line out)
5. Short press: Previous song
long press: Turn lights on/off
6. Short press: Next song
long press: U disk and Bluetooth song switching
7. Short press: FM frequency
long press: Power on/off
8. Treble EQ
Scroll up: Treble EQ Enhancement
Scroll Down: Treble EQ weakening
9. BASS EQ
Scroll up: BASS EQ Enhancement
Scroll Down: BASS EQ weakening
10. ①.USB flash drive socket
②.5V/1A Charger

How to use: FM Transmitter Radio

1. Tune your car radio to a clean, empty channel with no programming.

Tips
What is a blank channel?
- A blank channel with no programming will only make a slight rustle or snow sound on your car radio.



2. Plug the FM transmitter into the cigarette lighter or power port. It will be automatically powered on with the LED displaying the vehicle's battery voltage, FM frequency, then showing the word "bt".

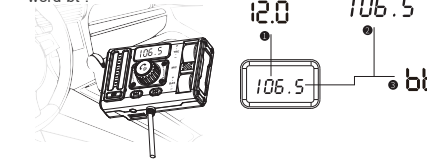

3. Click or hold the "CH-" or "CH+" key to adjust the frequency up and down to adjust the frequency of the unit to the same as the car radio

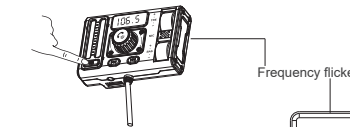

Click or hold to adjust the frequency

Wireless Pairing:

1. When the LED display shows "bt" and the device will enter into Wireless pairing mode.
2. Enable Wireless on the device you want to pair.
3. Search and select ID "MT02" from the list, then connect.
4. If asked enter the pairing code '0000' or '1234'.

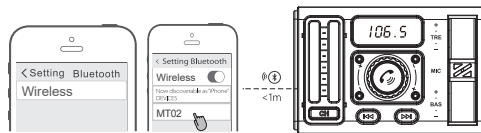

Wireless Calling:

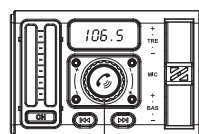

- Short press: Answer
- Short press: Hang up
- Long press1: Reject call
- Long press1: Handset/Hands-free

Playing and Controlling the Music:

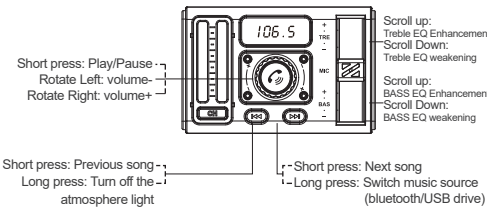

Note: Bass and treble EQ adjustment effect is very strong, it is recommended to work together to adjust to the best state, adjusted to the highest alone, easy to affect the sense of listening

Playing and Controlling the Music:

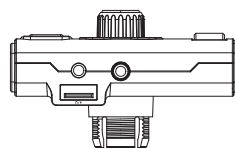

Support format: FAT32 format USB flash drive that has not been used as a computer boot disk
Supported capacity: up to 64G

Special function reminder

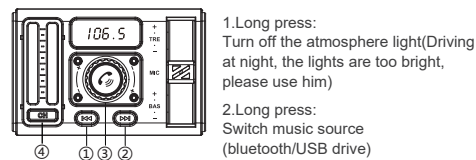

3. Long press: Activate siri&google

4. Long press: Turn on/off the power, turn off Bluetooth/transmission/display, and only keep the charging function (No depletion of car battery power)

Note:

In the music playing mode, when there is an incoming call, it will automatically switch to telephone mode and play the phone number in English.

If the volume was set below 22 at the last use, the next time you use the transmitter it will default to 24. If it was between 23 and 30 the last time it was used, it will be kept at the same level the next time it is turned on.

USB charger

USB socket with music logo, supports up to 64GB FAT format U disk for music playback, and supports 5VIA current output for charging.
The socket marked PD20W on the type-c and QC3.0 on the USB port is a fast charging socket that supports PD (20W)+QC3.0 protocol

Music playback source selection

1. When connected to Wireless, open the phone music player click play to play Wireless music.
2. This machine default insert audio source priority play, if you need to play U disk music, please insert the U disk into the "U" port of this machine, the screen shows the word usb will automatically play the music in the U disk.

Tips. U disk music does not support playing music in folders, please do not store the songs in folders by category.

Cautions:

1. When the car's battery voltage is less than 12V, the LED display will flash to remind you to charge the car battery.
2. The transmitter will connect to the pre-set phone automatically when turning it on. (Keep Wireless function activate).
3. Hang up via the phone if answering with the handset.
4. Please do not use the transmitter in severe high temperatures, humidity, dusty or corrosive environments.
5. Please remove the product from the cigarette lighter when not in use for a long time.
6. Never disassemble the product without due permission, otherwise the warranty will be invalid.