

# User's Manual

## wireless charging car phone holder

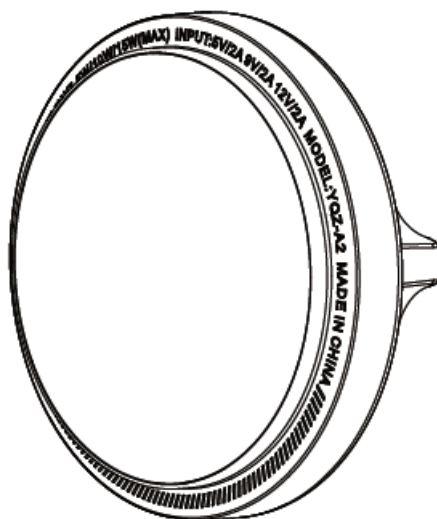

Model: A3

Thank you for choosing this product,  
Read the instructions carefully before using!

## Parameter Specification

input: DC 12V/1.5A, 9V/1.67A/5V/2A

output: 15W/10W/7.5W/5W

Product standard: Qi

Charging distance:  $\leq 8\text{MM}$

Product dimensions: 67\*38\*67mm

Product Material: ABS+Mag

(QC2.0 is required for fast charging mode/QC3.0 or 18W and above adapters)

## Indicating status and protection functions

Standby mode: LED light is always on. Press the touch area to switch 1 RGB mixed color + red, orange, yellow Green, green, blue and purple 7 colors.

Charging mode: LED is off, remove the receiver and enter standby mode.

Product size: 71\*30.5\*71mm.

FOD Automated Foreign Body Detection: Intelligent recognition of foreign bodies, such as hard objects, keys and other metal or magnetic objects

All-round protection: temperature, short circuit, over voltage over current.

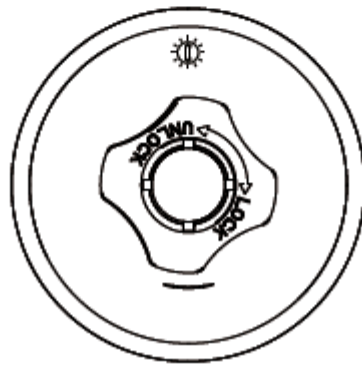

Touch button area with switchable colors

## Requirements

1. For models above IPHONE12, the magnetic car mount can be used directly in the state of bare metal without a shell. It can realize the function of magnetic fast charging and car bracket navigation [If you need to use it with a case, you need to be equipped with a magnetic mobile phone case with built-in magnetic attracting sheet function]
2. Other brands of mobile phones with wireless charging function need to wear magnetic coils, use this magnetic bracket [All mobile phones with wireless charging function can realize magnetic fast charging + mobile phone bracket and navigation]
3. Wear a magnetic coil on a mobile phone without a wireless charging function, and use this magnetic car mount [All mobile phones without wireless charging function can realize magnetic suction bracket and car navigation]
4. When pasting the magnetic guide sheet, it should be stuck in the center of the mobile phone, please use the positioning sticker scale to measure [Measurement method of the positioning sticker: The size indications of the surrounding scales are the same. At this time, the center circle of the positioning sticker is the mobile phone. Center position]

FCC warning statements:

This equipment has been tested and found to comply with the limits for a Class

B digital device, pursuant to part 15 of the FCC Rules. These limits are designed to provide reasonable protection against harmful interference in a residential installation. This equipment generates, uses and can radiate radio frequency energy and, if not installed and used in accordance with the instructions, may cause harmful interference to radio communications. However, there is no guarantee that interference will not occur in a particular installation. If this equipment does cause harmful interference to radio or television reception, which can be determined by turning the equipment off and

on, the user is encouraged to try to correct the interference by one or more of the following measures:

- Reorient or relocate the receiving antenna.

- Increase the separation between the equipment and receiver.

- Connect the equipment into an outlet on a circuit different from that to which the receiver is connected.

- Consult the dealer or an experienced radio/TV technician for help.

Caution: Any changes or modifications to this device not explicitly approved by manufacturer could void your authority to operate this equipment.

This device complies with part 15 of the FCC Rules. Operation is subject to the following two conditions: (1) This device may not cause harmful interference, and (2) this device must accept any interference received, including interference that may cause undesired operation.

#### FCC Radiation Exposure Statement

This equipment must be installed and operated in accordance with provided instructions and the antenna(s) used for this transmitter must be installed to provide a separation distance of at least 20 cm from all persons and must not be co-located or operating in conjunction with any other antenna or transmitter. End-users and installers must be provided with antenna installation instructions and transmitter operating conditions for satisfying RF exposure

### Indication of product parts

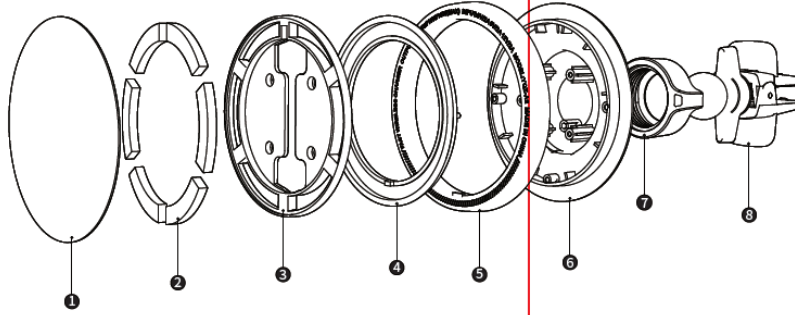

### Parts List

1	Face cover
2	Magnet
3	Plastic cement
4	Wireless charge-launch coil
5	Transparent parts
6	Zinc alloy housing
7	Stand angle adjustment knob
8	Air vent clip

### Attention

1. Do not squeeze or collide heavily.
2. Do not disassemble or put into fire by yourself when the power is on, in water, to avoid short circuit leakage.
3. Do not use in severe high temperature, humidity or corrosive environment to avoid damaging the circuit Leakage occurred
4. Do not charge magnetic cards (ID cards, bank cards, etc.) with magnetic strips or chips On the board, avoid magnetic card failure.
5. Do not place metal (metal objects such as coins) on the charging plate while charging, as this will prevent Cause heat damage

5V2A adapter for normal mode charging (5W output)

9V1. 67A adapter for Apple mobile phone fast charging mode (7.5W output)

9V1. 67A for Samsung mobile phone fast charging mode (10W output)

12V1. 5A adapter for 15W power fast charge mode charging (15W output)

Note: This product is applicable to all Qi standard mobile phones with wireless charging function. Other mobile phones need additional receivers.