

Installation Steps

- Before attempting to use the LED light bar please make sure that there is no dust, oil or fingerprints on the surface you are installing onto. For best results, use the included alcohol-based cleaning cloth to wipe the surface before attaching.

①

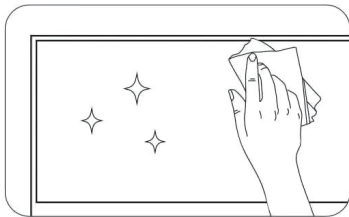

Wipe the surface to make sure it's clean and dry. Our RGB Strips are best suited for flat, smooth and non-porous surfaces.

②

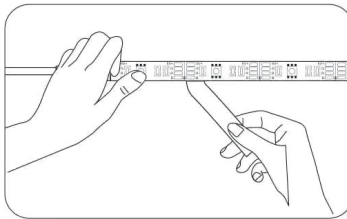

Peel off the protective film on the tape, place the strip on desired surface and press down firmly.

③

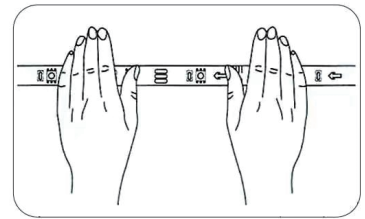

Stick the strip light and press down for about 10-15s to ensure contact.

④

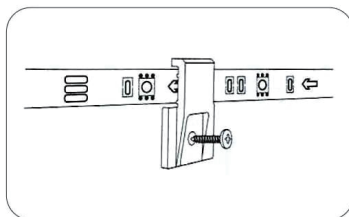

Reinforce via clips and screws provided.

⑤

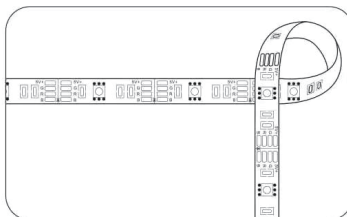

For corners, gently bend the strip over itself as shown above.

⑥

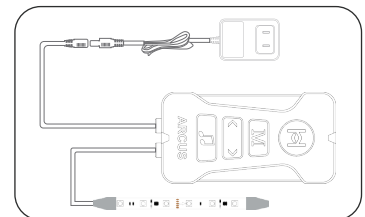

Connect the 12V Controller to the AC Adapter and your RGB Strips to complete installation.

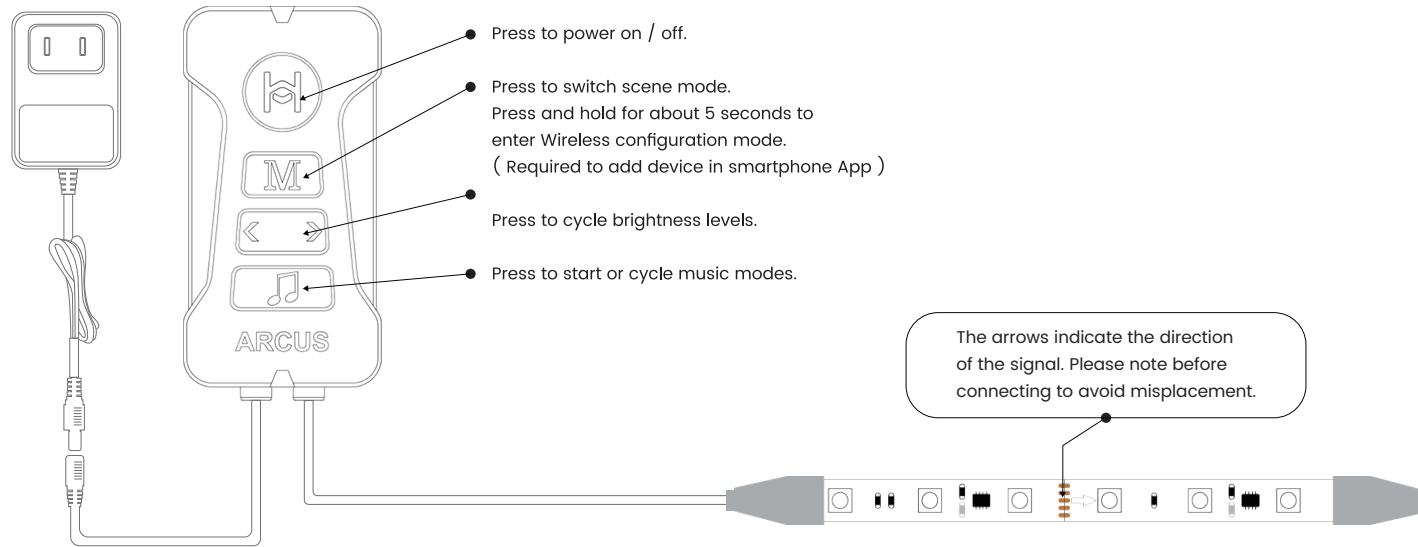

Scan & Download APP to control

Installation Steps

- Before attempting to use the LED light bar please make sure that there is no dust, oil or fingerprints on the surface you are installing onto. For best results, use the included alcohol-based cleaning cloth to wipe the surface before attaching.

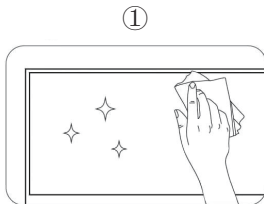

1 Wipe the surface to make sure it's clean and dry. Our RGB Strips are best suited for flat, smooth and non-porous surfaces.

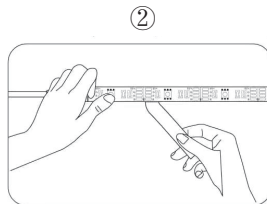

2 Peel off the protective film on the tape, place the strip on desired surface and press down firmly.

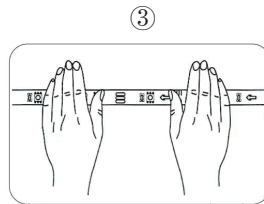

3 Stick the strip light and press down for about 10-15s to ensure contact.

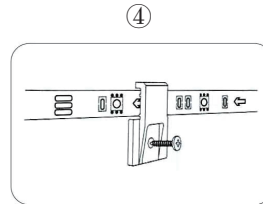

4 Reinforce via clips and screws provided.

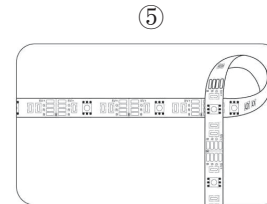

5 For corners, gently bend the strip over itself as shown above.

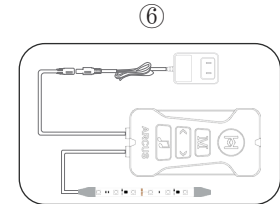

6 Connect the 12V Controller to the AC Adapter and your RGB Strips to complete installation.

This device complies with Part 15 of the FCC Rules. Operation is subject to the following two conditions: (1) this device may not cause harmful interference, and (2) this device must accept any interference received, including interference that may cause undesired operation

NOTE: This equipment has been tested and found to comply with the limits for a Class B digital device, pursuant to Part 15 of the FCC Rules. These limits are designed to provide reasonable protection against harmful interference in a residential installation. This equipment generates, uses and can radiate radio frequency energy and, if not installed and used in accordance with the instructions, may cause harmful interference to radio communications. However, there is no guarantee that interference will not occur in a particular installation.

If this equipment does cause harmful interference to radio or television reception, which can be determined by turning the equipment off and on, the user is encouraged to try to correct the interference by one or more of the following measures:

- Reorient or relocate the receiving antenna.
- Increase the separation between the equipment and receiver.
- Connect the equipment into an outlet on a circuit different from that to which the receiver is connected.
- Consult the dealer or an experienced radio/TV technician for help.

Warning: changes or modifications not expressly approved by the party responsible for compliance could void the user's authority to operate the equipment

Radiation Exposure Statement

This equipment complies with FCC radiation exposure limits set forth for an uncontrolled environment.

This equipment should be installed and operated with minimum distance 20cm between the radiator and your body.