

PRODUCT INSTRUCTION MANUAL

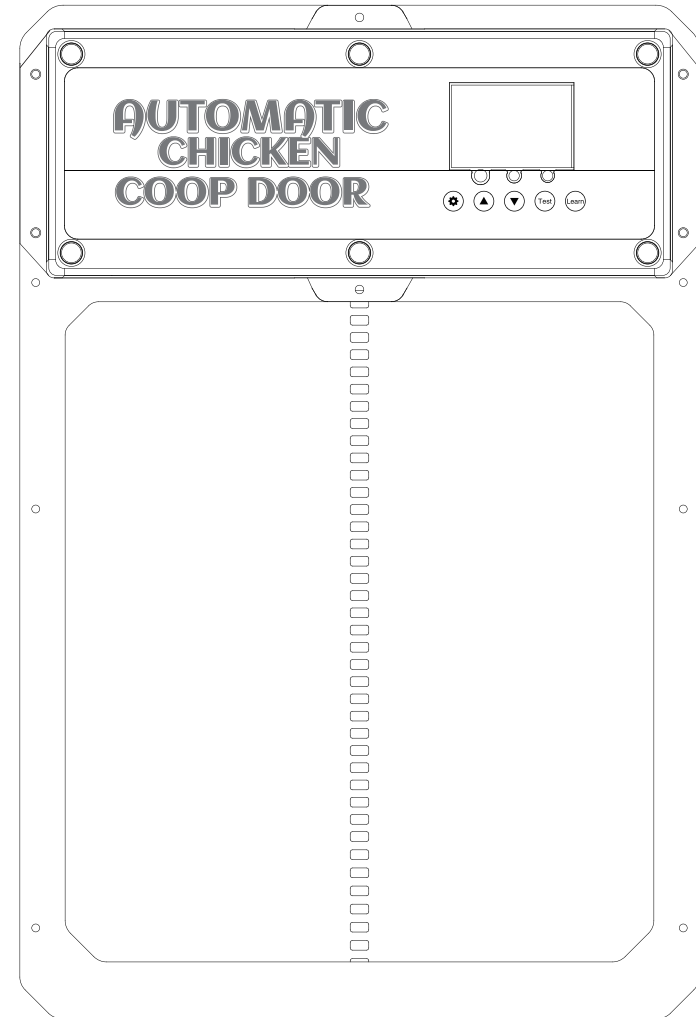

Chicken Coop Door
Model: JUMCC06B

Table of Contents

Welcome & Package Contents	Pg. 1
Warnings & Cautions	Pg. 2
Product Introduction Figure	Pg. 3
Installation Figure	Pg. 4
Control Panel Introduction Figure	Pg. 5
Specifications	Pg. 6
General Introduction & Setup	Pg. 7-9
Programming the Wireless Remote Control(s)	Pg. 10-11
Open& Close the Door with & without Remote Control	Pg. 12
Programming the Chicken Coop Door	Pg. 13-15
How To Power By Solar	Pg. 16-18
Maintenance/Troubleshooting	Pg. 19-20
FAQ	Pg. 21-22
Warranty	Pg. 23

IMPORTANT

- 1. DO NOT OVERTIGHTEN INSTALLATION SCREWS OR FRAME CAN COMPRESS AND BURN MOTOR OUT.
- 2. ENSURE DOOR IS INSTALLED ON FLAT FLUSH SURFACE, IF NOT THE DOOR FRAME CAN BEND AND WILL STOP WORKING(PAGE 7-9)

AUTOMATIC CHICKEN COOP DOOR

Thanks for your purchase of the Automatic Chicken Coop Door! We are working hard to provide high-quality products and service to satisfy you, and your positive response made our effort more meaningful, our relationship is more than seller and customer, we are partners!

Please review, read and understand ALL instructions and information to ensure proper functionality.

If you have any questions or concerns, don't hesitate to reach out to us, we are always available to help you.

Package Contents

- » **1x** Automatic Chicken Coop Door with Infrared Sensor
- » **1x** Wireless Remote Control
- » **1x** AC/DC Power Adapter
- » **1x** Internal Battery Pack (LOAD FOUR AA BATTERIES OR RECHARGEABLE BATTERY, BATTERIES CAN BE USED NORMALLY FOR A HALF YEARS WITH THIS DOOR)
- » **4x** Self-tapping Screw
- » **1x** Owner's Manual

Warnings & Cautions

- » To reduce risk of electric shock, do not disassemble this product. Contact **DYTREND** for any maintenance issues.
- » Use the AC/DC Power Adapter and cable provided with the unit. The use of other cables can result in shock, fire or cause damage to the unit.
- » Ensure the unit is connected to the power source properly.
- » Do not use the unit if power cord is damaged or if the plug socket contact is loose. Only use the AC/DC Power Adapter with a 100 - 240V AC power source.
- » Run power supply to a protected area or build power supply housing in order to protect the power plug in from weather. (Run cord through hole in chicken coop and plug in on the interior of the coop)



WARNING
ELECTRIC CHOCK HAZARD
This equipment is to be serviced by trained personnel only.



WARNING:HAZARDOUS MOVING PARTS
Do not place fingers, hair, clothes, lanyard.. near moving parts



PROP 65 WARNING
This product can expose you to chemicals including lead, which is known to the State of California to cause cancer, birth defects or other reproductive harm. For more information go to www.P65Warnings.ca.gov



CHOKING HAZARD. SMALL PARTS. 0-3
Not for children under 3 years old.



DO NOT DISPOSE IN TRASH
Follow appropriate Local electronics scrap procedures.

AUTOMATIC CHICKEN COOP DOOR

Product Introduction

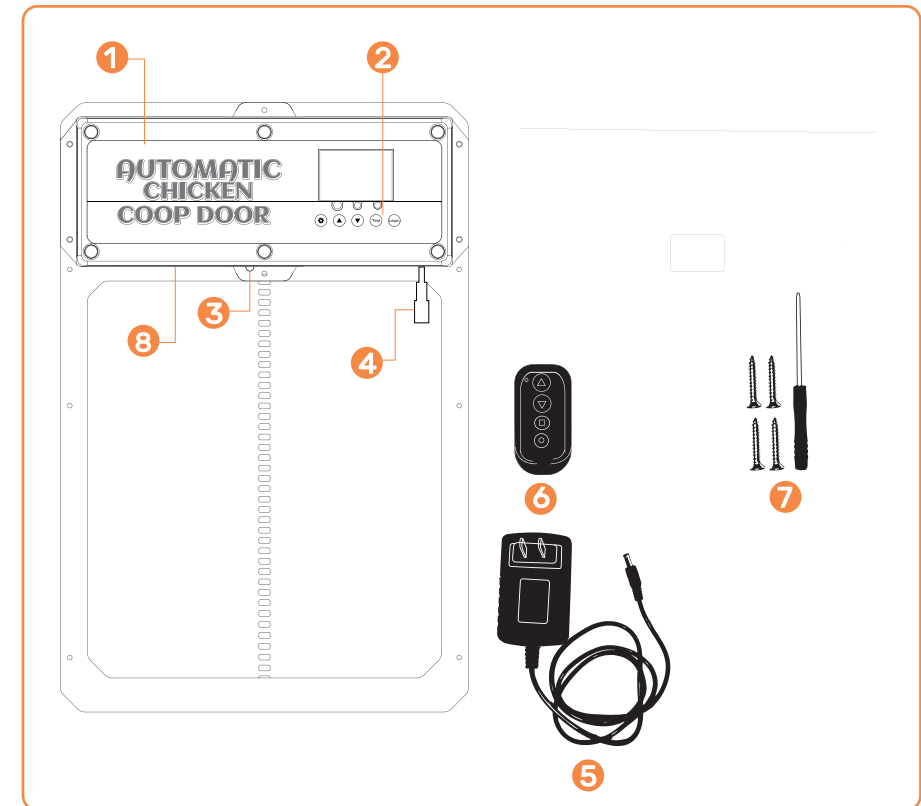

- 1, Chicken Coop Door
- 2, Control Panel
- 3, Infrared sensor
- 4, DC/Solar Female Plug
- 5, AC/DC Power Adapter with Cord and DC Male Plug
- 6, Wireless Remote Control (Batteries Not Included, LOAD A27 BATTERIES)
- 7, Self-tapping screws
- 8, Internal Battery Pack (BACKUP POWER SUPPLY)

Installation Introduction

8.5" Inches in Width Approximately

12" Inches in Height Approximately

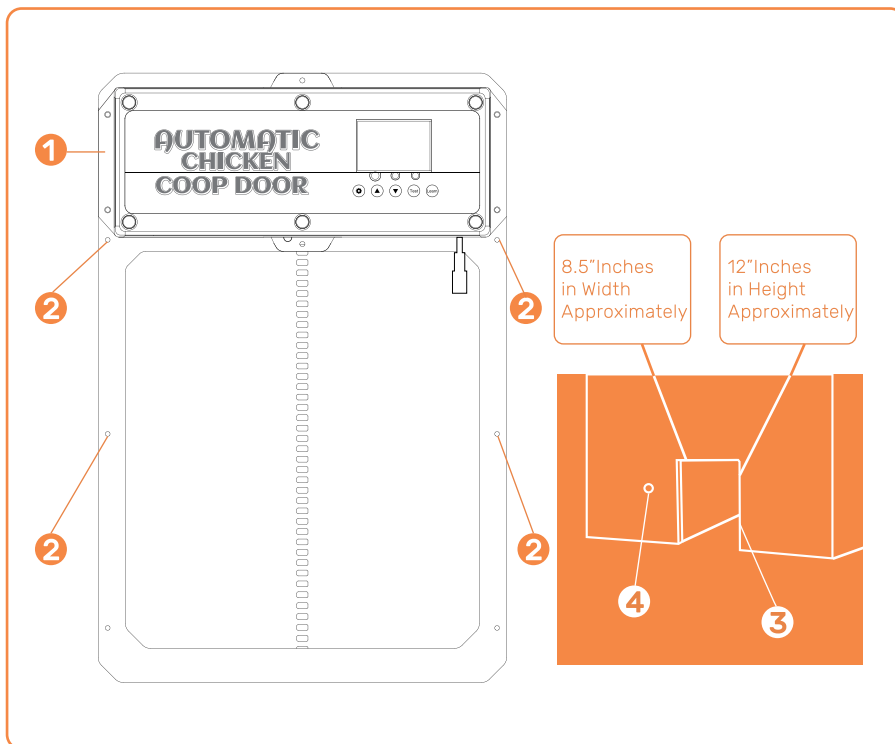

- 1. Chicken Coop Door Frame
- 2. Screw Installation Location
- 3. Chicken Coop Structure/Wall (with hole for the Chicken Coop Door Frame Installation)
- 4. Hole for power supply to run through to ensure power is protected from weather

AUTOMATIC CHICKEN COOP DOOR

Control Panel Introduction

Digital Display

- **SET**-Button used to switch between programming modes
- **LEARN**--Button used to add/remove the wireless remote control(s)
- **Test**-Button used to manually open/close the door
- **(UP)**-Button used to change program functions while in the program mode
- **(DOWN)**-Button used to change program functions while in the program mode
- **Light 1**-Open door (green) and close door (red) indicator lights
- **Light 2**-Infrared sensor working indicator light
- **Light 3**-Light sensor working indicator light

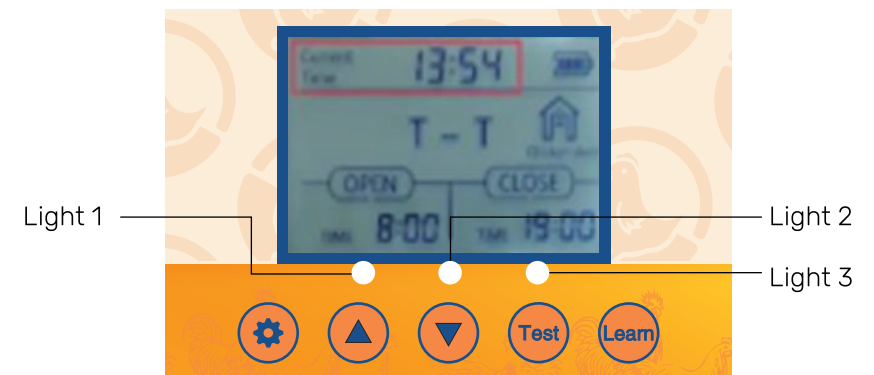

Specifications

- » **Unit Weight:** 4lbs
- » **Power Supply:** AC/DC Power Adapter (Input (100-240V 50/60hz) to Output (12V 3A)) with cord (30 inches) that has a DC (5.5x2.1mm) Male Plug (Outside Diameter: 5.5mm, Inside Diameter: 2.1mm, Length: 10mm)
- » **Female Plug:** DC (5.5x2.1mm) Plug (Hole Diameter: 5.5mm, Pin Diameter: 2.1mm, Length: 10mm)
- » **Solar Panel or Battery Attachment:** DC (5.5x2.1mm) Male Plug
- » **(Outside Diameter: 5.5mm, Inside Diameter: 2.1mm, Length: 10mm)**
- » **Wireless Remote Control:** Frequency 433 MHZ with a range of up to 40 meters
- » **Wireless Remote Control Battery:** A27 12V

AUTOMATIC CHICKEN COOP DOOR

Operations Manual

General Introduction

The Coop Door is the perfect solution for a more enjoyable Homesteading way of life. We utilize modern technology and put that into a slim compact design to provide our customers with the best Automatic Coop Door available.

Our product is made to support your homesteading goals and to help make homesteading easier. **We suggest to use the power cord or solar to power your door, this door uses a lot of power due to it being a sturdier door so batteries will die fast!**

General Introduction

1. Verify/create an opening in the chicken door structure/wall such that the chicken coop door frame can be installed and securely fastened with screws. Width= 8.5" inches, Height = 12" inches
2. Attach the chicken coop door frame to the chicken coop structure/wall with the self-tapping screws **(DO NOT OVERTIGHTEN OR DOOR WILL COMPRESS AND NOT OPEN)**. Ensure the chicken coop door frame is flat (no gaps/warps) against chicken coop structure/wall after the self-tapping screws are installed. Use a power tool to install screws through door.
3. Connect the DC Male Plug of the AC/DC Power Adapter to either one of the DC Female Plugs on the chicken coop door.
4. Connect AC/DC Power Adapter to a power source and the chicken coop door will turn on as confirmed by the Digital Display being illuminated. Ensure power source is protected from weather by plugging in on interior of coop or building a simple power supply box to prevent water intrusion.

Operations Manual

General Installation Continued

IMPORTANT

- 5. To utilize the light sensor or the timer see page 14-16.
- 6. Don't forget if the door isn't opening/closing all of the way try loosening the screws on the door. The door can get pinched if the door is installed to tight.
- 7. *****If the door is not closing after programming.** Please try turning off the power again and try closing it again.
- 8. If you have exterior trim or anything that could make the door installed uneven then use 2x4s or some flat pieces of wood to ensure flushness.

OPTIONAL RAIN SHIELD

- 9. Use two 1" to 1" wooden spacers and install them above door at the width of the holes in the rain shield.
- 10. Install rain shield onto the two wooden spacers So door can go up and behind the rain shield.

**** = Extra Important

AUTOMATIC CHICKEN COOP DOOR

Operations Manual

General Installation Continued I (Infrared Sensor)

- 11. The infrared sensor is built-in this door.
- 12. There is a red light on the sensor to indicate when something is blocking the infrared ray. While the red light is illuminated the door will not close.
- 13. The animal sensing probe is shown in Figure . When the door descends (or is descending) the probe senses an animal at the door (action+temperature, blue light on), and the door will return to rise. After 1 minute, it will continue to descend. After power outage, restarting the probe requires preheating for about 15 seconds (blue light goes out) to operate normally.

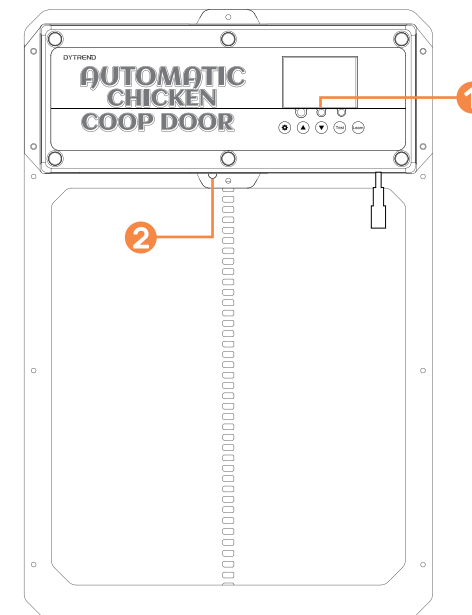

1 Infrared sensor

2 Infrared sensor indicator light

Operations Manual Continued...

1.0 - Programming the Wireless Remote Control(s)

- 1. Verify the remote control battery(s) are installed in the remote control(s)
(Battery(s): A27 12V sold separately).
- 2. To pair a remote control to the chicken coop door push and hold the **LEARN** button on the control panel down for 2 seconds. Then press any button on the remote control twice. The green LED flashes twice, indicating that the pairing is complete. To pair the second remote control repeat this step.
- 3. To un-pair all remote control(s) push and long hold the **LEARN** button, until the green LED flashes twice, indicating that the cancellation is complete.

Note: If power is removed from the chicken coop door for a short period of time and power is reapplied, the remote control(s) will still be paired to the chicken coop door.

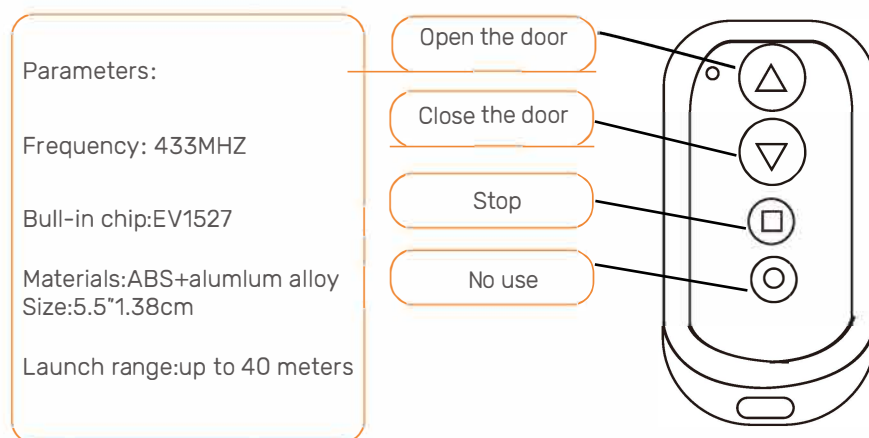

AUTOMATIC CHICKEN COOP DOOR

Operations Manual Continued...

2.0- Open/Close Chicken Coop Door With Remote Control

- 1. Push the Up Arrow button to open the door.
- 2. Push the Down Arrow button to close the door.
- 3. Push the Square button to stop any movement of the door.

3.0- Open/Close Chicken Coop Door Without Remote Control

Sequentially pushing the Test button on the control panel will either open or close the door.

- 1. Push the Test button on the control panel. The door will open.
- 2. Push the Test button on the control panel. The door stop moving.
- 3. Push the Test button on the control panel. The door will close.

Description of wireless remote control



Parameters:

Frequency: 433MHZ

Built-in chip :EV1527

Shock resistance: 330k

Materials: ABS + aluminium alloy

Size: 53*33*13mm

Operations Manual Continued...

4.0 - Programming the Chicken Coop Door

1. Screen Wakeup

- 1.1 Button wake-up: Press the **SET** or **TEST** button once to turn on the screen for about 1 second.
- 1.2 Remote control wake-up: Press and hold any key on the remote control for about 5 seconds to light up the screen.

2. Setting manual door opening or closing

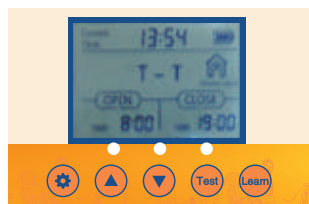

- 2.1 Connect the power supply, and the display screen will display as shown
- 2.2 Push the **Test** **TEST** button for one time for open the door.
- 2.3 Press the **Test** **TEST** button once to pause
- 2.4 Press the **Test** **TEST** button again to close the door

3. Setting the Local Time (24 Hour Time Format) for the Door

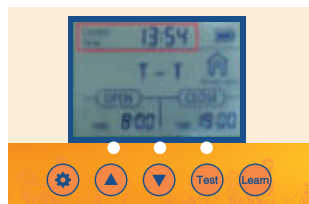

- 3.1 Push the **SET** button on the control panel to display
- 3.2 The Hours time unit will flash. Adjust the Hours time unit by pushing the **▲ (UP)** or **▼ (DOWN)** button.
- 3.3 Push the **SET** button to switch to the Minutes time unit. The Minutes time unit will flash.
- 3.4 Adjust the Minutes time unit by pushing the **▲ (UP)** or **▼ (DOWN)** button.
- 3.5 Push the **SET** button to confirm the time setting and the next setting

Sequentially pushing the **SET** button on the control panel will cycle through the different settings to be programmed.

AUTOMATIC CHICKEN COOP DOOR

Operations Manual Continued...

4. Set timing and light sensing mixed mode

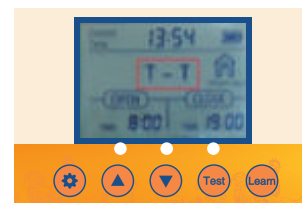

- 4.1 Push the SET button for one second on the control panel to display
- 4.2 **T - T** Indicates **time to open the door - time to close the door.**

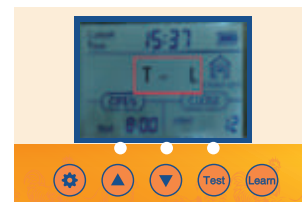

- 4.3 Push the UP button for one second on the control panel to display
- 4.4 **T - L** Indicates **time to open the door - light to close the door.**

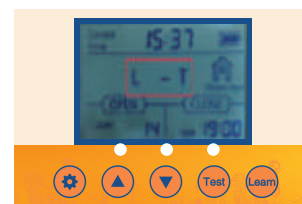

- 4.5 Push the UP button for one second on the control panel to display
- 4.6 **L - T** Indicates **light to open the door - time to close the door.**

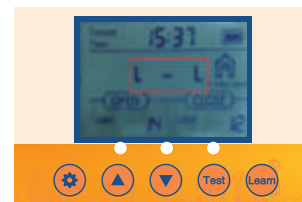

- 4.7 Push the UP button for one second on the control panel to display
- 4.8 **L - L** Indicates **light to open the door - light to close the door.**

Operations Manual Continued...

5. Turning option on so that the Door opens or closes automatically with the Local Time Setting and Timer

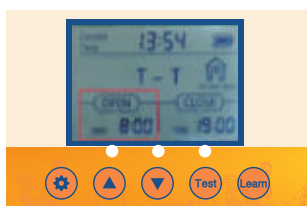

- 5.1 Verify/Push the **SET** button on the control panel to display **OPEN-T**
- 5.2 The Hours time unit will flash. Adjust the Hours time unit by pushing the **▲ (UP)** or **▼ (DOWN)** button.
- 5.3 Push the **SET** button to switch to the Minutes time unit. The Minutes time unit will flash.
- 5.4 Adjust the Minutes time unit by pushing the **▲ (UP)** or **▼ (DOWN)** button.

6. Turning option on so that the Door opens or closes automatically with the Ambient Light Brightness Setting

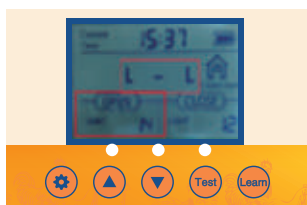

- 6.1 Verify/Push the **SET** button on the control panel to display **OPEN-L**
- 6.2 The Lumen value unit will flash. Adjust the Lumen value unit by pushing the **▲ (UP)** or **▼ (DOWN)** button.
- 6.3 Adjust the Lumen value unit by pushing the **▲ (UP)** or **▼ (DOWN)** button.

Remember, **For Open**

23 = The most light for the door to open
0 = The least for the door to open

Remember, **For Close**

23 = The least light for door to close
0 = The most light for the door to close

- 6.4 It is recommended that the customer set it at around 15. If the sensitivity value is too strong, the chicken coop door will open and close when it senses a little light!

AUTOMATIC CHICKEN COOP DOOR

Operations Manual Continued...

7. Close option on so that the Door opens or closes automatically with the Local Time Setting and Timer

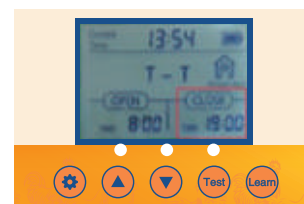

- 7.1 Verify/Push the **SET** button on the control panel to display **CLOSE-T**
- 7.2 The Hours time unit will flash. Adjust the Hours time unit by pushing the **▲ (UP)** or **▼ (DOWN)** button.
- 7.3 Push the **SET** button to switch to the Minutes time unit. The Minutes time unit will flash.
- 7.4 Adjust the Minutes time unit by pushing the **▲ (UP)** or **▼ (DOWN)** button.

8. Close option on so that the Door opens or closes automatically with the Ambient Light Brightness Setting

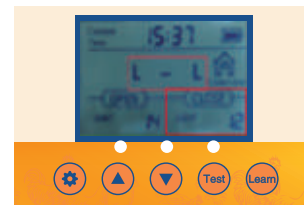

- 8.1 Verify/Push the **SET** button on the control panel to display **CLOSE-L**
- 8.2 The Lumen value unit will flash. Adjust the Lumen value unit by pushing the **▲ (UP)** or **▼ (DOWN)** button.
- 8.3 Adjust the Lumen value unit by pushing the **▲ (UP)** or **▼ (DOWN)** button.

Remember, **For Open**

23 = The most light for the door to open
0 = The least for the door to open

Remember, **For Close**

23 = The least light for door to close
0 = The most light for the door to close

- 8.4 It is recommended that the customer set it at around 15. If the sensitivity value is too strong, the chicken coop door will open and close when it senses a little light!

The chicken coop door is equipped with automatic charging function:

- 1. How to use the battery: No. 5 1.2V nickel hydrogen rechargeable battery The 4PCS control board has a voltage stabilizing function and automatically stops when the battery is fully charged.
② 4PCS AA 1.5V No.5 battery.
- 2. Solar charging panel charging: output 9V 10W solar charging panel as shown in the figure

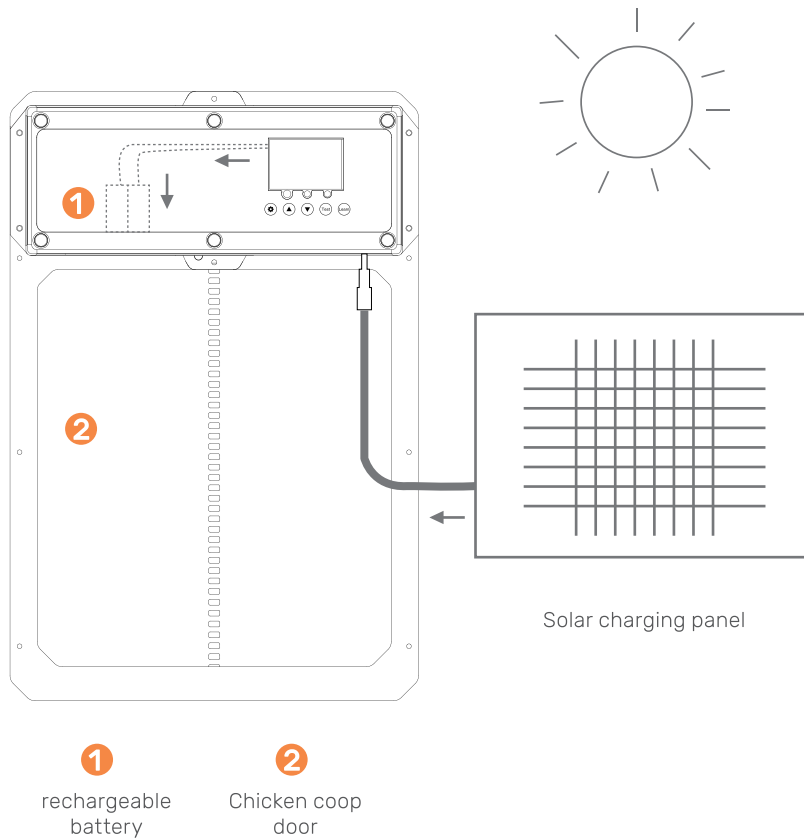

AUTOMATIC CHICKEN COOP DOOR

How To Power By Solar?

Go to **DYTREND official store** contact us via [after-sales services](#) for further help! We will walk you through the process!

CAUTION: DO NOT TOUCH LEAD WIRES TOGETHER!

What you need:

10W - 25W Solar Panel
9V 10Amp Solar Charge Controller
9V Battery 10AmpHour Battery

- 1. Install Solar Panel in direction to optimize for sunlight.
- 2. Connect solar panel to solar charge controller.
- 3. Connect battery to solar charge controller.
- 4. Connect auto chicken coop door to solar charge controller.
- 5. Protect solar charge controller and battery in enclosing to protect from rain/weather.

How To Power By Solar? Continued...



See examples of products below

Solar Charge Controller and 25W Solar Panel

AUTOMATIC CHICKEN COOP DOOR

Maintenance & Troubleshooting

Remote Control(s) Not Working

- » Check that the remote control battery(s) are installed in the correct direction and the battery(s) are full of charge. Replace batteries if required.
- » Ensure the remote is programmed to the Chicken Coop Door correctly.
- » Check that the Chicken Coop Door is powered on.

Chicken Coop Door Does Not Power On

- » Ensure there is power going to the unit.
- » Check the electrical connections powering the unit to ensure they are not dirty or damaged.

Chicken Coop Door Does Not Open and/or Close Automatically with the Local Time or Brightness Settings

- » Check to see if the settings used are programmed correctly and the features are not turned off (Refer to Page 13-16 for programming instructions).

Maintenance & Troubleshooting

Timer isn't working properly

Follow these instructions to diagnose whether your timer is faulty or the door settings were not set correctly.

- 1. Unplug the door from power.
- 2. Plug the door back in.
- 3. Do not change any other settings.
- 4. Reset the opening or closing time.
- 5. Wait until the door goes to specify the opening time 0805 to confirm if the door opens.
- 6. If following these steps made your door work follow the same instructions to program the door to your local time and your door open and close time. Ensure to unplug the door again prior to doing so just to give it a hard reset.

If this troubleshooting did not fix your door then please reach out to me via email and I'll respond shortly or give you a call.

If you need further help please email us at our store and we will get back to you within a couple of hours!

AUTOMATIC CHICKEN COOP DOOR

Frequently Asked Questions (FAQ)

Can a Solar Panel or Backup Battery be used with the unit?

Yes, it can be connected/installed with the supplied DC Male Plug

Does the Chicken Coop Door have to be installed on the inside or outside of the chicken coop?

It depends on how you plan to use it. If it is installed on the inside of a closed off coop then the light sensitivity settings will not operate properly.

What to do if the Door Jams when opening or closing the door?

Ensure the door frame is installed flat against the wall and that there are no foreign debris found in the path of travel of the door. Also ensure the installation screws are not installed too tight!

What to do if the Door does NOT open/close all of the way?

If the door is NOT closing try to reset your power supply.

Frequently Asked Questions (FAQ)

How do I reach out to DYTREND for Technical support?

Go to our Amazon store and email us. We are always available to help!

My unit is not working, what do I do?

Check out the rest of this manual or send us an email. We are always available to help!

Can the AC/DC Power Adapter Cord be extended?

Yes, an DC Male/Female extension cable can be used.(Refer to Page for the dimension DC Plug specifications)

How do I prevent the power supply cord from getting wet?

Use electrical tape and sufficiently wrap the connection point, drill a hole next to the door to run the power supply through so the power supply is not exposed to the weather.

How should I power my door?

Use the power cord and power from your grid or go solar! Send us an email if you need help setting up the solar, it's inexpensive and simple!

Warranty

Warranty Promise

The Automatic Chicken Coop Door is backed by a 6 month warranty. Before processing a replacement, we'll walk you through several troubleshooting steps, so be patient and allow us to properly diagnose the issue and path forward, Sign up for our warranty by contact our Amazon shop after-sales team.

Void of Warranty

- » If there is any foreign object debris inside the machine or it looks like it's been tampered with the warranty will be voided.
- » If any internal parts have been replaced and/or messed with without contacting **DYTREND** customer support, warranty will be voided.

FCC Caution.

(1) § 15.19 Labelling requirements.

This device complies with part 15 of the FCC Rules. Operation is subject to the following two conditions: (1) This device may not cause harmful interference, and (2) this device must accept any interference received, including interference that may cause undesired operation.

§ 15.21 Changes or modification warning

Any Changes or modifications not expressly approved by the party responsible for compliance could void the user's authority to operate the equipment.

§ 15.105 Information to the user.

Note: This equipment has been tested and found to comply with the limits for a Class B digital device, pursuant to part 15 of the FCC Rules. These limits are designed to provide reasonable protection against harmful interference in a residential installation. This equipment generates uses and can radiate radio frequency energy and, if not installed and used in accordance with the instructions, may cause harmful interference to radio communications. However, there is no guarantee that interference will not occur in a particular installation. If this equipment does cause harmful interference to radio or television reception, which can be determined by turning the equipment off and on, the user is encouraged to try to correct the interference by one or more of the following measures:

- Reorient or relocate the receiving antenna.
- Increase the separation between the equipment and receiver.
- Connect the equipment into an outlet on a circuit different from that to which the receiver is connected.
- Consult the dealer or an experienced radio/TV technician for help.