

PHILIPS

Home Access

Retrofit lock

DDL230X-10HW

User Manual

Sign your product up and
get support at
www.philips.com/support



Contents

1 Warnings & Safety Information 02

Safety
Caution
Returns & Disposal
Door Compatibility

2 Installation Guide 04

Parts List
Assembly View
Installation Steps
Required Tools

3 Lock setup 11

4 Install door position sensor 12

5 Factory Default Settings & Reset Instructions 14

6 Warranty 15

7 FCC Statement 16

8 ISED Statement 17

1 Warnings & Safety Information

Safety

- ◆ Before using this product, please read and understand all instructions. Damage caused by failure to follow instructions is not covered by the warranty.
- ◆ Only use components the manufacturer provided and suggested accessories.
- ◆ Only use non-rechargeable, CR123A batteries.
- ◆ Do not forcibly disassemble the product to trigger an alarm or damage the product.
- ◆ Do not remove the batteries during lock setup and operation.

Caution

- ◆ Do not place the batteries near fire sources.
- ◆ Do not connect the 2 poles of the batteries to metals in order to avoid a short circuit and potential explosion.
- ◆ Any replacement component should be performed by Philips, a Philips authorized service center or professional technician.
- ◆ Do not use parts or accessories manufactured by others, except batteries.
- ◆ Do not expose products to places that have water leakage or splashing.

Returns & Disposal

- ◆ Locks can be returned at authorized Philips service centers. Appropriate compensation will be provided if the returned product meets Philips conditions.

- ◆ Please follow local regulations and do not throw used product or batteries into normal household waste.

Door Compatibility

- ◆ The Philips Wi-Fi retrofit lock is compatible with most single-cylinder deadbolts.

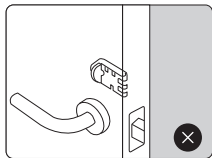
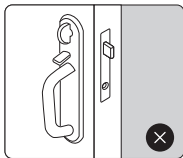
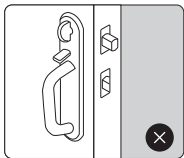
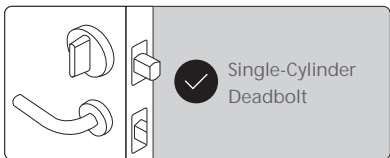

2 Installation Guide

Parts List

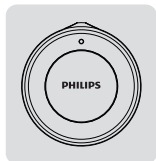

① Wi-Fi Retrofit Lock



② Mounting Plate

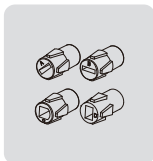

③ Mounting Adapters (4)

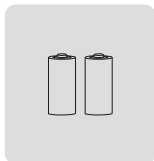

④ CR123A Batteries (2)

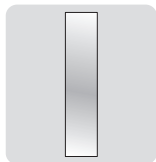

⑤ Adhesive Strip

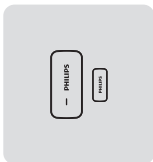

⑥ Door Position Sensor

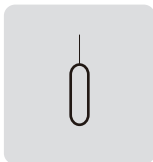

⑦ Setting Pin for Door Position Sensor



⑧ User Manual

Assembly View

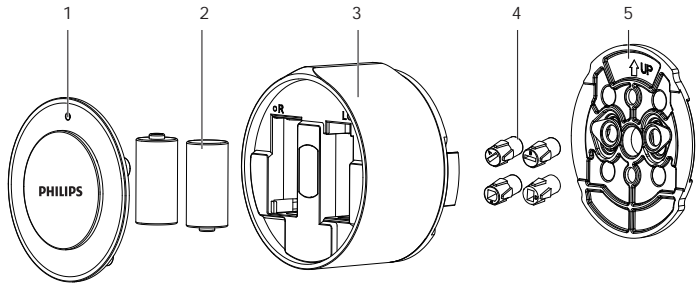

1	Battery Cover
2	Batteries
3	Retrofit Lock
4	Mounting Adapters
5	Mounting Plate

Installation Steps

Required Tools



#2 Philips screwdriver

Step 1 Prepare your existing deadbolt

Use the supplied adhesive strip to hold the keyed side of the lock in place.

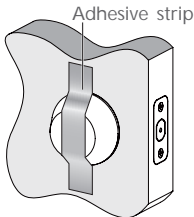

Step 2 Remove your existing thumb turn

While keeping the tape on the exterior portion of the lock, unlock your deadbolt via the thumb turn. Use a #2 Philips screwdriver to remove the mounting screws holding the existing thumb turn and back plate. Remove the interior deadbolt components.

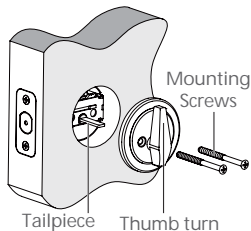

Step 3 Attach the mounting plate

Place mounting plate on the interior of the door. Insert the mounting screws that were previously removed from the thumb turn to secure the mounting plate.

⚠ Attention

Please make sure deadbolt is retracted

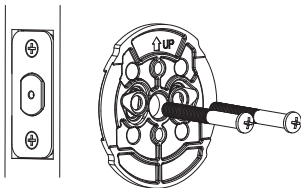

Step 4 Choose and attach correct mounting adapter

- 1 There are four adapters provided. Check the shape of the tailpiece protruding through the latch and select the appropriate adapter.

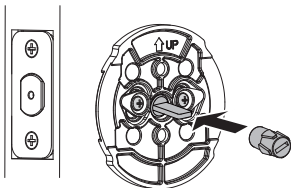

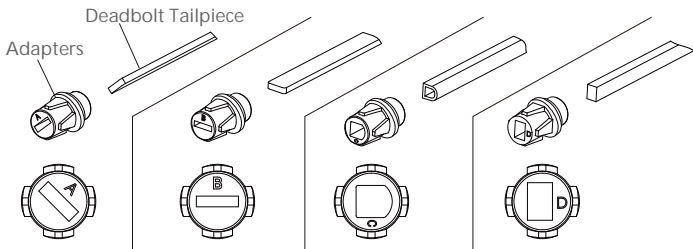

Keep in mind that the tailpiece of your deadbolt may be oriented differently depending on the side of the door that the hinges are on.

- ② Place the correct adapter into the tailpiece.

One of the triangle shaped nubs should face up if you have the correct adapter.

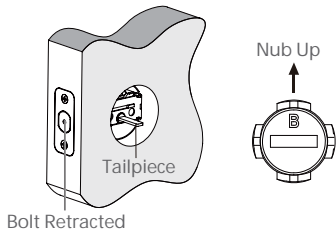

Step 5 Prepare your retrofit lock

- 1 Remove the battery cover by pressing down on the dot on the battery cover, then grab the bottom of battery cover to remove it.

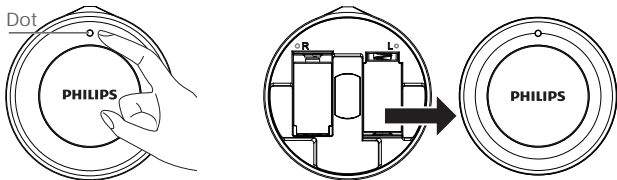

- 2 While standing inside of the house, keep the batteries vertical to the ground, rotate the outer shell right or left toward hinges until the position mark on outer shell aligns with the dot L or R.

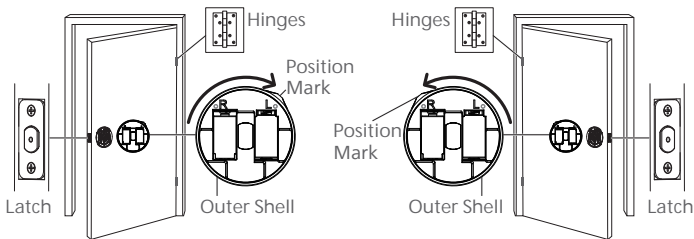

Step 6 Open the wing latches

Keep your door in the unlocked position. Pull out both side wing latches to prepare for mounting.

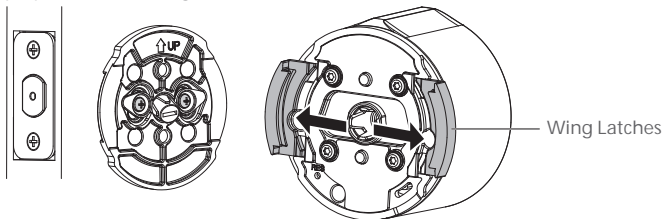

Step 7 Attach the Philips Wi-Fi retrofit lock

Before placing the Philips Wi-Fi retrofit lock on the door, ensure the thumb turn is in the correct unlocked position. Slide the retrofit lock over the tailpiece and attach it to the mounting plate. To secure the smart lock, clamp down both side wing latches to the mounting plate completely. Make sure the back of the lock is flush with the door, and the lock is able to lock and unlock the deadbolt manually by rotating the outer shell.

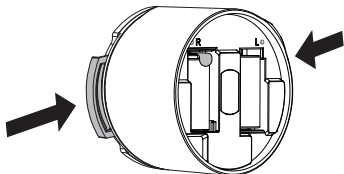

Step 8 Remove the battery tab

While holding the batteries in place, remove the plastic battery isolation tab. Make sure that the batteries are properly seated in its compartment. Place the battery cover back onto the smart lock.

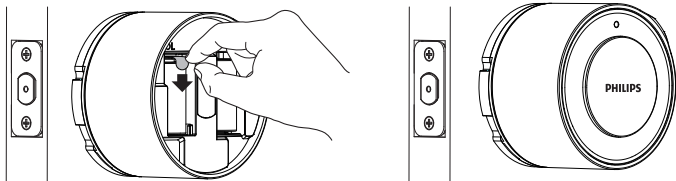

3 Lock setup

- 1 Download the Philips Home Access App from Google Play or AppStore.



Scan QR code to download
Philips Home Access App



Home Access



② Pair and calibrate the lock.

Add device

1. Turn on the Bluetooth on your phone and click the "Add Device" button on the Philips Home Access APP.
2. Scan the QR code or manually enter the device ESN displayed on the device body.
3. Complete pairing and Wi-Fi configuration according to instructions in the App.

4 Install door position sensor

- ① Push the battery back cover upward with your hand, remove the battery tab inside the door position sensor.

Insert the setting pin into the reset button on the side of the door position sensor and press it for 5 seconds. The door position sensor pairing indicator light turns red and enters the pairing state.

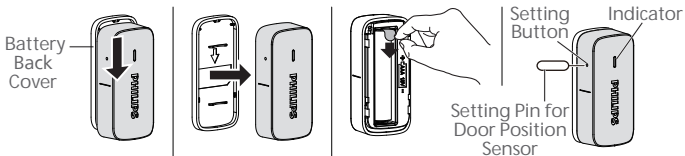

- ② Tear the double-sided tape of the door magnet and fix it on the door and door frame respectively.

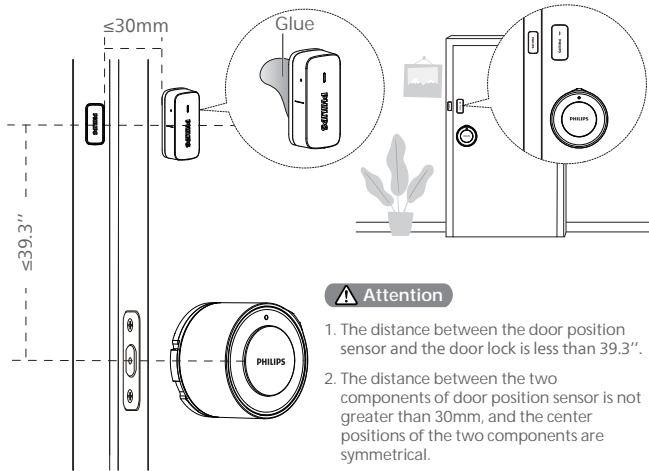

⚠ Attention

1. The distance between the door position sensor and the door lock is less than 39.3".
2. The distance between the two components of door position sensor is not greater than 30mm, and the center positions of the two components are symmetrical.

Need Help?



U.S.A. & Canada: +1(833)599-9111

5 Factory Default Settings & Reset Instructions

Factory Reset Instructions

This procedure erases all user and network settings and unpairs the lock from users accounts. All paired accessories will be also removed. Restoring the lock will also activate lock handing process.

Step 1: Unlock the door.

Step 2: Remove the lock from the door.

Step 3: Press and hold the reset button on the back side of the lock for at least 5 seconds until you hear the voice prompt.

The lock can be also restored to factory default settings through the Philips Home Access App.

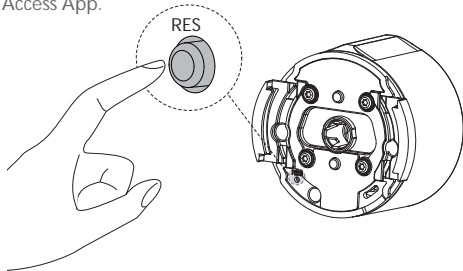

6 Warranty

2 years warranty

This product was brought to the market by Conex, which is the manufacturer of the product. Conex provides the warranty in relation to the product with which this booklet has been packaged. For more information on the warranty applicable to this product, please visit www.philips.com or contact the dealer where you purchased the product.

7 FCC Statement

This equipment has been tested and found to comply with the limits for a Class B digital device, pursuant to part 15 of the FCC Rules. These limits are designed to provide reasonable protection against harmful interference in a residential installation. This equipment generates, uses and can radiate radio frequency energy and, if not installed and used in accordance with the instructions, may cause harmful interference to radio communications. However, there is no guarantee that interference will not occur in a particular installation. If this equipment does cause harmful interference to radio or television reception, which can be determined by turning the equipment off and on, the user is encouraged to try to correct the interference by one or more of the following measures:

- Reorient or relocate the receiving antenna.
- Increase the separation between the equipment and receiver.
- Connect the equipment into an outlet on a circuit different from that to which the receiver is connected.
- Consult the dealer or an experienced radio/TV technician for help.

Caution: Any changes or modifications to this device not explicitly approved by manufacturer could void your authority to operate this equipment.

This device complies with part 15 of the FCC Rules. Operation is subject to the following two conditions: (1) This device may not cause harmful interference, and (2) this device must accept any interference received, including interference that may cause undesired operation.

RF Exposure Information

This equipment complies with FCC radiation exposure limits set forth for an uncontrolled environment. This equipment should be installed and operated with minimum distance 20cm between the radiator and your body.

8 ISED Statement

English: This device contains licence-exempt transmitter(s)/receiver(s) that comply with Innovation, Science and Economic Development Canada's licence-exempt RSS(s). Operation is subject to the following two conditions:

- (1) This device may not cause interference.
- (2) This device must accept any interference, including interference that may cause undesired operation of the device.

The digital apparatus complies with Canadian CAN ICES-3 (B)/NMB-3(B).

French: Cet appareil contient des émetteurs/récepteurs exempts de licence qui sont conformes aux RSS exemptés de licence d'Innovation, Sciences et Développement économique Canada.

L'exploitation est soumise aux deux conditions suivantes :

- (1) Cet appareil ne doit pas provoquer d'interférences.
- (2) Cet appareil doit accepter toute interférence, y compris les interférences susceptibles de provoquer un fonctionnement indésirable de l'appareil.

L'appareil numérique du ciem conforme canadien peut-3 (b) / nmb-3 (b).

This device meets the exemption from the routine evaluation limits in section 2.5 of RSS 102 and compliance with RSS 102 RF exposure, users can obtain Canadian information on RF exposure and compliance.

cet appareil est conforme à l'exemption des limites d'évaluation courante dans la section 2.5 du cnr - 102 et conformité avec rss 102 de l'exposition aux rf, les utilisateurs peuvent obtenir des données canadiennes sur l'exposition aux champs rf et la conformité.

This equipment complies with Canada radiation exposure limits set forth for an uncontrolled environment.

Cet équipement est conforme aux limites d'exposition aux rayonnements du Canada établies pour un environnement non contrôlé.

This equipment should be installed and operated with minimum distance 20cm between the radiator & your body.

Cet équipement doit être installé et utilisé à une distance minimale de 20 cm entre le radiateur et votre corps.



Philips and the Philips Shield Emblem are registered trademarks of Koninklijke Philips N.V. and are used under license. This product has been manufactured by and is sold under the responsibility of Shenzhen Conex Intelligent Technology Co., Ltd. and Shenzhen Conex Intelligent Technology Co., Ltd. is the warrantor concerning this product.