



# WIRELESS EARBUDS



## USER GUIDE

INEB1446GR

### What's in the Box?

- A. 1 pair of earbuds
- B. 1 charging case
- C. 3 pairs of silicone eartips (M size installed on earbuds)
- D. USB-C® charging cable
- E. 1 quick start guide  
1 warranty card

A

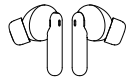

B

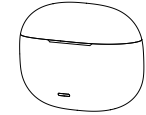

C

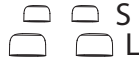

D



E



### Setting Up Your Device

Step 1: Place your earbuds into the charging case for initial activation and charge your device using the included charging cable.

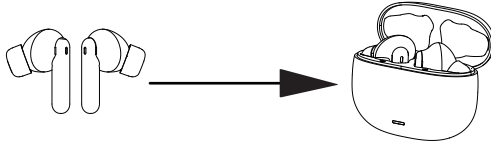

Step 2: Once fully charged, open the charging case. Your earbuds will enter pairing mode automatically. On your smartphone, search for the Bluetooth® device named "INEB1446" and tap to connect.

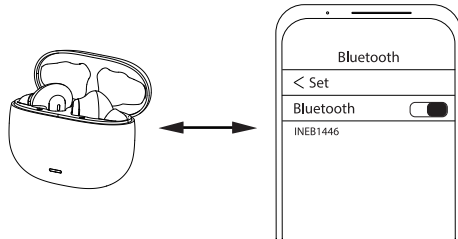

### Powering On/Off and Unpairing

#### Powering On

Removing your earbuds from the charging case will connect them to the last paired device.

#### Powering Off

Placing your earbuds in the charging case and closing the lid will turn off and disconnect your earbuds from the last paired device.



You may also turn off your earbuds without the charging case by pressing and holding each side of the earbuds for 5 seconds.

#### Pairing and Unpairing

To unpair your earbuds from the previously connected device, turn Bluetooth® off on your device. Place the earbuds in the charging case with the lid open to pair to a new device.

### Functionality

#### In-Ear Detection

Both earbuds will auto-pause when you remove them from your ears.



**Tap 1x** to Play/Pause



**Tap 3x** for Siri/ Voice Assistant



**Tap & Hold Left Earbuds 2 seconds** to play the previous track

**Tap & Hold Right Earbuds 2 seconds** to play the next track



**Tap Once** to answer an incoming call or to hangup

**Hold for 3 seconds** to reject an incoming call

### Charging Your Device

Use the included charging cable to connect your device to a power source such as a battery pack, laptop, or car charger.

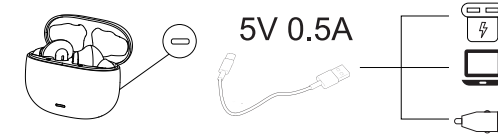

# The Specs

**Model:** INEB1446GR  
**Speaker Diameter:** 0.4"  
**Speaker Impedance:** 32 Ω ± 15%  
**Sensitivity:** 102 ± 3 dB at 1 KHz  
**Speaker Driver Rating Power:** 3 mW  
**Charging Cable:** 19.69"  
**Input:** 5V DC=0.5 A  
**Battery:** 3.7 V, 200 mAh, 1 Wh  
**Playback:** 5 hours (at 50% volume)

**WARNING:** Listening to loud audio for extended periods of time may damage your hearing permanently.

## Warranty Information

90-day Limited Warranty  
Territory: United States/Canada

**LIMITED WARRANTY TO ORIGINAL CONSUMER**  
This product (including any accessories included in the original packaging) as supplied and distributed new by an authorized retailer is warranted by **MCG Innovation Inc.** to the original consumer purchaser against defects in materials and workmanship ("Warranty") as follows:

- To obtain warranty service:
- Visit our website at **WWW.MCGINNOVATIONS.COM**
  - Click on **Product Support**
  - Select the **Brand** of your device
  - Select **Service Request** and fill out the form to begin your inquiry

## Warranty Information ( Continued )

Your product will be repaired or replaced, at our option, for the same or similar model of equal value if examination by the service center determines this product is defective. Products received damaged as a result of shipping will require you to file a claim with the carrier.

Warranty service not provided  
This warranty does not cover damage resulting from accident, misuse, abuse, improper installation or operation, lack of reasonable care, unauthorized modification including software modifications such as the installation of custom firmware. This warranty is voided in the event any unauthorized person opens, alters or repairs this product. All products being returned to the authorized service center for repair must be suitably packaged.

**FCC Information**  
This device complies with Part 15 of the FCC Rules.

**Caution:** Any changes or modifications not expressly approved could void the user's authority to operate the equipment.  
**Note:** This equipment has been tested and found to comply with the limits for a Class B digital device, pursuant to part 15 of the FCC Rules. These limits are designed to provide reasonable protection against harmful interference in a residential installation. This equipment generates, uses and can radiate radio frequency energy and, if not installed and used in accordance with the instructions, may cause harmful interference to radio communications. However, there is no guarantee that interference will not occur in a particular installation. If this equipment does cause harmful interference to radio or television reception, which can be determined by turning the equipment off and on, the user is encouraged to try to correct the

- interference by one or more of the following measures:
- Reorient or relocate the receiving antenna.
  - Increase the separation between the equipment and receiver.
  - Connect the equipment into an outlet on a circuit different from that to which the receiver is connected.
  - Consult the dealer or an experienced radio/TV technician for help.

This device complies with Part 15 of the FCC Rules. Operation is subject to the following two conditions: (1) This device may not cause harmful interference, and (2) this device must accept any interference received, including interference that may cause undesired operation .

**Radiation Exposure Information**  
This device has been evaluated to meet general RF exposure requirements. The device can be used in portable exposure conditions without restriction.



BRILLIANT INNOVATIONS® NAME AND LOGO ARE REGISTERED TRADEMARKS OF MCG INNOVATIONS INC.  
MANUFACTURED AND MARKETING UNDER LICENSE  
©2023 ALL RIGHTS RESERVED.  
WWW.MCGINNOVATIONS.COM  
MADE IN CHINA

**⚠️ WARNING: CANCER AND REPRODUCTIVE HARM –**  
**WWW.P65WARNINGS.CA.GOV**