



The manufacturer reserves the right to make changes to the product,
and update this manual at any time.
www.isinwheel.com

S10 Pro **US**

ELECTRIC SCOOTER

USER MANUAL

QUICK START GUIDE



Step 1: To unfold the scooter, pull the stem upright until you hear a click. Then close the folding latch until you hear a click.



Step 2: Insert the four bolts into the holes and then tighten them.

TIPS

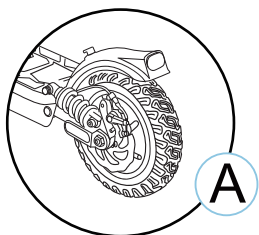

A) If there are some noises from the rear brake or the rear suspension (image A), please email us at support@isinwheel.com for assistance.

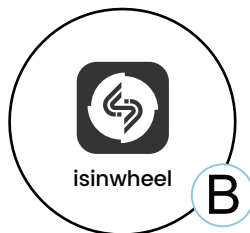

B) Download the "isinwheel" app in App Store (iPhones) or Google Play Store (Android phones) for more information and functions.

TABLE OF CONTENTS

1. Package Contents	01
2. Product Overview	02
3. Display Screen and Buttons	03
4. Charging	04
5. isinsheel App	05
6. Riding Basics	06
7. Riding Notice	07
8. Folding and Carrying	07
9. Disc Brake Adjustment	08
10. Maintenance and Care	09
11. Specifications	10
12. Questions and Answers	11
13. Contact Us	11



1. PACKAGE CONTENTS

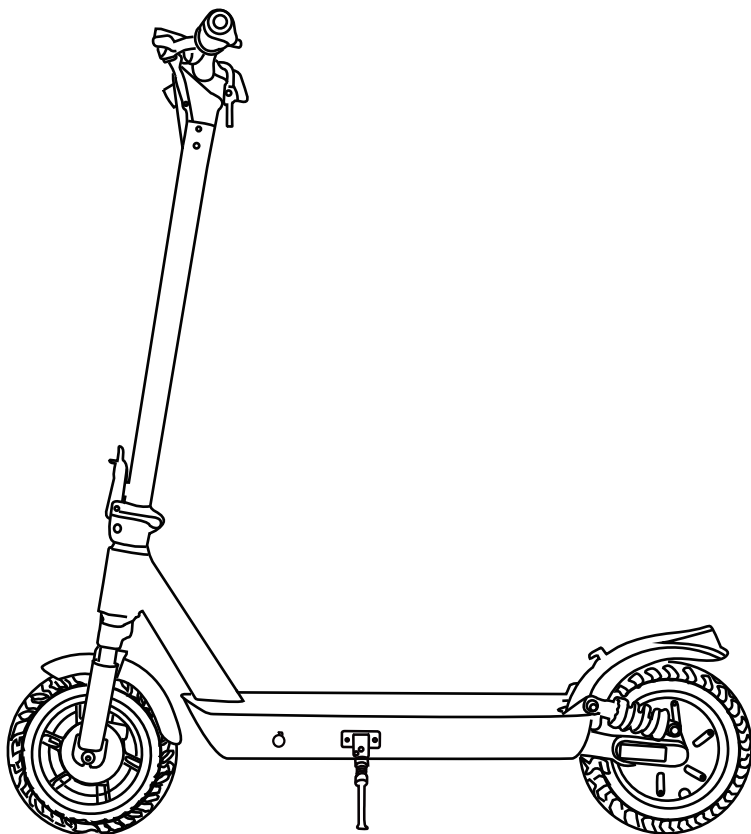

When unboxing your S10 Pro electric scooter, please check that all the below items are included in the package. If anything is missing or damaged, please contact isinwheel customer service for support at [**support@isinwheel.com**](mailto:support@isinwheel.com).

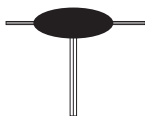

T-handle
Hex Key x1

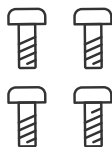

Bolt x4

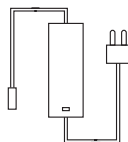

Charger x1



2. PRODUCT OVERVIEW





3. DISPLAY SCREEN & BUTTONS

3.1 Display Screen



*** Cruise control is turned on by default. The scooter will move at a constant speed after it maintains a speed for about 10 seconds.**

*** The default unit system is the imperial system.**

3.2 Buttons and Functions



Power Button

- Press and hold for 2 seconds to power on/off the electric scooter.
- Press once to turn on/off the front light.
- Press twice to switch the riding mode.
- Press three times to switch between the metric and imperial systems.
- Press four times to switch the start mode between zero start (default) and non-zero start.
- Press five times to turn on/off cruise control.



Turn Signal Switch

- Press the left arrow button to turn on/off the left turn signal light.
- Press the right arrow button to turn on/off the right turn signal light.



4. CHARGING

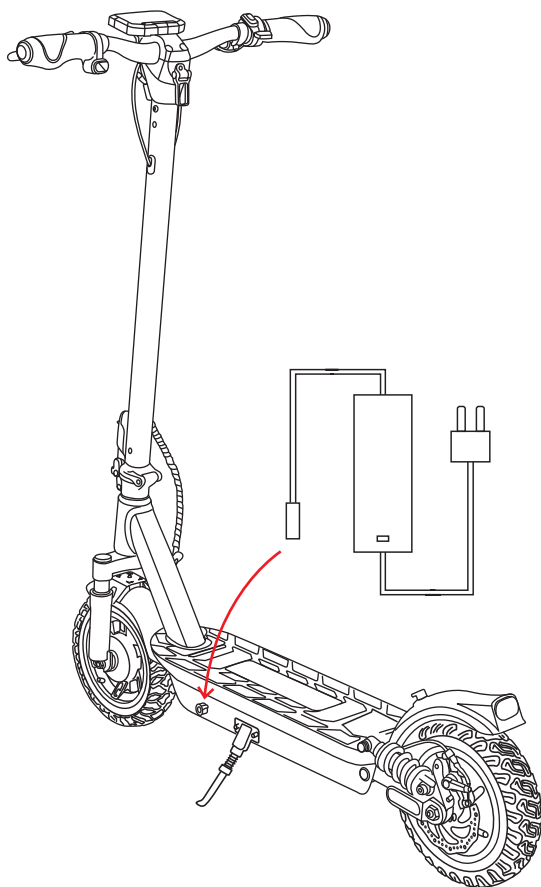

- The battery will be fully charged when the LED light on the charger changes from red to green.
- The charging protection feature will stop charging automatically after a full charge. Even so, charging your scooter for more than 24 hours is not recommended.
- Do not connect the charger if the charging port is wet.
- Close the charging port cover when the scooter is not charging.

Note: The scooter cannot be turned on during the charging period.



5. isinwheel APP



Scan the QR code or search “isinwheel” in App Store (iOS) or Google Play Store (Android) to download the app.



1. Open the isinwheel app and select “Sign up”.

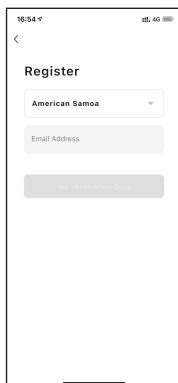

2. Select your country or region and enter your email address.

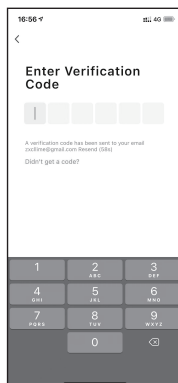

3. Find the verification code in your mailbox and fill it in.

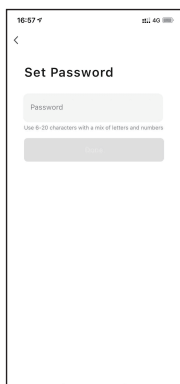

4. Set a password for your account.

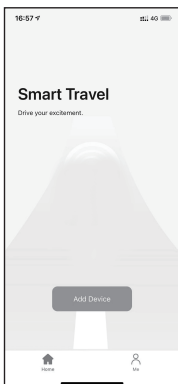

5. Registration is completed. Start your riding right now!



6. RIDING BASICS



Wear a helmet and knee pads to avoid falling and injuries when you learn to ride the scooter.



1. Power on the scooter and check the battery level on the display screen.

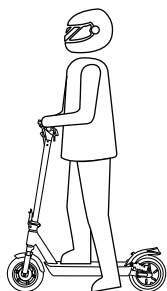

2. Put one foot on the deck and propel the scooter with the other foot (when the non-zero start is selected).

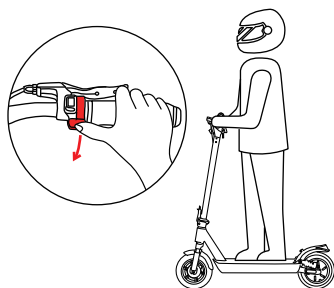

3. When the speed reaches 3 mph, put both feet on the deck and press the thumb throttle to accelerate. (Only when the speed exceeds 3 mph and the thumb throttle is pressed will the motor engage.)

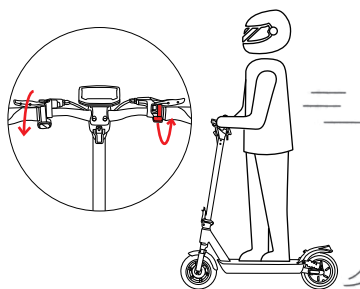

4. Release the thumb throttle and the kinetic energy recovery system (KERS) will initiate automatically. Squeeze the brake levers to slow down the scooter.

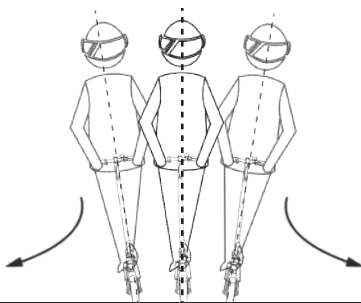

5. To turn, tilt your body in the steering direction and slowly turn the handlebar.



7. RIDING NOTICE

The isinwheel S10 Pro electric scooter is a recreational product. But it will be seen as vehicles and is subject to any risks faced by vehicles once it enters a public area. For your safety, please follow the instructions in this user manual and traffic laws and regulations set forth by government and regulatory agencies.

- Respect pedestrians' right of way. Try not to startle them (especially children) during riding. When you ride from behind pedestrians, ring your bell to give them a heads-up and slow your scooter to pass from their left (applicable to countries where vehicles drive on the right). When you ride across pedestrians, keep to the right at the lowest speed or get off.
- Closely follow the safety instructions in the manual. isinwheel shall not be liable for any financial losses, physical injuries, accidents, legal disputes, or other interest conflicts resulting from actions that violate user instructions.
- Check the scooter before every use. When you note loose parts, low battery alerts, excessive wear, strange sounds, malfunctions, or other abnormal conditions, stop riding.
- **WARNING - Risk of Fire - No User Serviceable Parts.**



8. FOLDING & CARRYING

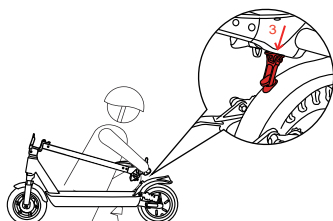
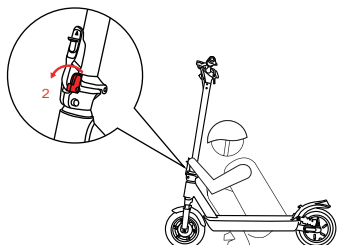
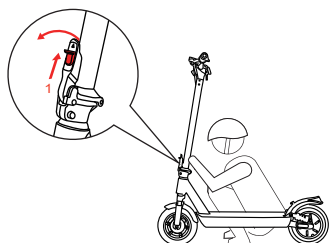

Before folding and carrying the scooter, power off the scooter.

- ① Open the folding latch while pushing up the safety switch.
- ② Flip forward the safety lever and fold the stem down.
- ③ Adjust the locking ring so that the hook catches the ring.



9. DISC BRAKE ADJUSTMENT

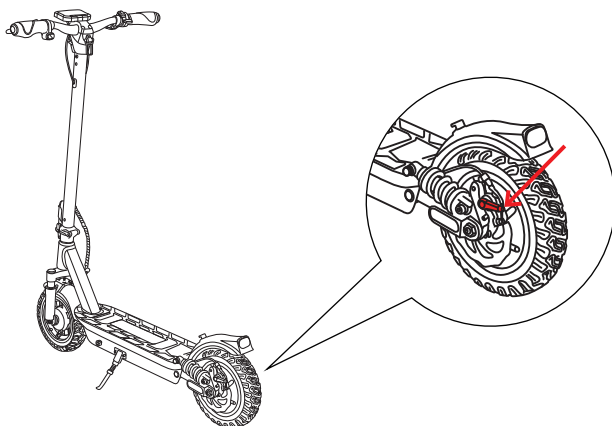

To adjust the disc brake:

You need a hex wrench to loosen the bolt on the cable clamp.

- If the disc brake is dragging, slide the arm of the clamp backward along the cable while holding the cable in one hand. Then, re-tighten the bolt on the brake clamp.
- If the disc brake does not work efficiently, the cable is slack. You need to slide the arm of the clamp forward along the cable while holding the cable in one hand. Then, re-tighten the bolt on the brake cable clamp.

Notice: The disc brake may squeak when in use until it is broken in. This is normal and does not affect the brake's function or performance.

To eliminate braking noises:

For easier operating, we suggest you put the scooter on the desk.

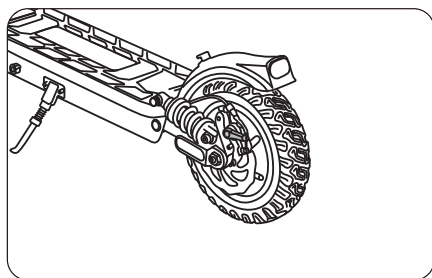

- First, make sure the scooter is turned off.
- Loosen the two brake caliper mounting bolts (not the bolt on the cable clamp).
- Reposition the brake caliper to ensure the brake rotor is in the middle of the two brake pads.
- Keep the brake rotor not touching the brake pads.
- After repositioning the brake caliper, re-tighten the mounting bolts.



10. MAINTENANCE & CARE

Cleaning

To clean stains on the scooter's body, wipe them off with a damp cloth. For stubborn stains, brush them with toothpaste and then wipe them off with a damp cloth.

- Do not clean the scooter with alcohol, gasoline, kerosene, or other corrosive and volatile chemical solvents.
- Do not wash the scooter deck with high-pressure water sprays. Before cleaning, make sure the scooter is turned off, the charging cable is unplugged, and the waterproof charging port cover is tightly closed to prevent electric shock or other severe problems.

Storage and Disposal

1. Store the scooter in a cool and dry place with a temperature of 14°F~95°F when it is not in use. In extremely humid environments, the internal parts of the scooter may suffer from condensation or even water accumulation, causing rapid battery aging.
2. Store the scooter indoors as prolonged exposure to UV rays and rainwater may damage the enclosure materials and reduce the battery pack's lifespan.
3. Charge the scooter every other month to preserve the battery during storage.
4. Mishandling of used batteries may do tremendous harm to the environment. Please follow local regulations to dispose of used batteries to protect the environment.

Battery Maintenance

1. Only use the original battery pack and charger to avoid safety hazards.
2. Fully charge the battery to maximize its lifespan after each use.
3. Charge the battery as soon as possible if the battery is low. Avoid completely exhausting it.
4. Never dismantle or puncture the battery.
5. Keep the battery contacts from metal objects to prevent short circuits that may result in battery damage or even injuries and deaths.



11. SPECIFICATIONS

Model	S10 Pro
Scooter Dimensions	Unfolded (Length x Width x Height ¹): 43.7 x 25.0 x 49.2 in.
	Folded (Length x Width x Height ¹): 43.7 x 24.8 x 21.5 in.
Scooter Weight	44.5 lbs
Range ²	25-32 mi.
Max Speed	28 mph
Speed Level	9/15/21/28 mph
Max Incline	35%
Load Capacity	264 lbs
Recommended Age	14+
Wheel	10-inch off-road inflatable tires
Brake	Front drum brake, rear disc brake, and electronic brakes
Motor	Peak Power: 800 W
	Rated Power: 500 W
Battery	48-54.6 V, 12.5 Ah
Charger	Input: AC 100-240 V, 50/60 Hz
	Output: 54.6 V, 2 A
Charging Time	6-7 h
Operating Temperature	28.4°F~95°F
Storage Temperature	14°F~95°F

(1) About the height: The distance from the ground to the top of the scooter.

(2) About the range: The range is measured under the condition of a full battery, a load of 154 lbs, at 77°F, on a flat road without wind, and a riding speed of 9.3 mph. The range in the actual use varies depending on different loads, humidity, wind speeds, and riding habits.

(3) The load shall be kept within 264 lbs (including the rider and other items apart from the scooter) in any case. Consider the extra weight of the clothes or other items with you and the gravity generated by speed.



12. QUESTIONS & ANSWERS

Question 1: What if the product comes with incomplete package contents or there are damaged parts?

Answer: Please take photos and send them to the isinwheel support team by e-mail at support@isinwheel.com. The support team will reply to you soon and then send the missing items or replacement parts.

Question 2: Are the tires replaceable and how to replace them?

Answer: Yes, the tires are replaceable. Please contact the isinwheel support team for more information or search "How to replace scooter tires" on YouTube.

Question 3: What if the disc brake doesn't work?

Answer: Please contact us for disc brake adjustment instructions or search "How to adjust scooter disc brakes" on YouTube.

Question 4: What if there are unusual noises from the rear wheel?

Answer: Usually, the noises come from the disc brake rotor. Please see the DISC BRAKE ADJUSTMENT page. If the problem still exists, please contact us.

Question 5: What do the fault codes on the display screen mean?

Answer: If you see any fault codes below on the screen, please contact the isinwheel support team to remove them.

E10	Communication Failure
E14	Accelerator Failure
E15	Brake Lever Failure
E16	Motor Hall Sensor Failure
E50	Over Voltage



13. CONTACT US

Contact us if you experience problems relating to riding safety, maintenance, or fault codes with your isinwheel S10 Pro electric scooter.

✉ support@isinwheel.com

🌐 www.isinwheel.com

FCC Statement

This equipment has been tested and found to comply with the limits for a Class B digital device, pursuant to part 15 of the FCC Rules. These limits are designed to provide reasonable protection against harmful interference in a residential installation. This equipment generates, uses and can radiate radio frequency energy and, if not installed and used in accordance with the instructions, may cause harmful interference to radio communications.

However, there is no guarantee that interference will not occur in a particular installation. If this equipment does cause harmful interference to radio or television reception, which can be determined by turning the equipment off and on, the user is encouraged to try to correct the interference by one or more of the following measures:

- Reorient or relocate the receiving antenna.
- Increase the separation between the equipment and receiver.
- Connect the equipment into an outlet on a circuit different from that to which the receiver is connected.
- Consult the dealer or an experienced radio/TV technician for help.

Caution: Any changes or modifications to this device not explicitly approved by manufacturer could void your authority to operate this equipment.

This device complies with part 15 of the FCC Rules. Operation is subject to the following two conditions: (1) This device may not cause harmful interference, and (2) this device must accept any interference received, including interference that may cause undesired operation.

RF Exposure Information

The device has been evaluated to meet general RF exposure requirement. The device can be used in portable exposure condition without restriction.