

User Manual

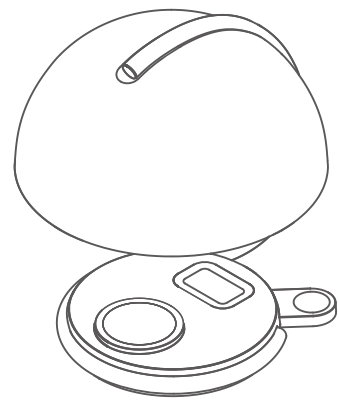

Model: PW0062

Contents

Product Introduction Setting	01
Brightness Setting Of Light	02
Brightness Setting Of Display	03
Clock Display Setting	04-05
Alarm Clock Setting	06-08
Snooze Mode	09
Compatible Devices	10
Other Information	11
Using Attention	12
Specification&Package Content	13
Q&A	14-15
Warranty	16

Product Introduction

- 1 Displays & Touch Panel
- 2 Wireless Charging For AirPods
- 3 Wireless Charging For Phone
- 4 Wireless Charging For Watch
- 5 Type C Power Input

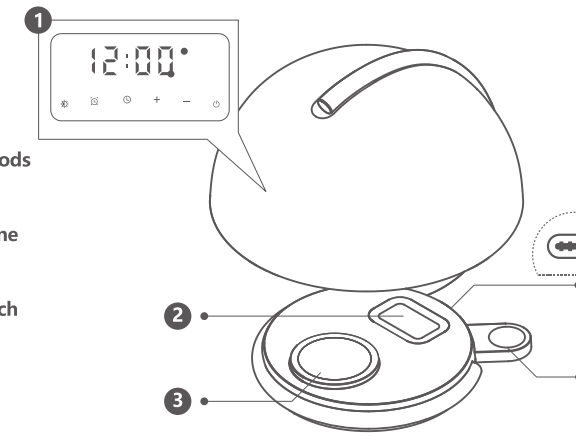

Brightness Setting Of Light

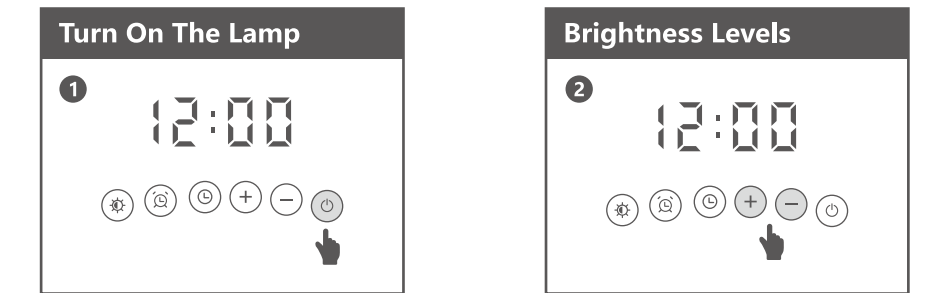

- 1 Short-press (power icon) to turn on the light.
- 2 Short-press (+) or (-) to adjust the brightness of the light. (Adjustable brightness in 4 levels)

Brightness Setting Of Display

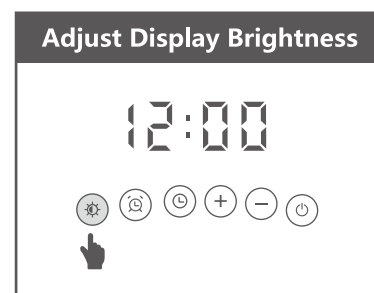

Short-press (+), to adjust the brightness of the display. (Adjustable brightness in 3 levels)

Clock Display Setting

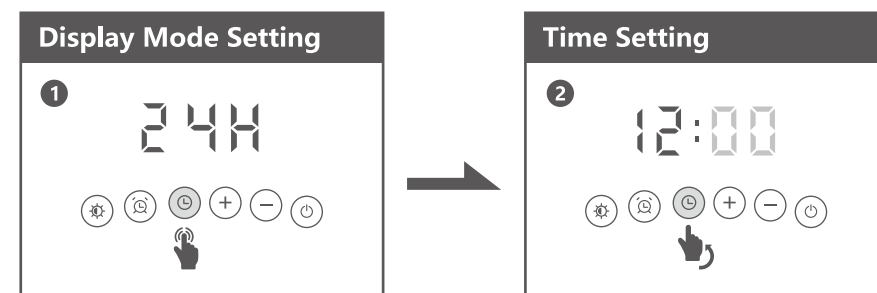

- 1 Long-press (clock icon) (1 sec) to enter the Clock Display Mode to set the time. Enter the interface, short-press (+) or (-) to select between 12-hour or 24-hour mode.
- 2 Short press again (clock icon) the time display blinks to enter the time setting, adjust by (+) or (-) to set the hour and minutes separately. (To confirm the setting, click (power icon))

Clock Display Setting

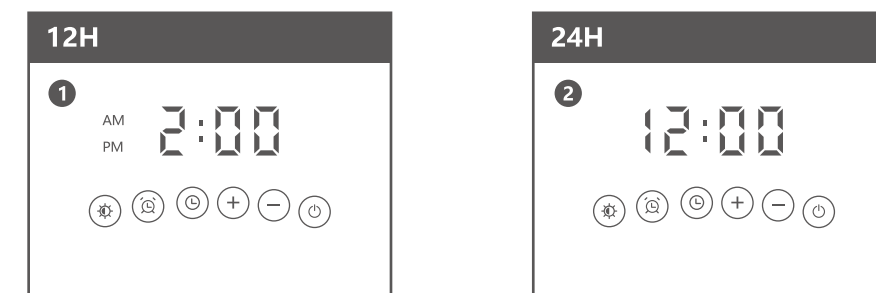

- 1 In 12-hour mode, AM light will on for morning, PM light is on for afternoon & evening.
- 2 In 24-hour mode, AM & PM lights won't come on.

Alarm Clock Setting

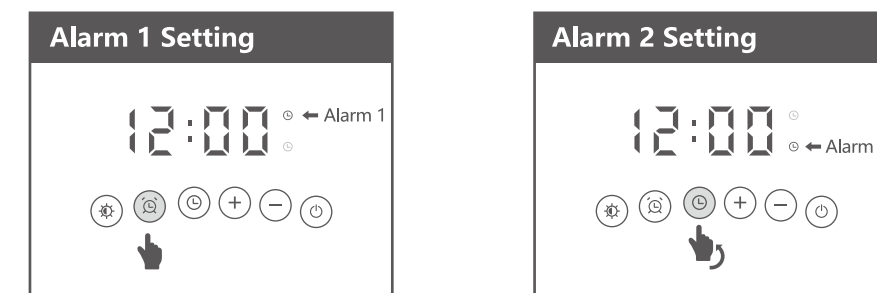

- 1 Long-press (alarm icon) to enter the Alarm 1 setting, at this time the indicator light of Alarm 1 on the right side of the screen lights up.
- 2 After setting the Alarm 1, press (alarm icon) to enter the Alarm 2 setting. At this time, the indicator light of Alarm 2 on the right side lights up.

Alarm Clock Setting

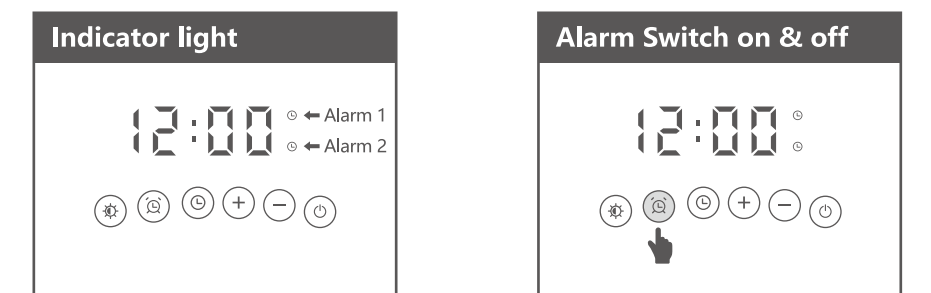

- 3 After setting the alarms, the indicator lights of Alarm 1 & 2 light up on the right side of the screen, it means Alarm 1 & 2 are switched on at the same time.
- 4 When Alarm 1 & 2 are switched on, press (alarm icon) once and the indicator light of Alarm 1 will go out, it means Alarm 1 is switched off; Press (alarm icon) again, the indicator light of Alarm 2 will light off, and it will turn off all Alarm clocks.

Alarm Clock Setting

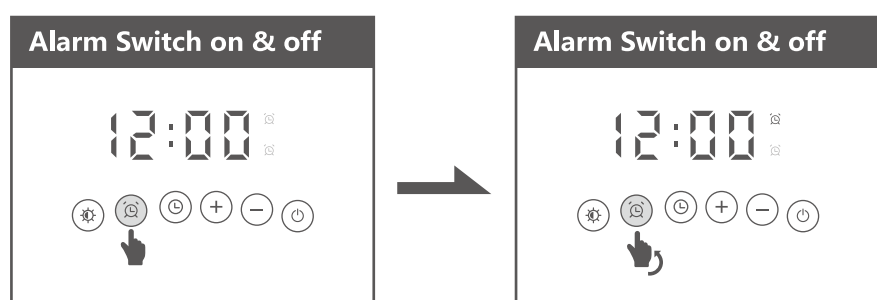

When all the alarms are off (no indicator lights on), press (alarm icon) to turn on Alarm 1 individually (number flashing), then press (alarm icon) again to confirm the setting. (Alarm 1 light on)
Press (alarm icon) again, will turn on Alarm 2 together (number flashing), then press (alarm icon) again to confirm the setting. (Alarm 1 & 2 light on)

Snooze Mode

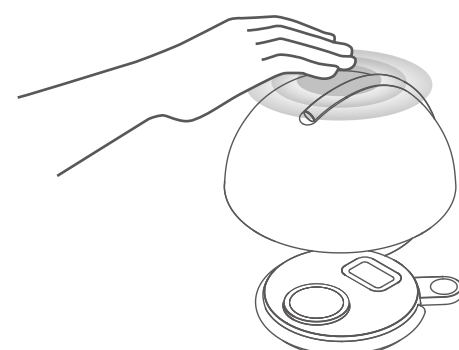

When the alarm rings, tap the top of the shade to enter snooze mode. (Alert light flashes)
Enter the Snooze mode, it will ring again at every 10 mins unless the alarm is turned off. (Automatic shut-off after 3 times)
(Short-press (power icon) to switch off the alarm.)

Compatible Devices



Other Information

- Adaptable Devices:**
- Supports communication protocols such as PD and QC 3.0.
 - Adopts magnetic suction automatic adsorption alignment for charging.
 - Performs 10W, 7.5W, 5W wireless fast charging for mobile phones that meet the Qi standard.
 - Charges 5W wireless charging devices that conform to the Qi protocol of WPC V1.3.2.
 - Supports Qi standard receivers such as TI, IDT, and PANASONIC.
- Protective Function**
- Output over-current protection
 - Output short-circuit protection
 - Output overpass protection
 - Foreign object detection
- (When the temperature is above 65°C, wireless charging functions stops working.)

Using Attention

- Do not touch the DC adapter with wet hands or charge it in a high temperature & humid environment;
- Do not use or store the product for a long time in direct sunlight or high temperature places, high temperature will affect the charging speed;
- Do not charge in places that are too close to magnetic cards, magnetic recording media, or precision instruments;
- The charging distance is 2-8mm, if the thickness reaches 3mm and above, please take out the phone case.
Product working environment temperature range: -10~60°C

Specification&Package Content

Product Size	9.4*8.7*7.9 inches
Product Weight	0.59 lb
Charging Port	Universal Type-C
Power Input	5V/3A, 9V/2A, 12V/2.5A
Power Output	Maximum 30W
Charging Power (iPhone)	10W
Charging Power (AirPods)	3W
Charging Power (AppleWatch)	2.5W

Package Content:	1 * Touch Lamp With Alarm & Wireless Charging
	1 * 1 Meter USB C Cable
	1 * 30W QC Charger
	1 * User Manual

Q&A

- Q1:** What should I do if the buttons are not working?
A1: Please re-connect the original charging cable to try, if the buttons still has problems, please contact us at service@pauchy.net
- Q2:** Why can't I charge my iPhone with the wireless charging station? Is it possible to charge my iPhone with a case?
A2: Please ensure that your iPhone supports wireless charging. This station support charging for iPhone 12 and above models. If you're unsure, please contact us for assistance. Additionally, avoid using a phone case thicker than 2mm to achieve optimal charging efficiency.

Q&A

- Q3:** Can this charging station charge iPad?
A3: Unfortunately, all the iPad models do not support wireless charging at this time.
- Q4:** How many alarms can be set at most?
A4: This lamp allows you to set a maximum of 2 alarms, and you can choose to have both alarms active at the same time or only activate one of them.

Warranty

18-Month Warranty

Need any helps, please contact us:
service@pauchy.net



Made in China
Designed in USA



Filename	User manual	Date	2023.07.31
Version	V1.4	Design	Terry

NOTE

FCC Statement

This device complies with Part 15 of the FCC Rules. Operation is subject to the following two conditions:
(1) This device may not cause harmful interference.
(2) This device must accept any interference received, including interference that may cause undesired operation.

2. Changes or modifications not expressly approved by the party responsible for compliance could void the user's authority to operate the equipment.
Note: This equipment has been tested and found to comply with the limits for a class B digital device, pursuant to Part 15 of the FCC Rules. These limits are designed to provide reasonable protection against harmful interference in a residential installation.
This equipment generates uses and can radiate radio frequency energy and, if not installed and used in accordance with the instructions, may cause harmful interference to radio communications. However, there is no guarantee that interference will not occur in a particular installation. If this equipment does cause harmful interference to radio or television reception, which can be determined by turning the equipment off and on, the user is encouraged to try to correct the interference by one or more of the following measures:

- Reorient or relocate the receiving antenna.
- Increase the separation between the equipment and receiver.
- Connect the equipment into an outlet on a circuit different from that to which the receiver is connected.
- Consult the dealer or an experienced radio/TV technician for help.

The device has been evaluated to meet general RF exposure requirement. This equipment should be installed and operated with a minimum distance of 20 cm between the radiator and your body.

深圳盛高电子商务有限公司
Shenzhen Shenggao e-commerce Co., LTD