

24 年 2 月 26 日

Antenna Specification

For official certification

Model: ERH3

Version, status:

Date: 2024-02-26

Creator: Lily_Cao

HW DM

CPM:

Function: Regulatory Certification

Change History

Version	Status	Date	Handled by	Comments
1.0	Draft	2024-01-10	Lily_Cao	Initial Draft
2.0	Draft	2024-02-26	Lily_Cao	Draft

24 年 2 月 26 日

Test Lab:

Chamber: ETS-LINDGREN AMS-8500

Test Equipment used:

VNA: Agilent Technologies E5071C

Test Equipment calibration information:

Cal Date: 2021.05.07-Loss Calibration

Test Location:

No.385, Yangguang St., Neihu District, Taipei City 114, Taiwan (R.O.C.)

Test Engineer: WenRen Lee

Chamber Axis:

24年2月26日

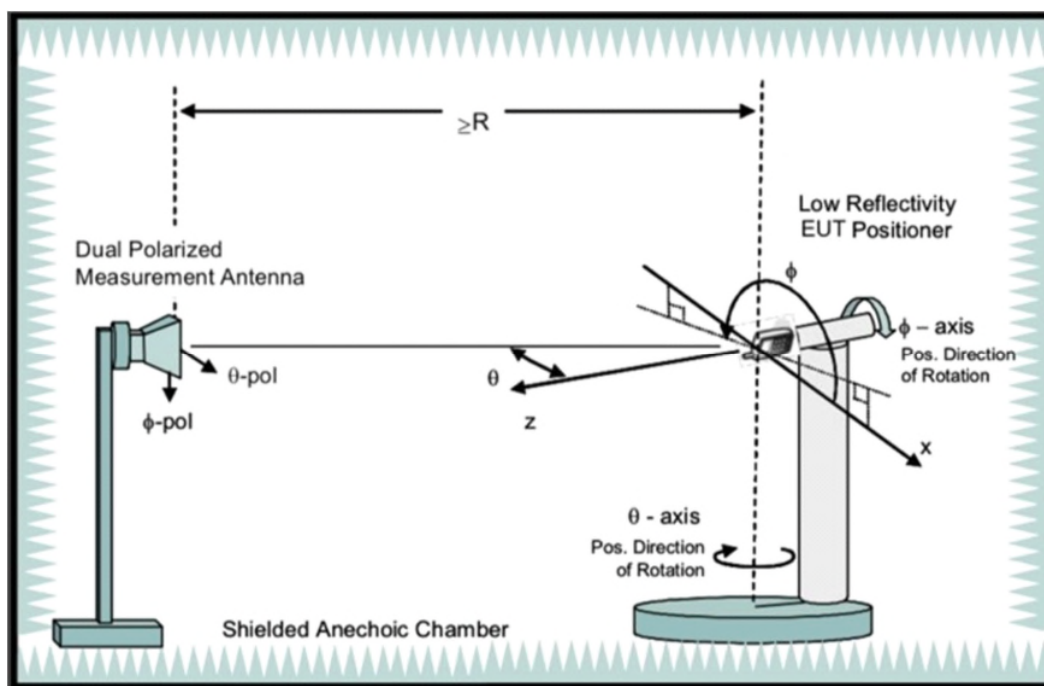

Contents

- | | |
|----------------------------------|---|
| 1. <i>Antenna Location</i> | 4 |
| 2. <i>BT Antenna Information</i> | 5 |

24年2月26日

1. Antenna Location

ERH3:

BT Antenna Location: The upper case of device

Antenna Type: PIFA antenna

2. BT Antenna Information

2.1 BT Antenna

2.1.1 Frequency: 2400-2485 MHz

2.1.2 Peak Gain: -0.6 dBi

2.1.3 Antenna Size: 9.1mm * 10.5 mm

2.1.4 Antenna Brand and Address : Chung Ting Alfa Electronic Technology (SZ) Co.,Ltd

A5-11 Huan Zhan South Road, Da Bo Industrial Park, Pok Kong, Sa Jing, Po An District, Shen Zhen, China.

2.2 Antenna Radiation Pattern

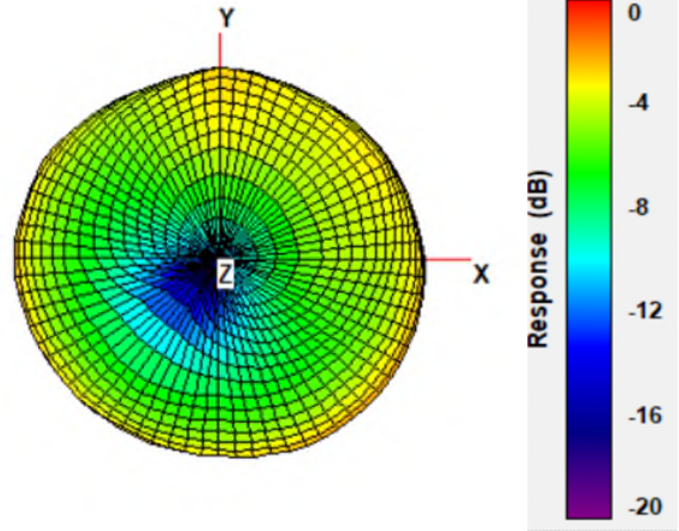
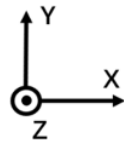
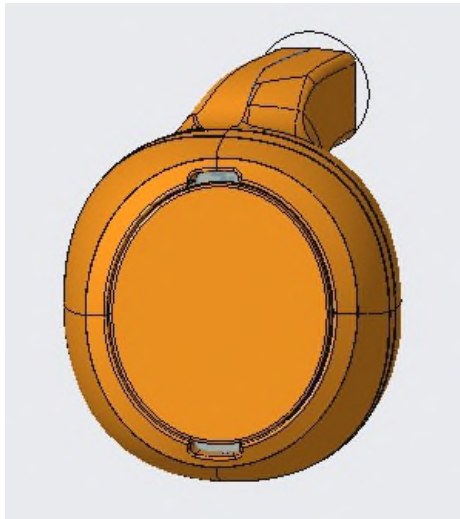

XY Plane at 2450 MHz

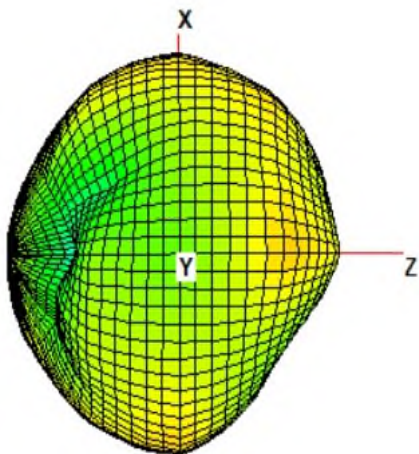

XZ plane at 2450 MHz

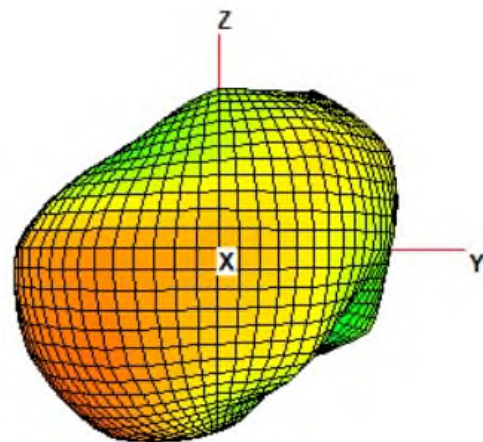

YZ plane at 2450 MHz