



使用手册

Service Manual

## statement

welcome to use our company's laptop (hereinafter simply called "This product")

Please read the manual carefully before first time installation of this product, this will favour you to get better with this product. If you operated this product according to the instruction and requirements in this specification, you operated this product because you understand other reasons, our company will not be responsible for any loss which is caused by these.

We already processed strict quality check and verification of this service manual carefully, but we can't guarantee the specification is completely correct. If you find any mistake or omission in this product service manual, please refer to the pictures not according to the actual product, then please submit to the actual products. To get better service, our company will keep right to improve and modify the described products and software which is described in this product service manual and the content of this product service manual. Please understand that we are not specially informed.

Our company will not be responsible for any data/data loss and loss which is caused by error operation of software and hardware, product maintenance in other situations, also not responsible for other indirect loss caused by these, please backup your data at any time.

The Content in this product service manual is protected by copyright law and regulations, you can't copy or record this product service manual in any method, or transmit this product service manual through internet or wireless network under any method, or translate this product service manual into any language.

To extend the working life of this product, please do best to make that continuous power on working time of this product not exceed 72 hours.

## Notices and safety warnings

1. You should read this safety and operating instruction carefully before operate and use the product. And please keep this specification for future use.

2. You should follow the warning marks in the product and this product service manual.

3. Please cut off power supply and plug the plug immediately when happen abnormal sound or smell in the machine, don't continue use after confirmed it is normal, should ask the professional staffs check and repair.

4. Please cut off the product power supply if long time not use the product, plug off the plug, cut off power supply wire and network connection in thunder rain in season.

5. Please do not use this product when thunder raining, otherwise, it may be caused product damaged by the thunder shock, need plug the power supply plug and antenna before thunder raining arrived, prevent the thunder shock.

6. Inflammable, explode, electric shock, flame, and others all can't replace on the machine or where close to the machine, avoid the machine electric accident.

7. Attention the liquid and metal enter into product body, if has liquid and metal fall into machine, never start machine to use again, should ask professional staffs handle it as possible.

8. Don't use chemical reagent to wipe the machine, the solvent may be caused machine shell to be damaged, and damage its coating surface. If has dust and dirty, then should wipe it after with dry cloth for 10 minutes later. The display screen can be light wipe by clean soft cloth. Plug out the product plug from the wall installation power supply socket before cleaning. Can't use liquid cleaner to clean agent.

9. Attention at water and moisture. Don't use this product where has water or nearby it, example: bathing pool, washing basin, kitchen, water channel, washing cloth basin, damp basement or nearby the swimming pool.

10. The equipment shouldn't have water drip or water splashing, shouldn't place the objects which full liquid like lower bottle on the equipment.

11. The plug should use the correct wiring grounding wire, but purchaser of this product should figure the power supply wire and adapter according to purchase requirements, if the end users can't use this product because different specification of power supply wire and adapter, please directly contact your supplier.

12. The grooves and tapping on the equipment as air venting performance, guarantee the product reliable running and prevent overheating. The air venting holes can't be covered by the objects like newspaper, tablecloth, curtain and others to impede air venting. Should guarantee there is a certain clearance around the product for air venting completely.

13. This product only can use the power supply type and power supply which marked in the accessories of this product to supply power. If you are not clear at the power supply type and voltage in your home, please contact the product seller or local supply power company.

14. The power supply cable in this product accessories is three insert power supply wire (with grounding protection)/ please confirm the grounding end grounding well at the wall socket. Should avoid the passageway when lay out the power supply wire, avoid step by people, also should avoid where squeezed by other objects.

15. Forbid to push any type various into this product through any tapping, otherwise, they maybe touched dangerous voltage points or extrude parts, maybe caused fire or electric shock.

16. Don't self repair this product freely. Self open or disassemble the cover and this maybe make you face dangerous voltage or other dangers. Please contact the manufacturer appointed maintain staffs handle it if has any maintain matters.

17. Should follow the operating instruction of manufacturer to install this product, and only can use the installation fittings which recommend by manufacturer.

18. The important content in the exclamatory mark on the back of the plate means: must stand on you use the components which stipulated in the safety test documents to renewal if need renewal the important safety stipulated components (the component has this symbol beside the component some electric circuit board) during maintain, finish same components to renewal then please ask from manufacturer.

19. The type equipment can touch electric conduct parts and protection ground in go outputs socket should reliable connect with the protection ground in the equipment.

20. The minimum working environment temperature of the computer must be above 20°C. Working in an environment below 20°C will cause permanent damage to the battery. The battery cannot be charged or even short-circuited.

21. This product is sold without a power adapter. If you use a power adapter for power supply, you should purchase a power adapter that has obtained CCC certification and meets the standard requirements.

## products summary and function

Product overview and functions

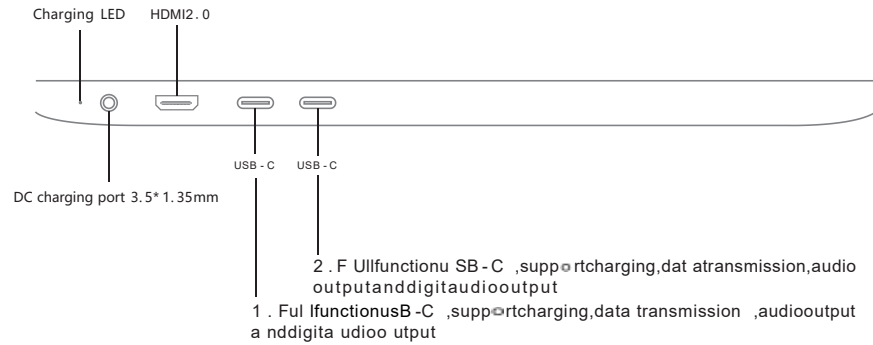

Matters needing attention;  
Do not use DC adapter with Type-C adapter

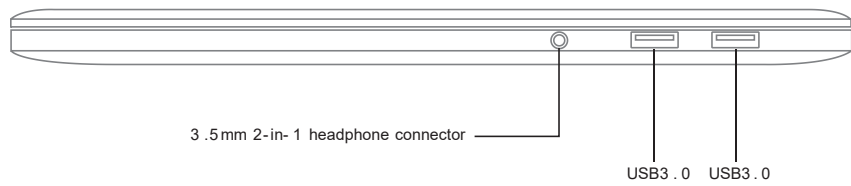

Note :partialproducts j oggles haved ifferece

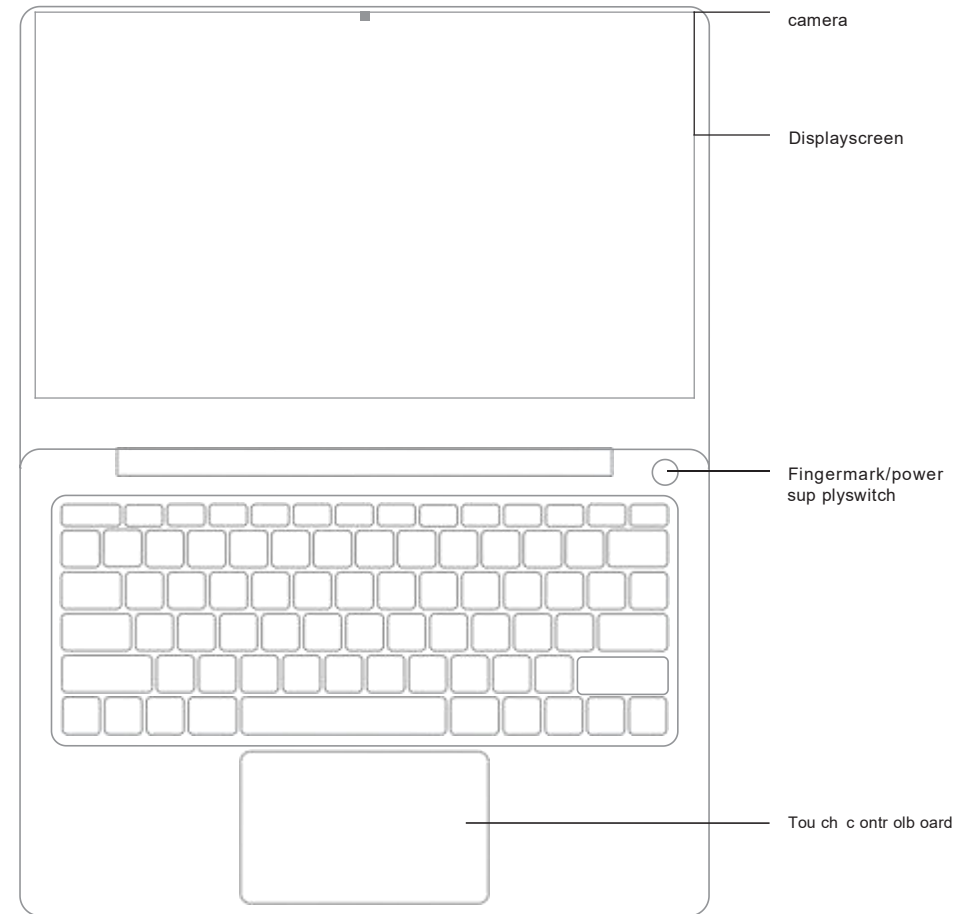

# Fn assembly keys instruction

Fn key used to assemble the keys used at the special start and close functions. The detail assemble and realized functions are listed in the table below:

keys	Function instruction	keys	Function instruction
Fn + F1	sleeping	Fn + F2	Increase volume
Fn + F2	Reduce LCD display screen luminance	Fn + F3	keyboard backlight adjustment
Fn + F3	Increase LCD display screen luminance	Fn + F10	Run Calculator
Fn + F4	outer corner indicator display mode	Fn + F11	Enter mail
Fn + F5	Touch screen board start and forbid touch	Fn + F12	Open Settings
Fn + F6	Mute mode	Fn + Q	Switch working mode: 1. Energy saving mode Default settings 2. Balanced mode 3. Performance mode
Fn + F7	Reduce volume		

**Warmly reminding:** maintenance of keyboard: clean the keyboard always according to the dust after a long time use keyboard, clean the keyboard with a soft brush, clean the gaps, or use the high pressure spray which has clean camera lens to blow out the dust, or use the hand type vacuum cleaner to clean the dust and chips on the keyboard. Clean the keyboard with a soft cloth to clean the keyboard surface, lightly wipe the keyboard surface under power off situation.

## Fingermark setting

press down start → setting → account → login options (must prior to set password) → window shell of fingermark (the highest can set 10 pieces fingermarks) → set PIN after finished (support English + digit assembly, complete numbers above 4 bytes)

## Touch screen board operating gesture



Single finger singly click, double click touch screen, equal to the function of mouse left key.



Double finger singly click touch screen, equal to right key of mouse, pop out selection menu.



Double fingers upward/downward sliding touch screen, realize that screen scrolls, equal to the role of mouse.



Double fingers right/left sliding touch screen, realize that screen scrolls, the function of leftward or rightward sliding pictures.



Double fingers sliding together to close or open opposite angle line at the same time, realize that the picture/page is reduced or enlarged.

## About operating, maintenance and maintenance

Please contact the product support when the product is out of work for a long time, to extend the product working life.

Please close the whole machine according to the normal power off procedure when out of use the interior configured computer, don't illegally power off the machine, also don't plug the power supply directly, to guarantee the stability of the product system.

Please don't open the back cover of the product if not professional staffs, avoid damage to the product self-damage to human body safety, please contact your distributor to handle the product problem.

Please don't add any accessories which are not on the product or the accessories which are specially designed for this product;

Never touch the power supply wire and signal cable when thundering and lightning, this may be a serious danger, it may cause electric shock, if possible, please don't use this product when thundering and lightning.

Please confirm the product is ready fixed well when installing, avoid the product is not installed properly, please do not install this product where children can't touch;

Please avoid other objects into the product shell, some interior space with dangerous high voltage;

Please far away from the product, please don't install this product near the heat radiator or heat radiation source;

This product belongs to the heat generating products, please guarantee the product in the relative air venting space when using, please don't block the heat radiation hole of the product, may be caused by product failure because of accumulated too much heat;

This product needs to be cleaned during operation, generally, one time clean each 5-7 days, the detail frequency according to the use environment;

Please plug the product power supply first when cleaning, the clean the product surface, please don't use wet cloth to clean the product back, please don't directly use the fog on the product display screen, because too much fog may cause electric shock;

Please use soft cloth to wipe the product to prevent scratches when cleaning, don't use chemical products like benzene, cleaning materials thinner and ethyl alcohol to clean.

Please 2-3 times spray water on the soft cloth when clean the product, then wipe the product in one direction, please pay attention to the direction of the cloth, to avoid the product will be discolored.

# Accessories and environment protection instruction

specially reminding:

The below accessories list is product standard configuration list, if order has special requirements then subject to the detail requirements, we will not process further or inform of our product's accessories has modification.

S/N	Name	Quantity	specification
1	service manual and maintenance warranty card	1 set	
2	Qualified certificate	1 piece	
3	power supply connector	1 piece	1.8m
4	power supply adapter	1 piece	

## product poisonous matters or elements name and content table:

component name	Harmful matters					
	Lead (pb)	Mercury (Hg)	Cadmium (cd)	Hexavalent chromium (Cr6+)	polybrominated biphenyl (PBB)	polybrominated diphenylethers (PBDE)
Printed circuit board	x	■	■	■	■	■
Hardware driver	x	■	■	■	■	■
Display screen	x	■	■	■	■	■
Outer shell	x	■	■	■	■	■
Battery	x	■	■	■	■	■
Keyboard	x	■	■	■	■	■
Loudspeaker	x	■	■	■	■	■
Heat radiation module	x	■	■	■	■	■
Microphone	x	■	■	■	■	■
Wi-Fi module unit	x	■	■	■	■	■
Adapter	x	■	■	■	■	■

Draw up this table according to the stipulated in SJ/T 11364-2014.

o: means the content of this harmful material in all quality materials of this component fully under the stipulated limit requirements in GB/T 26572.

x: means the content of this harmful material at least in one or more quality materials of this component exceed the stipulated limit requirements in GB/T 26572.

This environment protection time limit means that under normal operating conditions, the harmful materials or elements which contain in portable computer (with battery) and the accessories will not leak, and will not cause serious pollution or harm to human body, properly when the electric information product users using this product.

## problem solve methods of simple failure

specially reminding:

Please check the below table before preparing to repair, check whether you can find the failure reason. When confirmed that complete operation according to this service manual still can't solve the problem, then please contact the product service center to process product repair.

Laptop system failure	
Appearance	Solve methods
No image and no voice	1. Check whether AC power supply wire is normally connected, whether product normally supply power.
	2. Check whether the status indicator lamp of power supply adapter lighting, if not lighting then means adapter failure or AC power supply not connected well.
No image and no voice	3. Confirm the product under the working status, not under the standby status.
	4. If above all can't solve the problems, please long time press the power supply key about 10s for reset power off.
No image and no voice	1. Check whether the system volume is turned on.
	2. Check whether the system volume is turned on.
	3. If the external configured equipment then check whether the input wire of external equipment are normal.
Sound image disturbed	1. Confirm whether the external electricals around the product which can affect the product and make it faulty product.
	2. Renew the socket of product input, confirm whether the external is disturbed.
Unable to start machine	1. Check whether the power system is normal.
	2. Check whether the power supply switch is jammed, unable to press it.
	3. If above all can't solve the problems, please long time press the power supply key about 10s for reset power off.

## Technical instruction:

The ironware structure parts, plastic injection parts and most of the electrical parts of this machine accordance with China and EUROHS requirements, only few parts limited by the technical level in the world, maybe affected the reliability of products so temporarily not realize that replace the poisonous and harmful matters or elements, please satisfied to use, it will not affect the health under the normal use environment.



This mark is environment protection and limit marks (time limit in years). The poisonous and harmful matters or elements contained in the electronic information products will not leak or emit, and the time limit for users to use the selected electronic information product will not generate serious pollution or seriously affect their health and property.

This product can realize zero energy consumption status under the situation that no external power supply is provided.

Reminder: Instructions from waste electrical products retrieval and handling management regulations:

Please follow national laws related to waste electrical products retrieval and handling when users need to stop working or if this product is delivered to the local factor which has national authorized retrieval and handling qualification to retrieve and handle.

## Quickly entry level

Please pay attention: strongly advise you to connect the AC adapter and use the AC power supply when first time use this laptop. Start charging battery once connected AC adapter.

Not please: authorized AC adapter in the package box used by your laptop, if use the other type adapter may be damaged the laptop or other equipment which connected with computer.

## start machine setting

Set the system according to the below steps after pressing power supply key (all will have load time after each one time setting, please be patient and guarantee that correct connection of the adapter to avoid enough power):

1. start machine will occur the loading interface

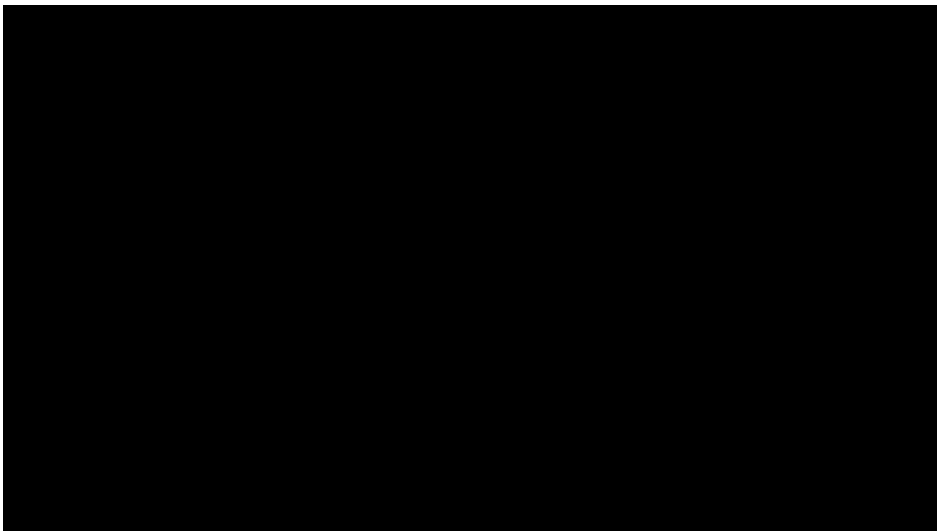

2. Enter into language selection interface, select the system language which you required

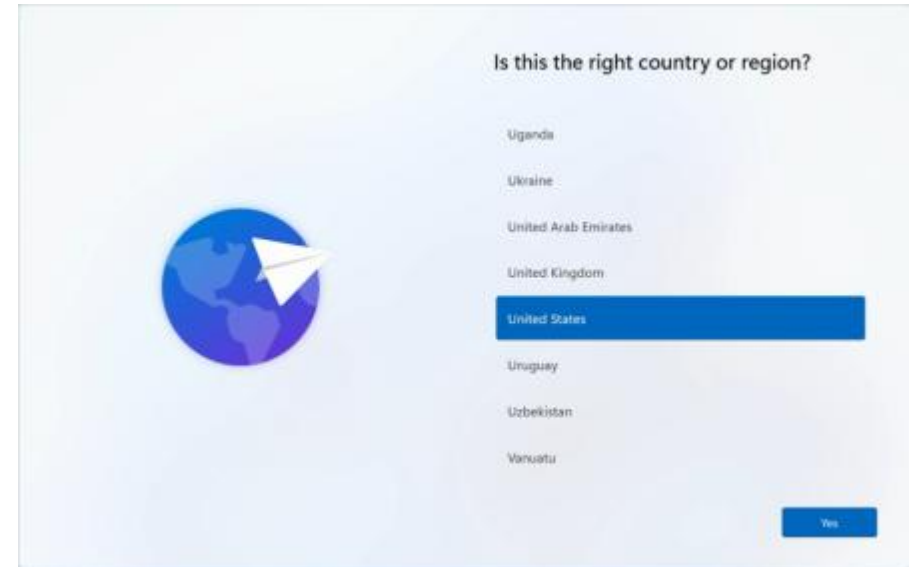

3. Operate according to system reminding, set your own area and input language

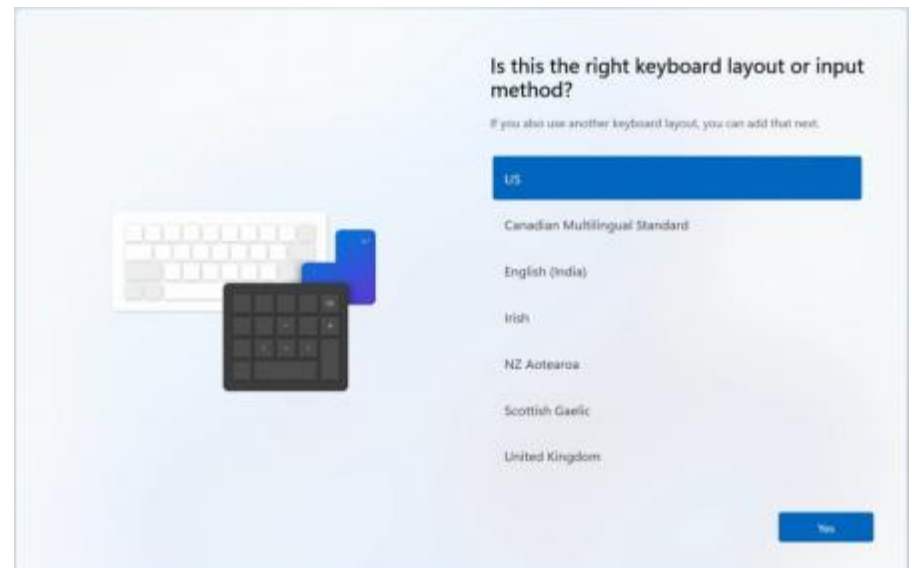

### 3.2、 Add keyboard layout select “ skip ”

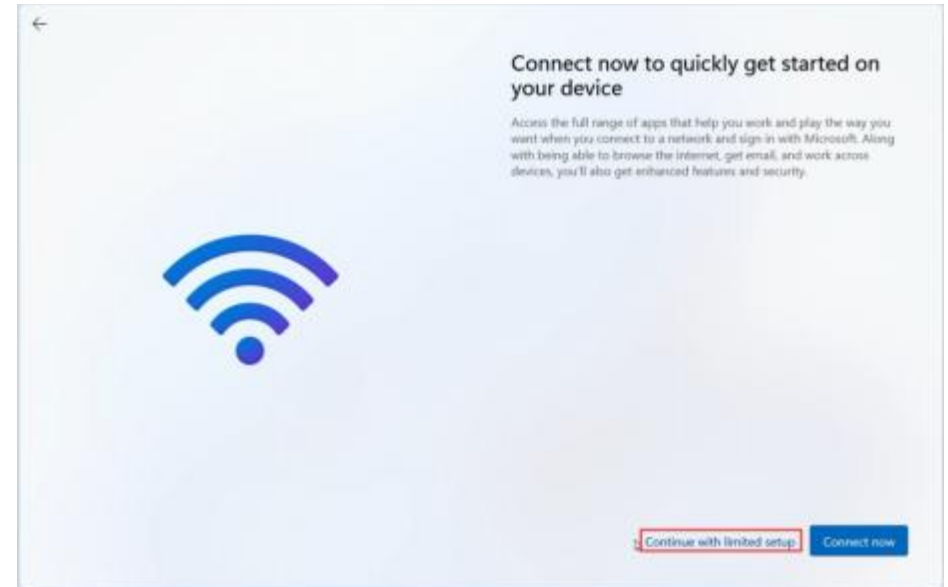
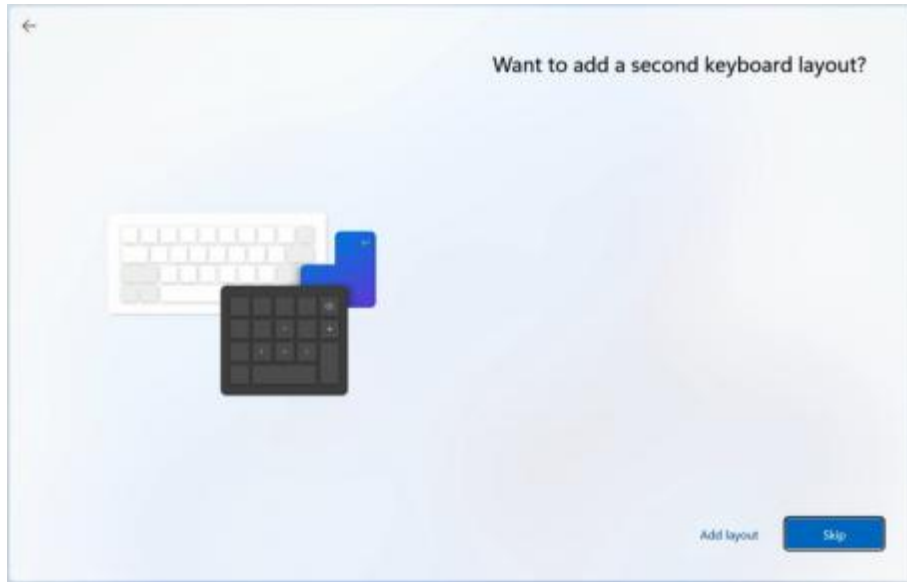

5. Please read and accept the terms of the Microsoft Windows license agreement carefully (if you need to use the windows operating system, you must accept it before entering the next step. This term has nothing to do with the company, and is provided for the official Microsoft operating system)

### 4、 Select " I don't have Internet ”

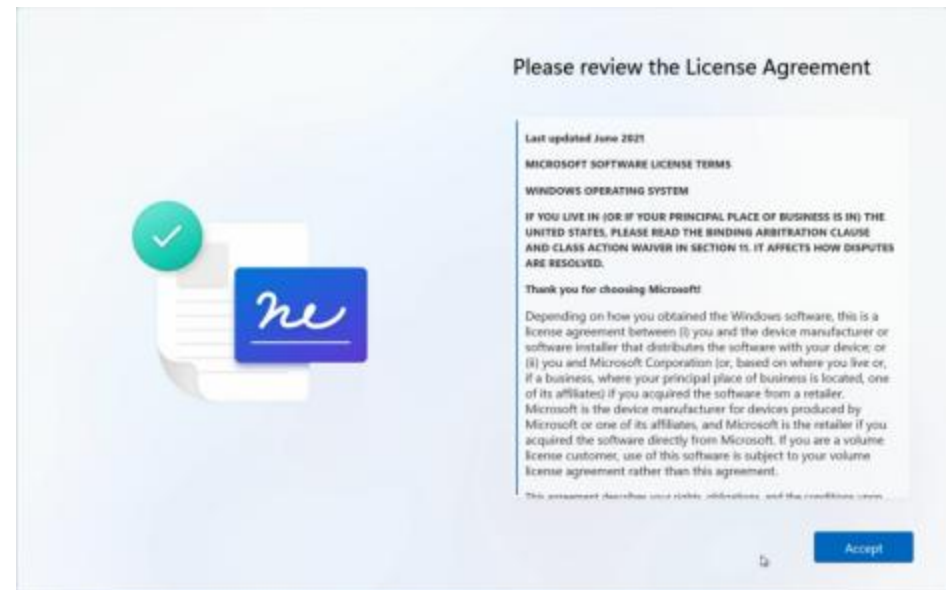
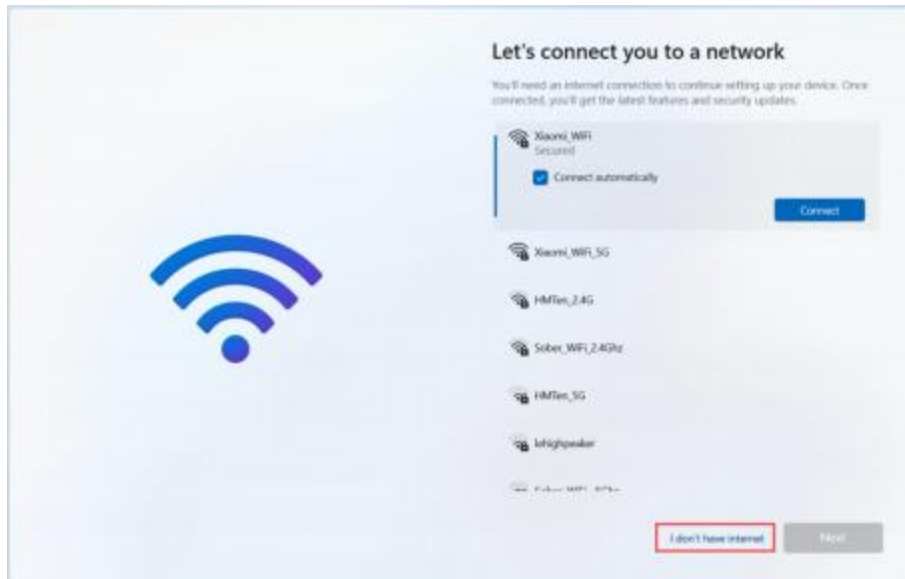

6. Set your account name (you must create an account, otherwise you cannot go to the next step)

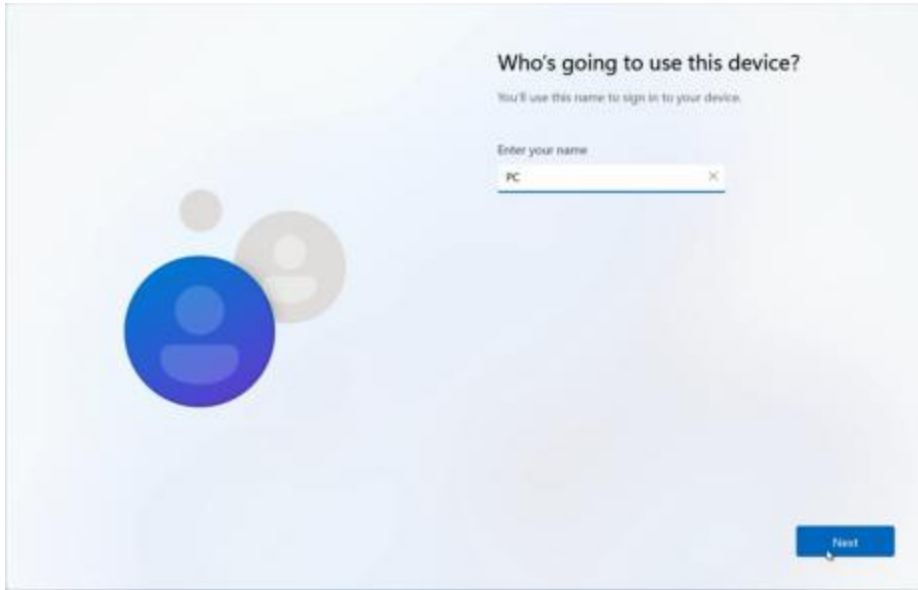

7. Enter the account name after the need to create a boot password you can choose to enter you can also choose to click next/skip

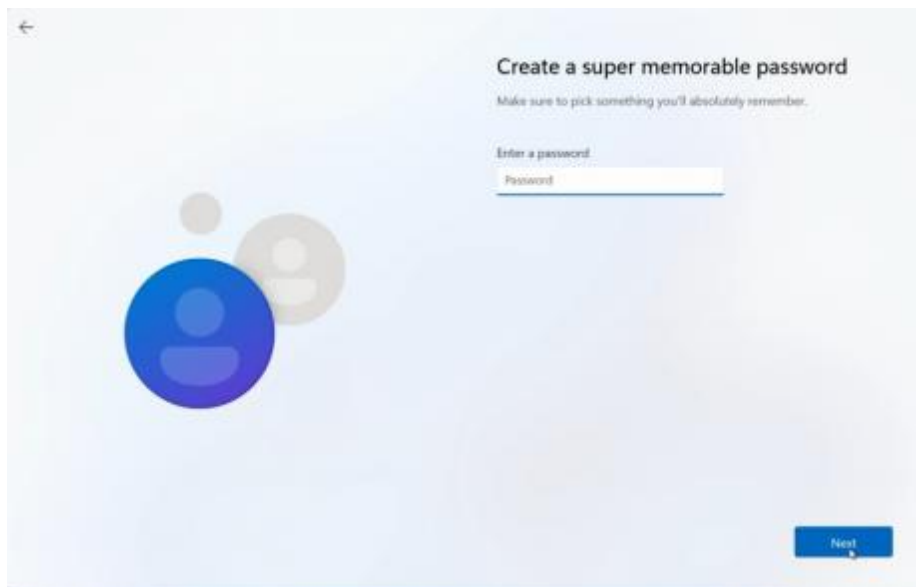

8. The next step according to the operation on the display screen then can enter into the system smoothly

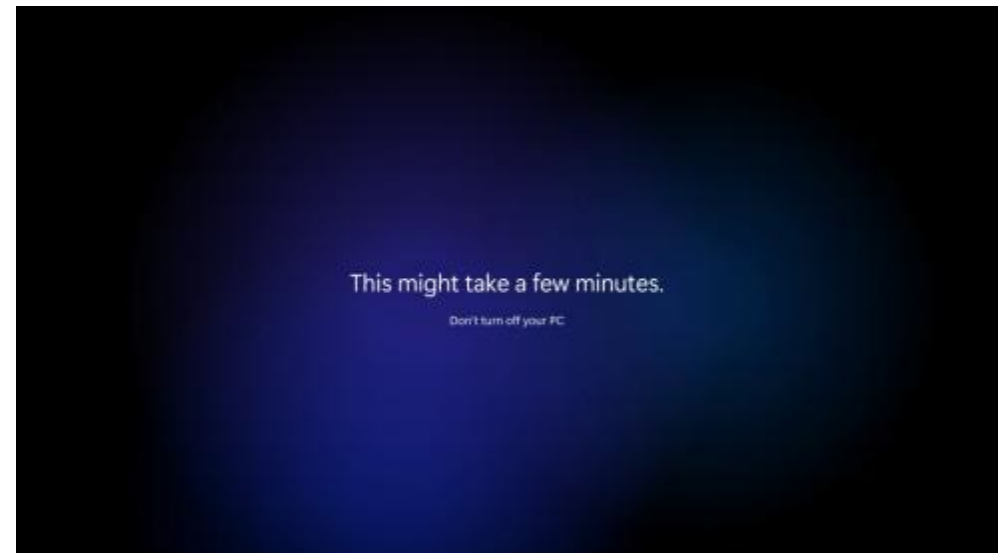
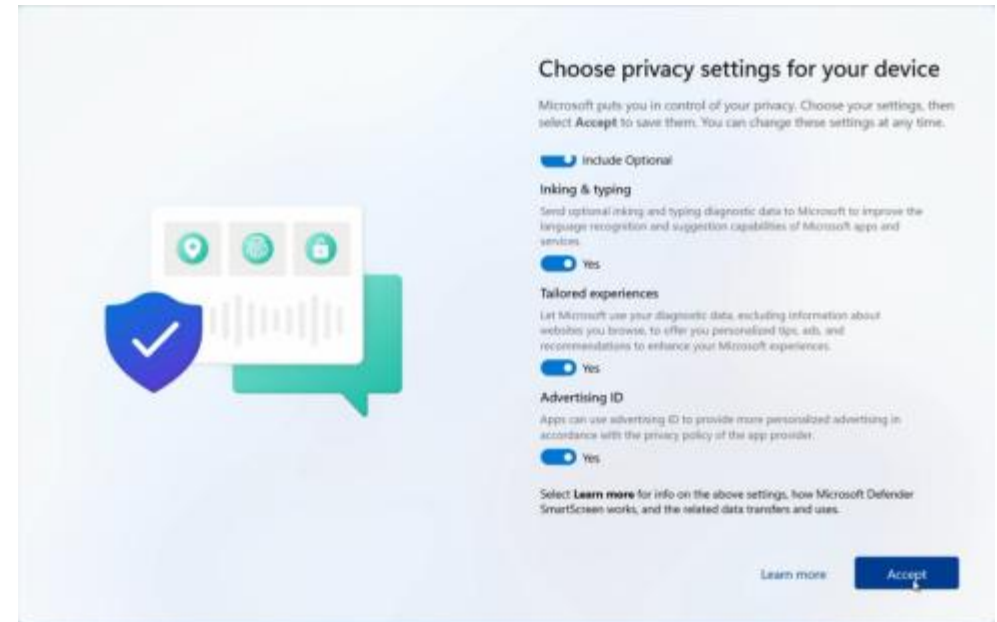



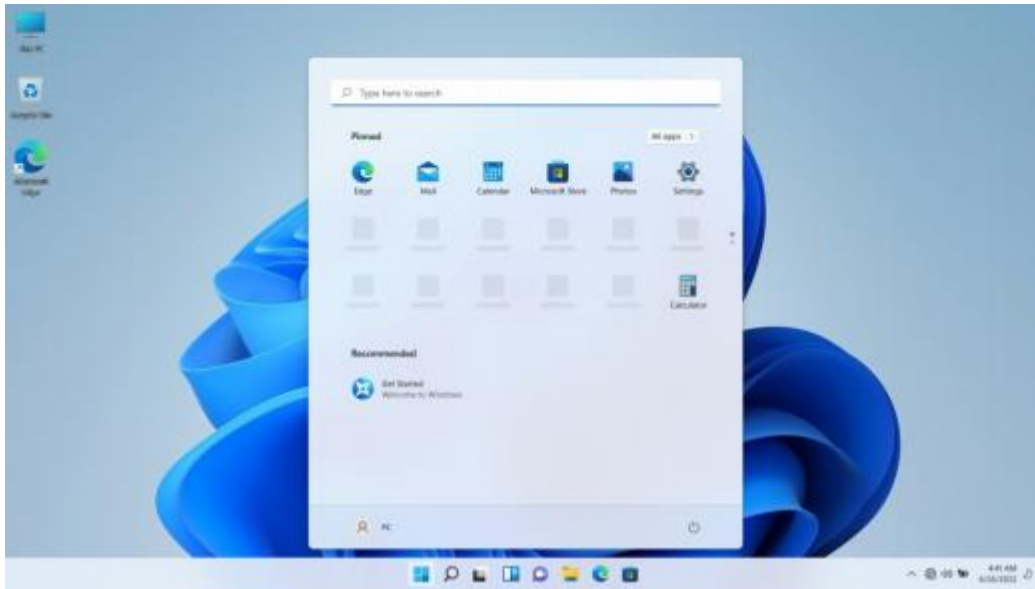

Attention: the time of the whole system start-up process needs 10-20 minutes, remind you to wait patiently again, keep the adapter correctly connected and charge the computer as soon as possible to avoid power affecting system loading.

# Fingerprint recognition settings

1. Go to Windows 10 Settings (Win+I) and select Accounts

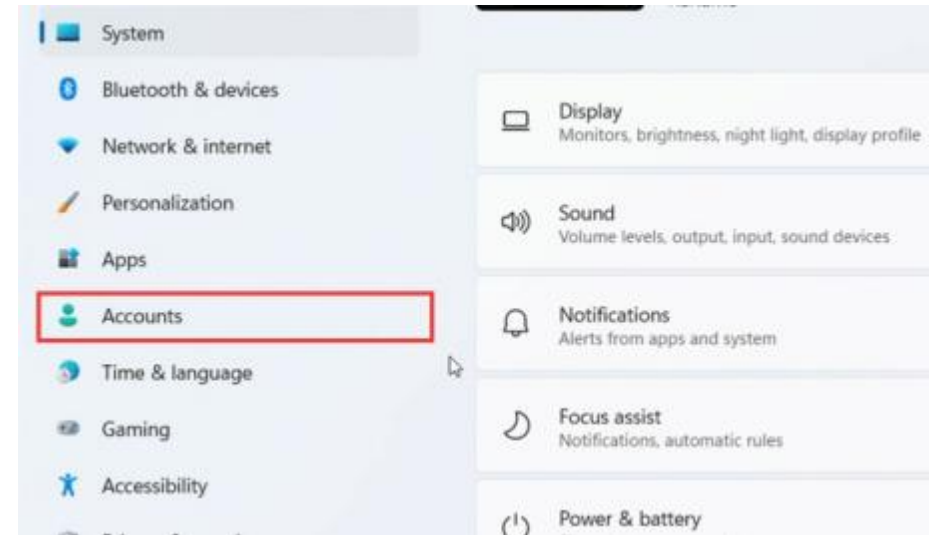

2. Go to Account options and select Login options

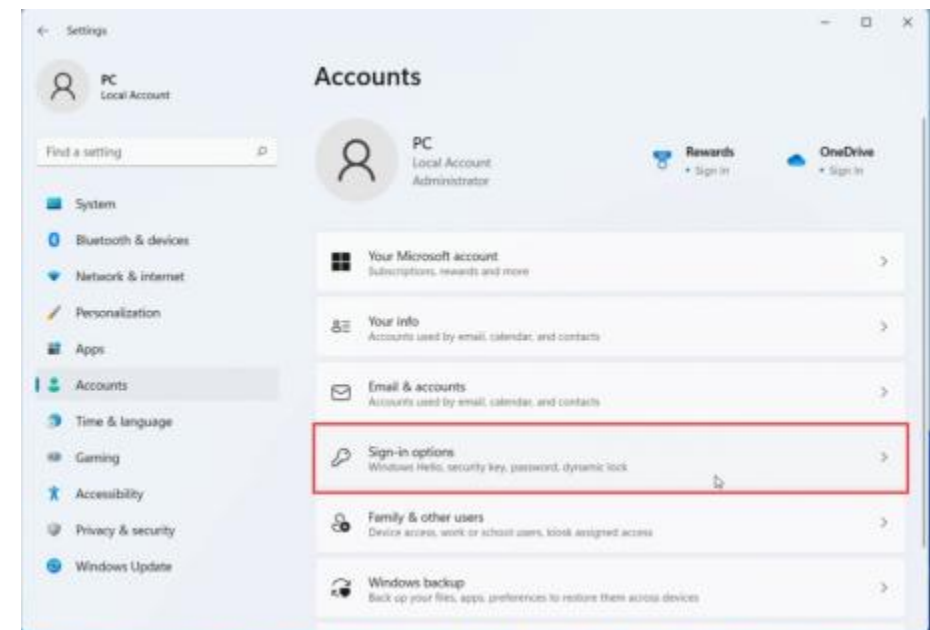

3. In the eLoginoption screen ,setpassword"frst .Tip: F nigerprintcan notb e setw ithoutapasswordfirst

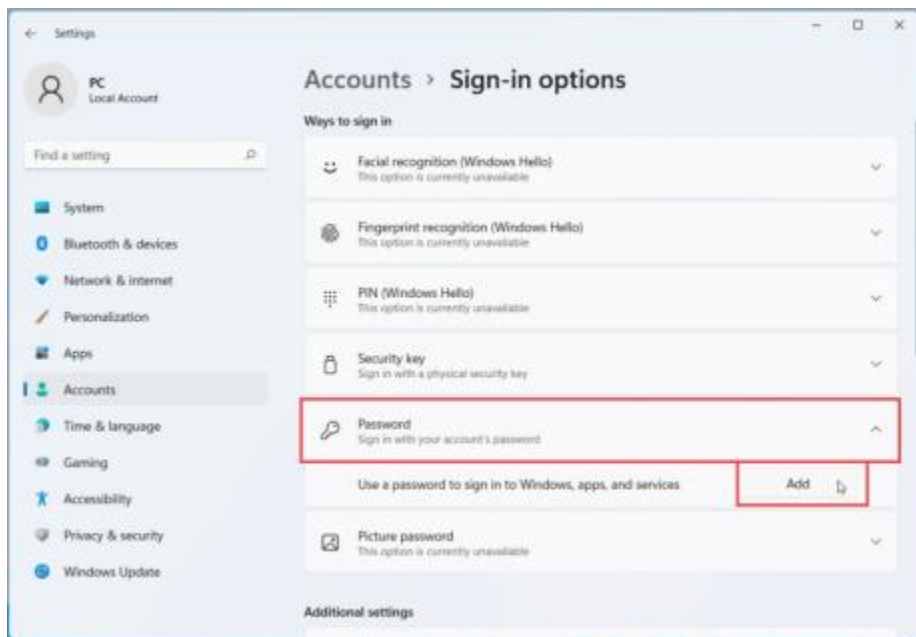

5. Enter the settings screen and select start

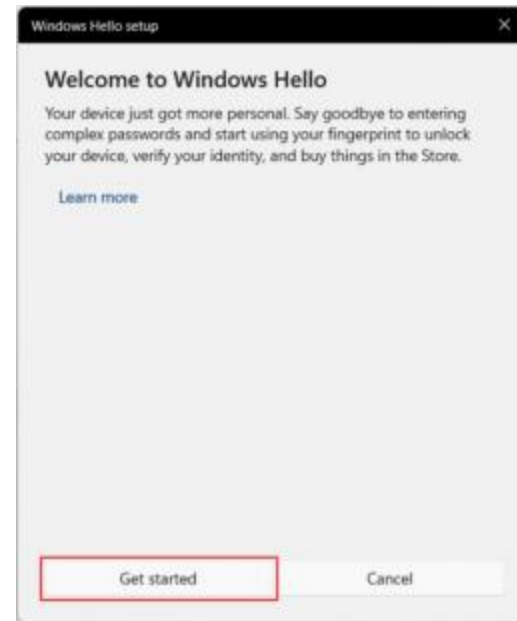

4. Enter the password setting interface ,and select the fingerprint setting in the "Account" page after setting the password

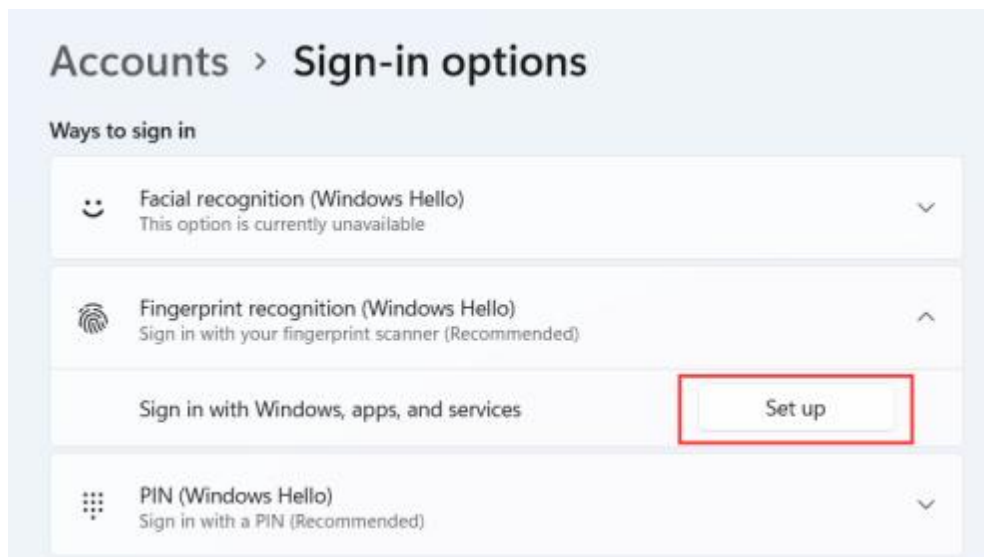

6. Input fingerprint page ,need to press input fingerprint ,not slide

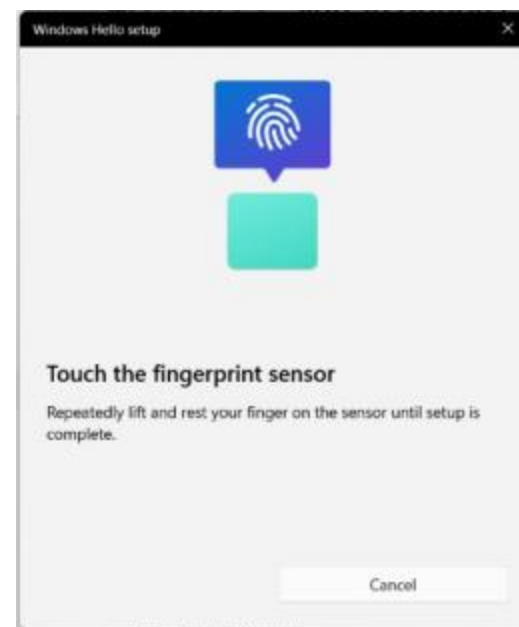

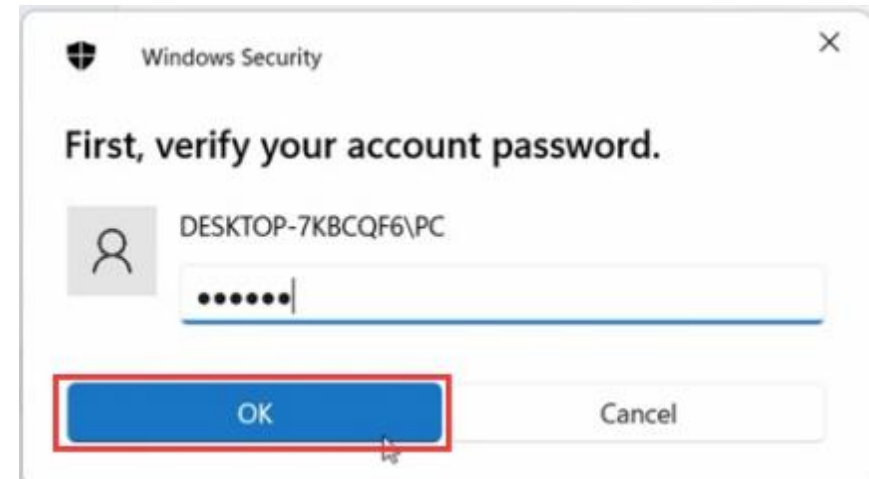
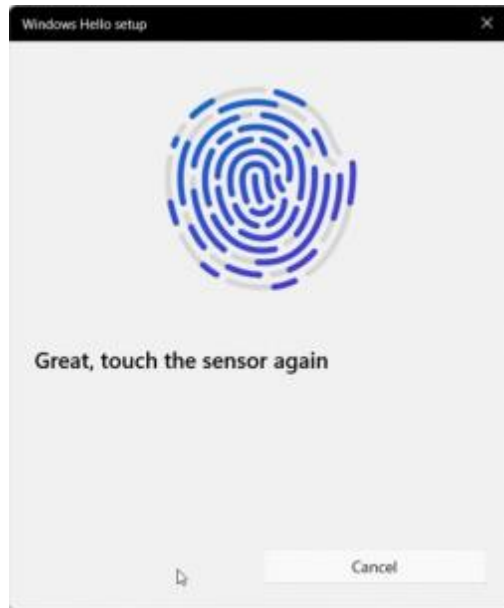

7 .After entering the fingerprint, enter the "setPIN" page and set the password according to the PIN requirements. The setup is complete and indicates that everything is ready.

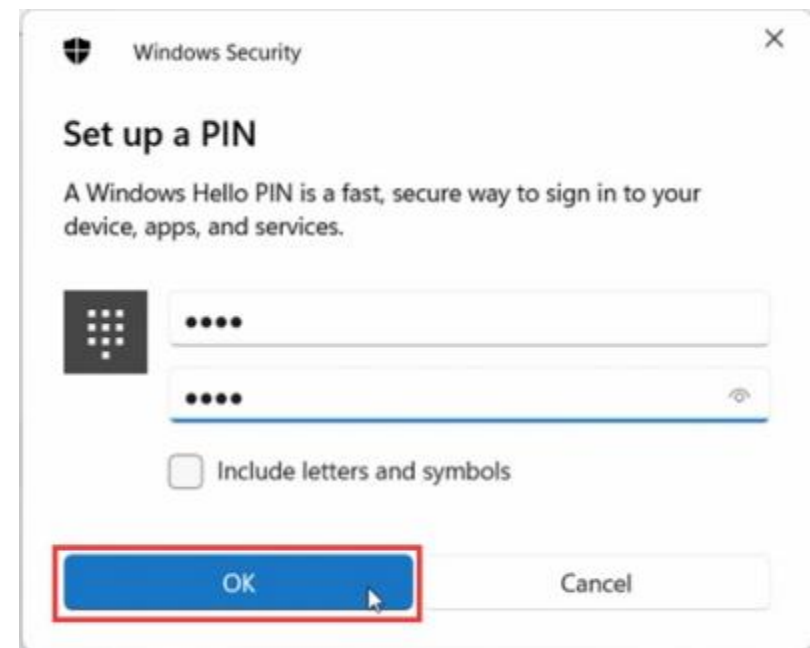
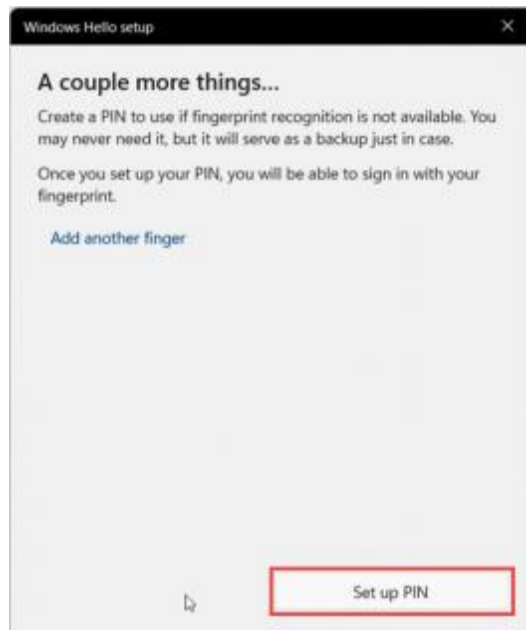

# warrantyperiod

## Warranty certificate:

The purchase invoice and the three-guarantee certificate are the guarantee certificates that you can normally enjoy the national "three-guarantees" and standard services. Please keep them properly and show them to our certified service agencies when you need services.

## Note:

The purchase invoice must be a formal invoice recognized by the national taxation department.

## Warranty start date:

The warranty start date of the Raytheon Gaming computer is subject to the purchase date indicated on the purchase invoice. If you cannot present a valid purchase invoice and three guarantees certificate, or the information recorded in the above warranty certificate does not conform to the product, or is altered or illegible, the "three guarantees" period and free repair period of the product will be based on the product One month after the production date is calculated as the warranty start date. If valid product delivery information is not available, we will not provide free warranty service.

## Parts warranty duration:

Refer to the "Three Guarantees" for the agreementofthemaincomponents.

Notebookparttype	penpartname	warrantyduratio
Maincomponents	Motherboard	2 years
	CPU	2year
	LCD Screen	2year
	RAM	2year
	Harddrive	2year
	poweradapter	2year
	keyboard	2year
	Graphics card (discrete graphics card)	2year
otherparts	Optical drive, shell, booster board, touch pad, mouse button board, touch pad to motherboard cable, screen cable, camera camera cable, wireless network card, battery, fan	1 years
Attachment	Random accessories (CD, power cord, etc.)	3months
	Laptopbag	N/A
software	pre-installedsoftware	1year
	Random software	3months

**Note:**

The parts mentioned in the warranty period table should not be understood as a commitment and description of the configuration of the product you have purchased, and the product configuration should be based on the specific model you purchased and the packing list shall prevail.

**Pre-installed software:**

Pre-installed software refers to the operating system software that is bundled with the product and installed before the product leaves the factory.

**Random software:**

Random software refers to the software sold with the product as a part of the product. Generally refers to the product's driver, and the accompanying software will vary from product to product.

**warrantyperiodafterrepair**

Products and parts within the scope of this warranty clause will continue to enjoy the promised service within the term promised in this warranty clause after being repaired by a Manufacturer-certified service organization; if repaired parts are repaired from the date of repair, this warranty If the end of the service period promised in the clause is less than three months, the service period of the component will be extended to three months from the date of repair (only applicable to components with a free warranty period of one year or more).

At that time, please provide a valid maintenance record.

**FCC WARNING:**

This device complies with part 15 of the FCC Rules. Operation is subject to the following two conditions:

(1) This device may not cause harmful interference, and (2) this device must accept any interference received, including interference that may cause undesired operation.

Note: This equipment has been tested and found to comply with the limits for a Class B digital device, pursuant to part 15 of the FCC Rules. These limits are designed to provide reasonable protection against harmful interference in a residential installation. This equipment generates, uses and can radiate radio frequency energy and, if not installed and used in accordance with the instructions, may cause harmful interference to radio communications. However, there is no guarantee that interference will not occur in a particular installation.

If this equipment does cause harmful interference to radio or television reception, which can be determined by turning the equipment off and on, the user is encouraged to try to correct the interference by one or more of the following measures:

—Reorient or relocate the receiving antenna.

—Increase the separation between the equipment and receiver.

—Connect the equipment into an outlet on a circuit different from that to which the receiver is connected.

—Consult the dealer or an experienced radio/TV technician for help.

Note: The Grantee is not responsible for any changes or modifications not expressly approved by the party responsible for compliance. such modifications could void the user's authority to operate the equipment.

The device has been evaluated to meet general RF exposure requirement.

This equipment complies with FCC's RF radiation exposure limits set forth for an uncontrolled environment. This device and its antenna(s) must not be co-located or conjunction with any other antenna or transmitter

## 声明

欢迎使用本公司的笔记本电脑（以下简称“本产品”）

在第一次安装和使用本产品之前，请您务必仔细阅读随机配送的所有资料，这会有助于您更好地使用本产品。如果您未按本使用说明书的说明及要求操作本产品，或因错误理解等原因操作本产品，本公司将不对由此而导致的任何损失承担责任。

本公司已经对本产品使用指南进行了严格仔细的校勘和核对，但我们不能保证本使用说明书完全没有任何错误和疏漏。本产品使用指南中的图片说明仅供参考，如果有个别图片说明与产品的实际显示不符，请以产品实际显示为准。为更好地提供服务，本公司保留对本产品使用指南中描述的产品和软件程序以及本产品使用指南的内容随时进行改进和修改的权利，恕不另行通知。

本公司对于因软件、硬件的误操作、产品维修或者其他情况引起的数据资料丢失和损失不负任何责任，也不对由此造成的其他间接损失负责，请随时备份您的数据资料。

本产品使用指南内容受著作权法律法规保护，未经本公司事先书面授权，您不得以任何方式复制、抄录本产品使用指南，或将本产品使用指南以任何形式在任何有线或无线网络中进行传输，或将本产品使用指南翻译成任何文字。

为延长产品的使用寿命，产品连续上电工作时间请尽量不要超过72小时。

## 注意事项及安全警告

注意：请仔细阅读本说明书并将其置于随手可得的地方。请严格遵循下列安装与操作注意项

- 1.在操作、使用产品之前，应认真阅读该安全与操作说明。并请保留该说明书，以备使用。
- 2.应遵循产品与产品使用指南中的所有警告标志。
- 3.当机内发生异常声音或气味时，请立即关闭电源并拔掉插头，经确认为异常时，不要继续使用，应请产品维修人员检修。
- 5.如长时间不使用产品，将产品电源关闭，拔掉电源插头，雷雨季节时需断开电源线及网线的连接。
- 6.雷雨时尽量不要使用本产品，否则可能会因为雷击造成产品的损坏，在雷雨未到之前就要拔掉电源插头和天线，以防雷击。
- 7.易燃易爆物，电炉、灯泡等均不能放在机器上和接近机器的地方，避免机器出现意外。
- 8.小心液体、金属进入产品体内，如有液体、金属掉入机内，一定不能再开机使用，应尽快请专业人员处理。
- 9.不能用化学试剂擦拭机器，溶剂可能会使机壳变质，以及损坏其涂漆面。如有灰尘污垢，应在关掉产品十分钟后用湿布拧干后擦拭。显示屏可用干净软布轻轻擦拭。清洁前，将产品插头从壁装电源插座拔出。不得使用液体清洁剂或气雾清洁剂。
- 10.注意水与潮气。不要在有水的地方或附近使用本产品，例如：浴池、盥洗盘、厨房、水槽、洗衣盆、潮湿的地下室或游泳池附近。
- 11.设备不应遭受水滴或水

本产品不带电源适配器销售，若使用电源适配器供电，则应购买配套使用获得CCC认证并满足标准要求电源适配器，本产品适用于非热带气候条件下安全使用。

- 13.设备上槽位与开孔起通风作用，以确保本产品可靠运行，并防止过热。通风孔不应覆盖诸如报纸、桌布和窗帘等物品而妨碍通风。为了充分通风，应保证产品周围有一定间隙。
  - 14.本产品只能使用厂商注明的电源类型和电源电压供电。如果您对家里的电源类型及电压不确定，请联系产品经销商或当地的供电公司。
  - 15.本产品附件中电源线为三插电源线（带接地保护），安装时请确认墙面插座的接地端接地良好。电源线布线时应避开通道，以免被人踩踏，也应避开被其它物品挤压的地方。
  - 16.禁止通过任何开孔将任何类型的杂物推入本产品，否则它们可能会接触危险的电压点或突出部件，可能会导致火灾或电击。
  - 17.不要擅自维修本产品。擅自打开或拆卸盖子可能会使您面临危险的电压或其它危险。如有任何维修事宜，请联系制造商指定的维修人员处理。
  - 18.安装本产品应遵循制造商的操作说明，并且只能使用制造商推荐的安装配件。
  - 19.后铭牌上有感叹符号的重要内容是指：如果在维修中有需要更换重要安规元器件的（电路板上元器件旁边有此符号的元器件）必须只能使用安全测试文件中规定的元器件来更换，如果没有相同的元器件更换请向生产商索要。
  20. I类设备可触及导电零部件以及输出插座的保护接地应可靠地与设备中的保护接地端子连接。
  - 21.本产品最低工作环境温度必须在20℃以上，低于20℃会对电池造成永久性损伤，导致电池无法充电甚至短路。
-

## 产品概述与功能

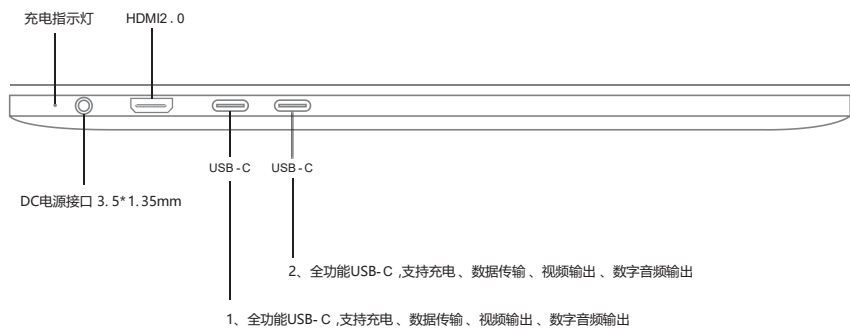

注意事项;  
请勿DC适配器与Type-C适配器同时使用。

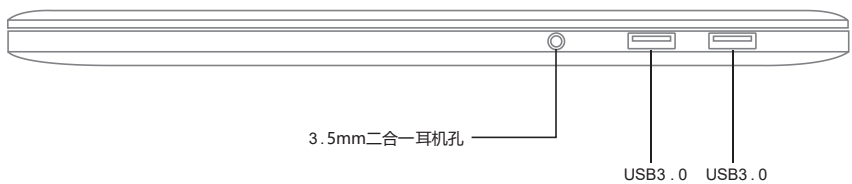

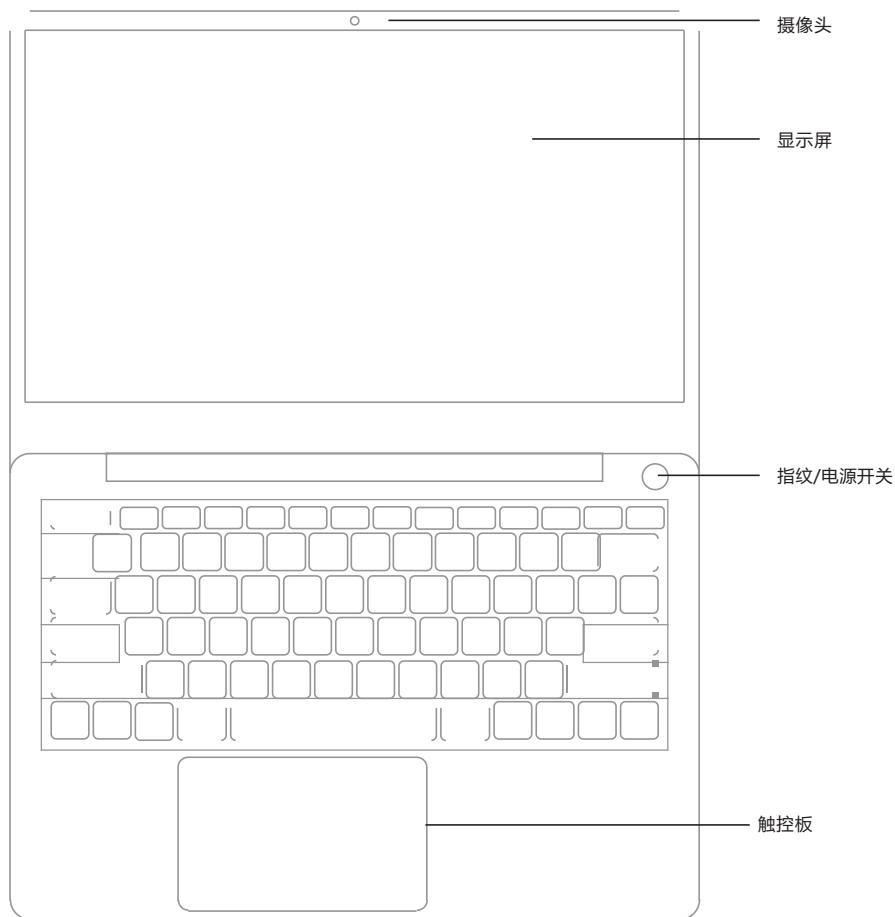

注：部分产品接口有所差异



## Fn组合键介绍

 键用于与其他按键组合使用，用于开启和关闭特定功能。具体组合及实现功能见下表：

按键	功能说明	按键	功能说明
	睡眠		增大音量
	降低LCD显示屏亮度		键盘背光调节
	提升LCD显示屏亮度		计算器
	外接显示器显示模式		运行邮件
	触摸板开启和禁用		打开设置
	静音模式		切换工作模式： 1.节能模式 默认设定 2.平衡模式 3.高性能模式
	减小音量		

 **温馨提示：**键盘的维护：长时间使用键盘，按键间隙通常会积累灰尘，可用小毛刷清洁缝隙，或是使用一般在清洁相机镜头使用的高压喷气罐将灰尘吹出，或使用掌上型吸尘器来清除键盘上的灰尘和碎屑。键盘表面的清洁可在软布上沾上少许清洁剂，在关机的情况下轻轻擦拭键盘表面。

## 指纹设置

按下开始 → 设置 → 账户 → 登录选项（必须优先设定密码）→ Windows hello指纹（最高可以设置10个指纹）→ 完成后设置PIN（支持英文+数字组合、4位数以上纯数字）

## 触摸板操作手势



单指单击、双击触摸板，相当于鼠标左键的功能。



双指单击触摸板，相当于鼠标右键，弹出选择菜单



双指同时向上/下划，实现屏幕的滚动，相当于鼠标的滚轮一样



双指同时向左 / 右划滑，用于浏览图片时，向左或者向右划图片的功能



双指同时向对角划开 / 缩合，实现放大或者缩小当前的图片 / 页面

## 关于使用维护与保养

- 当长时间不使用产品时，请断开产品电源，以延长产品寿命；
- 当不使用内置电池时，请按照正常的关机流程对整机进行关闭，不要非法关机也不要直接拔掉电源，以保证产品系统的稳定性；
- 非专业人士，请不要私自打开产品的任何背盖，以免对产品本身造成损坏或者对人身安全造成威胁，如果您的产品有问题，请联系您的经销商处理；
- 请不要私自添加任何原本不属于本产品的配件或不是专门设计用于本产品的配件；
- 打雷和闪电时，切勿接触电源线和信号电缆，这可能及其危险，可能导致触电，如果可以，请不要在打雷和闪电时使用部产品；
- 安装时请确认已将本产品牢固的固定好，以免硬伤，请尽量将产品安装到小孩无法触及的地方；
- 请避免将水或其他物体投入或推入产品机壳内，某些内部期间带有危险高压；
- 使用本产品请远离火源，请勿将本产品安装在散热器或散热源的附件或上方；
- 本产品属于发热产品，使用时请保证产品处在在相对通风的空间，请不要将产品本身的散热孔阻塞，因为积累过多热量可能会导致产品故障；
- 本产品在使用过程中需要定期清洁，一般使用5到7天清洁一次，具体频率依整使用环境而定；
- 清洁时，请先拔掉产品电源，然后再清洁产品表面，清洁产品背面请使用不湿的布，不要直接在产品显示屏幕上使用气雾剂，因为过多喷雾可能会导致触电；
- 清洁时，请使用柔软的布或者纸擦拭以防刮坏，不要使用像苯、涂料稀释剂或者酒精等化学物品进行清洁；
- 清洁产品正面时，请将水喷到柔软的布上2到3次，然后只向一个方向擦拭，请注意擦拭布的水分，布太湿会导致染色

## 配件及环保说明

特别提示：

以下附件清单为产品标配清单，如若订单有特别需求则已具体需求为准，如果我司产品附件有更新调整也不再做进一步的通知。

序号	名称	数量	规格
	使用说明书保修卡	1本	
	合格证	1张	
	电源连接线	1条	1.8米
	电源适配器	1个	

产品有毒有害物质或元素的名称及含量表：

部件名称	有害物质					
	铅 (Pb)	汞 (Hg)	镉 (Cd)	六价铬 (Cr <sup>6+</sup> )	多溴联苯 (PBB)	多溴二苯醚 (PBDE)
印刷电路板	X	○	○	○	○	○
硬盘驱动器	X	○	○	○	○	○
显示屏	X	○	○	○	○	○
外壳	X	○	○	○	○	○
电池	X	○	○	○	○	○
键盘	X	○	○	○	○	○



扬声器	X	○	○	○	○	○
散热模组	X	○	○	○	○	○
麦克风	X	○	○	○	○	○
W -F 模组	X	○	○	○	○	○
AC适配器	X	○	○	○	○	○

本表格依据SJ/T 1 1364-2014的规定编制。

○：表示该有害物质在该部件所有均质材料中的含量均在GB/T 26572 规定的限量要求以下。

X：表示该有害物质至少在该部件的某一均质材料中的含量超出GB/T 26572 规定的限量要求。

该环保使用期限是指在正常使用情况下，便携式计算机（不含电池）及期附件产品含有的有害物质或元素不会外泄，以及电子信息产品用户使用该产品时不会对环境造成严重污染或对其人身、财产造成严重的损害。

## 简单故障的排除方法

### 特别提示：

在准备修理前，请检查下表，看看能不能找到您所遇到的故障原因。当您确信完全按照本使用指南操作，仍然不能排除故障后，请您联系产品服务中心进行产品维修。

笔记本电脑系统故障	
现象	解决方法
没有图像没有声音	1) 检查交流电源线及电脑端是否连接正常，产品是否正常供电。
	2) 检查电源适配器的状态指示灯是否亮起，若未亮起代表适配器故障或交流电源线未连接好。
	3) 确认产品处在工作状态，而不是在待机状态。
	4) 若以上均无法排除故障，请长按电源 键10秒左右强制关机。
画面正常没有声音	1) 检查是否将系统音量设置到了最小。
	2) 检查是否将产品音量设置成了静音。
	3) 如果有外置设备，检查外接设备音频输入线是否正常。
声音或图像收到干扰	1) 确认产品周边是否有影响产品的电器并将其远离产品。
	2) 更换产品交流输入的插座，确认是否是交流导致干扰。
无法开机	1) 检查供电系统是否正常。
	2) 检查电源开关按键是否有顶死，无法按动的现象。
	3) 若以上均无法排除故障，请长按电源 键10秒左右强制关机。

### 技术说明：

本机五金结构件、注塑件、接插件及绝大多数电子件符合中国和欧盟RoHS指令求，仅有少数部件由于全球技术水平限制，可能影响产品可靠性而暂未实现有毒有害物质或元素的替代，请消费者放心使用，正常使用条件下不会对使用者造成健康影响。



此标识为环保使用期限标识，期限（十年）。电子信息产品中含有的有毒有害物质或元素在正常使用的条件下不会发生外泄或突变，用户使用该电子信息产品不会对环境造成严重污染或对其人身、财产造成严重损害的期限。本产品在任何外界输入电源的情况下才能实现零能耗状况。

### 《废弃电器电子产品回收处理管理条例》提示性说明：

当用户不在需要此产品或产品寿命中止时，请遵守国家废弃电器电子产品回收处理相关法律规定，将其交给当地具有国家认可的回收处理资质厂商进行回收处理。

## 快速入门

请注意：初次使用此笔记本电脑时，强烈建议您连接交流适配器并使用交流电源。连接交流适配器后，即开始对电池充电。

请注意：包装箱中的交流适配器经认可供您的笔记本电脑使用；使用其他型号的适配器可能损坏笔记本电脑或与电脑相连的其他设备。

## 开机设置

按电源键开关之后，按以下步骤设置系统（在每一次设置之后，都会有加载的时间，请您耐心等待并保证适配器的正确连接，以避免电量不足）：

### 1、开机加载的界面



## 2、进入语言选择界面 选择您需要的系统语言



## 3.2、添加键盘布局选择“跳过”



## 3.1 按照系统提示操作，设置输入法



## 4、选择“我没有Internet连接”





- 5、微软windows许可协议条款，请您仔细阅读并选择接受。  
(若您需要使用window 操作系统，必须接受才能进入下一步，此条款与本公司无关，为微软官方操作系统提供)



- 6、设置您的账户名 (必须输入，否则您不能进入下一步)



- 7、输入账户名之后需要创建开机密码  
您可以选择输入，也可以选择点击下一步跳过



## 8、之后按照显示屏幕的操作进行点选，则可以顺利进入系统



注意：整个开机过程需要10~20分钟，再次提醒您耐心等待，并保持适配器正确连接并给电脑充电，避免电量不足影响系统加载



# 指纹识别设置

1. 进入windows10设置选项 (WIN +I) , 选择账户。



2. 进入账户选项、选择登陆选项。



3. 在登录选项界面，先设“密码”。提示：不先设密码，无法设置指纹。



4、再打开指纹识别 (Windows hello)



5、进入设置界面，选择开始



6、录入指纹页面，需要按压录入指纹，非滑动。



7、录入完指纹后，进入“设置PIN”页面，按照PIN的要求设置密码。设置完毕后提示一切就绪。



## 保修期

### 保修凭证:

购机发票及三包凭证是您可以正常享有国家“三包”和标准服务的保修凭证，请务必妥善保管，并在您需要服务时主动向我们的认证服务机构出示。

### 注意:

购机发票需为国家税务部门认可的正规发票。

### 保修起始日期:

雷神游戏本电脑的保修起始日期以购机发票标明的购机日期为准。如果您不能出示有效的购机发票及三包凭证，或上述保修凭证所记载的信息与产品不符合，或被涂改、无法辨认，则该产品的“三包”期、免费修理期将以产品的生产日期后推一个月为保修起始日期计算，如果不能得到有效的产品出厂信息，我们将不提供免费保修服务。

### 部件保修期:

主要部件的约定参照“三包”规定。



笔记本部件类别	部件名称	保修期
主要部件	主板	二年
	CPU	二年
	液晶屏	二年
	内存	二年
	硬盘驱动器	二年
	电源适配器	二年
	键盘	二年
	显示卡（独立	二年
其他部件	光驱、外壳、升压板、 触摸板、鼠标按键板、 触摸板到主板排线、 屏线、摄像头 摄像头排线、无线网卡、 电池、风扇	一年
附件	随机附件（光盘、电源线等）	三个月
	笔记本电脑包	无
软件	预装软件	一年
	随机软件	三个月

**注:**

保修期限表所提及的部件不应该被理解是对您所购买产品的配置的承诺和描述，产品配置应根据您购买的具体机型以装箱单为准。

**预装软件:**

预装软件是指与产品捆绑发售且在产品出厂时就已经安装好的操作系统软件。

**随机软件:**

随机软件是指随同产品配套出售的软件，该软件作为产品的一部分。一般指的是产品的驱动程序，随机软件会随产品的不同而不同。

**维修后的保修期限:**

本保修条款范围内的产品及部件，经厂商认证的服务机构维修后在本保修条款承诺的期限内继续享有所承诺的服务;维修部件如自修复之日起距本保修条款承诺的服务期限结束不足三个月的，该部件的服务期限将延长至修复之日起三个月止（仅适用免费保修期在一年(含)以上的部件）。届时，请您出具有效的维修记录。