

Simply NUC NDN23BHFICW

User Manual

User Manual for NDN23BHFICW

Before You Begin



CAUTIONS

The steps in this guide assume you're familiar with computer terminology and with the safety practices and regulatory compliance required for using and modifying computer equipment.

Disconnect the computer from its power source and from any network before performing any of the steps described in this guide.

Failure to disconnect power, telecommunications links, or networks before you open the computer or perform any procedures can result in personal injury or equipment damage. Some circuitry on the board can continue to operate even though the front panel power button is off.

Follow these guidelines before you begin:

- Always follow the steps in each procedure in the correct order.
- Create a log to record information about your computer, such as model, serial numbers, installed options, and configuration information.
- Electrostatic discharge (ESD) can damage components. Perform the procedures described in this chapter only at an ESD workstation using an antistatic wrist strap and a conductive foam pad. If such a station isn't available, you can provide some ESD protection by wearing an antistatic wrist strap and attaching it to a metal part of the computer chassis.

Installation Precautions

When you install and test the Simply NUC Unit, observe all the warnings and cautions in the installation instructions.

To avoid injury, be careful of:

- Sharp pins on connectors
- Sharp pins on circuit boards
- Rough edges and sharp corners on the chassis
- Hot components (such as SSDs, processors, voltage regulators, and heat sinks)

Observe all warnings and cautions that instruct you to refer computer servicing to a qualified technician.

Observe Safety & Regulatory Requirements

If you don't follow these instructions, you increase your safety risk and the possibility of noncompliance with regional laws and regulations.

For regulatory information please visit: simplynuc.com/regulatory

Use only the power supply provided with this device.

Utilisez uniquement l'alimentation fournie avec cet appareil.

Disclaimer & Safety Instructions

Disclaimer

The contents mentioned in this disclaimer are related to your safety, legal rights and responsibilities. Please pay attention to any warnings, cautions and attention signs on the instructions and product labels, and install according to the instructions.

This product is relatively complex, and users need to have basic hands-on installation skills and safety knowledge. You should be careful during installation.

Before using this product, please read the instructions carefully to ensure that the product can be set up correctly. Failure to follow the instructions, warnings, cautions, and attention signs may damage the product or data, and may result in personal or property injury or loss.

Once you use the product, you are deemed to have carefully read the content requirements of the disclaimer, warning, caution, and attention signs, understood and accepted all the contents. You accept full responsibility for the consequences of using this product. You agree to use this product only for legitimate purposes and agree to this statement and any policies and guidelines formulated by Simply NUC.

In addition to the warranty terms, Simply NUC is not legally responsible for damage or injury caused directly or indirectly by using this product, especially those caused by failure to operate in accordance with safety guidelines. Users should follow the instructions mentioned in this statement and all safety guidelines.

The final interpretation right of this statement belongs to Simply NUC.

Safety Precautions

Dust, moisture and drastic temperature changes will affect the product life, so please try to avoid placing the product in these places.

The suitable temperature for this unit and accessories is 0°C to 60°C.

Before using this product, make sure you leave enough space around the device for ventilation.

This equipment should be installed and operated with enough clearance for air to flow freely round the unit.

When using a power extension cord, the total current of all connected products should be within the rated current of cables, ensuring stable operation.

Maintenance Guideline

Do not step on the power cord or put anything on the unit.

Do not spill water or any other liquid over this product.

There's still some current passing through even when the system is off. To avoid severe damage caused by possible electric shock, unplug all power cables from electrical outlets before opening, cleaning or moving the unit.

Included in the box



- 1) Bloodhound unit
- 2) Regional Power Cord
- 3) Power Supply

Getting to Know Your System

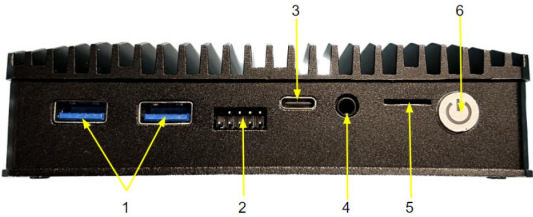

Identifier	Connector
1	Dual USB 3.0 Gen 2 Type-A
2	Front Panel Header
3	USB 3.0 Gen 2 Type-C
4	HD Audio Jack (Headset Only)
5	Micro SD Card Slot
6	Power Button

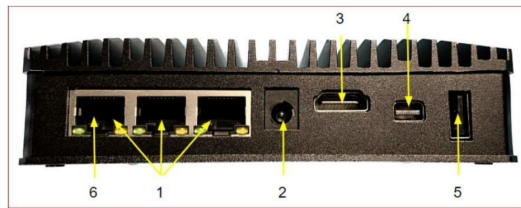

Identifier	Connector
1	RJ-45 /r 2.5 Gigabit Ethernet
2	Lockable DC Power Input
3	HDMI 2.0 Port
4	Mini DisplayPort 1.4 (mDP)
5	USB 2.0 Type A
6	PoE+ (In) Enabled RJ-45

Open the Chassis

To open the Chassis, follow these steps:

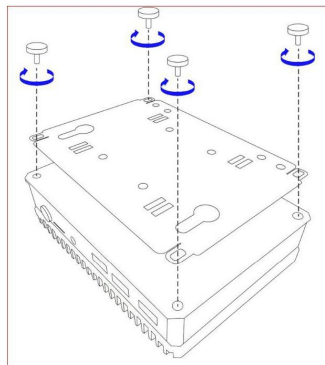

Note: Rotate the screw in the counterclockwise direction to loosen and remove them. If using the wall mount plate align it as shown in the image above...

Internal Connectors

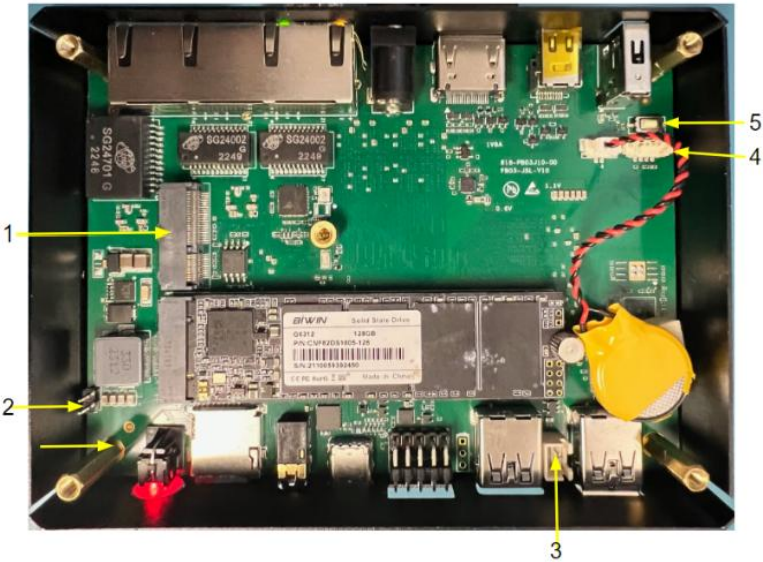

Identifier	Header
1	Wi-Fi Module / 2nd Expansion Slot
2	Power On Jumper
3	12VDC 2 Pin Header
4	Reserved Fan Header
5	CMOS Clear Button

Installing 2280 & 2242 M.2 Cards

The NDN23BHFIC supports 22mm x 80mm SSD (SATA only) and a 22mm or 42mm M.2 Radio.

If you're installing an M.2 device:

1. Remove the small silver screw from the 80mm (A) and 42mm (B) metal standoff on the motherboard.
2. Align the small notch at the bottom edge of the M.2 card with the key in the connector.
3. Insert the bottom edge of the M.2 card into the connector (C).
4. Secure the card to the standoff with the small silver screw (D).

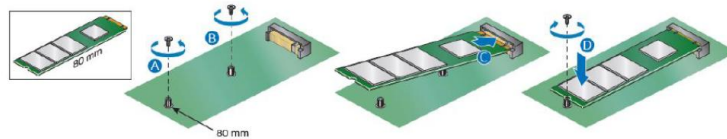

Note: the system supports NVME type SSD only in the 2280 slot...

Warning if you are replacing or reinstalling your SSD or radio ensure the appropriate thermal interface pad. A damaged or missing thermal pad can cause overheating the SSD and/or the Radio...

If you're installing a 42mm M.2 device:

1. Remove the small silver screw from the metal standoff on the motherboard (A).
2. Align the small notch at the bottom edge of the M.2 card with the key in the connector.
3. Insert the bottom edge of the M.2 card into the connector (B).
4. Secure the card to the standoff with the small silver screw (C).

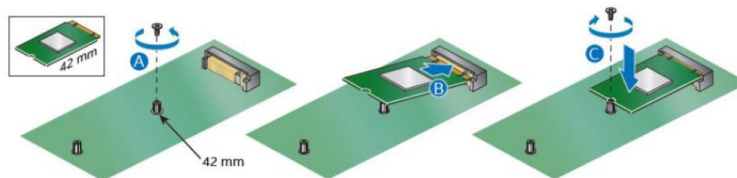

Closing The Chassis

After all components have been installed, close the chassis. Simply NUC recommends this be done by hand. Avoid over-tightening as damage to the screws could occur. Note that if you are using the wall mount plate, as shown below please replace the plate in the same orientation from when it was removed.

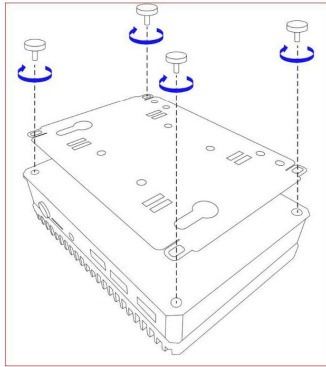

Connecting Unit

Connect Monitor



User Manual for NDN23BHFIC

Connect Keyboard & Mouse

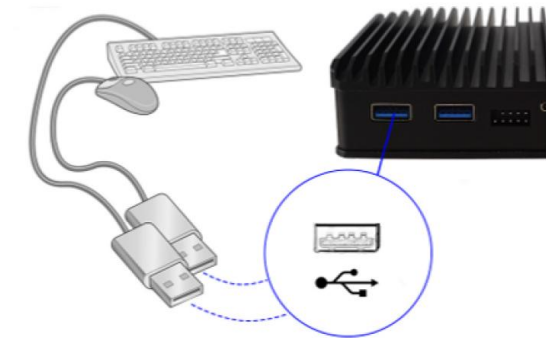

Connect the Keyboard and Mouse to the front panel USB connectors.

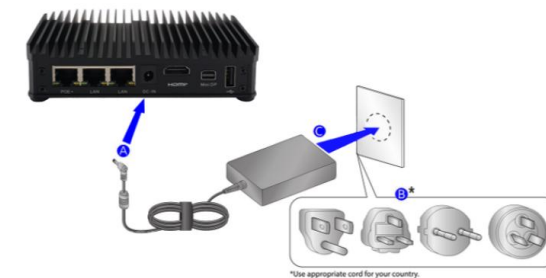

Connect To AC Power & System

Choose the appropriate configurable power connector as shown in the image below that fits your wall AC outlet type. Snap fit the AC plate into place on the back of the PSU / wall brick.



-  **Warning:** Only use the PSU / wall brick that ships with the system. The System end consists of a lockable 5.5mm barrel connector. Damage to the system may occur if a different PSU / wall brick is used.
-  **Warning:** The supplied PSU / wall brick operates at 100 to 220 VAc and can deliver up to 2.0 Amps. The supply voltage output to the system is 12.0 VDC.

Powering No The Unit



Simply depress and hold down the power button for one to two seconds. It is located on the right hand side of the front of the unit as shown in the image above.

Drivers & Support

Visit <https://support.simplynuc.com/portal/en/home> for drivers and support.

Version History

Version	Date	Notes
1.0	01/29/14	Initial Release, Finished including technical content and related imagery..

Warning:

This device complies with Part 15 of the FCC Rules. Operation is subject to the following two conditions:

- (1) this device may not cause harmful interference, and
- (2) (2) this device must accept any interference received, including interference that may cause undesired operation.

NOTE: This equipment has been tested and found to comply with the limits for a Class B digital device, pursuant to Part 15 of the FCC Rules. These limits are designed to provide reasonable protection against harmful interference in a residential installation. This equipment generates uses and can radiate radio frequency energy and, if not installed and used in accordance with the instructions, may cause harmful interference to radio communications. However, there is no guarantee that interference will not occur in a particular installation. If this equipment does cause harmful interference to radio or television reception, which can be determined by turning the equipment off and on, the user is encouraged to try to correct the interference by one or more of the following measures:

- Reorient or relocate the receiving antenna.
- Increase the separation between the equipment and receiver.
- Connect the equipment into an outlet on a circuit different. from that to which the receiver is connected.
- Consult the dealer or an experienced radio/TV technician for help. NOTE: This device and its antenna(s) must not be co-located or operation in conjunction with any other antenna or transmitter

RF Exposure Statement To maintain compliance with FCC ' s RF Exposure guidelines, This equipment should be installed and operated with minimum distance of 20cm the radiator your body. This device and its antenna(s) must not be co-located or operation in conjunction with any other antenna or transmitter.

The device contains BT and WIFI transmitter Module: 9260NGW (Contains FCC ID: PD99260NG).