

AIRDOPES ALPHA



boat

AIRDOPES ALPHA

Get ready to immerse yourself in musical bliss with your very own pair of boAt Airdopes Alpha. Please consider this manual as your guiding map towards the unparalleled shores of auditory realm. Knowledge of Bluetooth and device connectivity is essential for steering this boat and therefore we strongly recommend thorough reading of this manual. Also, you may refer to the same at times when you face any sort of difficulty.



PACKAGE CONTENTS

- 1) 1x Pair of TWS Earbuds
- 2) 1x Charging Case
- 3) 1x Type-C Charging Cable
- 4) 1x User Manual
- 5) 1x Warranty Card
- 6) 1x Catalogue
- 7) 1x FAQ Card

OVERVIEW

- 1) CTC (Capacitive Touch Control) / Power Button

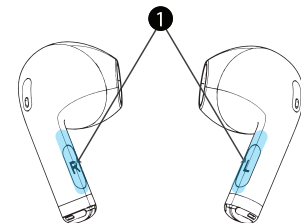

POWER ON (FIRST TIME USER):

Step 1: To switch the earbuds on (Smart Power On) simply open the lid of the charging case (when earbuds are inside), Courtesy our IWP™ (Insta Wake N' Pair) technology, the earbuds power on automatically, get connected and enter the connection mode

OR

Long touch the CTC (Capacitive Touch Control) on both earbuds for 3 seconds to manually power on the earbuds



Step 2: After powering on, the earbuds enter the Connection Mode, indicated by alternate red and blue LED flashes on primary earbud and blue LED flashes once every 5 seconds on the secondary earbud

CONNECTION MODE:

Step 3: Turn on the Bluetooth functionality on your phone/media device and scan.

Step 4: Search for 'Airdopes Alpha' and pair accordingly.

Congratulations! Your earbuds are connected successfully via Bluetooth

Note :

- Pairing Mode: It lasts for 5 minutes. If the pairing time is missed then you will need to reconnect the ear-buds and follow the above-mentioned procedure
- Airdopes Alpha remembers previously connected devices; once switched on, the earbuds automatically reconnect to the previously connected devices in working range.



CHARGING THE EARBUDS

Step 1: Please insert the earbuds back inside the charging case in correct orientation and close the lid

Step 2: In charging status, the red LED Solid turns on when case lid gets opened, LED stays off when the lid stays closed.

Step 3: Once the earbuds get fully charged, the charging case automatically switches off to save power, and the red LED stays turned off.

Note
• Before using the earbuds for the first time, it is recommended to fully charge the earbuds. Also, please keep the lid of the charging case closed while charging.

• To indicate low earbud battery, red LED blinks thrice every 30 seconds

CHARGING THE CASE

Step: To charge the case, plug one end of the provided cable into the case and connect the other end to a computer/ wall adapter/ powerbank, etc.

REMAINING CASE BATTERY LED INDICATIONS

Scenario	Indication
Less than 20% battery	WHITE LED blinks continuously when the Case lid is opened/Closed
More than 20% battery	WHITE LED is solid on for 8 seconds when the Case lid is opened/closed
Case in charging mode	WHITE LED continuously blinks
Case fully charged	WHITE LED is solid on

CASE LED INDICATION WHEN EARBUDS ARE GETTING CHARGED FROM THE CASE

This is to indicate the earbud getting charged from the case (when case lid gets closed):

- WHITE LED is Solid ON for 8 seconds while charging
- WHITE LED is OFF when Earbuds are charged fully

BASIC FUNCTIONS

- Voice Assistant: Triple tap on left CTC to activate default smart voice assistant
- Answer: Single tap the CTC on either earbud to answer an incoming call

- Hang Up / Reject Call: Double tap the CTC on either earbud to end / reject call
- Play/Pause Music: Single tap either earbud's CTC to play or pause music
- Next Track: When playing music, double tap the right earbud's CTC to skip to the next song
- Previous Track: When playing music, double tap the left earbud's CTC to return to the previous song

Note

- Volume can only be controlled via the media device

VOICE ASSISTANT:

Step 1: Triple tap on left CTC to activate default smart voice assistant

Step 2: The respective voice assistant screen pops up and you may place your commands at ease

- Tips: You may try the following commands,
- What is the weather?
 - Play a song
 - Set a reminder

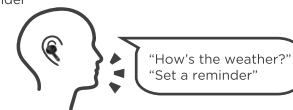

Note

If the voice assistant doesn't get triggered, then the functionality has to be first enabled via your media device settings.

ENX™ TECH

Our ENX™ tech algorithm cancels out the background noise so that you can hear crystal clear via voice calls. One need not activate ENX™ as the mics are equipped with the same and activated by default.

Deliver your voice without interruptions anywhere – traffic, railway stations, airports, work space; literally anywhere!

SMART POWER OFF

Step 1: After usage, remove both the earbuds from your ears

Step 2: Place the earbuds back into the charging case in correct orientation and close the lid

The earbuds automatically switch off (and enter charging mode).

MANUAL POWER OFF

Step 1: Long touch either CTC for 8 seconds to manually power off the earbuds

Step 2: Once the earbuds get turned off, place them back inside the case and close the lid

BEAST™ MODE

Triple tap the right CTC to switch to Low Latency mode, also known as the BEAST™ Mode. Once switched on, it gets notified via a sound prompt. Triple tap the left CTC once again, to turn it off and return to standard Music Mode.

Made for the Gamers - By Gamers, BEAST™ Mode reduces the latency significantly and improves the overall gaming experience.

FACTORY RESET

Perform the factory reset in case you feel any difficulty while operating your Airdopes.

*NOTE: Before performing reset, clear "Airdopes Alpha" from pairing device history by forgetting device

Step 1: Take out the earbuds from the charging case, and long touch the CTC for 5 seconds on both the earbuds.

Step 2: Place the earbuds inside the Case.

Step 3: Close the lid, wait for 5 seconds.

Step 4: Take out the earbuds from the charging case and perform a fresh connection.

Note: To complete the factory reset, all of the above steps should be performed.

Congratulations! Your Airdopes Alpha has been Reset

SINGLE EARBUD USAGE

Step 1: Please note that both the earbuds can be used in mono mode. Use Smart / Manual Power On for switching on the desired earbud

Step 2: The Selected earbud automatically enters the connection mode indicated by rapid red & blue LED flashes.

Step 3: Turn on Bluetooth on your phone/media device and search for 'Airdopes Alpha' to connect

Notes:

- To switch to Stereo mode, simply take out the other earbud from the case. It will automatically power on and pair with the previously selected earbud, hence enabling Stereo usage
- You cannot return to the previous tracks in Mono(single-earbud) mode

QUICK GLANCE ON FUNCTIONALITIES

- 3 Times: Triple tap on left CTC to activate default smart voice assistant
- 3 Seconds: Long touch both CTCs for 3 seconds to manually power on, indicated by white LED flash for 1 second
- 5 Seconds: Long touch both CTCs for 5 seconds to perform factory reset
- 8 Seconds: Long touch either CTC for 8 seconds to manually power off

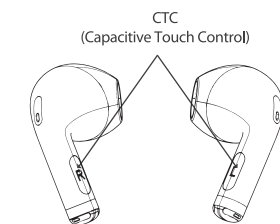

SPECIFICATIONS

Headphone Type	TWS
Bluetooth Version	V5.3
Music Playtime	8.5H earbuds; 26H (at 60% volume)
Standby Time	50H
Transmission Range	10m
Driver Size	13mm*2
ENX™	Yes
ASAP™ Charge	Yes
frequency response	20HZ-20KHZ
Battery	300mAh (Case) ; 35mAh*2(Earbuds)
Charging Time	40Min (Earbuds) ; 2H (Case)
Charging Interface	USB Type C
Water Resistance	IPX5

WARNING

- Please follow the instructions to operate
- Please don't use the earbuds in extreme temperatures
- Please don't use the product near water
- Please keep the product away from heat sources, as the heat may damage it
- Don't jam the ports such as charger port, LED port, etc.
- It is recommended to utilize the product below the maximum volume in order to protect hearing and extend the ear-buds' service life

Charging norms & Precautionary Guidelines: -	
1) Charger/Brick/Adapter	: 5V 2A
2) Cable/Wire	: Standard Cable (20 strands @0.10mm diameter/ strand)
Any other accessory can be paired up with the product as long as the specifications are as per above norms.	
Model Name: Airdopes Alpha	
Input Rating: 5V 1A	
Output Rating: 5V 200mA	
Made In India	

FCC Caution:

This device complies with part 15 of the FCC Rules. Operation is subject to the following two conditions: (1) This device may not cause harmful interference, and (2) this device must accept any interference received, including interference that may cause undesired operation. Any Changes or modifications not expressly approved by the party responsible for compliance could void the user's authority to operate the equipment.

Note: This equipment has been tested and found to comply with the limits for a Class B digital device, pursuant to part 15 of the FCC Rules. These limits are designed to provide reasonable protection against harmful interference in a residential installation. This equipment generates uses and can radiate radio frequency energy and, if not installed and used in accordance with the instructions, may cause harmful interference to radio communications. However, there is no guarantee that interference will not occur in a particular installation. If this equipment does cause harmful interference to radio or television reception, which can be determined by turning the equipment off and on, the user is encouraged to try to correct the interference by one or more of the following measures:

- Reorient or relocate the receiving antenna.
 - Increase the separation between the equipment and receiver.
 - Connect the equipment into an outlet on a circuit different from that to which the receiver is connected.
 - Consult the dealer or an experienced radio/TV technician for help.
- The device has been evaluated to meet general RF exposure requirement. The device can be used in portable exposure condition without restriction.