

IN THE BOX

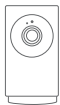

WiFi
Camera*1

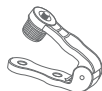

Mounting
Bracket*1



USB
Cable*1



Quick Start
Guide*1



Reset Pin*1

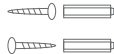

screws plastic
anchors



Screw
Set*1



USB
Adapter*1

PRODUCT OVERVIEW

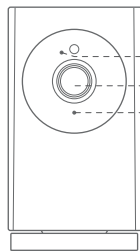

Status LED

Lens

Microphone

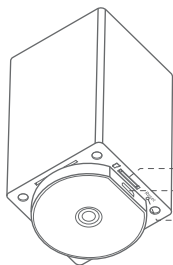

SD card slot

Power input

Reset button

CAMERA SETUP

1. Download the ugho.me APP and create a new account.



2. Connect the camera to a power outlet and wait for 5-10 seconds until it rotates.

3. Open the APP and tap "+" to add your camera to the system.

4. Follow the on-screen instructions to complete the setup.

Note: Camera setup only support 2.4GHz WiFi (5GHz network is not supported.)

CAMERA INSTALLATION

The camera can be placed on a table, or shelf, or can be mounted on a wall or a ceiling. Select a location and height where you can get the desired view, and can reach a power outlet easily. The camera needs to be powered on while using. Keep the camera away from anything (wall or window) that may obstruct the view. Do this to avoid infrared reflection which can have a negative impact on night vision performance.

To mount this indoor camera on a ceiling or on a wall, follow the steps below:

1. Using bracket part A as a template, mark points on the ceiling or wall to help the drilling process.

2. Drill holes with a 1/4 inch drill bit.

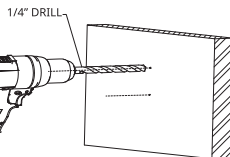
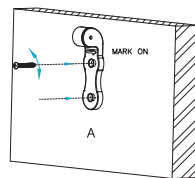

3. Align the holes on the mounting plate with those in the ceiling. Insert the anchors into the holes (anchors are necessary for walls that are made out of hard materials such as concrete, brick, or stucco.) Fix the screws with a screwdriver to fasten the mounting bracket to the ceiling or wall.

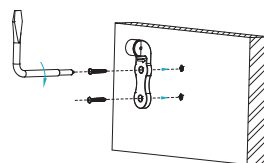
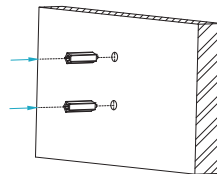

4. Place part C into the bracket part B, securely screw the camera on the top.

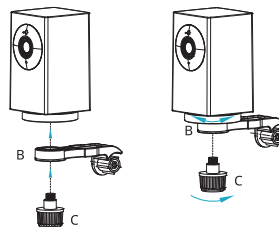

5. Place the bracket part B to part A, and adjust the two parts for a better camera viewing angle.

Note: You may need to pull part B from part A first, then adjust the desired angle and insert it back. Do not rotate two parts by force.

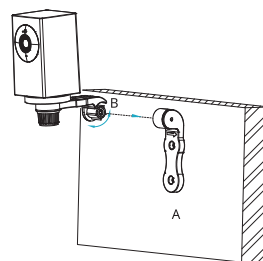

6. Fasten the bracket with a screw.

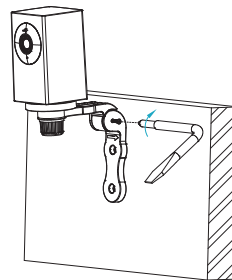

7. Plug in the USB cable to a power outlet, then finish.

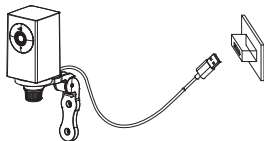

NOTICE

FCC Statement

This device complies with Part 15 of the FCC Rules. Operation is subject to the following two conditions: (1) this device may not cause harmful interference, and (2) this device must accept any interference received, including interference that may cause undesired operation.

Warning

Changes or modifications not expressly approved by the party responsible for compliance could void the user's authority to operate the equipment.

Note

This equipment has been tested and found to comply with the limits for a Class B digital device, pursuant to Part 15 of the FCC Rules. These limits are designed to provide reasonable protection against harmful interference in a residential installation. This equipment generates uses and can radiate radio frequency energy and, if not installed and used in accordance with the instructions, may cause harmful interference to

radio communications. However, there is no guarantee that interference will not occur in a particular installation. If this equipment does cause harmful interference to radio or television reception, which can be determined by turning the equipment off and on, the user is encouraged to try to correct the interference by one or more of the following measures:

- (1) Reorient or relocate the receiving antenna.
- (2) Increase the separation between the equipment and receiver.
- (3) Connect the equipment into an outlet on a circuit different from that to which the receiver is connected.
- (4) Consult the dealer or an experienced radio/TV technician for help.

FCC Radio Frequency Exposure Statement

The device has been evaluated to meet general RF exposure requirements. The device can be used in fixed/ mobile exposure condition. The min separation distance is 20cm.

Notice: Shielded cables

All connections to other computing devices must be made using shielded cables to maintain compliance with FCC regulations.

♻️ This product is designed and manufactured with high-quality materials and components, which can be recycled and reused.

♻️ This symbol means the product must not be discarded as household waste and should be delivered to an appropriate collection facility for recycling. Proper disposal and recycling help protect natural resources, human health and the environment. For more information on disposal and recycling of this product, contact your local

municipality, disposal service, or the shop where you brought this product.

IC Statement

This device complies with Industry Canada licence-exempt RSS standard(s). Operation is subject to the following two conditions:

- (1) this device may not cause interference, and
- (2) this device must accept any interference, including interference that may cause undesired operation of the device.

Le présent appareil est conforme aux CNR d'Industrie Canada applicables aux appareils radio exempts de licence. L'exploitation est autorisée aux deux conditions suivantes:

- (1) l'appareil n doit pas produire de brouillage, et
- (2) l'utilisateur de l'appareil doit accepter tout brouillage radioélectrique subi, même si le brouillage est susceptible d'en compromettre le fonctionnement.

This Class B digital apparatus complies with Canadian ICES-003. Cet appareil numérique de la classe B est conforme à la norme NMB-003 du Canada.

IC RF Statement

When using the product, maintain a distance of 20cm from the body to ensure compliance with RF exposure requirements. Lors de l'utilisation du produit, maintenez une distance de 20 cm du corps afin de vous conformer aux exigences en matière d'exposition RF.

CUSTOMER SERVICE

Warranty

Puwell Technology Inc. warrants this product to be free of defects in materials or workmanship for one year. This warranty does not include

damage resulting from accidents or misuse. Damage from unauthorized service or modification of the product or of any furnished component will void this warranty in its entirety. This warranty is expressly in lieu of all other warranties, expressed or implied, including any warranty, representation, or condition of merchantability or that the products are fit for any particular purpose or use, and specifically in lieu of all special, indirect, incidental, or consequential damages. To obtain service/ replacement, please contact support@ugohome.me . Please allow up to seven (7) business days for your replacement to be processed.

Contact Us

✉ support@ugohome.me

🐦 @UGOHOME

📺 @UGOHOME

ugohome

Quick Start Guide

1080P PTZ WI-FI SECURITY CAMERA

