

Digital Wireless Hearing Buds

# Noah Sound Buds

User Manual

## 1、Introduction

The hearing buds includes: The Noah Sound bugs consists of a sound processor, buds, connecting cable and magnetic charging cable and domes.

### ➤ Sound Processor

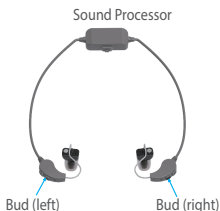

### ➤ Bud (left)

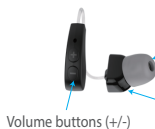

### ➤ Bud (right)

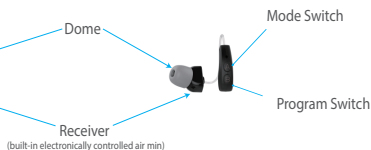

## 2、Ready For Use

### 1 Charging

- The charging cable is connected to the USB charger.
- Suck the magnetic charging head to the magnetic charging port position as demonstrated in the picture.
- The indicator on that meanings it is charging, and when it is full, the indicator goes off.
- Charging takes up to about 2 hours.

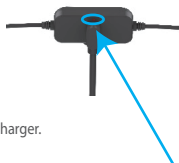

## 2 Selection Of Domes

There are four sizes of domes, so please choose the one that fits best and is comfortable for you.

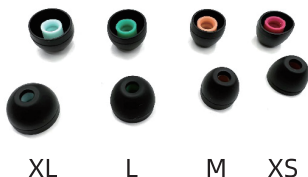

## 3 Wearing

Wear the receiver with dome into the ear canal, make sure to wear to the right position, and then hang the bud on the ear. You can refer to the diagram on the right.



\*Note: The left and right buds are not interchangeable.

### 3、Turn On And Off, Bluetooth Pairing

#### 1 Turn On / Off

Long press the on/off button for 2 seconds after turn on/off.

The indicator flashes after turn on,  
and the indicator fast flashes off after turn off.

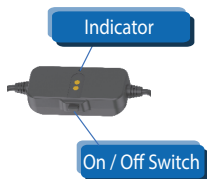

#### 2 Bluetooth Setup And Pairing

➤ After power on, the buds defaults to "Amplify Program".

➤ If you need to enter the "Bluetooth mode".

The operation steps are as follows:

- Press the "A" button on the right bud;
- Open the Bluetooth setting on the phone settings;
- Search for Bluetooth devices and find "Noah sound buds";
- Click on "Noah sound buds" to pair and connect;
- After successful connection, the sound processor light will flash slowly.



## 4、Switching Mode

The product provides two modes:

Amplify and Bluetooth mode.

Amplify mode:

default setting, amplify the sound.

Bluetooth mode:

connected to the phone, receiving calls, Bluetooth audio transmission.

Switch through the A button on the right bud,

Amplify program - Bluetooth mode - Amplify program.

Button A: Switching Program  
(on the right bud)



## 5、Volume Adjustment And Program Switching In Amplify Mode

### 1 Volume Adjustment:

In the auxiliary listening mode, adjust the sound level by push the volume button on the left bud.

Press "+" to increase the volume, press "-" to decrease the volume.

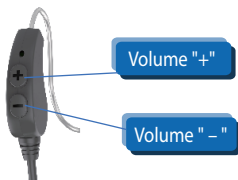

## 2 Program Switching:

In the amplify mode,

2 programs are provided to adapt to different listening scenarios.

Program 1 is a general program,

suitable for home, office and other relatively quiet scenarios;

Program 2 is a noise-reduction program,

for scenarios such as outdoor and commuting.

The program can be switched by the button "B" on the right bud,

and there will be a "beep" or "beep beep" tone when the switch is successful.

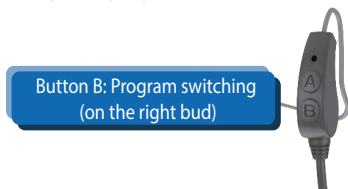

## 6、 More Operation Via APP

By installing the APP, in addition to the previously introduced button operation, you can also make more fine adjustments:

- Switch between amplify mode and Bluetooth mode;
- Volume adjustment;
- Left and right buds volume independent adjustment (APP only);
- Electronically controlled air valve switch (APP only).

## 7、Precautions In Use

### 1 Avoid Whistling Sound

The principle is to amplify the sound,  
due to the sound feedback, sometimes inevitable whistling will occur.  
Please turn down the volume first,  
and then increase the volume after the hearing buds is worn correctly,  
and also turn down the volume before taking off the hearing buds,  
and then take off it.

### 2 Volume Setting Suggestions:

#### (1) Amplify mode:

In order to get the best amplify effect,  
please adjust the volume to the appropriate range.  
It is recommended not to set the volume too high,  
especially when you first start using it, or in a noisy environment.

#### (2) Bluetooth mode:

It is recommended not to be at high volume  
for long periods of time when using Bluetooth for phone calls  
or audio transmission to better protect your hearing.

## 8、Daily Maintenance

### 1 Waterproof And Moisture Resistant

Please do not wear the hearing buds in case you take a shower, wash your face,  
get wet, etc.

Please be careful to keep the earphone dry when you sweat a lot.

### 2 Loss Prevention

When the hearing buds are not used, do not hang on the neck or easy to slip off lost,  
please properly stored.

### 3 Charging

The hearing buds must be removed when charging.

### 4 Cleaning

Wipe clean with a dry paper or soft cloth.

This device complies with part 15 of the FCC Rules. Operation is subject to the following two conditions: (1) This device may not cause harmful interference, and (2) this device must accept any interference received, including interference that may cause undesired operation.

Any Changes or modifications not expressly approved by the party responsible for compliance could void the user's authority to operate the equipment.

This equipment has been tested and found to comply with the limits for a Class B digital device, pursuant to part 15 of the FCC Rules. These limits are designed to provide reasonable protection against harmful interference in a residential installation. This equipment generates uses and can radiate radio frequency energy and, if not installed and used in accordance with the instructions, may cause harmful interference to radio communications. However, there is no guarantee that interference will not occur in a particular installation. If this equipment does cause harmful interference to radio or television reception, which can be determined by turning the equipment off and on, the user is encouraged to try to correct the interference by one or more of the following measures:

- Reorient or relocate the receiving antenna.
- Increase the separation between the equipment and receiver.
- Connect the equipment into an outlet on a circuit different from that to which the receiver is connected.
- Consult the dealer or an experienced radio/TV technician for help.

The device has been evaluated to meet general RF exposure requirement. The device can be used in portable exposure condition without restriction.

Product Name: Digital Wireless Hearing Buds

Product Model: BYO1A

Manufacturer: BOIN HEARING TECHNOLOGY ( SHANG HAI ) CO.,LTD ;

Website: [www.boinhearing.com](http://www.boinhearing.com)

Address: Room 401,402,403,405, Building 4, No.2899,  
Lianhua South Road, Minhang District, Shanghai, China

National Hotline: 400 8200 658

Hotline: 021-6477 0588