

PAXA X15pro 真无线蓝牙耳机

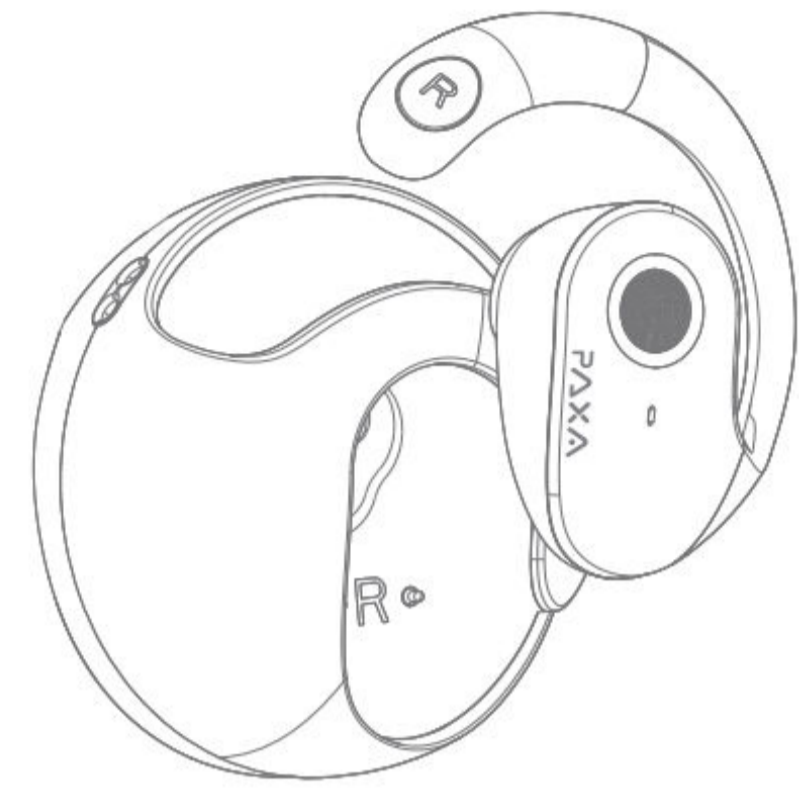

使用说明书
使用前请阅读使用说明书

产品使用简介

- 除说明书有特殊标示的操作方式以外, 请勿尝试拆卸或更换产品内的任何零件。
- 请勿将产品放入水或其他任何液体中, 此产品非防水设计。
- 如果有任何液体不小心进入产品内时, 请立即断开连接并移开此产品。
- 为避免触电, 请在安装或卸载产品时, 确保手上没有沾水。
- 请勿将此产品放置于热源附近或直接暴露在火源附近
- 请勿将本产品放置在有强大电磁力的环境中, 否则会导致产品故障。

包装清单



产品示意说明



产品规格

蓝牙版本: V5.3
传输距离: 10m
电池容量: 50mAh
使用时长: 约5小时
充电时长: 约1.5小时
额定输入: 5V=30mA

充电仓规格

电池容量: 250mAh
充电时间: 约2小时
额定输入: 5V=250mA
使用时间: 约15小时
(所有技术信息以实际性能为准)

给充电仓充电

用Type-C充电线连接充电仓到5V电源适配器。
(温馨提示: 当充电仓指示灯绿灯闪烁时, 请及时给充电仓充电。)

LED指示灯说明

充电仓指示灯	<ul style="list-style-type: none"> 给耳机充电未充满: 白灯常亮 给耳机充满电: 灯灭 给充电仓充电: 白灯闪烁 充电仓充满电: 白灯常亮 充电仓低电: 绿灯闪烁
耳机指示灯	<ul style="list-style-type: none"> 开机: 白绿灯交替闪烁 关机: 白灯闪烁三次 蓝牙配对状态: 白绿灯交替闪烁 耳机配对成功: 灯灭

产品操作说明

- 1、开机**
方式一: 将耳机从充电仓中取出, 耳机自动开机。
方式二: 当耳机处于关机状态, 长按耳机触摸功能区3秒, 耳机开机。

- 2、关机**
方式一: 将耳机放回充电仓, 耳机关机。
方式二: 长按耳机触摸功能区5秒, 耳机关机。

- 3、配对**
步骤一: 将耳机从充电仓中取出, 耳机自动开机, 开机后耳机自动组队;
步骤二: 打开智能设备的蓝牙列表, 搜索“X15pro”并连接(支持单耳使用)。

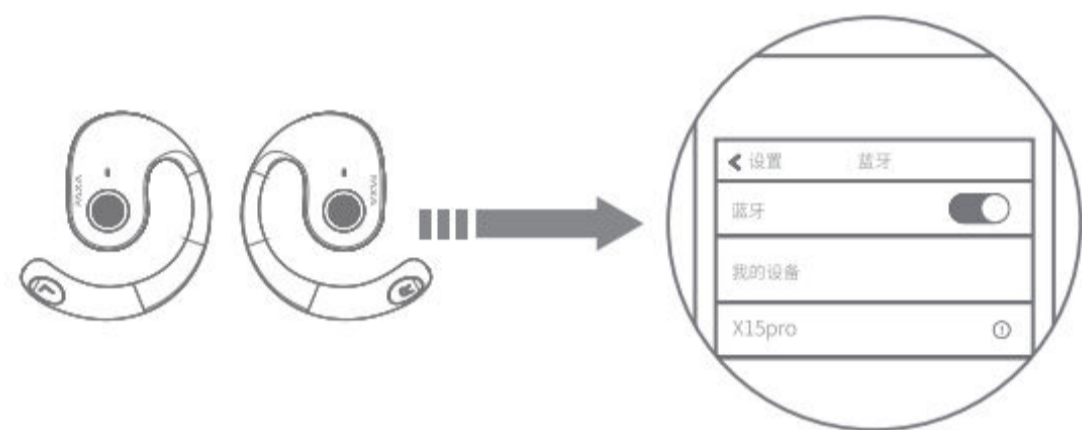

■ 触控按键的操作 音乐播放模式

■■ 左/右耳机操作



电话免提

■■ 左/右耳机操作 (来电状态下)



激活语音助手 (智能设备支持语音助手)

■■ 左/右耳机操作

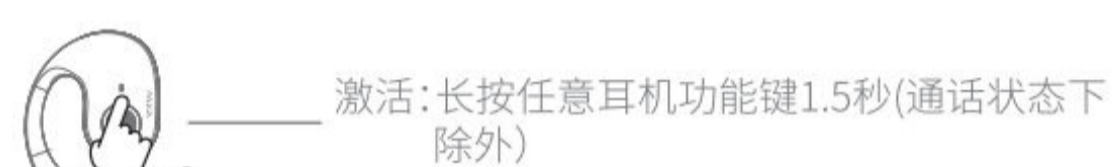

产品中有有害物质名称及含量

部件名称	有害物质					
	铅(Pb)	汞(Hg)	镉(Cd)	六价铬 (Cr(VI))	多溴联苯 (PBB)	多溴二苯醚 (PBDE)
印刷电路板组件	○	○	○	○	○	○
外壳等小结构件	○	○	○	○	○	○

本表格依据SJ/T 11364的规定编制。
○: 表示该有害物质在该部件所有均质材料中的含量均在GB/T 26572规定的限量要求以下。
×: 表示该有害物质至少在该部件的某一均质材料中的含量超出GB/T 26572规定的限量要求。
表中标记“X”的部件, 皆因全球技术发展水平限制而无法实现有害物质的替代。

印刷电路板组件*: 包括印刷电路板及其零部件, 电子元器件等, 根据产品型号不同, 您所购买的产品可能不会含有以上所有部件

10 在中华人民共和国境内销售的电子电气产品必须标识此标志, 标志内的数字代表在正常的使用状态下的产品的环保使用期限。

保修卡

尊敬的用户, 本保修卡是您将来申请保修的凭证, 请您配合销售商填写并妥善保管备用!

用户信息	
用户姓名	电子邮件
联系电话	邮政编码
通讯地址	

产品信息

产品名称	产品型号
产品条码/编号/批号	

销售商信息

名称	
地址	
联系电话	邮政编码
销售日期	发票号码
备注	

制造商: 深圳市企顺创新科技发展有限公司
地址: 深圳市龙华区民治街道上芬社区龙胜路与景龙建设路交汇处融创智汇大厦A座1915



FCC声明

根据FCC规则第15部分, 本设备经过测试, 符合B类数字设备的限制。这些限制旨在提供合理的住宅设施中的有害干扰防护。该设备产生使用并可辐射射频能量, 如果未按照规定安装和使用该指示可能会对无线电通信造成有害干扰。然而, 有不能保证在特定安装中不会发生干扰。如果这个设备有对无线电或电视接收造成有害干扰, 可通过转动来确定设备, 关闭和打开时, 鼓励用户尝试通过一个或多个以下更多措施

- 重新定向或重新定位接收天线。
- 增加设备和接收器之间的间距。
- 设备连接到与接收器不同的电路上的插座已连接。
- 请咨询经销商或经验丰富的无线电/电视技术人员以获得帮助。

此设备符合FCC规则的第15部分。操作受以下两个条件限制条件

- (1) 本装置不得引起有害干扰。
 - (2) 本装置必须接受任何接收到的干扰, 包括可能导致意外操作的干扰。
- 未经合规责任方明确批准的变更或修改可能使用户对设备的操作权限失效。

FCC ID:2BAQF-X15PRO



PAXA X15pro True Wireless Earphones

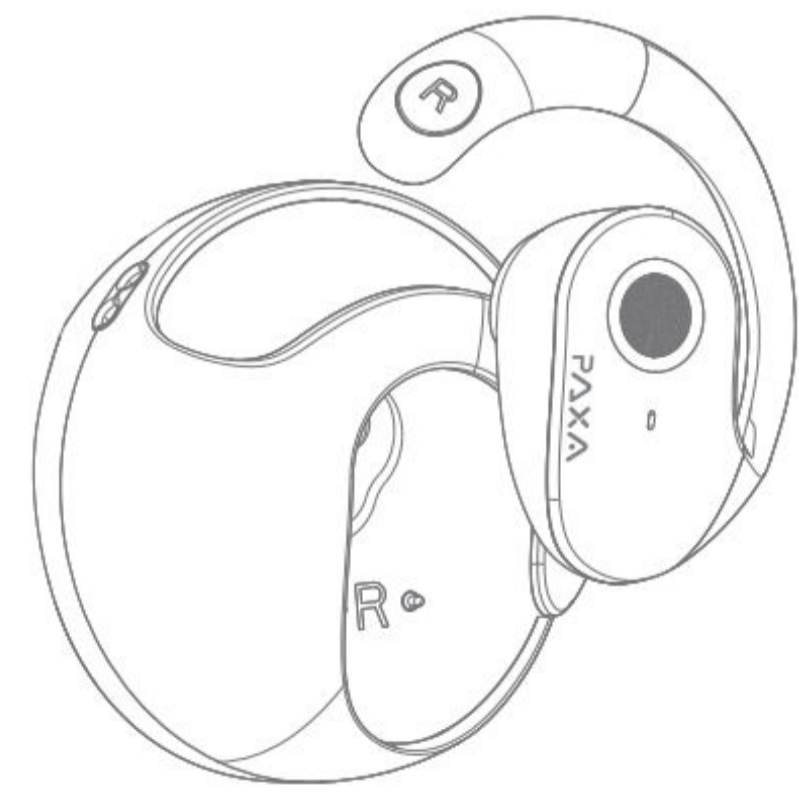

Manual
Please read all instructions carefully and retain for future use

Usage Instruction

- Don't attempt to disassemble the unit and change any part, except there is operation method mentioned in the manual.
- Don't expose the unit to liquid, moisture or humidity, since it is not a waterproof product.
- Disconnect the unit with your BT device and move it to the safe area if the liquid get inside the unit.
- Don't assemble or disassemble the unit to avoid electric shock, if there is water on your hands.
- Don't expose the unit to extremely high temperature or dispose of the unit in fire as it will result in an explosion.
- Don't place the unit in an electromagnetic interference environment to avoid malfunction.

Packing list



Product schematic description



Product specification

BT Version: V5.3
Transmission distance: 10m
Battery capacity: 50mAh
Playing time: About 5 hours
Charging time: About 1.5 hours
Rated input: 5V=30mA

Charging case specification

Battery capacity: 250mAh
Charging time: About 2 hours
Rated input: 5V=250mA
Playing time: About 15 hours
(All technical information is subject to actual performance)

Charge the Charging case

Connect the Type-C cable to the 5V power adaptor, and another end to the charging port of the Charging case.
(Tips: When the green light of the charging bin blinks, please charge the charging bin in time.)

LED Indicator Status

Charging case Indicator	<ul style="list-style-type: none"> Charge the charging bay: White light on. Charging bay is fully charged: Indicator is off. Charging the earphones is not fully charged: White light flashing. Fully charge the earphones: White light on. Low charge: Green flashing
Earphones Indicator	<ul style="list-style-type: none"> Power on: Blinking white and green Power off: White light flashes 3 times BT pairing status: White and green lights flash alternately Earphones are successfully paired: Indicator is off.

Product operating instructions

- 1. Power on**
Method 1: Remove the earphones from the charging bin, and the earphones will automatically power on.
Method 2: When the earphones is off, press and hold the earphones to touch the functional area for 3 seconds power on.

- 2. Power off**
Method 1: Put the earphones back into the charging bin and turn off the earphones.
Method 2: Press and hold the earphones to touch the functional area for 5 seconds, and the earphones shuts down.

- 3. Pairing**
Step 1: Remove the earphones from the charging compartment, the earphones will automatically turn on, and the earphones will be turned on automatic team formation.
Step 2: Open the BT list of smart devices, search for "X15pro" and connect. (Supports single-ear use).

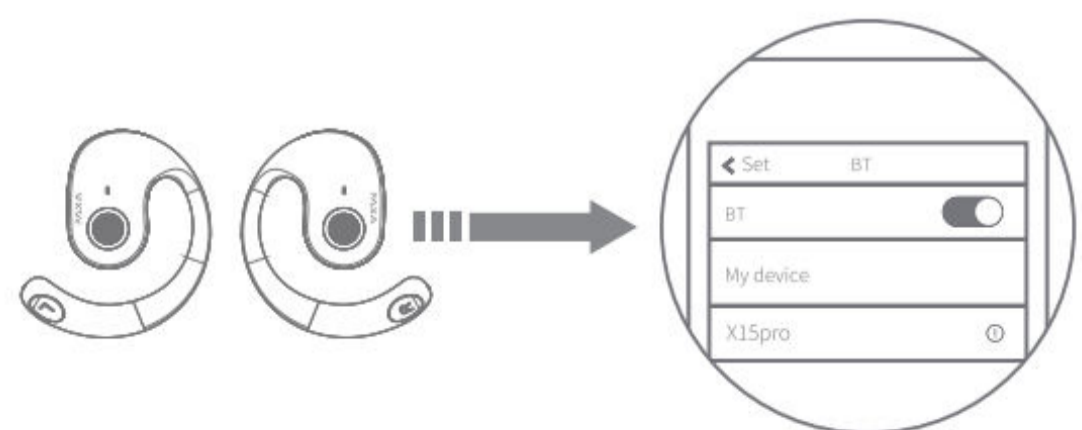

- Touch control button operating Music playing mode
- Left/Right earphone operating

- Previous song: double-click the (L) function button on the left earphone.
- Next song: double-click right the (R) function button on the left earphone.
- Volume +: Triple strike the MF button of right earphone.
- Volume -: Triple strike the MF button of left earphone.
- Pause/Play: Click the MF button of one earphones.

- Hands free function
- Left/ Right earphone operating (incoming call)

- Answer incoming call: Click the MF button of any earphones.
- Access denial: Press and hold the MF button of any earphones for 2 seconds
- Hang up: Click the MF button of any earphones.

- Active the voice assistant function (the smart devices support voice assistant function)
- Left/ Right earphone operating

- Activation: Press and hold the MF button of any earphones for 1.5 seconds(except in call state)

Name and content of hazardous substances in products

Part Name	Harmful materials					
	Pb	Hg	Cd	Cr(VI)	PBB	PBDE
Printed circuit assembly	○	○	○	○	○	○
Small structural parts such as shell	○	○	○	○	○	○

This form is compiled in accordance with SJ/T 11364
○: Indicates that the content of the hazardous substance in all homogeneous materials of the part is in Below the limit requirements specified in GB/T 26572.
×: Indicates that the content of the hazardous substance in at least one of the homogeneous materials of the part exceeds The limit requirements specified in GB/T 26572.
The parts marked with "X" on the form are all harmful due to the limitations of global technological development. Substitution of substances.

Printed circuit board components*: including printed circuit boards and their parts, electronic components, etc., Depending on the product model, the product you purchased may not contain all the above components

10 Electronic and electrical products sold in the People's Republic of China must mark this Logo, the number in the logo represents the product under normal use Environmental protection use period.

Warranty Service

Dear user, this warranty card is the proof of your future warranty application, please cooperate with the seller to fill it out and keep it for future use!

User info	
User name	Email
Contact number	Postal code
Mailing address	
Product information	
Product name	Product number
Product barcode / Serial number / Batch number	

Vendor information

Name	
Address	
Contact number	Postal code
Sales date	Invoice number
Remark	

Shenzhen Qishun Innovation Technology Development Co., Ltd
1915, Block A, Rongchuang Zhihui Building, Intersection of Long Sheng Road and Jing Long Construction Road, Shang Fen Community, Minzhi Street, Longhua District, Shenzhen.



FCC Statement

According to Part 15 of the FCC Rules, this device has been tested to meet the restrictions for Class B digital devices. These restraining decrees In providing reasonable protection against harmful disturbances in residential facilities. The device generates and uses radiofrequency energy. If this instruction is not installed and used in accordance with the regulations, it may cause harmful interference to radio communications. However, there are There is no guarantee that interference will not occur in a particular installation. If this device has built for radio or television reception into harmful interference, the device can be determined by turning it off and on when the user is encouraged to try to pass through one or Several more measures below

- Redirect or reposition the receiving antenna.
- Increase the distance between device and receiver.
- Sockets connected to devices on circuits different from the receiver are connected.
- Please consult a dealer or experienced radio/TV technician for assistance.

This device complies with Part 15 of the FCC Rules. The operation is restricted by the following two conditions

- (1) The device shall not cause harmful interference.
- (2) The device must accept any received interference, including interference that may cause unexpected operation.

Changes or modifications that are not explicitly approved by the compliance responsible party may invalidate the user's permission to operate the device.

This equipment complies with FCC radiation exposure limits set forth for an uncontrolled environment. This equipment should be installed and operated with minimum distance 0cm between the radiator and your body.

FCC ID:2BAQF-X15PRO

