

封面

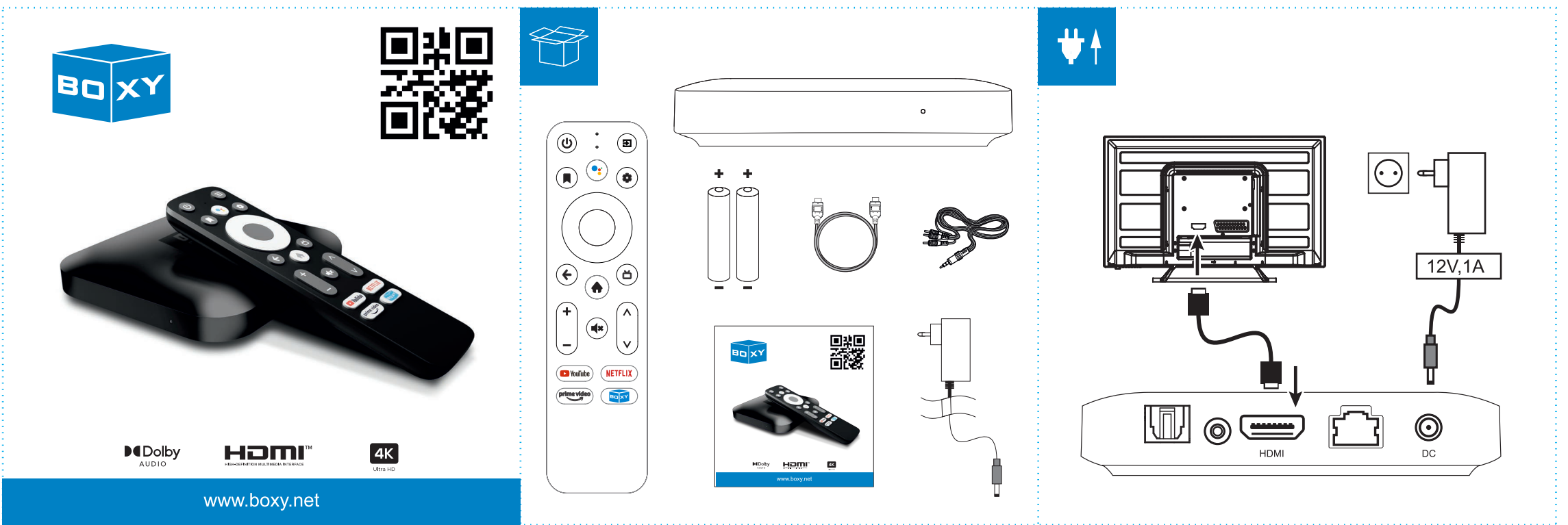

尾页

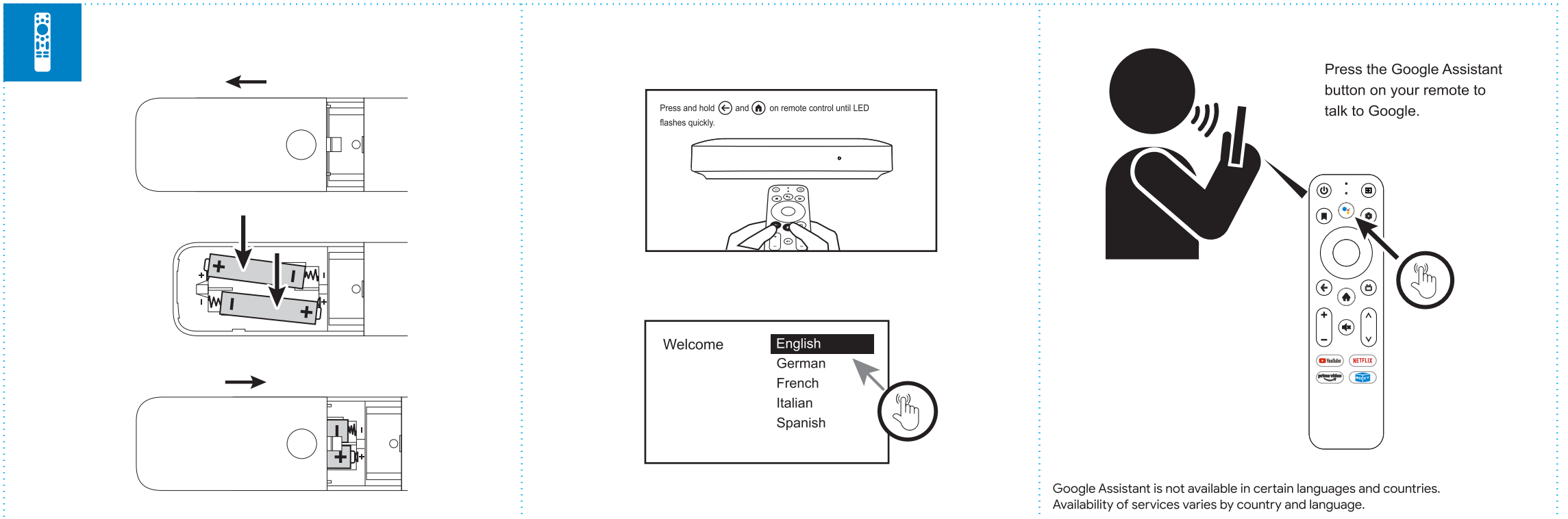
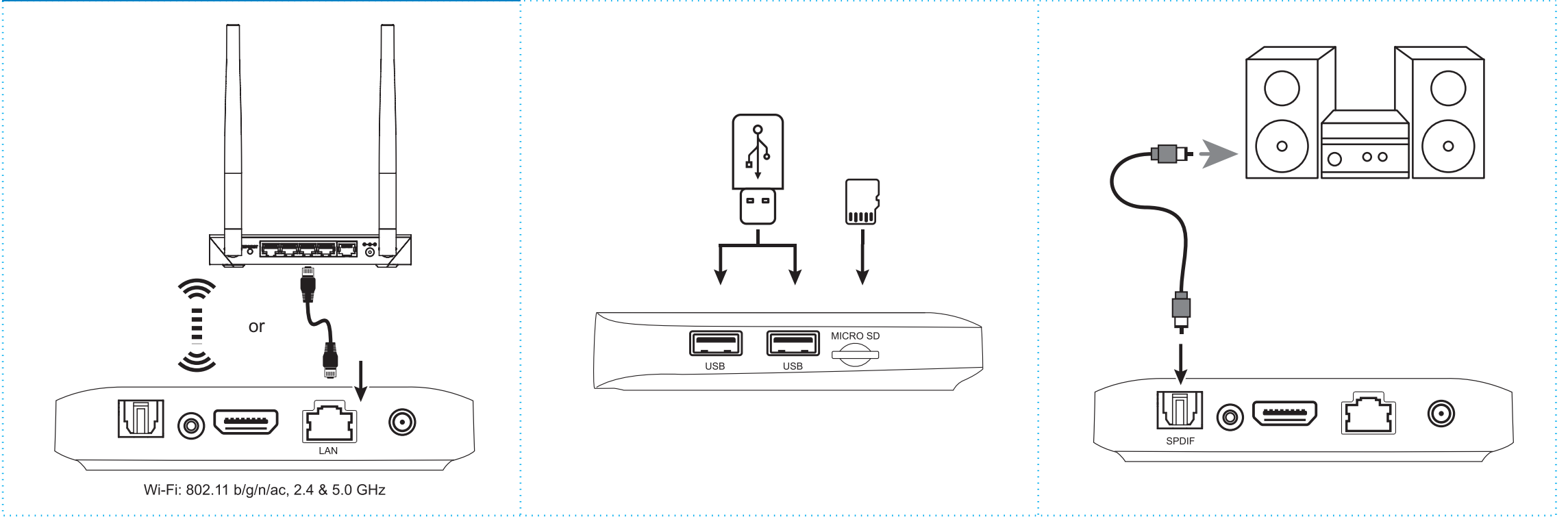

WARNING: TO PREVENT DAMAGE, FIRE, OR ELECTRIC SHOCK HAZARD, DO NOT EXPOSE THIS APPLIANCE TO RAIN OR EXPOSE THIS APPLIANCE TO HUMIDITY.

WARNINGS:

- Never open the device and the external power supply yourself, as this may cause electric shock, damage the device, and void the manufacturer's warranty. For repairs and maintenance, refer only to qualified personnel.
- Use an electrical outlet with the correct specifications to power the device.
- Connect the device only to audio and video components and connection cables designed for this purpose.
- Do not expose the device to direct sunlight, low and high temperatures, high humidity. Avoid sudden changes in temperature and humidity. When moving the device from a cool place to a warm place or vice versa, unpack the device before using it and wait 1-2 hours without turning it on.
- Do not install foreign objects on the device. Protect the device from shocks, drops, vibrations and other mechanical influences.
- Do not block the ventilation holes and do not install it in a place where normal cooling of the device during operation is not possible. We recommend that you leave at least 10 cm of free space around the device for better ventilation.
- Install the device only on a solid, level surface.
- When mounted on a swivel base or bracket, make sure that the power cable is not under tension and remains free to access in case you need to quickly disconnect the power cable from the mains. The mains plug must remain easily accessible in case a quick disconnection from the mains power supply is required.
- Do not use abrasive materials or organic compounds (alcohol, gasoline, etc.) to clean the device. A small amount of neutral detergent may be used to clean the body of the device.
- Disconnect the device from the mains power supply and from the TV antenna cable if you do not intend to use it for a long time, or before a thunderstorm. Do not touch the device, power cord or antenna cable during a thunderstorm!
- Remove the batteries from the remote control if you are not going to use it for a long time.
- If a malfunction of the equipment is detected, it is necessary to disconnect the device from the mains and contact specialists.

This product is designed and manufactured with high quality parts and components that can be recycled and reused, so please dispose of this equipment in accordance with local regulations. This device is intended for home use. Media player complies with all necessary safety standards and CE/FCC/EAC technical regulations. Special implementation conditions are not provided.

Power supply 100-240V~, 50/60 Hz
 Temperature requirements:
 Operation: +5 to +35°C
 Transportation and storage on racks in original packaging: -25 to +40°C
 Humidity requirements: 10-75% (non-condensing)

Attribution statement
 Google and YouTube are marks of Google LLC.
 Dolby, Dolby Atmos, and the double-D symbol are registered trademarks of Dolby Laboratories.

FCC Statement
 This equipment has been tested and found to comply with the limits for a Class B digital device, pursuant to part 15 of the FCC Rules. These limits are designed to provide reasonable protection against harmful interference in a residential installation. This equipment generates, uses and can radiate radio frequency energy and, if not installed and used in accordance with the instructions, may cause harmful interference to radio communications. However, there is no guarantee that interference will not occur in a particular installation. If this equipment does cause harmful interference to radio or television reception, which can be determined by turning the equipment off and on, the user is encouraged to try to correct the interference by one or more of the following measures:
 •Reorient or relocate the receiving antenna.
 •Increase the separation between the equipment and receiver.
 •Connect the equipment into an outlet on a circuit different from that to which the receiver is connected.
 •Consult the dealer or an experienced radio/TV technician for help.
 Caution: Any changes or modifications to this device not explicitly approved by manufacturer could void your authority to operate this equipment.
 This device complies with part 15 of the FCC Rules. Operation is subject to the following two conditions: (1) This device may not cause harmful interference, and (2) this device must accept any interference received, including interference that may cause undesired operation.

RF Exposure Information
 This equipment complies with FCC radiation exposure limits set forth for an uncontrolled environment. This equipment should be installed and operated with minimum distance 20cm between the radiator and your body.

| | | | | | |
|-------|---------------------------|--------|----------------|---------|--------------|
| 公司名称: | 深圳市视壮科技有限公司 | 订单号: | VS-CHE220212ST | 物料料号: | |
| 物料名称: | 说明书 | 版本号: | Ver 1.0 | 图号: | STR.BOX01.01 |
| 对应机型: | STR | 特殊工艺: | / | 需求材质: | 128g铜版纸 |
| 印刷工艺: | / | 印刷色需求: | 4色印刷 | 过膜类型: | / |
| 成品尺寸: | 折后尺寸: 100x100mm | 尺寸公差: | ± 1mm | 物料刀模名称: | / |
| 设计人员: | 兰正孟 | 设计日期: | | 审核: | / |
| 备注: | 折叠方式: 风琴折后对折 蓝色虚线为无需印刷 | | | | |
| 专色色号: | | | | | |